

KNOW ALL MEN BY THESE PRESENTS. TO WIT:

THAT WILLIAM WATTS AND ELIZABETH B. WATTS, HIS WIFE, JEAN S. SHOWALTER AND ENGLISH SHOWALTER, HER HUSBAND, ALLEN W. STAPLES, JR. AND LINDA LEE STAPLES, HIS WIFE, ELLEN ELIZABETH STAPLES, UNMARRIED, ABRAM PENN STAPLES AND PEGGY K. STAPLES, HIS WIFE, AND W. HUNT STAPLES AND AELRED GLYNN STAPLES, HIS WIFE, ARE THE OWNERS OF THE PROPERTY SHOWN HEREON KNOWN AS "THE WATTS ESTATE," BOUNDED BY OUTSIDE CORNERS 1 THRU 5 TO 1, INCLUSIVE.

THE SAID OWNERS CERTIFY THAT THE LAND HAS BEEN SUBDIVIDED AS APPEARS ON THIS PLAT WITH THE FREE CONSENT AND IN ACCORDANCE WITH THE DESIRE OF SAID OWNERS AND IS PURSUANT TO AND IN COMPLIANCE WITH THE PROVISIONS OF TITLE 15.1 OF THE 1950 CODE OF VIRGINIA, AS AMENDED. AND THE SUBDIVISION ORDINANCE OF THE CITY OF ROANOKE, VIRGINIA, AS AMENDED.

THE SAID OWNERS HEREBY DEDICATE TO THE CITY OF ROANOKE, VIRGINIA, THE WATER LINE EASEMENT, 20 FEET WIDE, AND THE SANITARY SEWER EASEMENT, 20 FEET WIDE, AS SHOWN ON THIS PLAT.

IN WITNESS WHEREOF ARE HEREBY PLACED THE FOLLOWING SIGNATURES AND SEALS ON 7 MAR. 1979.

William Watts SEAL
WILLIAM WATTS

Elizabeth B. Watts SEAL
ELIZABETH B. WATTS

Jean S. Showalter SEAL
JEAN S. SHOWALTER

Allen W. Staples, Jr. SEAL
ALLEN W. STAPLES, JR. - BY JEAN S. SHOWALTER ATTORNEY IN FACT

Ellen Elizabeth Staples SEAL
ELLEN ELIZABETH STAPLES - BY JEAN S. SHOWALTER ATTORNEY IN FACT

Abram Penn Staples SEAL
ABRAM PENN STAPLES - BY JEAN S. SHOWALTER ATTORNEY IN FACT

W. Hunt Staples SEAL
W. HUNT STAPLES - BY JEAN S. SHOWALTER ATTORNEY IN FACT

Ruth S. Spradlin SEAL
ENGLISH SHOWALTER- BY RUTH S. SPRADLIN ATTORNEY IN FACT

Linda Lee Staples SEAL
LINDA LEE STAPLES - BY JEAN S. SHOWALTER ATTORNEY IN FACT

Peggy K. Staples SEAL
PEGGY K. STAPLES - BY JEAN S. SHOWALTER ATTORNEY IN FACT

Aelred Glynn Staples SEAL
AELRED GLYNN STAPLES - BY JEAN S. SHOWALTER ATTORNEY IN FACT

STATE OF VIRGINIA
CITY OF ROANOKE

I, _____, A NOTARY PUBLIC IN AND FOR THE AFORESAID STATE DO HEREBY CERTIFY THAT WILLIAM WATTS, ELIZABETH B. WATTS, JEAN S. SHOWALTER, RUTH S. SPRADLIN AS ATTORNEY FOR ENGLISH SHOWALTER, AND JEAN S. SHOWALTER AS ATTORNEY FOR ALLEN W. STAPLES, JR., LINDA LEE STAPLES, ELLEN ELIZABETH STAPLES, ABRAM PENN STAPLES, PEGGY K. STAPLES, W. HUNT STAPLES AND AELRED GLYNN STAPLES, WHOSE NAMES ARE SIGNED TO THE FOREGOING WRITING DATED _____, 1979, HAVE PERSONALLY APPEARED BEFORE ME IN MY JURISDICTION AND ACKNOWLEDGED THE SAME ON _____, 1979.

MY COMMISSION EXPIRES ON _____.

NOTARY PUBLIC

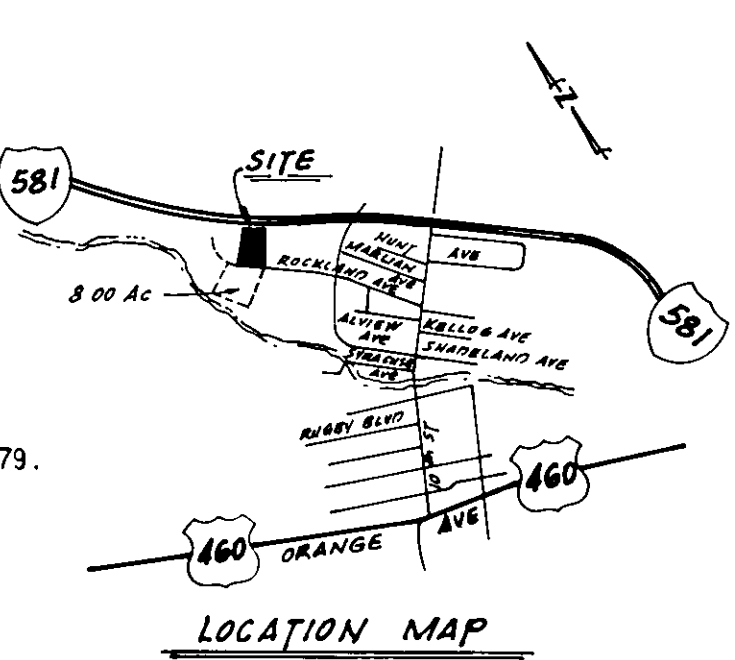

BOUNDARY CO-ORDINATES ORIGIN OF CO-ORDINATES ASSUMED		
COR.	NORTH	EAST
1.	2119.79	1868.20
2.	2247.38	1561.36
3.	2298.02	1465.21
4.	2760.03	1856.30
5.	2585.12	2136.09
TOTAL AREA 5.000 AC.		

CURVE DATA						
CURVE	ANGLE	TAN.	RADIUS	ARC	CH. BEARING	CHORD
A	60 00' 00"	17.32'	30.00'	31.42'	N 37 25' 20" W	30.00'
B	138 28' 00"	131.86'	50.00'	120.84'	N 76 39' 20" W	93.50'
C	10 23' 30"	54.56'	600.00'	108.82'	N 62 13' 35" W	108.67'
D	3 13' 46"	165.04'	5854.58'	330.00'	S 57 59' 18" E	329.96'

IN THE CLERK'S OFFICE OF THE CIRCUIT COURT FOR THE CITY OF ROANOKE, VIRGINIA THIS MAP IS PRESENTED ON Dec. 13, 1979, AND WITH THE CERTIFICATE OF ACKNOWLEDGEMENT THERETO ANNEXED, IS ADMITTED TO RECORD AT 3:32 O'CLOCK P.M.

TESTEE: By: Doris A. M. D.C.
CLERK

I HEREBY CERTIFY THAT THIS PLAT OF SURVEY IS CORRECT.

CERTIFIED LAND SURVEYOR

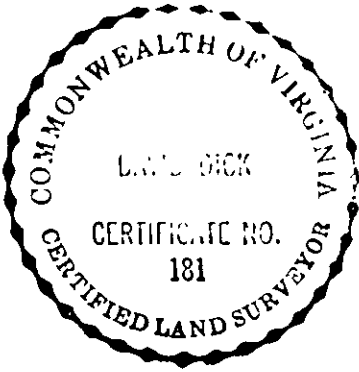

PLAT SHOWING (5.000 ACRES)
PORTION OF
WATTS ESTATE
PROPERTY OF
WILLIAM WATTS AND ELIZABETH B. WATTS, HIS WIFE,
JEAN S. SHOWALTER AND ENGLISH SHOWALTER, HER HUSBAND,
ALLEN W. STAPLES, JR. AND LINDA LEE STAPLES, HIS WIFE,
ELLEN ELIZABETH STAPLES, UNMARRIED,
ABRAM PENN STAPLES AND PEGGY K. STAPLES, HIS WIFE,
AND W. HUNT STAPLES AND AELRED GLYNN STAPLES, HIS WIFE
SITUATED ALONG ROCKLAND AVENUE, N. W.
ROANOKE, VIRGINIA

SCALE: 1" = 100' DATE 7 MAR. 1979
BUFORD T. LUMSDEN & ASSOCIATES, P. C.
CERTIFIED LAND SURVEYORS
ROANOKE, VIRGINIA

