

KNOW ALL MEN BY THESE PRESENTS TO WIT :

THAT HICKORY WOODS DEVELOPERS, INC. IS THE FEE SIMPLE OWNER OF THE PARCEL OF LAND SHOWN HEREON BOUNDED BY CORNERS 1,2,3,27,28,19,20,21,22, 23,24,25,26 TO 1, INCLUSIVE, AND BEING ALL OF THE LAND CONVEYED TO SAID OWNER BY DEED FROM THE HAROLD B. & ANN P. ALEXANDER TRUST DATED SEPTEMBER 7, 1989 AND RECORDED IN THE CLERK'S OFFICE OF THE CIRCUIT COURT OF ROANOKE, VIRGINIA IN DEED BOOK 1609, PG. 383.

THAT ANN P. ALEXANDER IS THE FEE SIMPLE OWNER OF THE PARCEL OF LAND SHOWN HEREON BOUNDED BY CORNERS 3,4,5,6,7,8,9,10,11,12,13,14,15,16,17, 18,28,27 TO 3, INCLUSIVE, AND BEING A PORTION OF THE LAND CONVEYED TO SAID OWNER BY DEED FROM E.J. LAND CO. DATED JULY 28, 1986 AND RECORDED IN THE AFORESAID CLERK'S OFFICE IN DEED BOOK 1542, PAGE 1743 AND BY DEED FROM E.J. LAND CO. DATED DECEMBER 29, 1986 AND RECORDED IN DEED BOOK 1551, PAGE 1815.

THE SAID OWNERS HEREBY CERTIFY THAT THEY HAVE SUBDIVIDED THE LAND AS SHOWN HEREON ENTIRELY WITH THIER OWN FREE WILL AND ACCORD AS REQUIRED BY SECTION 15.1-465 THRU 15.1-485 OF THE 1950 CODE OF VIRGINIA AS AMENDED TO DATE AND THE CITY OF ROANOKE SUBDIVISION ORDINANCE AS AMENDED TO DATE. THE NEW 30' SANITARY SEWER AND WATER LINE EASEMENT SHOWN HEREON IS HEREBY DEDICATED FOR PUBLIC USE.

WITNESS THE SIGNATURE AND SEAL OF THE SAID OWNERS.

HICKORY WOODS DEVELOPERS, INC.

Ann P. Alexander 11/8/89
ANN P. ALEXANDER DATE
PRESIDENT
D.B. 1609, PG. 383

Ann P. Alexander 11/8/89
ANN P. ALEXANDER DATE
OWNER
D.B. 1524, PG. 1743
D.B. 1551, PG. 1815

SEE AGREEMENT FOR RIGHT-OF-WAY ACCESS, STORM DRAINAGE AND OTHER EASEMENTS BETWEEN TRACT "A", TRACT "B1" AND TRACT "B2", RECORDED CONTEMPORANEOUSLY HEREWITH.

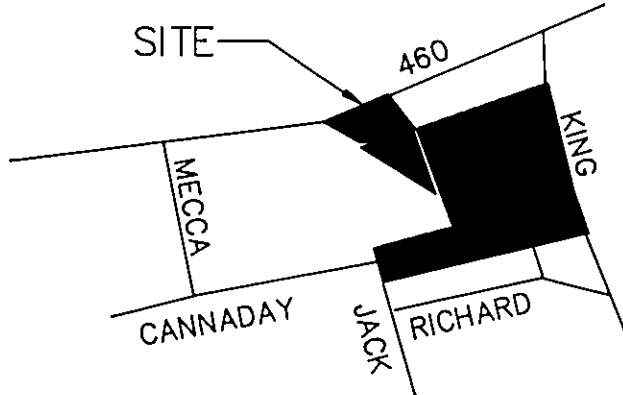

VICINITY MAP

BOUNDARY COORDINATES		
COR	NORTHING	EASTING
1	4040.142	3522.519
2	3881.449	3602.767
3	4108.065	4179.213
4	4304.236	4640.057
5	4470.841	4952.628
6	4484.055	4945.530
7	4608.078	5178.211
8	4513.102	5195.917
9	4235.993	5319.447
10	3969.405	5523.950
11	3867.982	5390.471
12	3840.114	5411.646
13	3734.238	5272.308
14	3715.554	5219.230
15	2734.209	3743.818
16	2984.743	3674.300
17	3549.635	4523.592
18	3700.809	4423.041
19	3764.795	4104.871
20	3677.511	3812.627
21	3766.216	3763.255
22	3791.464	3800.504
23	3865.381	3549.492
24	3834.595	3438.544
25	3895.137	3421.744
26	3904.319	3333.340
1	4040.142	3522.519

BOUNDARY COORDINATES SHOWN
HEREON ARE BASED ON
AN ASSUMED DATUM

TOTAL BOUNDARY, CORNERS
1 THRU 26 TO 1, CONTAINS
30.632 AC.

APPROVED:

Edward R. Tucker 11/27/89
AGENT - CITY OF ROANOKE
PLANNING COMMISSION DATE

Charles M. Huffine 11/27/89
CITY ENGINEER - CITY OF
ROANOKE DATE

STATE OF VIRGINIA
CITY OF ROANOKE
TO WIT:

I, BARBARA C. POFF, A NOTARY PUBLIC IN AND FOR THE AFORESAID STATE DO HEREBY CERTIFY THAT ANN P. ALEXANDER, WHOSE NAME IS SIGNED TO THE FOREGOING WRITING HAS PERSONALLY APPEARED BEFORE ME AND ACKNOWLEDGED THE SAME IN MY AFORESAID JURISDICTION ON THIS 27th DAY OF NOVEMBER, 1989.

MY COMMISSION EXPIRES:
FEBRUARY 3, 1992

Barbara C. Poff
NOTARY PUBLIC

- NOTES:
1. THIS PLAT IS SUBJECT TO INFORMATION WHICH MAY BE DISCLOSED BY A TITLE REPORT BY A LICENSED ATTORNEY.
 2. A PORTION OF THE SUBJECT PROPERTY IS WITHIN THE LIMITS OF THE 100 YEAR FLOOD BOUNDARY AS SHOWN ON THE FEMA FLOOD BOUNDARY MAP. THIS DETERMINATION IS BASED ON THE FLOOD BOUNDARY MAP AND HAS NOT BEEN VERIFIED BY ACTUAL FIELD ELEVATIONS.
 3. IRON PINS FOUND OR SET AT ALL CORNERS.

IN THE CLERK'S OFFICE OF THE CIRCUIT COURT OF ROANOKE, VIRGINIA THIS MAP WAS PRESENTED WITH THE CERTIFICATE OF ACKNOWLEDGMENT THERETO ATTACHED ADMITTED TO RECORD AT 11:45 O'CLOCK A.M. ON THIS 28th DAY OF November, 1989.

TESTE: PATSY TESTERMAN
CLERK

Charles M. Huffine
DEPUTY CLERK

THIS PLAT OF SUBDIVISION IS REQUIRED FOR RECORDATION IN ORDER TO SUBSTANTIATE A PREVIOUS DIVISION OF LAND BY DEED ONLY, AS RECORDED IN DEED BOOK 1609, PAGE 383 ON SEPTEMBER 7, 1989, IN THE OFFICE OF THE CLERK OF CIRCUIT COURT, IN THE CITY OF ROANOKE, AS REQUIRED BY SECTION 31-6, OF THE CODE OF THE CITY OF ROANOKE, VIRGINIA (1979) AS AMENDED.

SUBDIVISION OF
HICKORY WOODS - PHASE II

PROPERTY OF
HICKORY WOODS DEVELOPERS, INC. &
ANN P. ALEXANDER

SHOWING THE RESUBDIVISION OF TRACT "B",
HICKORY WOODS SUBDIVISION, M.B. 1, PG. 577
AND CREATING NEW TRACT "B1" AND NEW TRACT "B2"
ROANOKE, VIRGINIA

T. P. PARKER & SON
ENGINEERS - SURVEYORS - PLANNERS

TAX NO. 7090501 SCALE: 1" = 100'
DRAWN: DAP/CADD OCT. 19, 1989
CALC.: DAP SHEET 1 OF 2 W.O. 89-1238
N.B.: H.W. #4 M.B. 1 PG. 909