

THIS IS AN ORIGINAL SIZE MAP AND HAS NOT BEEN REDUCED.

LOTS ZONED RS-3

LEGEND

- M.B.L. MINIMUM BUILDING LINE
- R/W RIGHT OF WAY
- O IRON PIN FOUND
- IRON PIN SET
- E- OVERHEAD UTILITY LINES

COORDINATES

POINT	NORTHING	EASTING
1	2009.91	1929.27
3	1994.72	2034.95
4	1979.90	2090.83
5	1790.76	2011.25
7	1848.92	1872.79
1	2009.91	1929.27

BOUNDARY COORDINATES SHOWN
HEREON ARE ON ASSUMED DATUM.
BOUNDARY CONTAINS 0.690 ACRE

REFERENCE MAPS

1. SURVEY FOR RAYO LEE HOWLETT BY T. P. PARKER, C.L.S. DATED DEC. 16, 1969.
2. SURVEY FOR RAYO LEE HOWLETT BY T. P. PARKER, C.L.S. DATED OCT. 24, 1966.

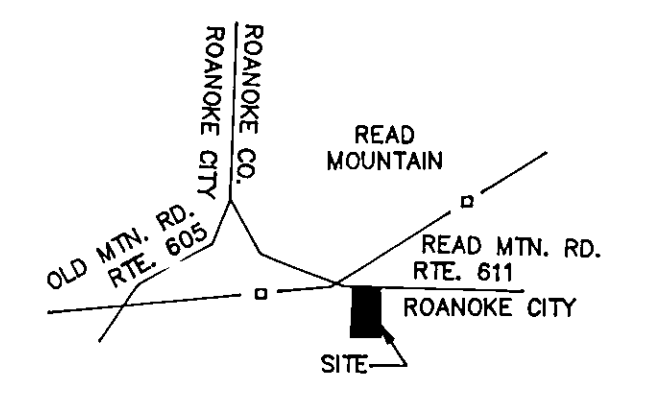

LOCATION MAP

NOTE: IRON PINS
AT ALL CORNERS

NEW LOT A
0.288 AC.
BOUNDED BY CORNERS
1, 2, 6, 7 TO 1
INCLUSIVE

NEW LOT B
0.392 AC.
BOUNDED BY CORNERS
2 THRU 6 TO 2
INCLUSIVE

PROPERTY OF
STANLEY & MARY LOU
KAZWELL
TAX # 7380109
D.B. 1515, PG. 94

PROPERTY OF
STANLEY & MARY LOU
KAZWELL
TAX # 7380108
D.B. 1515, PG. 94

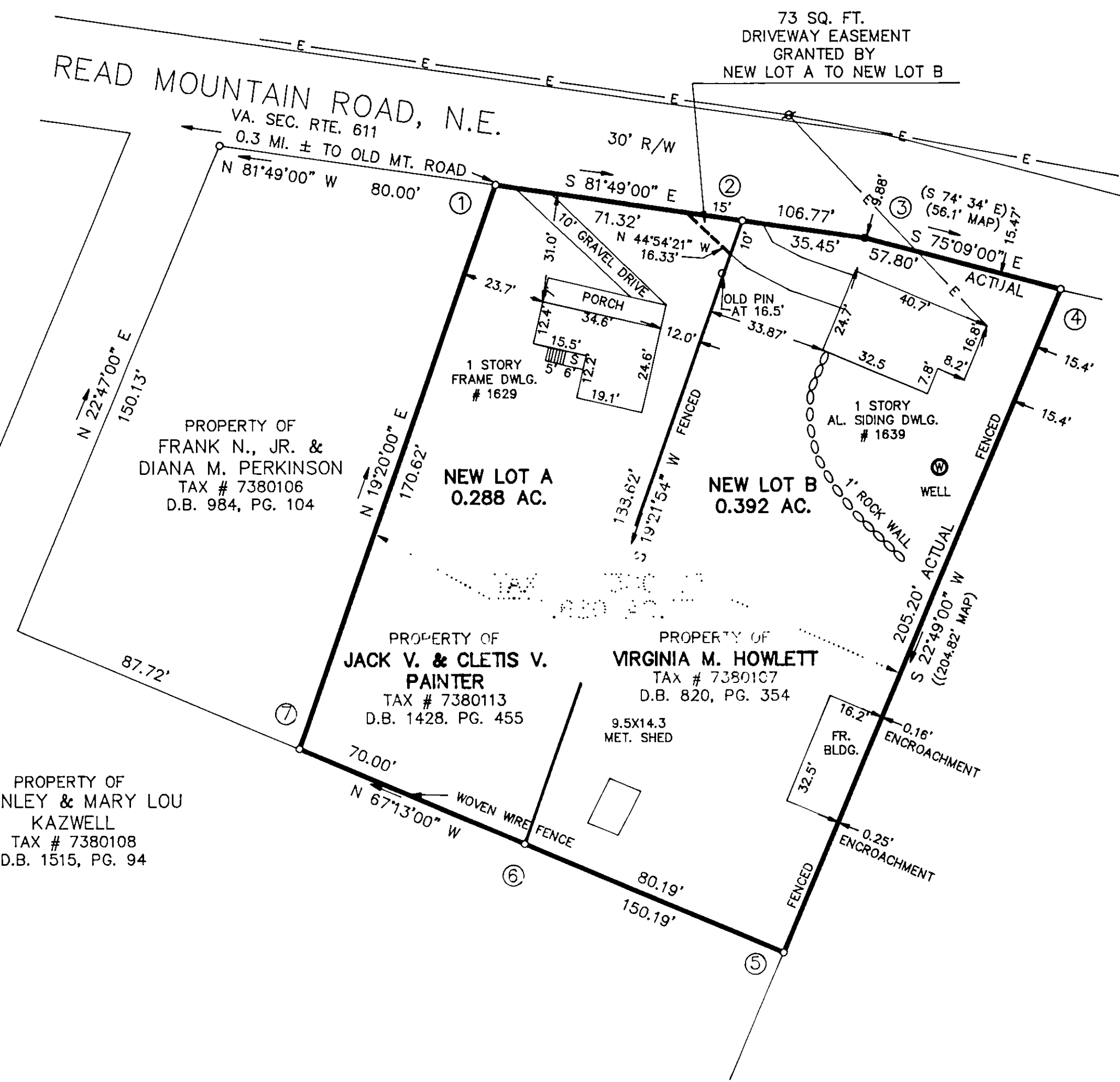

SUBDIVISION FOR
JACK V. & CLETIS V. PAINTER
AND VIRGINIA M. HOWLETT

SHOWING THE DIVISION OF A 0.680 ACRE LOT
CREATING NEW LOT A (0.288 AC.)
AND NEW LOT B (0.392 AC.)
SAID LOTS HAVING BEEN SUBDIVIDED BY DEED ONLY,
DEED RECORDED IN D.B. 1428, PG. 545
SITUATE ON READ MOUNTAIN ROAD, VA. SEC. RTE. #611
ROANOKE, VIRGINIA

T. P. PARKER & SON
ENGINEERS - SURVEYORS - PLANNERS
SALEM, VIRGINIA

TAX # 7380113,
7380107
CALC: LRD
DRAWN: LRD/CADD

SCALE: 1" = 30'
DATE: JULY, 2, 1990
N.B. G-69
W.O. 90-0891

SHEET 2 OF 2
M.B. 1, PG. 983

