

THIS ORIGINAL SCALE PLAT HAS NOT BEEN REDUCED M.B. 1 P.G. 1019

KNOW ALL MEN BY THESE PRESENTS, TO WIT:

THAT ELMER L. AND MARTHA S. POTTER ARE THE FEE SIMPLE OWNERS OF THE LAND SHOWN HEREON BOUNDED BY CORNERS 1 THRU 7 TO 1, INCLUSIVE, AS RECORDED IN DEED BOOK 1532 PAGE 322 IN THE OFFICE OF THE CLERK OF THE CIRCUIT COURT IN THE CITY OF ROANOKE, VIRGINIA.

JOSEPH H. LIKENS
RUBEY NISWANDER PEDIGO
TAX# 6110137

PEARL WEBB
DELMAR R. WEBB
TAX# 6110136

EDWARD H. ALBERT
D.B. 769 P.G. 458
TAX# 6110135

THE PLATTING AS SHOWN HEREON IS WITH THE FREE WILL AND CONSENT AND IS IN ACCORDANCE WITH THE DESIRE OF THE UNDERSIGNED OWNER AND IS IN COMPLIANCE WITH SECTION 15-1-477 OF THE 1950 CODE OF VIRGINIA, AS AMENDED TO DATE AND IN COMPLIANCE WITH THE PROVISIONS OF TITLE XVI, CHAPTER 2, OF THE CODE OF ROANOKE, VIRGINIA 1956 AS AMENDED TO DATE.

WITNESS THE FOLLOWING SEALS AND SIGNATURES ON THIS
13th DAY OF Aug 1990

Elmer L. Potter
ELMER L. POTTER

Marttha S. Potter
MARTHA S. POTTER

STATE OF VIRGINIA

City of Roanoke
I, LouAnne Keith A NOTARY PUBLIC
IN AND FOR THE AFORESAID City AND STATE
DO HEREBY CERTIFY THAT Elmer L. Potter
& Marttha S. Potter

WHOSE NAMES is SIGNED TO THE FOREGOING WRITING
DATE 8-13-90 HAVE PERSONALLY APPEARED BEFORE
ME AND ACKNOWLEDGED THE SAME ON THIS 13th
DAY OF Aug 1990

MY COMMISSION EXPIRES 3-27-92

LouAnne Keith
NOTARY PUBLIC

APPROVED: Edward R. Tuckey 10/11/90
AGENT ROANOKE CITY PLANNING COMM. DATE

Charles M. Hulfine 10/11/90
CITY ENGINEER, CITY OF ROANOKE, VIRGINIA DATE

IN THE CLERKS OFFICE OF THE CIRCUIT COURT
OF THE CITY OF ROANOKE, VIRGINIA, THIS MAP
WAS PRESENTED ON THIS 2nd DAY OF November
1990, AND WITH THE CERTIFICATES OF DEDICATION
AND ACKNOWLEDGEMENTS THERETO ATTACHED, IS
ADMITTED TO RECORD AT 10:40 O'CLOCK A.M.

TESTEE: Kathy Childs

Deputy CLERK
I HEREBY CERTIFY THAT THIS PLAT IS CORRECT
TO THE BEST OF MY KNOWLEDGE.

John D. Abbott
JOHN D. ABBOTT, L.S., P.E.; NEWCASTLE, VA

NOTE:

.9442 ACRES OF TAX PARCEL NO. 6110143
IS BEING SUBDIVIDED INTO A NEW LOT A
(.5275 AC.) AND A NEW LOT B (.4167 AC.).

SEE MAINTENANCE AGREEMENT RECORDED IN DEED BOOK
PAGE _____, IN THE OFFICE OF THE CLERK OF CIRCUIT COURT,
ROANOKE, VIRGINIA.

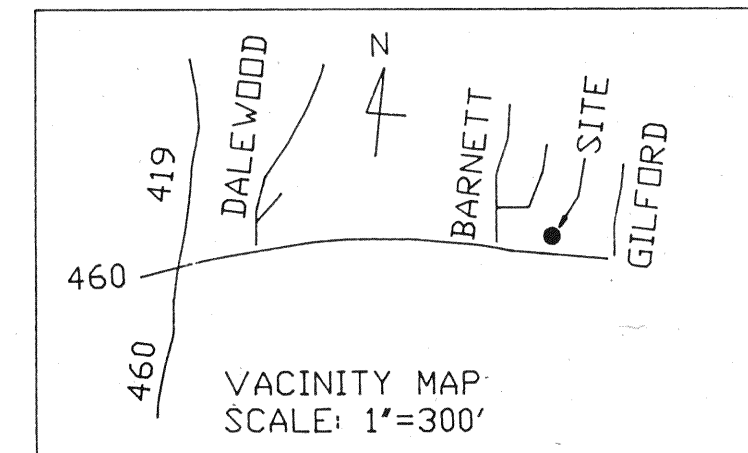

BOUNDARY COORDINATES

CORNER	N	E
1	5000.0000	5000.0000
2	4999.8473	5074.9999
3	4725.7990	5070.8316
4	4733.4708	4996.2251
5	4873.7090	5013.8393
6	4916.4904	4741.6702
7	5000.1615	4920.6702
1	5000.0000	5000.0000

TOTAL AREA = .9442 ACRES

SCALE: 1" = 40'

NOTES:

- LEGAL REFERENCE: DEED BOOK 1532
PAGE 322
DEED BOOK 1448
PAGE 305
DEED BOOK 846
PAGE 422
DEED BOOK 769
PAGE 458
DEED BOOK 1583
PAGE 1632
- TAX MAP NUMBER: 6110143
6110142
6110140
6110137
6110136
6110135
6110144
- PROPERTY NOT IN ANY HUD FLOOD
HAZARD ZONE.
- PROPERTY ZONED C-2

LEGEND

- SURVEYED PROP. LINE
- DEED LINE
- EIP EXISTING IRONS FOUND
- IPS IRONS SET

PLAT OF SURVEY SHOWING THE SUBDIVISION OF
A TRACT OF LAND (.9942 AC.) BELONGING TO
ELMER L. AND MARTHA POTTER, CREATING
HEREON NEW LOT A (0.5275 AC.) AND LOT B
(0.4167 AC.) SITUATED ADJACENT TO MELROSE
AVENUE ROANOKE, VIRGINIA.

SURVEYED: _____

M.B. 1 P.G. 1019