

CURVE TABLE						
CURVE	RADIUS	ARC	TANGENT	CHORD	CHORD BEARING	DELTA
A	250.00'	55.81'	28.02'	55.69'	S 65° 16' 17" W	12° 47' 24"
B	55.00'	67.57'	38.79'	63.40'	S 83° 37' 19" E	70° 23' 26"
C	25.00'	22.39'	12.01'	21.65'	N 86° 50' 28" E	51° 18' 58"
D	260.00'	91.51'	46.23'	91.04'	S 57° 25' 00" E	20° 09' 58"
D-6	260.00'	21.40'	10.71'	21.40'	S 49° 41' 32" E	4° 43' 01"
D-8	260.00'	70.11'	35.27'	69.89'	S 59° 46' 31" E	15° 26' 57"
E	25.00'	46.35'	33.31'	39.99'	S 5° 46' 19" W	106° 13' 20"

BOUNDARY COORDINATES ORIGIN OF COORDINATES ARE ASSUMED		
CORNER	NORTHING	EASTING
1	3,956.412	3,857.500
2	3,891.337	3,749.721
3	3,868.041	3,699.137
4	4,028.394	3,598.322
5	3,984.507	3,437.187
6	4,033.142	3,400.329
7	4,177.817	3,528.660
8	4,170.774	3,591.667
9	4,171.967	3,613.284
10	4,146.377	3,675.064
11	4,097.350	3,751.775
12	3,996.199	3,861.520
1	3,956.411	3,857.498
TOTAL AREA = 1.629 ACRES		

LEGEND	
M.B.	MAP BOOK
PG.	PAGE
P.U.E.	PUBLIC UTILITY EASEMENT
M.B.L.	MINIMUM BUILDING LINE
S.F.	SQUARE FEET
EX.	EXISTING
R/W	RIGHT-OF-WAY

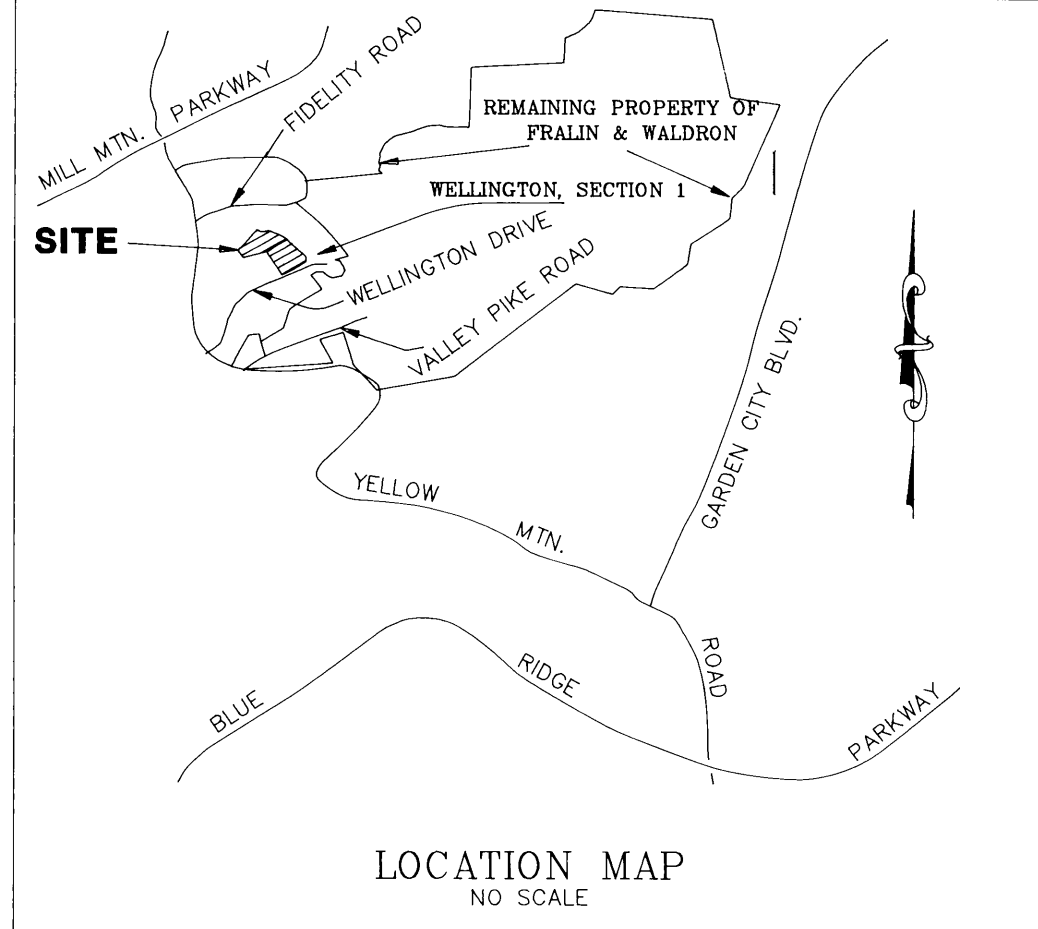

## APPROVED:

Edward R. Tucker  
AGENT, ROANOKE CITY PLANNING COMMISSION

12/16/93  
DATE

Charles M. Huffing  
CITY ENGINEER, ROANOKE, VIRGINIA

12/16/93  
DATE

IN THE CLERK'S OFFICE OF THE CIRCUIT COURT OF THE CITY OF ROANOKE, VIRGINIA, THIS MAP WITH THE CERTIFICATE OF ACKNOWLEDGEMENT THERETO ANNEXED IS ADMITTED TO RECORD ON December 22, 1993, AT 2:50 O'CLOCK P.M.

TESTEE: ARTHUR B. CRUSH, III

Sara Esterman  
DEPUTY CLERK

## KNOW ALL MEN BY THESE PRESENTS TO WIT.

THAT FRALIN & WALDRON, INC. IS THE FEE SIMPLE OWNER AND PROPRIETOR OF THE LAND SHOWN HEREON TO BE RESUBDIVIDED, BEING LOTS 6, 7, & 8, BLOCK 1, SECTION 1, WELLINGTON (MAP BOOK 1, PAGE 966), WHICH COMPRISES PART OF THE LAND CONVEYED TO SAID OWNER FROM CHARLES E. KEPLEY AND JUANITA D. KEPLEY BY DEED DATED MAY 10, 1989, AND RECORDED IN THE CLERK'S OFFICE OF THE CIRCUIT COURT OF THE CITY OF ROANOKE, VIRGINIA, IN DEED BOOK 1602, PAGE 1592.

THE SAID OWNER HEREBY CERTIFIES THAT THIS LAND HAS BEEN RESUBDIVIDED AS SHOWN HEREON ENTIRELY WITH THEIR OWN FREE WILL AND CONSENT AND PURSUANT TO AND IN COMPLIANCE WITH THE VIRGINIA CODE OF 1950, AS AMENDED TO DATE AND FURTHER PURSUANT TO AND IN COMPLIANCE WITH THE CITY OF ROANOKE LAND SUBDIVISION ORDINANCES.

IN WITNESS WHEREOF IS HEREBY PLACED THE FOLLOWING SIGNATURE AND SEAL ON THIS 3rd DAY OF December, 1993.

FRALIN & WALDRON, INC.

BY: Richard S. Whitney, Jr.  
RICHARD S. WHITNEY, JR., PRESIDENT

STATE OF VIRGINIA  
County OF Roanoke

I, Sara V. Prillaman, A NOTARY PUBLIC IN AND FOR THE AFORESAID County AND STATE DO HEREBY CERTIFY THAT RICHARD S. WHITNEY, JR., PRESIDENT OF FRALIN & WALDRON, INC., HAS PERSONALLY APPEARED BEFORE ME IN MY AFORESAID County AND STATE AND ACKNOWLEDGED THE SAME ON December 3, 1993.

MY COMMISSION EXPIRES January 31, 1995

Sara V. Prillaman  
NOTARY PUBLIC

## NOTES:

1. THIS PROPERTY IS NOT LOCATED WITHIN THE LIMITS OF A 100 YEAR FLOOD BOUNDARY AS DESIGNATED BY FEMA. THIS OPINION IS BASED ON AN INSPECTION OF THE FLOOD INSURANCE RATE MAP AND HAS NOT BEEN VERIFIED BY ACTUAL FIELD ELEVATIONS.
2. THIS ORIGINAL PLAT SCALE HAS NOT BEEN REDUCED.
3. THIS PLAT WAS PREPARED WITHOUT THE BENEFIT OF A CURRENT TITLE REPORT AND THERE MAY EXIST ENCUMBRANCES WHICH AFFECT THE PROPERTY NOT SHOWN HEREON.
4. THIS PLAT IS BASED ON A CURRENT FIELD SURVEY.
5. IRON PINS SET AT ALL CORNERS, P.C.'S AND P.T.'S UNLESS OTHERWISE NOTED.
6. THIS PLAT COMBINES TAX PARCELS 4280710, 4280711, AND 4280712 TO CREATE NEW LOTS 6A & 8A.

I HEREBY CERTIFY THAT THIS PLAT IS CORRECT TO THE BEST OF MY KNOWLEDGE AND BELIEF.

B. Lee Henderson, Jr.  
B. LEE HENDERSON, JR., L.S., P.E.

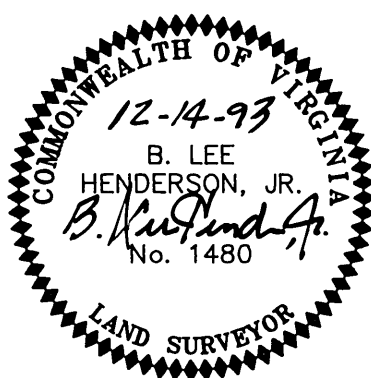

PLAT SHOWING THE  
RESUBDIVISION OF LOTS  
6, 7, & 8, BLOCK 1, SECTION 1

"WELLINGTON"  
(M.B. 1, PG. 967)

PROPERTY OF  
FRALIN & WALDRON, INC.

CREATING NEW

LOT 8A ( 0.795 Acres )  
LOT 6A ( 0.834 Acres )

ROANOKE, VIRGINIA

SCALE: 1" = 50' DATE: 19 AUGUST 1993

LUMSDEN ASSOCIATES, P.C.  
ENGINEERS-SURVEYORS-PLANNERS  
ROANOKE, VIRGINIA