

MERIDIAN OF VIRGINIA STATE  
PLANE COORDINATE SYSTEM  
NAD 83  
SOUTH ZONE

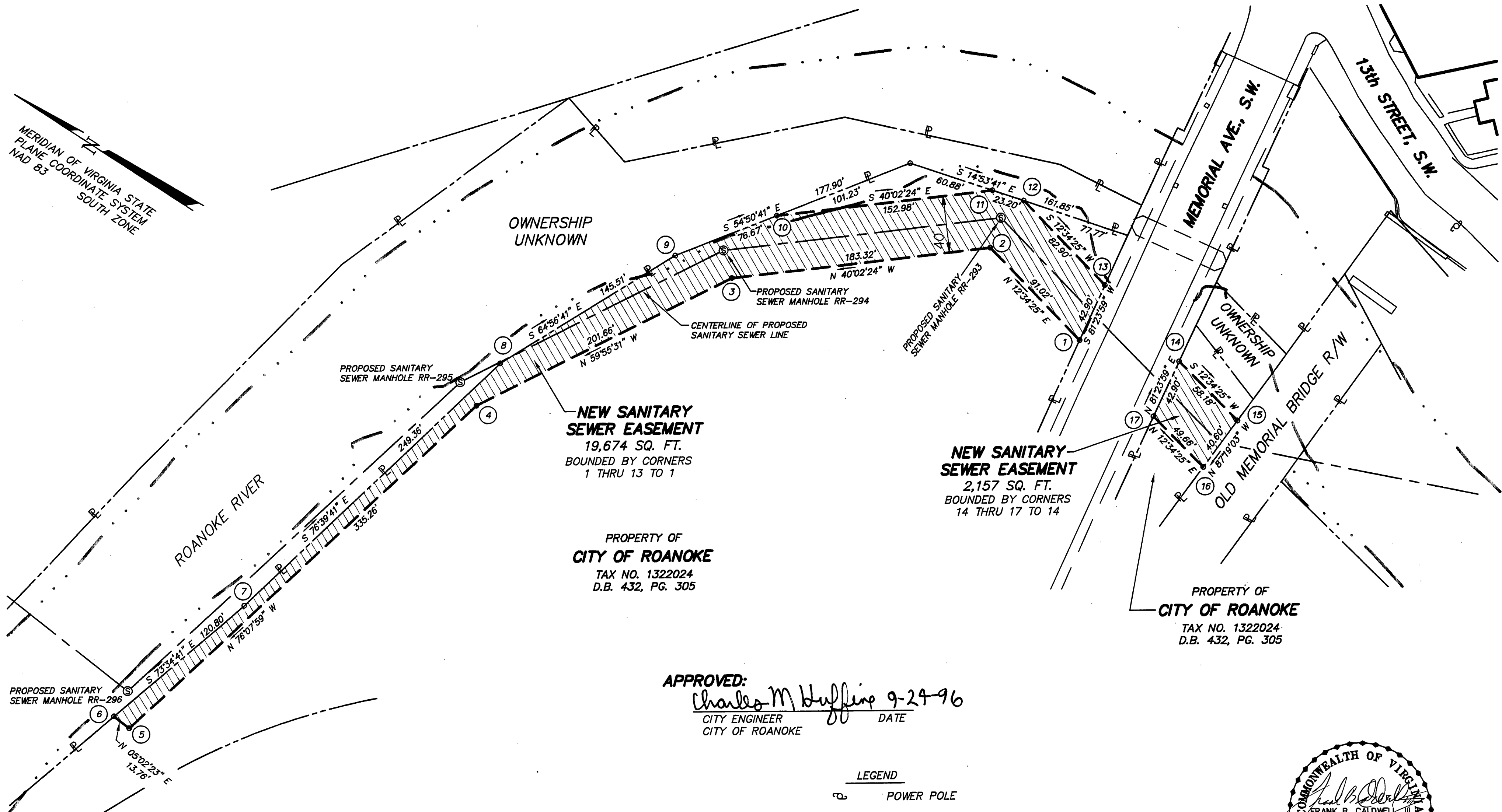

OWNERSHIP  
UNKNOWN

**NEW SANITARY  
SEWER EASEMENT**  
19,674 SQ. FT.  
BOUNDED BY CORNERS  
1 THRU 13 TO 1

PROPERTY OF  
**CITY OF ROANOKE**  
TAX NO. 1322024  
D.B. 432, PG. 305

**NEW SANITARY  
SEWER EASEMENT**  
2,157 SQ. FT.  
BOUNDED BY CORNERS  
14 THRU 17 TO 14

PROPERTY OF  
**CITY OF ROANOKE**  
TAX NO. 1322024  
D.B. 432, PG. 305

APPROVED:

*Charles M. Huffine* 9-24-96  
CITY ENGINEER DATE  
CITY OF ROANOKE

#### LEGEND

- POWER POLE
- OHW — OVERHEAD LINES
- SSMH — EXISTING SANITARY SEWER MANHOLE
- SS — SANITARY SEWER LINE
- P — PROPERTY LINE
- ▨ NEW SEWER EASEMENT
- ⊠ ELECTRIC TOWER

#### NOTES:

1. THIS PLAT WAS PREPARED WITHOUT BENEFIT OF A TITLE REPORT AND IS SUBJECT THERETO. THEREFORE, THERE MAY EXIST ENCUMBRANCES WHICH AFFECT THE PROPERTY NOT SHOWN HEREON.
2. METES AND BOUNDS DESCRIPTIONS SHOWN HEREON REPRESENT A COMPOSITE OF DEEDS, PLATS, CALCULATED INFORMATION AND FIELD TIES TO PROPERTY BOUNDARIES TO LOCATE THE POSITION OF THE EASEMENT IN RELATION TO THE BOUNDARIES. THIS SURVEY DOES NOT REFLECT A COMPLETE AND ACCURATE BOUNDARY SURVEY OF THE SUBJECT PROPERTIES.

IN THE CLERK'S OFFICE OF THE CIRCUIT COURT OF THE CITY OF ROANOKE,  
VIRGINIA THIS MAP WAS PRESENTED AND ADMITTED TO RECORD AT 2:15 O'CLOCK  
P.M. ON THIS 3rd DAY OF October, 1996.

TESTE: ARTHUR B. CRUSH, III  
CLERK

BY: *Kathy McMillan*  
DEPUTY CLERK

CLOSED BY DAP

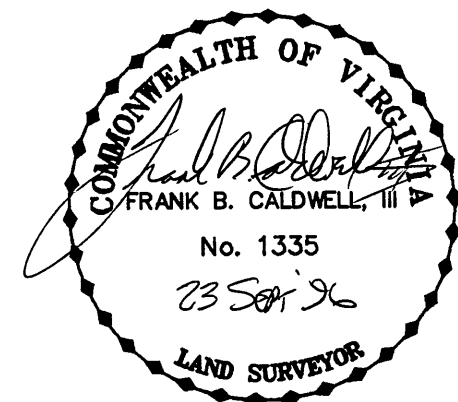
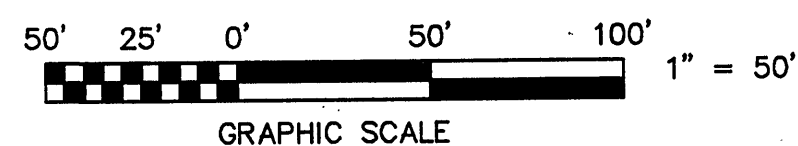

EASEMENT PLAT FOR  
**CITY OF ROANOKE**  
SHOWING A NEW SANITARY SEWER EASEMENT  
ACROSS PROPERTY OF  
CITY OF ROANOKE

ROANOKE, VIRGINIA

**T. P. PARKER & SON**  
ENGINEERS - SURVEYORS - PLANNERS

TAX NO.: 1322024  
DRAWN: DAP  
CALC.: DAP  
CITY PLAN NO. 6312-VVVV

SCALE: 1" = 50'  
SEPTEMBER 13, 1996  
W.O.: 95-0024