

KNOW ALL MEN BY THESE PRESENTS TO WIT:

THAT MARIE E. McGEORGE IS THE FEE SIMPLE OWNERS OF THE LAND SHOWN HEREON BOUNDED BY CORNERS 1 TO 5 TO 1 INCLUSIVE, AND IS ALL OF THE LAND CONVEYED TO SAID OWNERS BY DEED RECORDED IN THE CLERK'S OFFICE OF THE CIRCUIT COURT OF THE CITY OF ROANOKE, VIRGINIA, IN DEED BOOK 1079, PAGE 377.

THAT CHRISTOPHER L. HARRIS & LISA K. HARRIS ARE THE FEE SIMPLE OWNERS OF THE LAND SHOWN HEREON BOUNDED BY CORNERS 6 TO 9 TO 6 INCLUSIVE, AND IS ALL OF THE LAND CONVEYED TO SAID OWNERS BY DEED RECORDED IN THE CLERK'S OFFICE OF THE CIRCUIT COURT OF THE CITY OF ROANOKE, VIRGINIA, IN DEED BOOK 1667, PAGE 2125.

THE ABOVE DESCRIBED OWNERS BY VIRTUE OF THE RECORDING OF THIS PLAT DO HEREBY GRANT THE THE CITY OF ROANOKE IN FEE SIMPLE TITLE, THE LAND SHOWN HEREON AS SET APART FOR PUBLIC STREETS AND ALSO HEREBY GRANT THOSE CERTAIN AREAS SHOWN ON THE PLAT AS SET APART FOR USE AS PUBLIC EASEMENTS.

THE PLATTING OR DEDICATION OF THE LAND SHOWN HEREON IS WITH THE FREE CONSENT AND IN ACCORDANCE WITH THE DESIRE OF THE UNDERSIGNED OWNERS AS REQUIRED BY SECTION 15.1-465 THROUGH 15.1-485 OF THE CODE OF VIRGINIA (1950) AS AMENDED. AND THE SUBDIVISION ORDINANCE OF THE CITY OF ROANOKE, VIRGINIA.

Marie E. McGeorge  
MARIE E. McGEORGE

Christopher L. Harris  
CHRISTOPHER L. HARRIS

Lisa K. Harris  
LISA K. HARRIS

STATE OF VIRGINIA  
COMMONWEALTH AT LARGE:

I, Myra R. Whitley, A NOTARY PUBLIC IN AND FOR THE AFORESAID STATE, DO HEREBY CERTIFY THAT MARIE E. McGEORGE, WHOSE NAME IS SIGNED TO THE FOREGOING INSTRUMENT, HAS PERSONALLY APPEARED BEFORE ME AND ACKNOWLEDGED THE SAME ON THIS 27 DAY OF FEBRUARY, 1997.

Myra R. Whitley  
NOTARY PUBLIC

MY COMMISSION EXPIRES 9-30-99

STATE OF VIRGINIA  
COMMONWEALTH AT LARGE:

I, Myra R. Whitley, A NOTARY PUBLIC IN AND FOR THE AFORESAID STATE, DO HEREBY CERTIFY THAT CHRISTOPHER L. HARRIS & LISA K. HARRIS, WHOSE NAME IS SIGNED TO THE FOREGOING INSTRUMENT, HAS PERSONALLY APPEARED BEFORE ME AND ACKNOWLEDGED THE SAME ON THIS 31 DAY OF MARCH, 1997.

Myra R. Whitley  
NOTARY PUBLIC

MY COMMISSION EXPIRES 9-30-99

L. B. and C. Colman

ENGINEER FOR THE CITY OF ROANOKE, VIRGINIA Act. 4-10-97

John Thomas Josselyn 4/10/97  
AGENT FOR THE CITY OF ROANOKE, VIRGINIA PLANNING COMMISSION DATE

CLERK'S STATEMENT:

IN THE CLERK'S OFFICE FOR THE CIRCUIT COURT OF ROANOKE CITY, VIRGINIA THIS MAP WAS PRESENTED AND WITH THE CERTIFICATION OF ACKNOWLEDGEMENT THERETO ANNEXED, TO RECORD AT 9:55 O'CLOCK A.M. ON THIS THE 17 DAY OF APRIL, 1997 AND RECORDED IN MAP BOOK 1, PAGE 1634.

BY: Arthur B. Crouch III  
CLERK  
Matthew E. Hoff  
DEPUTY CLERK

I HEREBY CERTIFY THAT THIS PLAT IS FROM A CURRENT FIELD SURVEY AND IS CORRECT TO THE BEST OF MY KNOWLEDGE AND BELIEF.

Ronald R. Clark  
RONALD R. CLARK, L.S.

"THIS ORIGINAL PLAT HAS NOT BEEN REDUCED"  
ONE INCH 1" = 60'

#### LEGEND

- IRON PIN FOUND
- IRON PIN SET
- ⊙ DEED CALL

GARDEN CITY BOULEVARD  
R/W VARIES

PAMELA M. ROYE  
TM. # 4260507  
DB. 1664, PG. 32

HARRY LEE BECKNER  
& CARMEN R. BECKNER  
TM. # 4260508  
DB. 1619, PG. 1522

LARRY R. & DANA H. SUMPTER  
TM. # 4260509  
DB. 1647, PG. 720

3.144 FINAL ACREAGE  
LOT 3-A  
TM #4260515  
A.E. McGEORGE & MARIE E. McGEORGE  
DB. 1079, PG. 377

PREVIOUSLY  
NORTHERN PORTION LOT 3  
JOHN GARNAND SR. MAP  
PB. 1, PG. 224

MARY PAULINE THOMASON  
TM. # 4260510  
WB. 26, PG. 1144

#### LOCATION MAP

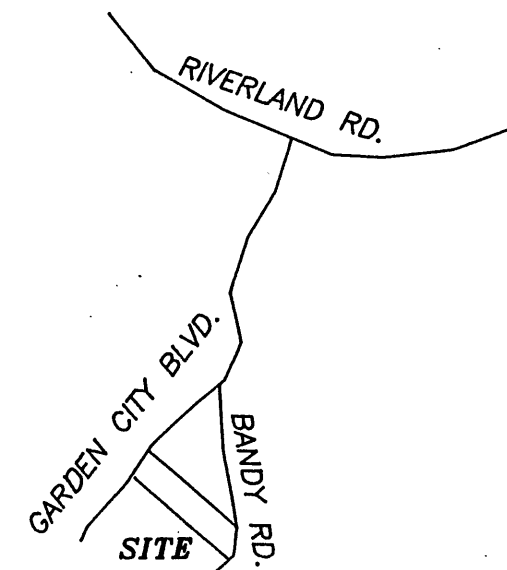

#### 0.224 FINAL ACREAGE

LOT C-1  
TM. # 4260517  
CHRISTOPHER L. & LISA K. HARRIS  
DB. 1667, PG. 2125

PREVIOUSLY LOT C  
GARY T. HALE ET. UX. MAP  
MB. 1, PG. 463

83 SQ. FT. TO  
BE COMBINED WITH  
TM. #4260515

EXISTING  
RESIDENCE  
# 2747

#### LINE TABLE

L-1 N54°45'00"E 27.35'  
L-2 S68°21'36"W 26.01'  
L-3 S16°35'21"W 6.45'  
L-4 S54°45'19"E 35.18'  
L-5 S46°56'30"W 59.62'  
L-6 S56°35'03"W 36.54'  
L-7 N56°34'19"W 30.03'  
L-8 S54°44'38"E 30.08'

#### C-1

I = 25°25'07"  
R = 452.00'  
A = 200.53'  
C = 198.89'  
CB = N28°33'41"E

#### COORDINATE LIST

1. = 622.6118 104.6303  
2. = 810.1425 219.6618  
3. = 400.0000 800.0000  
4. = 266.2030 750.2413  
5. = 225.4979 706.6795  
6. = 495.3059 665.1769  
7. = 571.9978 687.9442  
8. = 496.9690 794.1076  
9. = 420.2771 771.3403  
1. = 622.6118 104.6303

#### PLAT OF SURVEY SHOWING THE SUBDIVISION McGEORGE-HARRIS BOUNDARY LINE ADJUSTMENT

OF BE  
A 83 SQ. FT. TRACT TO BE CONVEYED TO LOT 3-A,  
CREATE LOT 3-A (3.144 ACRES) & LOT C-1 (0.224 ACRE)  
0.151 ACRE DEDICATED FOR GARDEN CITY BLVD. S.E.  
0.172 ACRE DEDICATED FOR BANDY ROAD S.E.  
LOCATED BETWEEN GARDEN CITY BOULEVARD S.E. & BANDY ROAD S.E.  
CITY OF ROANOKE, VIRGINIA  
SCALE: 1" = 60'



PREPARED BY:  
**CLARK SURVEYING**  
P.O. BOX 5575  
ROANOKE, VIRGINIA  
PHONE: (703) 362-1002

#### NOTES:

TAX # 4260717 & 4260515  
SOURCE OF TITLE: DB. 1727/812  
NO TITLE REPORT FURNISHED

SURVEYED OCTOBER 1, 1995  
UPDATED FEBRUARY 26, 1997  
DISK 27

