

KNOW ALL MEN BY THESE PRESENTS TO WIT:

THAT WILLIAM T. CARTER, BETTY LOU CARTER AND DONOVAN W. DRIVER, SHERI DRIVER ARE THE FEE SIMPLE OWNERS OF THE LAND SHOWN HEREON BEING NEW TRACT "A", M.B. 1, PG. 842 BOUNDED BY OUTSIDE CORNERS 1,3,4,6 TO 1, INCLUSIVE, BEING A PORTION OF THE PROPERTY CONVEYED TO SAID OWNERS BY DEED RECORDED IN DEED BOOK 1542, PAGE 787, RECORDED IN THE CLERK'S OFFICE OF THE CIRCUIT COURT OF THE CITY OF ROANOKE, VIRGINIA.

THE SAID OWNERS HEREBY CERTIFY THAT THEY HAVE RESUBDIVIDED THE LAND AS SHOWN ENTIRELY OF THEIR OWN FREE WILL AND ACCORD AS REQUIRED BY SECTION 15.2-2240 THROUGH 15.2-2276 OF THE 1950 CODE OF VIRGINIA AS AMENDED TO DATE AND THE CITY OF ROANOKE, VIRGINIA SUBDIVISION ORDINANCE AS AMENDED TO DATE.

WITNESS THE SIGNATURES AND SEALS OF SAID OWNERS.

OWNER  
D.B. 1542, PG. 787  
*William T. Carter* 2/22/00  
WILLIAM T. CARTER DATE

OWNER  
D.B. 1542, PG. 787  
*Betty Lou Carter* 2/22/00  
BETTY LOU CARTER DATE

OWNER  
D.B. 1542, PG. 787  
*Donovan W. Driver* 2/22/00  
DONOVAN W. DRIVER DATE

OWNER  
D.B. 1542, PG. 787  
*Sheri Driver* 2/22/00  
SHERI DRIVER DATE

#### BOUNDARY NOTE:

THIS PLAT SUBDIVIDES NEW TRACT "A" (1.059 AC.) AND CREATES LOT "A-1" (0.435 AC.) AND LOT "A-2" (0.624 AC.).

#### COORDINATES

CORNER	NORTHING	EASTING
1	5000.00	5000.00
2	4924.71	4813.60
3	4824.92	4566.57
4	4913.19	4518.09
5	5017.02	4775.15
6	5083.83	4940.53
1	5000.00	5000.00

THESE COORDINATES ARE BASED ON AN ASSUMED DATUM.

#### REFERENCE MAPS:

1. SURVEY FOR WILLIAM T. & BETTY LOU CARTER AND DONOVAN W. & SHERI DRIVER BY JACK G. BESS, C.L.S. DATED SEPTEMBER 1, 1987 AND RECORDED IN M.B. 1, PG. 842.

#### APPROVED:

*Arthur B. Crush, III* 2/22/00  
AGENT - CITY OF ROANOKE  
PLANNING COMMISSION DATE

*Charles M. Huffnir* 2/22/00  
CITY ENGINEER  
CITY OF ROANOKE DATE

IN THE CLERK'S OFFICE OF THE CIRCUIT COURT OF THE CITY OF ROANOKE, VIRGINIA THIS MAP WAS PRESENTED WITH THE CERTIFICATE OF ACKNOWLEDGMENT HERETO ATTACHED ADMITTED TO RECORD AT 4:15 O'CLOCK P.M. ON THIS 22nd DAY OF February, 2000.

TESTE: ARTHUR B. CRUSH, III  
CLERK

BY *James Chip*  
DEPUTY CLERK

CLOSED BY JTP, JR.

PROPERTY OF  
**ROBERT C. BRAMMER**

TAX NO. 641-0101  
D.B. 1718, PG. 1072  
1/2" REBAR FOUND

THIS IS AN ORIGINAL SIZE PLAT AND HAS NOT BEEN REDUCED.

M.B. 1 PG. 2068

5/8" REBAR FOUND (HIT)  
BEARS S27°07'49"W  
0.43' FROM CORNER  
N 28°46'33" W  
100.70'

PROPERTY OF  
**ROY C. & LINDA F. COLE**  
TAX NO. 642-0601  
D.B. 879, PG. 235  
LOT 1  
BLOCK 6

TRACT "A-2"  
0.624 AC.

NEW TRACT "B"  
2.538 AC.  
M.B. 1, PG. 842

PROPERTY OF  
**PAUL A. DUNCAN & GARY A. DUNCAN PARTNERSHIP**  
TAX NO. 642-1208  
D.B. 1607, PG. 240

#### LEGEND

P.U.E. PUBLIC UTILITY EASEMENT  
STY. STORY  
FR. FRAME  
DWLG. DWELLING  
GAR. GARAGE

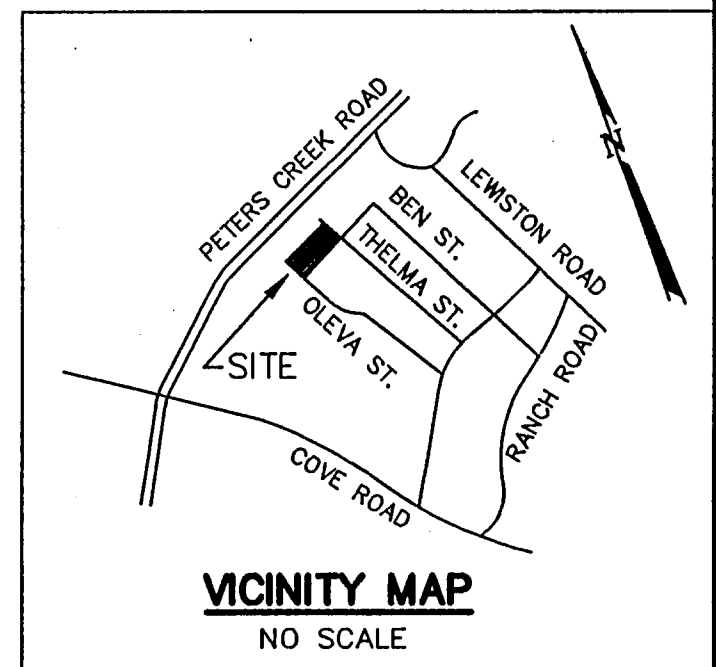

#### NOTES:

- THIS PLAT WAS PREPARED WITHOUT BENEFIT OF A TITLE REPORT AND IS SUBJECT THERETO. THEREFORE, THERE MAY EXIST ENCUMBRANCES WHICH AFFECT THE PROPERTY NOT SHOWN HEREON.
- THE SUBJECT PROPERTY IS WITHIN THE LIMITS OF FLOOD ZONE "X" AS SHOWN ON THE FEMA FLOOD INSURANCE RATE MAP NO. 51161C0023 D, EFFECTIVE DATE: OCTOBER 15, 1993. THIS DETERMINATION IS BASED ON SAID MAP AND HAS NOT BEEN VERIFIED BY ACTUAL FIELD ELEVATIONS.

STATE OF VIRGINIA  
COUNTY OF Roanoke TO WIT:

I, *Forrest R. Otley* A NOTARY PUBLIC IN AND FOR THE AFORESAID STATE DO HEREBY CERTIFY THAT WILLIAM T. CARTER AND BETTY LOU CARTER, WHOSES NAMES ARE SIGNED TO THE FOREGOING WRITING HAVE PERSONALLY APPEARED BEFORE ME AND ACKNOWLEDGED THE SAME IN MY AFORESAID JURISDICTION ON THIS 22nd DAY OF February, 2000.

MY COMMISSION EXPIRES:

*Nov. 30, 2002*

*Forrest R. Otley*  
NOTARY PUBLIC

STATE OF VIRGINIA  
COUNTY OF Roanoke TO WIT:

I, *Forrest R. Otley* A NOTARY PUBLIC IN AND FOR THE AFORESAID STATE DO HEREBY CERTIFY THAT DONOVAN W. DRIVER AND SHERI DRIVER, WHOSE NAMES ARE SIGNED TO THE FOREGOING WRITING HAVE PERSONALLY APPEARED BEFORE ME AND ACKNOWLEDGED THE SAME IN MY AFORESAID JURISDICTION ON THIS 22nd DAY OF February, 2000.

MY COMMISSION EXPIRES:

*Nov. 30, 2002*

*Forrest R. Otley*  
NOTARY PUBLIC

RESUBDIVISION FOR

**WILLIAM T. & BETTY LOU CARTER & DONOVAN W. & SHERI DRIVER**

SHOWING THE RESUBDIVISION OF NEW TRACT "A" (1.059 AC.)

M.B. 1, PG. 842

CREATING HEREON TRACT "A-1" (0.435 AC.) AND TRACT "A-2" (0.624 AC.)

CITY OF ROANOKE, VIRGINIA

TAX NO.: 642-1205

DRAWN: JTPZ-1

CALC: JTP, JR.

N.B. JR-179

SCALE: 1" = 40'

DATE: FEBRUARY 21, 2000

W.O.: 00-0092



**T.P. PARKER & SON**  
ENGINEERS  
SURVEYORS  
PLANNERS  
818 Boulevard  
Post Office Box 39  
Salem, Virginia 24153

