

KNOW ALL MEN BY THESE PRESENTS TO WIT:

THAT WILLIAM T. CARTER, BETTY LOU CARTER, DONOVAN W. DRIVER AND SHERI DRIVER ARE THE OWNERS OF THE LAND SHOWN HEREON BEING TRACT "A-2", M.B. 1, PG. 2068 BOUNDED BY OUTSIDE CORNERS 1,5,6,8 TO 1, INCLUSIVE, BEING A PORTION OF THE PROPERTY CONVEYED TO SAID OWNERS BY DEED RECORDED IN DEED BOOK 1542, PAGE 787, AND RECORDED IN THE CLERK'S OFFICE OF THE CIRCUIT COURT OF THE CITY OF ROANOKE, VIRGINIA.

THE SAID OWNERS HEREBY CERTIFY THAT THEY HAVE RESUBDIVIDED THE LAND AS SHOWN ENTIRELY OF THEIR OWN FREE WILL AND ACCORD AS REQUIRED BY SECTION 15.2-2240 THROUGH 15.2-2276 OF THE 1950 CODE OF VIRGINIA AS AMENDED TO DATE AND, THE CITY OF ROANOKE, VIRGINIA SUBDIVISION ORDINANCE AS AMENDED TO DATE AND VACATE LINE 2-4 AS SHOWN DOTTED HEREON.

THE SAID OWNERS HEREBY DEDICATE AND VEST IN THE CITY OF ROANOKE, VIRGINIA, SUCH PORTIONS OF THE PREMISES AS PLATTED AS ARE ON THIS PLAT SET APART FOR STREETS. WITNESS THE SIGNATURES AND SEALS OF SAID OWNERS.

OWNER
D.B. 1542, PG. 787

William T. Carter 1/11/01
WILLIAM T. CARTER DATE

OWNER
D.B. 1542, PG. 787

Betty Lou Carter 1/11/01
BETTY LOU CARTER DATE

OWNER

D.B. 1542, PG. 787

Donovan W. Driver 1-15-01
DONOVAN W. DRIVER DATE

OWNER
D.B. 1542, PG. 787

Sheri Driver 1-15-01
SHERI DRIVER DATE

BOUNDARY NOTE:

THIS PLAT SUBDIVIDES TRACT "A-2" (0.624 AC.) AND CREATES TRACT "A-2A" (0.339 AC.) AND TRACT "A-2B" (0.262 AC.).

COORDINATES

CORNER	NORTHING	EASTING
1	4924.71	4813.60
2	4890.91	4729.93
3	4903.95	4695.24
4	4872.06	4683.25
5	4824.92	4566.57
6	4913.19	4518.09
7	4970.87	4660.88
8	5017.02	4775.15
1	4924.71	4813.60

THESE COORDINATES ARE BASED ON AN ASSUMED DATUM.

REFERENCE MAPS:

1. SURVEY FOR WILLIAM T. & BETTY LOU CARTER AND DONOVAN W. & SHERI DRIVER BY JACK G. BESS, C.L.S. DATED SEPTEMBER 1, 1987 AND RECORDED IN M.B. 1, PG. 842.

2. RESUBDIVISION FOR WILLIAM T. & BETTY LOU CARTER & DONOVAN W. & SHERI DRIVER BY T. P. PARKER & SON DATED FEBRUARY 21, 2000 AND RECORDED IN M.B. 1, PG. 2068.

APPROVED:

John Thomas Russell 01/25/01
AGENT - CITY OF ROANOKE
PLANNING COMMISSION

Philip C. Guiraud 1/25/01
CITY ENGINEER
CITY OF ROANOKE

IN THE CLERK'S OFFICE OF THE CIRCUIT COURT OF THE CITY OF ROANOKE, VIRGINIA THIS MAP WAS PRESENTED WITH THE CERTIFICATE OF ACKNOWLEDGMENT THERETO ATTACHED ADMITTED TO RECORD AT 3:28 O'CLOCK P.M. ON THIS 29 DAY OF JANUARY, 2001.

TESTE: ARTHUR B. CRUSH, III
CLERK
BY *Art Crush*
DEPUTY CLERK

CLOSED BY JTP,JR.

THIS IS AN ORIGINAL SIZE PLAT AND HAS NOT BEEN REDUCED.

M.B. 1 PG. 2209

CURVE DATA						
CURVE	DELTA	TAN.	RAD.	ARC.	CHORD BRG.	CHORD
"A"	94°47'54"	27.37'	25.17'	41.65'	N 69°23'42" W	37.06'
"B"	85°12'06"	23.15'	25.17'	37.43'	S 20°36'18" W	34.08'
TOTAL	180°00'00"		25.17'	79.08'	S 68°00'15" W	50.34'

LEGEND

P.U.E. PUBLIC UTILITY EASEMENT
S.S.E. SANITARY SEWER EASEMENT

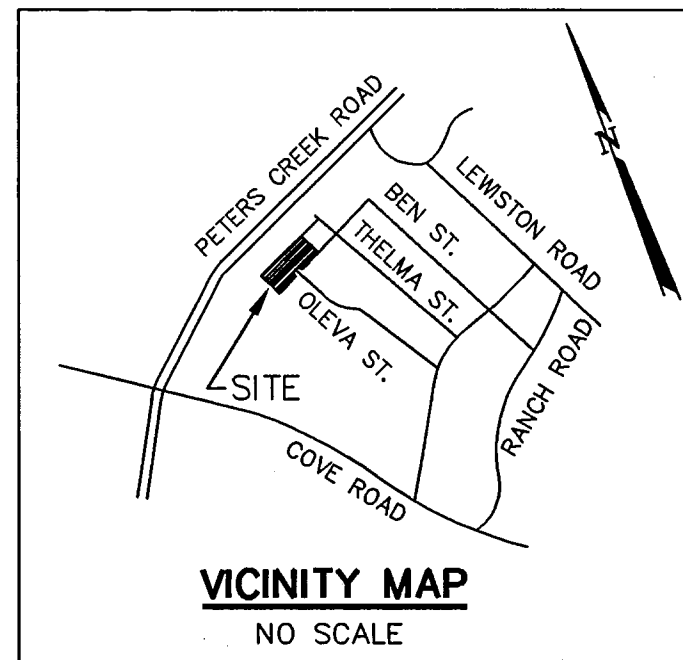

NOTES:

- THIS PLAT WAS PREPARED WITHOUT BENEFIT OF A TITLE REPORT AND IS SUBJECT THERETO. THEREFORE, THERE MAY EXIST ENCUMBRANCES WHICH AFFECT THE PROPERTY NOT SHOWN HEREON.
- THE SUBJECT PROPERTY IS WITHIN THE LIMITS OF FLOOD ZONE "X" AS SHOWN ON THE FEMA FLOOD INSURANCE RATE MAP NO. 51161C0023 D, EFFECTIVE DATE: OCTOBER 15, 1993. THIS DETERMINATION IS BASED ON SAID MAP AND HAS NOT BEEN VERIFIED BY ACTUAL FIELD ELEVATIONS.

STATE OF VIRGINIA
City of Salem TO WIT:

I, *Anna S. Gill* A NOTARY PUBLIC IN AND FOR THE AFORESAID STATE DO HEREBY CERTIFY THAT WILLIAM T. CARTER AND BETTY LOU CARTER, WHOSES NAMES ARE SIGNED TO THE FOREGOING WRITING HAVE PERSONALLY APPEARED BEFORE ME AND ACKNOWLEDGED THE SAME IN MY AFORESAID JURISDICTION ON THIS 11th DAY OF January, 2000. 2001 ASG

MY COMMISSION EXPIRES: 3-31-01
Anna S. Gill NOTARY PUBLIC

STATE OF VIRGINIA
City of Salem TO WIT:

I, *Anna S. Gill* A NOTARY PUBLIC IN AND FOR THE AFORESAID STATE DO HEREBY CERTIFY THAT DONOVAN W. & SHERI DRIVER WHOSE NAMES ARE SIGNED TO THE FOREGOING WRITING HAVE PERSONALLY APPEARED BEFORE ME AND ACKNOWLEDGED THE SAME IN MY AFORESAID JURISDICTION ON THIS 15th DAY OF January, 2000. 2001 ASG

MY COMMISSION EXPIRES: 3-31-01
Anna S. Gill NOTARY PUBLIC

RESUBDIVISION FOR

WILLIAM T. & BETTY LOU CARTER
& DONOVAN W. & SHERI DRIVER

SHOWING THE RESUBDIVISION OF TRACT "A-2" (0.624 AC.)
M.B. 1, PG. 2068

CREATING HEREON TRACT "A-2A" (0.339 AC.) AND TRACT "A-2B" (0.262 AC.)
SITUATE ON OLEVA STREET, N.W.

CITY OF ROANOKE, VIRGINIA

TAX NO.: 642-1209 SCALE: 1" = 40'
DRAWN: JTP,JR. DATE: JANUARY 2, 2001
CALC: JTP,JR. W.O.: 00-1216
DISK: JTPZ-4 N.B. JR-179



T. P. PARKER & SON
816 Boulevard
Post Office Box 39
Salem, Virginia 24153

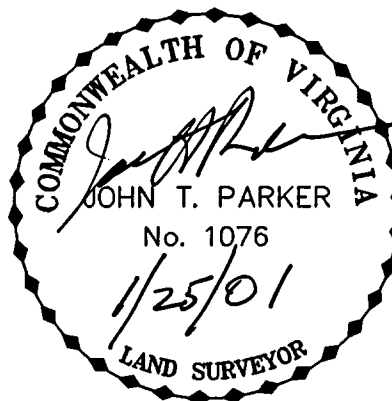

THIS RESUBDIVISION IS BASED ON A CURRENT FIELD SURVEY. WILLIAM T. & BETTY LOU CARTER & DONOVAN W. & SHERI DRIVER ARE THE OWNERS OF RECORD. SEE D.B. 1542, PG. 787.

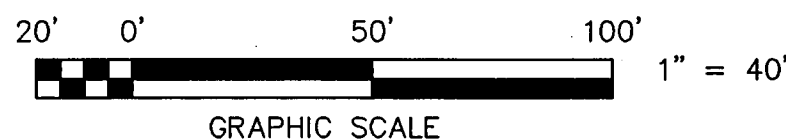

M.B. PG.