

KNOW ALL MEN BY THESE PRESENTS TO WIT:

THAT LOYD D. SHIFFER AND KATHY L. SHIFFER ARE THE FEE SIMPLE OWNERS AND PROPRIETORS OF THE LAND SHOWN HEREON TO BE SUBDIVIDED, BOUNDED BY OUTSIDE CORNERS 1 THROUGH 10 TO 1, INCLUSIVE, WHICH COMPRISES ALL OF THE LAND CONVEYED TO SAID OWNER BY INSTRUMENT DATED AUGUST 29, 2000 AND RECORDED IN THE CLERK'S OFFICE OF THE CIRCUIT COURT OF THE CITY OF ROANOKE, VIRGINIA, IN INSTRUMENT #000011413, ALL THE LAND CONVEYED TO AFORESAID OWNERS BY INSTRUMENT #990018355, DATED NOVEMBER 15, 1999 AND RECORDED IN THE AFORESAID CLERK'S OFFICE, A PORTION OF THE LAND CONVEYED TO AFORESAID OWNERS BY INSTRUMENT #990008055, DATED MAY 24, 1999 AND RECORDED IN AFORESAID CLERK'S OFFICE, A PORTION OF THE LAND CONVEYED TO AFORESAID OWNERS BY D.B. 1651, PG. 1802, DATED JAN. 20, 1992 AND RECORDED IN AFORESAID CLERK'S OFFICE, AND A PORTION OF THE LAND CONVEYED TO AFORESAID OWNERS BY D.B. 1651, PG. 1794, DATED JAN. 20, 1992 AND RECORDED IN AFORESAID CLERK'S OFFICE.

THE SAID OWNERS CERTIFY THAT THEY HAVE COMBINED THESE PARCELS OF LAND, AS SHOWN HEREON, ENTIRELY WITH THEIR OWN FREE WILL AND CONSENT AND PURSUANT TO AND IN COMPLIANCE WITH THE VIRGINIA CODE OF 1950, AS REQUIRED BY SECTIONS 15.2-2240 THROUGH 15.2-2279, AS AMENDED TO DATE, FURTHER PURSUANT TO AND IN COMPLIANCE WITH THE CITY OF ROANOKE LAND SUBDIVISION ORDINANCES.

IN THE WITNESS WHEREOF ARE HEREBY PLACED THE FOLLOWING SIGNATURES

Lloyd D. Shiffer 6-1-01
LOYD D. SHIFFER DATE:
OWNER

Kathy L. Shiffer 6-1-01
KATHY L. SHIFFER DATE:
OWNER

STATE OF VIRGINIA

COUNTY OF ROANOKE
I, MARGARET S. CONNER, A NOTARY PUBLIC IN AND FOR THE AFORESAID COUNTY AND STATE DO HEREBY CERTIFY THAT LOYD D. SHIFFER, WHOSE NAME IS SIGNED TO THE FOREGOING WRITING DATED APRIL 6, 2001, HAS PERSONALLY APPEARED BEFORE ME IN MY AFORESAID COUNTY AND STATE AND ACKNOWLEDGED THE SAME ON JUNE 1, 2001 MY COMMISSION EXPIRES JUNE 30, 2003.

Margaret S. Conner
NOTARY PUBLIC

STATE OF VIRGINIA

COUNTY OF ROANOKE
I, MARGARET S. CONNER, A NOTARY PUBLIC IN AND FOR THE AFORESAID COUNTY AND STATE DO HEREBY CERTIFY THAT KATHY L. SHIFFER, WHOSE NAME IS SIGNED TO THE FOREGOING WRITING DATED APRIL 6, 2001, HAS PERSONALLY APPEARED BEFORE ME IN MY AFORESAID COUNTY AND STATE AND ACKNOWLEDGED THE SAME ON JUNE 1, 2001 MY COMMISSION EXPIRES JUNE 30, 2003.

Margaret S. Conner
NOTARY PUBLIC

IN THE CLERK'S OFFICE OF THE CIRCUIT COURT OF THE CITY OF ROANOKE, VIRGINIA. THIS MAP WAS PRESENTED WITH THE CERTIFICATE OF ACKNOWLEDGMENT THERETO ANNEXED IS ADMITTED TO RECORD ON

JUNE 4th 2001, AT 9:40 O'CLOCK

TESTE: ARTHUR B. CRUSH, III

Patty Taylor
DEPUTY CLERK

NOTES

1. THIS PLAT IS BASED ON A CURRENT FIELD SURVEY
2. THE SUBJECT PROPERTY LIES IN ZONE "X" OF THE FLOOD INSURANCE RATE MAP PANEL 51161C0023 D DATED OCTOBER 15, 1993. THIS DETERMINATION IS MADE FROM SAID MAP AND NOT FROM AN ACTUAL FIELD SURVEY.
3. THIS PLAT WAS PREPARED WITHOUT THE BENEFIT OF A CURRENT TITLE REPORT.
4. LEGAL REFERENCES: INS. #000011413
INS. #990018355
INS. #990008055
D.B. 1651, PG. 1802
D.B. 1651, PG. 1794

PNT.	COORDINATES (ORIGIN OF COORDINATES IS ASSUMED)	
1	N 5000.0000	E 5000.0000
2	N 4909.0535	E 5377.4169
3	N 4885.4681	E 5368.9770
4	N 4871.2052	E 5416.8820
5	N 4612.2327	E 5340.8670
6	N 4561.2845	E 5682.2423
7	N 4316.3188	E 5678.1420
8	N 4360.9193	E 5384.8878
9	N 4105.1495	E 5379.3853
10	N 4165.8788	E 4972.1553
1	N 5000.0000	E 5000.0000
9.1218 ACRES		

LEGEND	
I.P.F.	IRON PIN FOUND
D.B.	DEED BOOK
PG.	PAGE
I.P.S.	IRON PIN SET
R/W	RIGHT-OF-WAY
INS.	INSTRUMENT
FND.	FOUND

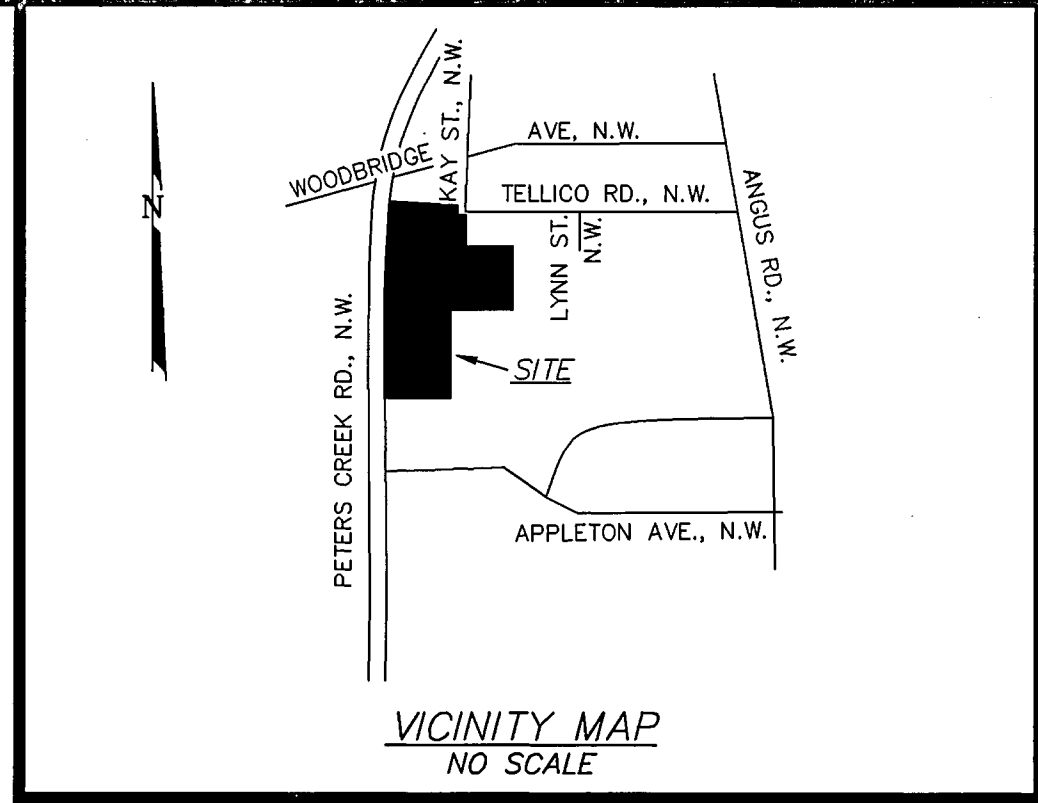
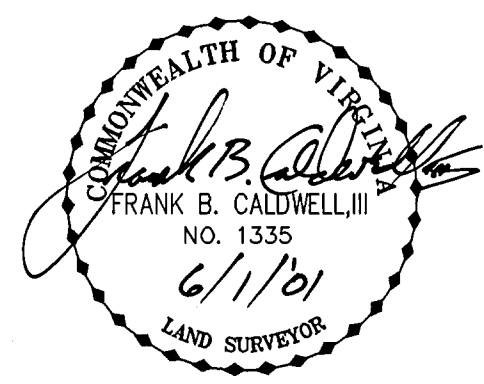
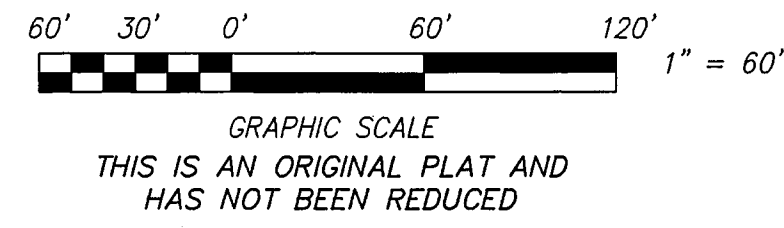

APPROVED:
John James Russell
AGENT, ROANOKE CITY PLANNING COMMISSION
Thrupp C. Edinger
CITY ENGINEER, ROANOKE VIRGINIA

6/1/2001
DATE
6/1/01
DATE

RESUBDIVISION PLAT
FOR
LOYD D. SHIFFER &
KATHY L. SHIFFER
SHOWING THE COMBINATION OF LOTS
CONVEYED TO LOYD D. SHIFFER & KATHY L. SHIFFER
IN INS# 000011413, INS #990018355,
INS# 990008055, D.B. 1651, PG. 1802,
AND D.B. 1651, PG. 1794
CREATING HEREON
NEW LOT 1 (9.1218 AC.)
SITUATE ON PETERS CREEK ROAD, N.W.
CITY OF ROANOKE, VIRGINIA

CWA
CALDWELL WHITE ASSOCIATES
ENGINEERS / SURVEYORS / PLANNERS

1054 OLD COUNTRY CLUB ROAD
P.O. BOX 6340
ROANOKE, VIRGINIA 24017
(540) 342-7094
FAX: (540) 981-0699

Calculated: M.L. Lipscomb
Drawn: M.L. Lipscomb
Checked: F.B. Caldwell, III
Dated: April 6, 2001

Scale: 1" = 60'
Tax Parcel: 6380101-104
& 6370306
Field Book: WES-7
W.O. No.: 01-0019