

SQUARE FEET PER UNIT

UNIT	FLOOR	SQUARE FEET
1	1	4,671
2	1	85
2	2	5,745
2 TOTAL		5,830
3	1	680
3	2	120
3	3	1,844
3 TOTAL		2,644

SQUARE FEET PER FLOOR

UNIT	FLOOR	SQUARE FEET
1	1	4,671
2	1	85
3	1	680
C.E. & L.C.E.		1,622
TOTAL		7,058
2	2	5,745
3	2	120
C.E. & L.C.E.		1,193
TOTAL		7,058
3	3	1,844
L.C.E.(DECK & WALK)		712
L.C.E.(ELEVATOR)		72
C.E.		298
TOTAL		2,926

LEGEND

P PROPERTY LINE
sq. ft. SQUARE FEET

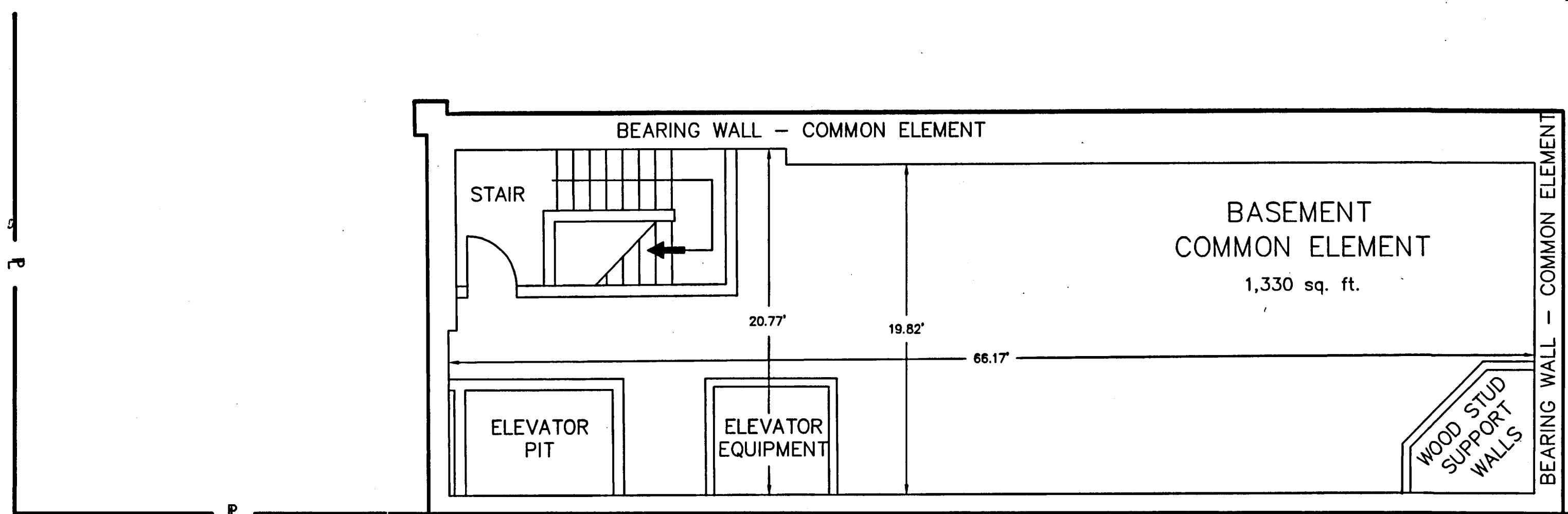

CHURCH AVENUE, S.E.

MARKET STREET, S.E.

THIS PLAT DOES NOT CONSTITUTE A
SUBDIVISION UNDER THE CITY OF
ROANOKE SUBDIVISION ORDINANCE.

BASEMENT

**PLAN OF
MARKET & CHURCH CONDOMINIUMS**

PROPERTY OF
MARKET & CHURCH LLC
SITUATE ON CORNER OF CHURCH AVE., S.E. &
MARKET ST., S.E.
ROANOKE, VIRGINIA

TAX # 401-1316
CALC: LRD
DRAWN: Z/LRD/9

SCALE: 1" = 6'
DATE: JUNE 8, 2001
W.O. 00-0318
N.B. JR-183

TPP&S T. P. PARKER & SON
ENGINEERS 816 Boulevard
SURVEYORS Post Office Box 39
PLANNERS Salem, Virginia 24163

SHEET 1 OF 5
M.B. _____, PG. _____

SURVEYOR'S CERTIFICATE:

I, JOHN T. PARKER, A LICENSED LAND SURVEYOR IN THE COMMONWEALTH OF VIRGINIA, HEREBY CERTIFY THAT THIS PLAN, SHEETS 1 THRU 5, ACCURATELY SHOWS THE UNITS DELINEATED AND COMPLIES WITH THE PROVISIONS OF SECTION 55-79.58 PARAGRAPH (B) OF CONDOMINIUM ACT. I FURTHER CERTIFY THAT UNLESS NOTED OTHERWISE ALL UNITS DEPICTED HEREON HAVE BEEN SUBSTANTIALLY COMPLETED.

GIVEN UNDER MY HAND THIS 8th DAY OF June, 2001.

John T. Parker
JOHN T. PARKER, P.E., L.S.

IN THE DECK'S OFFICE OF THE CIRCUIT COURT of the city of
Roanoke, VA. These maps were presented with the Certificate
of Acknowledgment thereto Attached Admitted TO Record
At 11:51 A.M. on this 5th day of July, 2001.

TESTE: *Anthony Bluebird*
By Anthony Taylor

