

KNOW ALL MEN BY THESE PRESENTS TO WIT:

THAT DANIEL J. WYNNE AND WENDY D. WYNNE ARE THE OWNERS OF A TRACT OF LAND BOUNDED BY OUTSIDE CORNERS 1, 2, 8, 9, 10, 11, 6, 7 TO 1 INCLUSIVE CONTAINING A TOTAL OF 0.620 ACRE BEING KNOWN AS LOT 3A, LUTHER B. LOWE, SR. MAP RECORDED IN THE CLERK'S OFFICE OF THE CIRCUIT COURT OF THE CITY OF ROANOKE, VIRGINIA IN MAP BOOK 1, PAGES 2138 AND 2139, BEING ALL OF THE PROPERTY CONVEYED TO SAID OWNER BY LORNA M. HALL BY DEED DATED JULY 11, 2002 AND RECORDED IN THE AFORESAID CLERK'S OFFICE AS INSTRUMENT NO. 020012544.

THAT LORNA M. HALL IS THE OWNER OF A TRACT OF LAND BOUNDED BY OUTSIDE CORNERS 3, 4, 5, 6, 11, 10, 9, 8 TO 3 INCLUSIVE, CONTAINING A TOTAL OF 0.981 ACRE AND BEING KNOWN LOT 4A, LUTHER B. LOWE, SR. MAP, BEING ALL OF THE PROPERTY CONVEYED TO SAID OWNER BY LUTHER B. LOWE, SR. BY BARBARA B. BATTLE, HIS ATTORNEY-IN-FACT, AND BANK OF AMERICA, N.A., SUCCESSOR BY MERGER TO NATIONSBANK OF VIRGINIA, N.A. TRUSTEE OF THE REBETH B. LOWE REVOCABLE TRUST UNDER AGREEMENT DATED FEBRUARY 28, 1994 BY DEED DATED OCTOBER 25, 2000 AND RECORDED IN THE AFORESAID CLERK'S OFFICE AS INSTRUMENT NO. 000014495.

THE SAID OWNERS HEREBY CERTIFY THAT THEY HAVE RESUBDIVIDED THE LAND INTO LOTS AS SHOWN HEREON ENTIRELY OF THEIR OWN FREE WILL AND ACCORD AS REQUIRED BY SECTIONS 15.2-2240 THRU 15.2-2276 OF THE 1950 CODE OF VIRGINIA AS AMENDED TO DATE AND THE CITY OF ROANOKE SUBDIVISION ORDINANCE AS AMENDED TO DATE AND VACATE LINES 3-8-9-10-11-12 SHOWN DOTTED HEREON.

WITNESS THE SIGNATURES AND SEALS OF THE SAID OWNERS.

Lorna M. Hall 9/3/02
LORNA M. HALL, OWNER
INST. NO. 000104495

Daniel J. Wynne 8-29-02 Wendy D. Wynne 8/29/02
DANIEL J. WYNNE, OWNER
INST. NO. 020012544

STATE OF VIRGINIA City of Roanoke
OF Roanoke
TO WIT:

Lynn C. Lusk, A NOTARY PUBLIC IN AND FOR THE AFORESAID STATE DO HEREBY CERTIFY THAT LORNA M. HALL, WHOSE NAME IS SIGNED TO THE FOREGOING WRITING HAS PERSONALLY APPEARED BEFORE ME AND ACKNOWLEDGED THE SAME IN MY AFORESAID JURISDICTION ON THIS 3rd DAY OF September, 2002.

MY COMMISSION EXPIRES:

11-30-05
Lynn C. Lusk
NOTARY PUBLIC

STATE OF VIRGINIA City of Roanoke
OF Roanoke
TO WIT:

Lynn C. Lusk, A NOTARY PUBLIC IN AND FOR THE AFORESAID STATE DO HEREBY CERTIFY THAT DANIEL J. WYNNE AND WENDY D. WYNNE, WHOSE NAMES ARE SIGNED TO THE FOREGOING WRITING HAVE PERSONALLY APPEARED BEFORE ME AND ACKNOWLEDGED THE SAME IN MY AFORESAID JURISDICTION ON THIS 29th DAY OF August, 2002.

MY COMMISSION EXPIRES:

11-30-05
Lynn C. Lusk
NOTARY PUBLIC

IN THE CLERK'S OFFICE OF THE CIRCUIT COURT OF THE CITY OF ROANOKE, VIRGINIA THIS MAP WAS PRESENTED WITH THE CERTIFICATE OF ACKNOWLEDGMENT, THERETO ATTACHED ADMITTED TO RECORD AT 9:30 O'CLOCK A.M. ON THIS 1st DAY OF November, 2002.

TESTE: ARTHUR B. CRUSH, III
CLERK

BY: Sandra Powell
DEPUTY CLERK

APPROVED:

[Signature] Oct 29, 2002
AGENT - CITY OF ROANOKE
PLANNING COMMISSION

[Signature] 10/29/02
CITY ENGINEER - CITY OF
ROANOKE

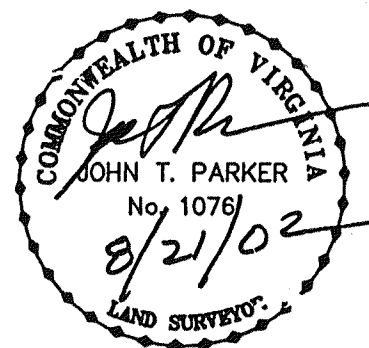

GENERAL NOTES:

1. THIS PLAT WAS PREPARED WITHOUT BENEFIT OF A TITLE REPORT AND IS SUBJECT THERETO. THEREFORE, THERE MAY EXIST ENCUMBRANCES WHICH AFFECT THE PROPERTY NOT SHOWN HEREON.
2. THE SUBJECT PROPERTY IS WITHIN THE LIMITS OF ZONE "X" AS SHOWN ON THE FEMA FLOOD INSURANCE RATE MAP NO. 51161C0044 D, EFFECTIVE DATE OCTOBER 15, 1993. THIS DETERMINATION IS BASED ON SAID MAP AND HAS NOT BEEN VERIFIED BY ACTUAL FIELD ELEVATIONS.
3. PIN SET BY TPP&S IS 1/2" DIAMETER BY 18" LONG REINFORCING ROD DRIVEN TO 2 INCHES ABOVE GROUND WITH PLASTIC YELLOW CAP ON TOP WITH "T.P. PARKER PROP. COR" EMBOSSED. A 3-4 FOOT METAL FENCE POST IS DRIVEN BESIDE CORNER PIN.

REFERENCE MAPS:

1. PLAT MADE FOR AND SHOWING SURVEY PROPERTY OF DR. LUTHER B. LOWE BY C. B. MALCOLM & SON DATED MAY 9, 1958 AND REVISED JULY 1, 1958 AND RECORDED IN D.B. 1035, PG. 352.
2. PLAT BEING A RESUBDIVISION OF PART OF BLOCK 10, CORBIESHAW, CORBIESHAW WOOD DATED JANUARY, 1948 AND RECORDED IN D.B. 767, PG. 406.
3. REVISED PLAT SHOWING NEW DIVISION LINES THROUGH PROPERTY OF LUTHER B. LOWE BY C. B. MALCOLM & SON DATED JUNE 1, 1955.
4. MAP OF SECTION 1, GREENWOOD FOREST BY DAVID DICK, S.C.E. & S. DATED OCTOBER 1, 1954 AND RECORDED IN P.B. 3, PG. 138.
5. RESUBDIVISION FOR LUTHER B. LOWE, SR. BY T. P. PARKER & SON DATED AUGUST 16, 2000 AND RECORDED IN M.B. 1, PGS. 2138 & 2139.

BOUNDARY NOTE:

THIS PLAT RESUBDIVIDES EXISTING TAX PARCEL NO. 165-0903, LOT 4A AND EXISTING TAX PARCEL NO. 165-J946, LOT 3A, LUTHER B. LOWE, SR. MAP AND CREATES HEREON LOT 3B (0.498 ACRE) AND LOT 4B (1.103 ACRE).

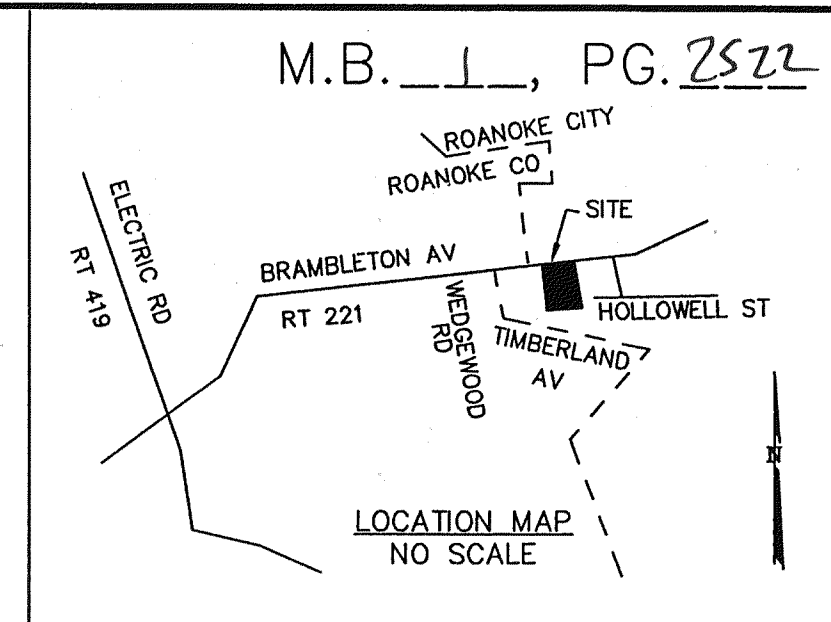

COORDINATES

CORNER	NORTHING	EASTING
1	4733.54	4493.42
2	4774.96	4543.11
3	4802.39	4576.02
4	4904.00	4697.92
5	4630.10	4884.29
6	4604.48	4762.35
12	4591.22	4699.24
7	4571.58	4605.77
1	4733.54	4493.42

THESE COORDINATES ARE BASED ON AN ASSUMED DATUM.

RESUBDIVISION FOR

LORNA M. HALL

AND

DANIEL J. & WENDY D. WYNNE

OF LOT 3A (0.620 ACRE) AND LOT 4A (0.981 ACRE)
LUTHER B. LOWE, SR. MAP
M.B. 1, PGS. 2133 & 2139

CREATING HEREON LOT 3B (0.498 ACRE) AND
LOT 4B (1.103 ACRE)

SITUATE ON BRAMBLETON AVENUE, S.W.
ROANOKE, VIRGINIA

TAX # 165-0903
165-0946
DRAWN: Z/LRD/12
N.B. 3-193

SCALE: 1" = 30'
DATE: AUGUST 21, 2002
W.O. 02-0420



TPP&S T. P. PARKER & SON
ENGINEERS 816 Boulevard
SURVEYORS Post Office Box 39
PLANNERS Salem, Virginia 24153

SHEET 1 OF 2
M.B. 1, PG. 2522