

KNOW ALL MEN BY THESE PRESENT, TO WIT:

THAT WE THE UNDERSIGNED, CERTIFY THAT WE ARE THE FEE SIMPLE OWNERS OF THE PROPERTIES SHOWN ON THIS PLAT TO BE SUBDIVIDED. WE FURTHER CERTIFY THAT L.M.W.,P.C. SURVEYED AND MADE THIS PLAT OF SURVEY AT OUR DIRECTION AND THAT THE ENTIRE SUBDIVISION IS WITHIN THE BOUNDARIES OF THE TRACT OF LAND CONVEYED TO UNIFIED HUMAN SERVICES AS BOUNDED BY CORNERS 1 TO 4, INCLUSIVE. BY DEED RECORDED IN INSTRUMENT #000016926 OF THE CITY OF ROANOKE, VIRGINIA.

THE SAID OWNERS CERTIFY THAT THEY HAVE SUBDIVIDED OR COMBINED THIS LAND, AS SHOWN HEREON, ENTIRELY OF THEIR OWN FREE WILL AND CONSENT AND PURSUANT TO AND IN COMPLIANCE WITH THE VIRGINIA CODE OF 1950, SECTION 15.2-2240 THROUGH 15.2-2276 AS TO DATE, AND FURTHER PURSUANT TO AND IN COMPLIANCE WITH THE CITY OF ROANOKE LAND SUBDIVISION ORDINANCES, AS AMENDED TO DATE.

IN WITNESS WHEREOF, IS HEREBY PLACED THE FOLLOWING SIGNATURE AND SEALS OF THIS 8th DAY OF May, 20

Curtis A. Andrews, Exe. Director 5/8/03
UNIFIED HUMAN SERVICES, (REPRESENTATIVE) DATE

STATE OF VIRGINIA
City OF Roanoke

I, Judith A. Marmaduke NOTARY PUBLIC IN AND FOR THE AFORESAID City AND STATE DO HEREBY CERTIFY THAT Curtis A. Andrews, Exe. Director OWNER, WHOSE NAME IS SIGNED TO FOREGOING WRITING

DATED May 8, 2003 DID PERSONALLY APPEAR BEFORE ME IN MY AFORESAID City AND STATE AND ACKNOWLEDGED THE SAME ON May 8, 2003.

MY COMMISSION EXPIRES August 31, 2006
Judith A. Marmaduke
NOTARY PUBLIC

IN THE CLERK'S OFFICE OF THE CIRCUIT COURT OF THE CITY OF ROANOKE, VIRGINIA, THIS PLAT WAS PRESENTED ON THIS 9th DAY OF May, 2003 AND WITH THE CERTIFICATES OF DEDICATION AND ACKNOWLEDGEMENTS, THERETO ANNEXED IS ADMITTED TO RECORD AT 9:45 O'CLOCK A.M.

TESTEE: James B. Miller
Deputy Clerk

NOTES:

1. THIS SURVEY WAS PERFORMED WITHOUT THE BENEFIT OF A TITLE SEARCH AND THEREFORE MAY NOT SHOW ALL ENCUMBRANCES.
2. THIS PROPERTY AS PLATTED DOES NOT FALL WITHIN THE 100 YEAR FLOOD ZONE.
3. THIS PLAT WAS PREPARED FROM AN ACTUAL AND CURRENT FIELD SURVEY.
4. ANY PHYSICAL IMPROVEMENTS NOT DIMENSIONED, SHALL NOT BE SCALED.
5. FEMA FLOOD ZONE: "X"
6. LEGAL REFERENCE: INST. #000016962
"RUNNYMEDE CORP" CITY FILE #1680
MB 1, PG 1455
TAX #2410301-2410306
FIRM MAP #51161C0042D
DATE: OCTOBER 15, 1993

APPROVED:

John R. J. J. J. 5/8/2003
AGENT CITY OF ROANOKE PLANNING COMMISSION DATE

Theresa C. Scriver 5.8.03
CITY OF ROANOKE - CITY ENGINEER DATE

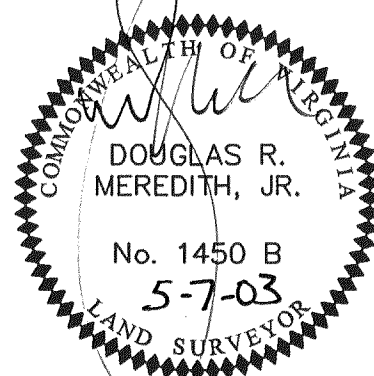

DATE: 5-7-03

I HEREBY CERTIFY THIS PLAT OF SURVEY TO BE CORRECT TO THE BEST OF MY KNOWLEDGE AND BELIEF.

NOTE: THIS IS AN ORIGINAL DRAWING AND HAS NOT BEEN REDUCED.

COORDINATE LIST		
POINT	NORTHING	EASTING
1	3813509.202	10988921.972
2	3813504.271	10989230.209
3	3813350.542	10989227.750
4	3813380.328	10988996.578
1	3813509.202	10988921.972

MB 1 PG 1455

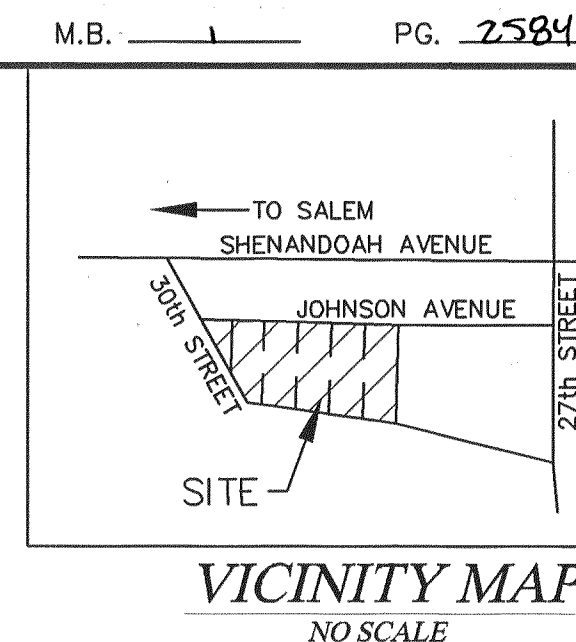

NOTE: PUBLIC WATER AND SEWER IS AVAILABLE AT THIS SITE.

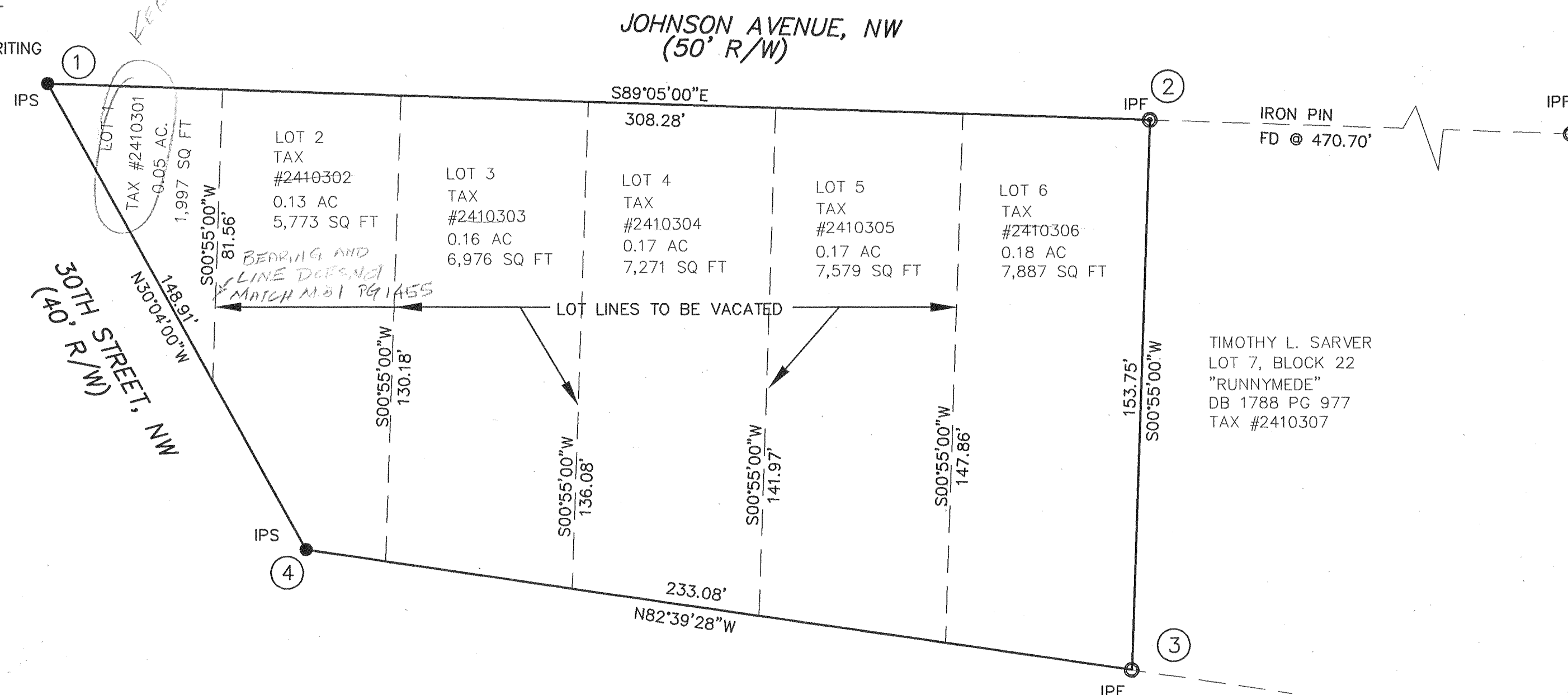

NORFOLK AND WESTERN RAILWAY

COMBINATION PLAT FOR

UNIFIED HUMAN SERVICES
SHOWING
THE VACATION OF
LOT LINES
BETWEEN LOTS 1-7, BLOCK 22
"RUNNYMEDE CORP."
(CITY FILE # 1680)
CREATING A NEW LOT "1-A"
0.86 ACRE PARCEL
SITUATED ON JOHNSON AVENUE
LOCATED IN
THE CITY OF ROANOKE,
VIRGINIA

COMM. 2674 SURVEYED: APRIL 1, 2003

LMW P.C.
ENGINEERING • ARCHITECTURE • SURVEYING
(540) 345-0675 102 ALBEMARLE AVE., S.E.
FAX (540) 342-4456 ROANOKE, VIRGINIA 24013

LEGEND

- SURVEYED PROPERTY LINE
- DEED LINE
- SET REBAR
- EXISTING IRON FOUND
- ⊙ END OF LINE/CURVE
- NOTHING FOUND, NOTHING SET

GRAPHIC SCALE
0 30
(IN FEET)
1 inch = 30 ft.

0652

M.B. 1 PG. 2584