

KNOW ALL MEN BY THESE PRESENTS, TO WIT:

THAT VISION OF FAITH MINISTRIES, INC. IS THE FEE SIMPLE OWNER OF THE TRACT OF LAND SHOWN HEREON BOUNDED BY OUTSIDE CORNERS 1 THRU 10 TO 1, INCLUSIVE, WHICH COMPRISES ALL THE LAND CONVEYED TO SAID OWNER BY INSTRUMENTS RECORDED IN THE CITY OF ROANOKE, VIRGINIA CIRCUIT COURT CLERK'S OFFICE AS INSTRUMENT NO. 030008374 AND INSTRUMENT NO. 030008375.

THE SAID OWNER HEREBY CERTIFIES THAT THEY ARE COMBINING THE TRACT OF LAND SHOWN HEREON ENTIRELY WITH THEIR OWN FREE WILL AND ACCORD AS REQUIRED BY SECTION 15.2-2240 THRU 15.2-2279 OF THE 1950 CODE OF VIRGINIA, AS AMENDED TO DATE, AND FURTHER PURSUANT TO AND IN COMPLIANCE WITH THE CITY OF ROANOKE LAND SUBDIVISION ORDINANCE.

IN WITNESS WHEREOF IS HEREBY PLACED THE FOLLOWING SIGNATURE:

Shadrack Brown, Jr. 6-20-03
SHADRACK BROWN, PRESIDENT DATE
VISION OF FAITH MINISTRIES, INC.

STATE OF VIRGINIA

County of Roanoke TO WIT:

I, Loretta Kaffer, A NOTARY PUBLIC IN AND FOR THE AFORESAID County AND STATE, HEREBY CERTIFY THAT SHADRACK BROWN, JR. APPEARED BEFORE ME AND HAS ACKNOWLEDGED THE FOREGOING INSTRUMENT ON THIS 20 DAY OF June, 2003.

Loretta W. Kaffer April 30, 2004
NOTARY PUBLIC MY COMMISSION EXPIRES

NOTES:

- 1) THIS MAP IS SUBJECT TO INFORMATION WHICH MAY BE DISCLOSED BY A TITLE REPORT BY A LICENSED ATTORNEY.
- 2) THE SUBJECT PROPERTY IS LOCATED IN UNSHADED FLOOD INSURANCE ZONE "X" AS DESIGNATED BY F.E.M.A. SEE FLOOD INSURANCE RATE MAP NO. 51161C0042 D, EFFECTIVE DATE OCT. 15, 1993.
- 3) THIS PLAT IS BASED ON "MAP OF TOPOGRAPHIC SURVEY MADE FOR TRUSTEES OF GARDEN OF PRAYER NO. 7 CHURCH OF GOD IN CHRIST, AND TRUSTEES OF VISION OF FAITH MINISTRIES" BY DAVID A. BESS. L.S., DATED SEPT. 10, 2001.
- 4) THE SUBJECT PROPERTY IS ZONED RM-2.

APPROVED:

Thrup C. Scurie 7-14-03
CITY ENGINEER, CITY OF ROANOKE, VA. DATE

John Thomas Paschke 7/14/2003
AGENT, CITY OF ROANOKE PLANNING DATE
COMMISSION

IN THE CLERK'S OFFICE OF THE CIRCUIT COURT IN THE CITY OF ROANOKE, VIRGINIA THIS MAP IS PRESENTED AND WITH THE CERTIFICATE OF ACKNOWLEDGEMENT THERETO ANNEXED IS ADMITTED TO RECORD AT 11:33 O'CLOCK A.M., ON THIS 15th DAY OF July, 2003.

TESTE: ARTHUR B. CRUSH, III, CLERK

BY: Arthur B. Crush, III
DEPUTY CLERK

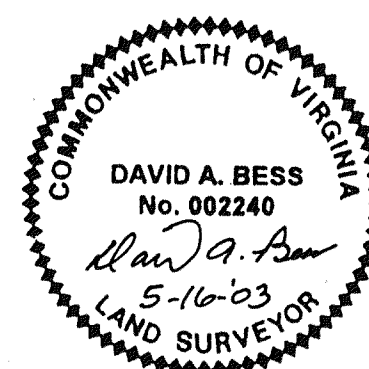

NOTE: THE ORIGINAL SCALE OF THIS PLAT HAS NOT BEEN REDUCED.

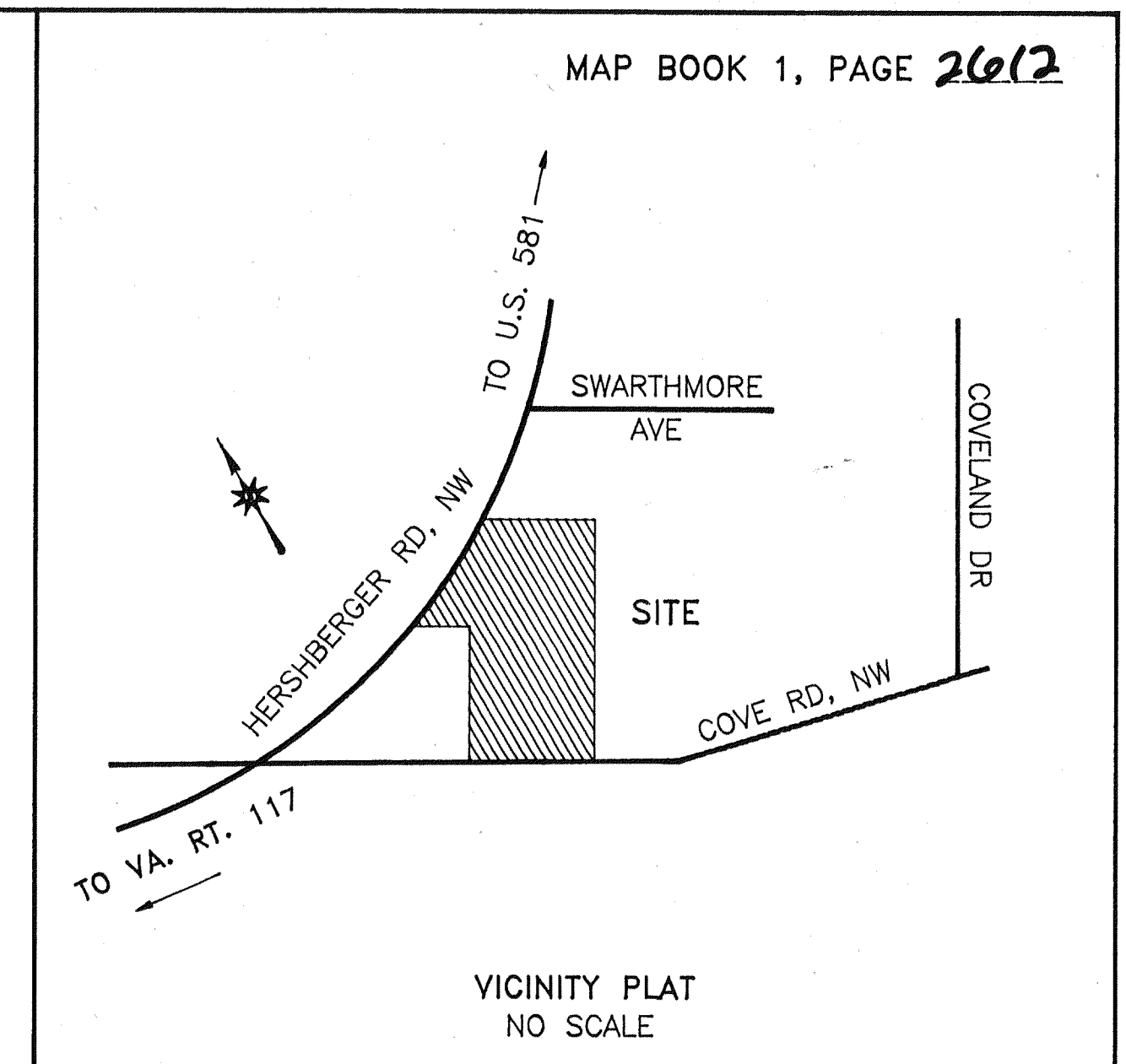

PAGE 1 OF 2
PLAT OF COMBINATION MADE FOR
VISION OF FAITH MINISTRIES, INC.

SHOWING THE COMBINATION OF TRACT "A-1" (1.360 ACRES), TRACT "A-2" (2.471 ACRES), TRACT "C" (0.441 ACRE), AND A 1.633 ACRE TRACT, GLADIES M. MOOMAW MAP (D.B. 1161, PG. 71), CREATING HEREON NEW LOT 1 (5.905 ACRES) LOCATED ON THE NORTH SIDE OF COVE ROAD, N.W. AND THE SOUTH SIDE OF HERSHBERGER ROAD, N.W.

ROANOKE, VIRGINIA

SCALE: 1" = 50' MAY 16, 2003

BY: DAVID A. BESS, L.L.C.
LAND SURVEYING
3100A PETERS CREEK RD.
ROANOKE, VA. 24019

MAP BOOK 1, PAGE 2612