

KNOW ALL MEN BY THESE PRESENTS TO WIT:

THAT GARY L. AVIS IS THE FEE SIMPLE OWNER OF THE PARCEL OF LAND SHOWN HEREON BOUNDED BY CORNERS 1 THRU 4 TO 1, INCLUSIVE, AND BEING ALL OF THE LAND CONVEYED TO SAID OWNER BY INSTRUMENT RECORDED IN THE CLERK'S OFFICE OF THE CIRCUIT COURT OF THE CITY OF ROANOKE, VIRGINIA BY INSTRUMENT NUMBER 030023296.

THE SAID OWNER HEREBY CERTIFIES THAT THE PLAT OF THE LAND AS SHOWN HEREON, AS REQUIRED BY SECTION 15.2-2240 AND 15.2-2279 OF THE CODE OF VIRGINIA (1950) AS AMENDED, AND THE SUBDIVISION ORDINANCE OF THE CITY OF ROANOKE, VIRGINIA; IS ENTIRELY WITH ITS OWN FREE WILL AND CONSENT AND IN ACCORDANCE WITH THE DESIRES OF THE OWNER OR PROPRIETORS OF THE LAND AND THE TRUSTEES IN ANY DEED OF TRUST, OR OTHER INSTRUMENT IMPOSING A LIEN UPON SUCH LAND, IF ANY THERE BE.

IN WITNESS WHEREON ARE HEREBY PLACED THE FOLLOWING SIGNATURES AND SEALS:

GARY L. DAVIS (OWNER)

STATE OF VIRGINIA
COMMONWEALTH AT LARGE

I, James H. Hill, A NOTARY PUBLIC IN
AND FOR THE AFORESAID STATE DO HEREBY CERTIFY THAT
Gayle Davis, WHOSE
NAME IS SIGNED TO THE FOREGOING INSTRUMENT, HAS
PERSONALLY APPEARED BEFORE ME AND ACKNOWLEDGED THE
SAME ON THIS 31 DAY OF December, 2008.

 NOTARY PUBLIC
 MY COMMISSION EXPIRES 2/28/06

GRAPHIC SCALE



(IN FEET)
1 inch = 30 ft.

APPROVED:

CITY OF ROANOKE ENGINEER

12/31/03
DATE

R. Brian Townsend 12-31-03
CITY OF ROANOKE AGENT, PLANNING COMMISSION DATE

IN THE CLERK'S OFFICE OF THE CIRCUIT COURT OF CITY OF ROANOKE,
VIRGINIA, THIS MAP WITH THE CERTIFICATE OF ACKNOWLEDGMENT
THEREO ANNEXED IS ADMITTED TO RECORD AT 11:10 O'CLOCK
A.M. ON THIS 5th DAY OF January, 2004, IN
MAP BOOK 1, PAGE 2676.

TESTE: Branda S. Hamilton
CLERK
Jarvis Romer
DEPUTY CLERK

NOTES:

1. OWNER OF RECORD: GARY L. AVIS
2. LEGAL REFERENCE: INSTRUMENT #030023296
3. ORIGINAL TAX MAP # 3410318
4. NO TITLE REPORT FURNISHED. THIS PLAT WAS PREPARED WITHOUT THE BENEFIT OF A CURRENT TITLE REPORT AND THERE MAY EXIST ENCUMBRANCES WHICH AFFECT THE PROPERTY NOT SHOWN HEREON.
5. PROPERTY IS CURRENTLY ZONED: RM-1
6. UNDERGROUND UTILITY SERVICE LINES.

THIS ORIGINAL PLAT
HAS NOT BEEN REDUCED.

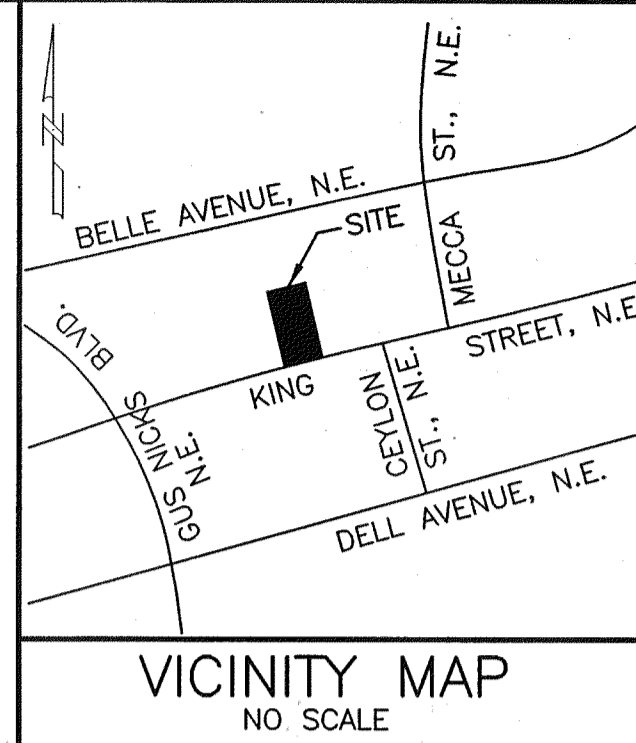
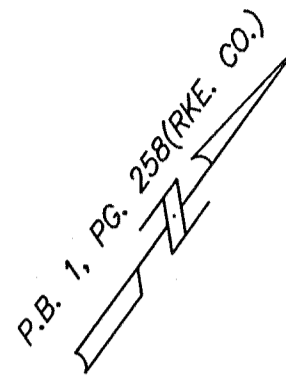

LEGEND

- — IRON PIN FOUND
○ — IRON PIN SET

COORDINATE LIST

CORNER	NORTHING	EASTING
1	4991.3044	5004.9709
2	5193.9957	4859.5011
3	5247.2862	4944.3436
4	5049.6112	5086.2132
1	4991.3044	5004.9709

I HEREBY CERTIFY THAT THIS PLAT IS FROM A CURRENT
FIELD SURVEY AND IS CORRECT TO THE BEST OF MY
KNOWLEDGE AND BELIEF.

John R. McAden
JOHN R. McADEN

002002



RESUBDIVISION PLAT FOR
GARY L. AVIS
 BEING THE RESUBDIVISION OF
 LOT 9 (0.566 ACRE)
 SECTION 12
 IDLEWOOD PARK
 PLAT BOOK 1, PAGE 258 (RKE. CO.)
 CREATING HEREON
 LOT 9A (0.285 ACRE) &
 LOT 9B (0.281 ACRE)
 SITUATED ON KING STREET, N.E.
 CITY OF ROANOKE, VIRGINIA
 SURVEYED NOVEMBER 26, 2003
 JOB #R0310371.00
 SCALE: 1"=30'
 SHEET 1 OF 1

G.L.A.



THIS PROPERTY DOES NOT LIE WITHIN THE LIMITS
OF A 100 YEAR FLOOD BOUNDARY AS DESIGNATED
BY CURRENT FEMA MAPS. PROPERTY IS IN ZONE X
UNSHADED. SEE MAP #51161C0046 D (EFFECTIVE
DATE: OCT. 15, 1993)

PLANNERS ARCHITECTS ENGINEERS SURVEYORS
Balzer & Associates, Inc. 1208 Corporate Circle Roanoke Va. 24018