

THIS IS AN ORIGINAL SIZE PLAT AND HAS NOT BEEN REDUCED.

INST. NO. _____

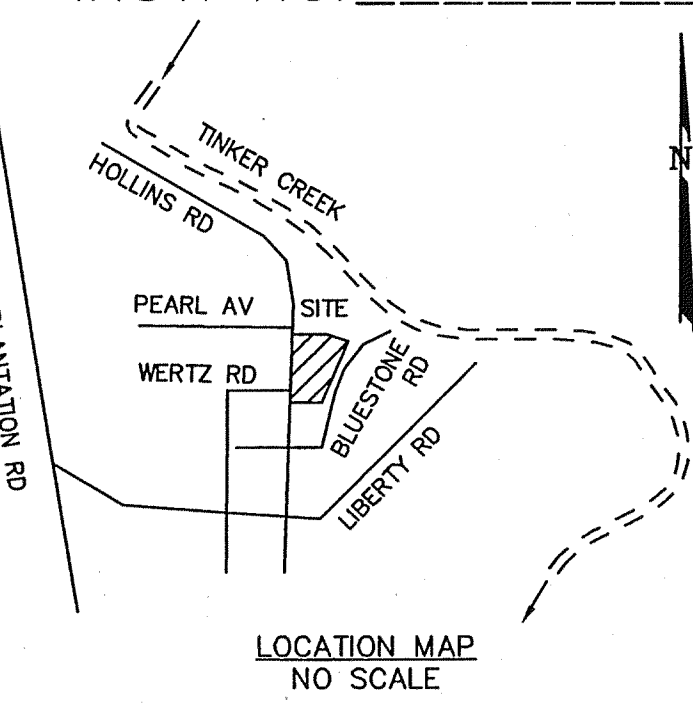

PROPERTY OF
PAMELA S. BARGER
TAX # 3140811
INST. NO. 980004484

PROPERTY OF
CITY OF ROANOKE REDEVELOPMENT
TAX # 3250232
REVISED MAP OF BLUESTONE PARK
M.B. 1, PG. 206

MERIDIAN OF
D.B. 1326, PG. 72

BLUESTONE AVE., N.E.
50' WIDE
VARIABLE WIDTH

LEGEND

-X- = EXISTING FENCE
CL = CENTERLINE
OHW = OVERHEAD WIRE
= UTILITY POLE
() = DEED METES & BOUNDS
APPROX. = APPROXIMATE

4.706 ACRES

BOUNDED BY CORNERS
1 THRU 7 TO 1 INCLUSIVE

PROPERTY OF
ROANOKE MENTAL HYGIENE
TAX # 3140817
D.B. 1354, PG. 610

LOT 9, BLOCK 1
BLUESTONE ADDITION
PROPERTY OF
ROSA MOSES BURNETT
TAX # 3250110
D.B. 1143, PG. 340

LOT 8, BLOCK 1
BLUESTONE ADDITION
PROPERTY OF
ROSA MOSES BURNETT
TAX # 3250109
D.B. 1508, PG. 65

GENERAL NOTES:

1. THIS PLAT WAS PREPARED WITH BENEFIT OF A TITLE REPORT PREPARED BY LAWYERS TITLE INSURANCE CORPORATION CASE NO. 000003216 AND IS SUBJECT THERETO.
2. THE SUBJECT PROPERTY IS WITHIN THE LIMITS OF ZONE "AE" & "X" AS SHOWN ON THE FEMA FLOOD INSURANCE RATE MAP NO 51161C0028 D, EFFECTIVE DATE OCTOBER 15, 1993. THIS DETERMINATION IS BASED ON SAID MAP AND HAS NOT BEEN VERIFIED BY ACTUAL FIELD ELEVATIONS.
3. PIN SET BY TPP&S IS 1/2" DIAMETER BY 18" LONG REINFORCING ROD DRIVEN TO 2 INCHES ABOVE GROUND WITH PLASTIC YELLOW CAP ON TOP WITH "T.P. PARKER PROP. COR" EMBOSSED. A 3-4 FOOT METAL FENCE POST IS DRIVEN BESIDE CORNER PIN.

REFERENCE MAPS:

1. SURVEY FOR E. C. BOLLING SHOWING 7.917 ACRE TRACT BEING CONVEYED BY WILLIAM R. & CATHERINE C. SILVER BY T. P. PARKER & SON DATED NOV. 10, 1980.
2. PLAT OF SURVEY SHOWING PROPERTY OF ROBERT LEWIS PAINTER, LOIS SIMMONS PAINTER AND CAROLYN S. PAINTER BY RAYMOND C. WEEKS, S.C.L.S. DATED FEB. 28, 1973 RECORDED IN D.B. 1326, PG. 72.
3. SURVEY OF BLUESTONE ADDITION BY W. LOFTON SMITH, C.P.C.E. DATED MARCH 11, 1921 RECORDED IN P.B. 1, PG. 265.
4. REVISED MAP OF BLUESTONE PARK BY BUFORD T. LUMSDEN & ASSOCIATES DATED 17, FEB. 1972 AND REVISED 2 NOV. 1972 AND RECORDED IN M.B. 1, PG. 206.

THIS BOUNDARY SURVEY DOES
NOT CONSTITUTE A SUBDIVISION
UNDER THE CITY OF ROANOKE
SUBDIVISION ORDINANCE.

BOUNDARY SURVEY FOR

SPIRIT OF LIBERTY WORSHIP CENTER

SHOWING A 4.706 ACRE TRACT
SITUATE ON HOLLINS ROAD, N.E.
VA. SEC. RTE. #115
ROANOKE, VIRGINIA

TAX # 3140812
DRAWN: Z/LRD/19
CALC: LRD
N.B. JR-230

SCALE: 1" = 40'
DATE: APRIL 28, 2004
W.O. 04-0221

IN THE CLERK'S OFFICE OF THE CIRCUIT COURT OF THE CITY OF ROANOKE, VIRGINIA THIS MAP WAS PRESENTED WITH THE CERTIFICATE OF ACKNOWLEDGMENT THERETO ATTACHED ADMITTED TO RECORD AT 2:30 O'CLOCK P.M. ON THIS 1 DAY OF June, 2004.

TESTE:
BRENDA S. HAMILTON
CLERK
BY: Patty Taylor
DEPUTY CLERK

DEED DESCRIPTION DID NOT CLOSE MATHEMATICALLY. SURVEYOR USED MONUMENTATION FOUND, WEEKS MAP AND ADJOINERS DESCRIPTIONS TO ESTABLISH THE BOUNDARY.

WERTZ RD., N.E.
40' WIDE

THIS BOUNDARY SURVEY IS BASED ON A CURRENT FIELD SURVEY. WAYNE F. PALMER IS THE OWNER OF RECORD, SEE D.B. 1432, PG. 506.

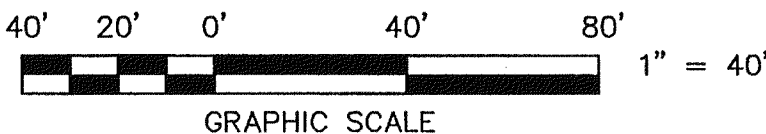
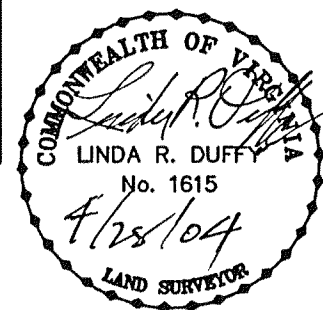

CLOSED BY LRD 4/29/04

TPP&S T. P. PARKER & SON
ENGINEERS 816 Boulevard
SURVEYORS Post Office Box 39
PLANNERS Salem, Virginia 24153
540-387-1153

M.B. 1, PG. 2740