

KNOW ALL MEN BY THESE PRESENTS TO WIT:

THAT THE CITY OF ROANOKE, VIRGINIA IS THE FEE SIMPLE OWNER OF THE PARCELS OF LAND SHOWN HEREON BOUNDED ON THE OUTSIDE BY CORNERS 1 THROUGH 14 TO 1 INCLUSIVE, CONTAINING 2.0468 ACRES AND BEING ALL THE LAND CONVEYED TO SAID OWNER BY DEED DATED AUGUST 14, 1918 AND RECORDED IN THE CLERK'S OFFICE OF THE CIRCUIT COURT OF THE CITY OF ROANOKE, VIRGINIA IN D.B. 309, PG. 28, DEED DATED OCTOBER 13, 1949 AND RECORDED IN THE CLERK'S OFFICE OF THE CIRCUIT COURT OF THE CITY OF ROANOKE, VIRGINIA IN D.B. 805, PG. 297, DEED DATED JULY 13, 1949 AND RECORDED IN THE CLERK'S OFFICE OF THE CIRCUIT COURT OF THE CITY OF ROANOKE, VIRGINIA IN D.B. 797, PG. 494, DEED DATED AUGUST 4, 1977 AND RECORDED IN THE CLERK'S OFFICE OF THE CIRCUIT COURT OF THE CITY OF ROANOKE, VIRGINIA IN D.B. 1408, PG. 197, DEED DATED MARCH 10, 1978 AND RECORDED IN THE CLERK'S OFFICE OF THE CIRCUIT COURT OF THE CITY OF ROANOKE, VIRGINIA IN D.B. 1421, PG. 653, DEED DATED JANUARY 9, 1979 AND RECORDED IN THE CLERK'S OFFICE OF THE CIRCUIT COURT OF THE CITY OF ROANOKE, VIRGINIA IN D.B. 1437, PG. 122, AND ALSO BY ORDINANCE No. 24938 DATED DECEMBER 10, 1979 AND RECORDED IN THE CLERK'S OFFICE OF THE CIRCUIT COURT OF THE CITY OF ROANOKE, VIRGINIA IN D.B. 1449, PG. 279.

THE SAID OWNER DOES HEREBY CERTIFY THAT THEY HAVE RE-SUBDIVIDED THE LAND HEREON ENTIRELY OF THEIR OWN FREE WILL AND ACCORD AS REQUIRED BY SECTION 15.2-2240 THROUGH 15.2-2279 OF THE 1950 CODE OF VIRGINIA, AS AMENDED TO DATED, AND AS REQUIRED BY THE CITY OF ROANOKE, VIRGINIA SUBDIVISION ORDINANCE AS AMENDED TO DATE.

WITNESS THE SIGNATURE AND SEAL OF SAID OWNER;

Darlene L. Burcham 7-28-04  
CITY OF ROANOKE, VIRGINIA--DARLENE L. BURCHAM, CITY MANAGER DATE  
(D.B. 309, PG. 28, D.B. 805, PG. 297, D.B. 797, PG. 494, D.B. 1408, PG. 197,) (D.B. 1421, PG. 653, D.B. 1437, PG. 122, D.B. 1449, PG. 279)

STATE OF VIRGINIA

City OF Roanoke  
TO WIT:  
I, Cecilia A. Freeman, A NOTARY PUBLIC  
IN AND FOR THE AFORESAID STATE DO HEREBY CERTIFY THAT  
Darlene L. Burcham WHOSE NAME IS SIGNED TO  
THE FOREGOING WRITING HAS PERSONALLY APPEARED BEFORE ME AND  
ACKNOWLEDGED THE SAME IN MY AFORESAID JURISDICTION ON THIS  
28th DAY OF July, 2004.  
MY COMMISSION EXPIRES February 28, 2006  
Cecilia A. Freeman  
NOTARY PUBLIC

APPROVED:  
H. Brian Townsend 7-27-04  
AGENT, ROANOKE CITY PLANNING COMMISSION DATE  
Thompson 7-27-04  
CITY ENGINEER, ROANOKE VIRGINIA DATE

IN THE CLERK'S OFFICE OF THE CIRCUIT COURT OF THE CITY OF ROANOKE, VIRGINIA. THIS MAP WAS PRESENTED WITH THE CERTIFICATE OF ACKNOWLEDGMENT THERETO ANNEXED IS ADMITTED TO RECORD ON July 29, 2004, AT 10:30 O'CLOCK A.M.

TESTE: BRENDA HAMILTON

Spedue  
DEPUTY CLERK

NOTES:

1. THIS PLAT WAS PREPARED WITHOUT THE BENEFIT OF A TITLE REPORT BY A LICENSED ATTORNEY, THEREFORE, THERE MAY EXIST ENCUMBRANCES WHICH AFFECT THE SUBJECT PROPERTY THAT MAY NOT BE SHOWN HEREON.
2. THE SUBJECT PROPERTY LIES WITHIN THE LIMITS OF ZONE "X" AS SHOWN ON THE FEMA FLOOD INSURANCE RATE MAP, 51161C0044 D, EFFECTIVE DATE OCTOBER 15, 1993.
3. REFERENCE: MAP OF THE CRYSTAL SPRING LAND COMPANY BY McILWAINE AND SMITH DATED AUGUST 1905, AND RECORDED IN P.B. 1, PG. 102, 103 (ROANOKE COUNTY CLERK OF CIRCUIT COURT OFFICE).
4. REFERENCE OF PROPERTY CONVEYANCE:
  - \* D.B. 309, PG. 28 BEING A PORTION OF TAX PARCEL 1061303 CONVEYED TO CITY OF ROANOKE, VIRGINIA
  - \* D.B. 805, PG. 297 BEING A PORTION OF TAX PARCEL 1061303 CONVEYED TO CITY OF ROANOKE, VIRGINIA
  - \* D.B. 797, PG. 494 BEING A PORTION OF TAX PARCEL 1061303 CONVEYED TO CITY OF ROANOKE, VIRGINIA
  - \* D.B. 1437, PG. 122 BEING TAX PARCEL 1061307 CONVEYED TO CITY OF ROANOKE, VIRGINIA
  - \* D.B. 1421, PG. 653 BEING TAX PARCEL 1061308 CONVEYED TO CITY OF ROANOKE, VIRGINIA
  - \* D.B. 1408, PG. 197 BEING TAX PARCEL 1061309 CONVEYED TO CITY OF ROANOKE, VIRGINIA
  - \* D.B. 1449, PG. 279 BEING ORDINANCE No. 24938 VACATION OF ALLEY CONVEYED TO CITY OF ROANOKE, VIRGINIA
5. THIS PLAT IS BASED ON A CURRENT FIELD SURVEY.

COORDINATE LIST (ASSUMED DATUM)		
1	N 5000.0000	E 5000.0000
2	N 5236.6298	E 5149.6875
3	N 5287.3362	E 5181.7634
4	N 5338.0425	E 5213.8393
5	N 5257.8528	E 5340.6052
6	N 5207.1464	E 5308.5293
7	N 5156.4401	E 5276.4535
8	N 5071.9294	E 5222.9936
9	N 5068.7218	E 5228.0643
10	N 4985.3245	E 5359.9009
11	N 4934.6181	E 5327.8250
12	N 4883.9117	E 5295.7491
13	N 4833.2054	E 5263.6732
14	N 4916.6027	E 5131.8366
1	N 5000.0000	E 5000.0000
15	N 4967.3091	E 5163.9125
16	N 5018.0154	E 5195.9884

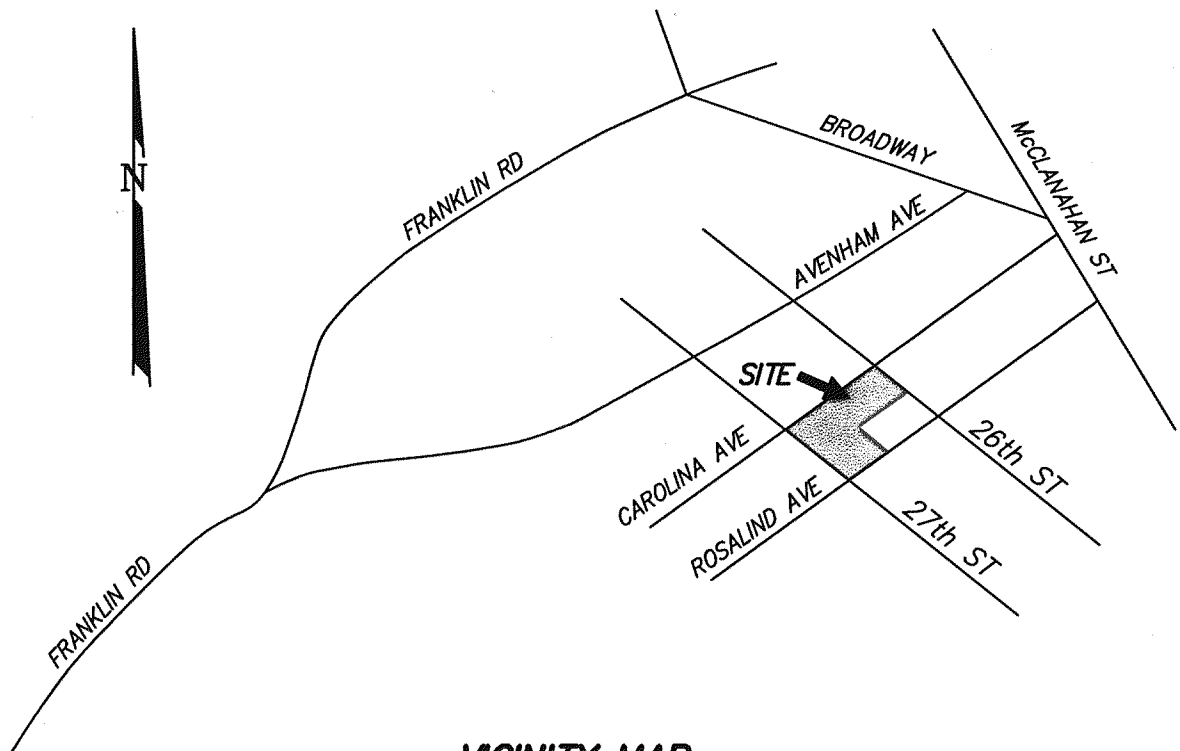

VICINITY MAP  
NO SCALE

RESUBDIVISION PLAT  
FOR  
THE SCHOOL BOARD OF THE  
CITY OF ROANOKE, VIRGINIA

SHOWING THE COMBINATION OF LOTS 1 THROUGH 7, BLOCK 35 (D.B. 309, PG. 28), LOT 8 AND HALF LOT 9, BLOCK 35 (D.B. 805, PG. 297), HALF LOT 9 & LOT 10, BLOCK 35 (D.B. 797, PG. 494), LOT 11 AND HALF LOT 12, BLOCK 35 (D.B. 1408, PG. 197), HALF LOT 12 AND LOT 13, BLOCK 35 (D.B. 1421, PG. 653), LOT 14 AND HALF LOT 15, BLOCK 35 (D.B. 1437, PG. 122) THE CRYSTAL SPRING LAND COMPANY (P.B. 1, PG. 102, 103) AND 0.0496 ACRE FROM VACATION OF ALLEY BY ORDINANCE No. 24938 DATED DECEMBER 10, 1979 (D.B. 1449, PG. 279) CREATING HEREON

LOT A (2.0468 ACRES)

SITUATE CAROLINA AVENUE, S.W. & ROSALIND AVENUE, S.W.  
CITY OF ROANOKE, VIRGINIA

**CWA**  
**CALDWELL WHITE ASSOCIATES**  
ENGINEERS / SURVEYORS / PLANNERS  
4203 MELROSE AVENUE, NW  
P.O. BOX 6260  
ROANOKE, VIRGINIA 24017  
(540) 366-3400 FAX: (540) 366-8702

TAX NO.: 1061303, 1061307, 1061308, 1061309  
DRAWN: JW  
CALC.: JW CHK'D.: FBC, III  
CLOSED: JW

SHEET 1 OF 2

SCALE: 1"= 30'  
DATE: July 6, 2004  
N.B.: CITY OF ROANOKE 2  
W.O.: 04-0079