

KNOW ALL MEN BY THESE PRESENTS TO WIT:

THAT THE CITY OF ROANOKE, VIRGINIA IS THE FEE SIMPLE OWNER OF THE PARCELS OF LAND CONTAINING 27.31 ACRES AND BEING A PORTION OF THE LAND CONVEYED TO SAID OWNER BY DEED DATED DECEMBER 16, 1935 AND RECORDED IN THE CLERK'S OFFICE OF THE CIRCUIT COURT OF THE CITY OF ROANOKE, VIRGINIA IN D.B 609, PG. 259, AND ALSO IN DEED DATED DECEMBER 16, 1935 AND RECORDED IN THE CLERK'S OFFICE OF THE CIRCUIT COURT OF THE CITY OF ROANOKE, VIRGINIA IN D.B. 609, PG. 262.

THE SAID OWNER DOES HEREBY CERTIFY THAT THEY HAVE RE-SUBDIVIDED THE LAND HEREON ENTIRELY OF THEIR OWN FREE WILL AND ACCORD AS REQUIRED BY SECTION 15.2-2240 THROUGH 15.2-2279 OF THE 1950 CODE OF VIRGINIA, AS AMENDED TO DATED, AND AS REQUIRED BY THE CITY OF ROANOKE, VIRGINIA SUBDIVISION ORDINANCE AS AMENDED TO DATE.

WITNESS THE SIGNATURE AND SEAL OF SAID OWNER;

Darlene L. Burcham 7-16-04
CITY OF ROANOKE, VIRGINIA—DARLENE L. BURCHAM, CITY MANAGER DATE
(D.B. 609, PG. 259 & D.B. 609, PG. 262)

STATE OF VIRGINIA

City OF Roanoke
I, Cecelia A. Freeman, A NOTARY PUBLIC,
IN AND FOR THE AFORESAID STATE DO HEREBY CERTIFY THAT
Darlene Burcham WHOSE NAME IS SIGNED TO
THE FOREGOING WRITING HAS PERSONALLY APPEARED BEFORE ME AND
ACKNOWLEDGED THE SAME IN MY AFORESAID JURISDICTION ON THIS
16th DAY OF July, 2004.

MY COMMISSION EXPIRES Feb. 28, 2006
Cecelia A. Freeman
NOTARY PUBLIC

APPROVED:

R. Brian Townsend 7-16-04
AGENT, ROANOKE CITY PLANNING COMMISSION DATE
Thrup C. Edm 7-16-04
CITY ENGINEER, ROANOKE VIRGINIA DATE

IN THE CLERK'S OFFICE OF THE CIRCUIT COURT OF THE CITY OF ROANOKE, VIRGINIA. THIS MAP WAS PRESENTED WITH THE CERTIFICATE OF ACKNOWLEDGMENT THERETO ANNEXED IS ADMITTED TO RECORD ON
July 28 2004, AT 9:19 O'CLOCK A.M.

TESTE: BRENDA HAMILTON

Brenda Hamilton
DEPUTY CLERK

NOTES:

1. THIS PLAT WAS PREPARED WITHOUT THE BENEFIT OF A TITLE REPORT BY A LICENSED ATTORNEY, THEREFORE, THERE MAY EXIST ENCUMBRANCES WHICH AFFECT THE SUBJECT PROPERTY THAT MAY NOT BE SHOWN HEREON.
2. THE SUBJECT PROPERTY LIES WITHIN THE LIMITS OF ZONE "AE" AS SHOWN ON THE FEMA FLOOD INSURANCE RATE MAP, 51161C0048 D, EFFECTIVE DATE OCTOBER 15, 1993.
3. REFERENCE: PLAT SHOWING PROPERTY (2.470 AC.) TO BE CONVEYED TO TRIPLE S REALTY COMPANY, A VIRGINIA GENERAL PARTNERSHIP BY GRAVES-HUMPHREYS COMPANY, DATED 16 OCTOBER 1985, BY BUFORD T. LUMSDEN & ASSOCIATES, P.C., ROANOKE, VIRGINIA.
4. REFERENCE: MAP SHOWING LANDS TO BE CONVEYED BY J.B. FISHBURN, J.P. FISHBURN AND THE CRYSTAL SPRING LAND COMPANY TO THE CITY OF ROANOKE, VIRGINIA, FOR PARK PURPOSES, CITY OF ROANOKE ENGINEERS OFFICE, PLAN NO. 2104.
5. REFERENCE OF PROPERTY CONVEYANCE:
* D.B. 609, PG. 259 & D.B. 609, PG. 262 BEING TAX PARCEL 1040401 CONVEYED TO CITY OF ROANOKE, VIRGINIA
6. UTILITY LOT A1 IS UNINHABITABLE FOR RESIDENTIAL USE AND IS TO BE USED FOR UTILITY PURPOSES ONLY.
7. THIS PLAT IS BASED ON A CURRENT FIELD SURVEY.

COORDINATE LIST (ASSUMED DATUM)		
1	N 5000.0000	E 5000.0000
2	N 4942.7167	E 5081.9672
3	N 4859.1101	E 5023.5382
4	N 4916.3935	E 4941.5710
1	N 5000.0000	E 5000.0000

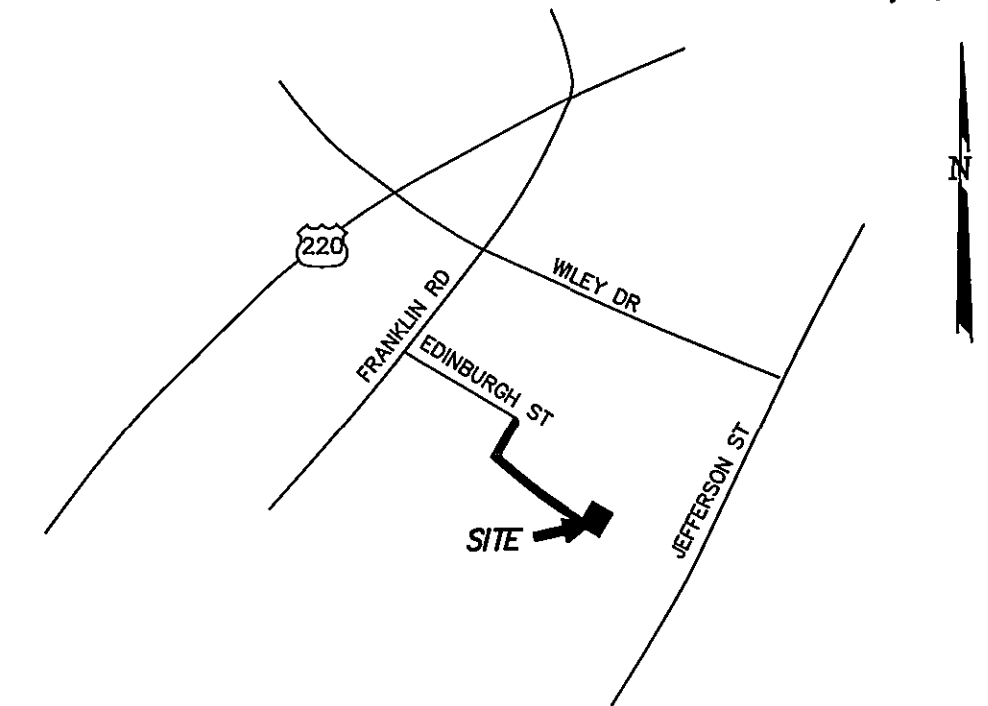

VICINITY MAP
NO SCALE

LEGEND
IPF IRON PIN FOUND
IPS IRON PIN SET
MH MANHOLE
TYP TYPICAL

**RESUBDIVISION PLAT
FOR
CITY OF ROANOKE, VIRGINIA**

SHOWING THE RESUBDIVISION OF 27.31 ACRES
(D.B. 609 PG., 262 AND D.B. 609 PG. 259)
CREATING HEREON

**LOT A — 27.0758 ACRES
UTILITY LOT A1 — 0.2342 ACRE**

SITUATE EDINBURGH STREET, S. W.
CITY OF ROANOKE, VIRGINIA

CWA
CALDWELL WHITE ASSOCIATES
ENGINEERS / SURVEYORS / PLANNERS
4203 MELROSE AVENUE, NW
P.O. BOX 6280
ROANOKE, VIRGINIA 24017
(540) 366-3400 FAX: (540) 366-8702

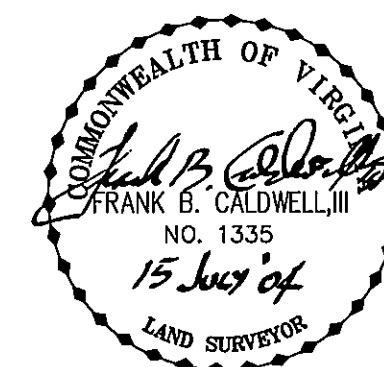

THIS IS A ORIGINAL SIZE DRAWING
THAT HAS NOT BEEN REDUCED

TAX NO.: 1040401

DRAWN: JW

CALC.: JW CHK'D.: FBC, III

CLOSED: JW

SHEET 1 OF 2

SCALE: 1"= 50'

DATE: JUNE 21, 2004

N.B.: CITY OF ROANOKE 2

W.O.: 04-0065