

KNOW ALL MEN BY THESE PRESENT, TO WIT:

THAT KEITH F. & TRACY L. HELMER ARE THE FEE SIMPLE OWNERS SHOWN HERE ON AND BEING ALL OF THE PROPERTY RECORDED IN THE OFFICE OF THE CLERK OF THE CIRCUIT COURT OF THE CITY OF ROANOKE, VIRGINIA IN INSTRUMENT #080008789 DATED 06/26/08 AND INSTRUMENT #080008830 DATE 06/26/08.

THE SAID OWNERS CERTIFY THAT THEY HAVE SUBDIVIDED THE LAND AS SHOWN HEREON ENTIRELY OF THEIR OWN FREE WILL AND ACCORD AS REQUIRED BY SECTION 15.2-2240 THRU 15.2-2279 OF THE CODE OF VIRGINIA, 1950 AS AMENDED AND SECTION 29-4.4 OF THE CITY OF ROANOKE SUBDIVISION ORDINANCE, AS AMENDED IN ACCORDANCE WITH SAID WILL.

WITNESS THE SIGNATURES AND SEAL OF THE SAID OWNERS:

Keith F. Helmer 8/8/08
KEITH F. HELMER DATE:
Tracy L. Helmer 8/18/08
TRACY L. HELMER DATE:

IN THE CLERK'S OFFICE OF THE CIRCUIT COURT OF THE CITY OF ROANOKE VIRGINIA THIS MAP PRESENTED ON THIS 18 DAY OF August 2008 AND WITH CERTIFICATE OF DEDICATION AND ACKNOWLEDGMENT THERETO ANNEXED, ADMITTED TO RECORD 4:24 O'CLOCK P.M.

TESTE: David L. Mill
CLERK

TAX NO. 4480102
RICHARD H. & GAIL G.
KEPLEY
D.B. 1392, PG. 695

TAX NO. 4280745
DANIEL R. TERSHAK &
VIVIAN H. MAO
INSTR. #050001430

TAX NO. 4280744
0.6424 ACRES
LOT 2

TAX NO. 4280743
0.7059 ACRES
LOT 1

TAX NO. 4280733
JOEL L. & TRACY L.
WILLIAMSON
INSTR. #000009468

CITY OF ROANOKE
STATE OF VIRGINIA

I, Beth L. Guillian A NOTARY PUBLIC IN AND FOR THE AFORESAID CITY AND STATE DO HEREBY CERTIFY THAT KEITH F. HELMER WHOSE NAME IS SIGNED TO THE FOREGOING WRITING DATED 8/18/08, HAS PERSONALLY APPEARED BEFORE ME IN MY CITY AND STATE AND ACKNOWLEDGED THE SAME ON THIS 18 DAY OF Aug 2008.

MY COMMISSION EXPIRES: 3-31-2012

NOTARY PUBLIC: Beth L. Guillian

REGISTRATION NO.: 243051

CITY OF ROANOKE
STATE OF VIRGINIA

I, Beth L. Guillian A NOTARY PUBLIC IN AND FOR THE AFORESAID CITY AND STATE DO HEREBY CERTIFY THAT TRACY L. HELMER WHOSE NAME IS SIGNED TO THE FOREGOING WRITING DATED 8/18/08, HAS PERSONALLY APPEARED BEFORE ME IN MY CITY AND STATE AND ACKNOWLEDGED THE SAME ON THIS 18 DAY OF Aug 2008.

MY COMMISSION EXPIRES: 3-31-2012

NOTARY PUBLIC: Beth L. Guillian

REGISTRATION NO.: 243051

APPROVAL HEREOF BY THE ROANOKE CITY SUBDIVISION AGENT IS FOR PURPOSES OF ENSURING COMPLIANCE WITH THE ROANOKE COUNTY SUBDIVISION ORDINANCE. PRIVATE MATTERS, SUCH AS COMPLIANCE WITH RESTRICTIVE COVENANTS OR OTHER TITLE REQUIREMENTS, APPLICABLE TO THE PROPERTIES SHOWN HEREON, ARE NOT REVIEWED OR APPROVED WITH REGARD TO THIS SUBDIVISION OR RE-SUBDIVISION.

NO EXISTING DWELLINGS EXIST WITHIN 10' OF THE NEW DIVISION LINES.

APPROVED: [Signature] 8/18/08
CITY OF ROANOKE SUBDIVISION AGENT, DATE:

CURVE	RADIUS	TANGENT	LENGTH	DELTA	DEGREE	CHORD	CH.BEARING
C1	325.00'	7.82'	15.84'	2°47'33"	17°37'46"	15.84'	S 32°21'00"W
C2	345.00'	16.22'	32.41'	5°22'57"	16°36'27"	32.40'	S 33°38'42"W
C3	345.00'	29.33'	58.51'	9°43'01"	16°36'27"	58.44'	S 41°11'41"W
C4	345.00'	51.40'	102.05'	16°56'53"	16°36'27"	101.68'	S 54°31'38"W
C5	525.00'	20.99'	41.95'	4°34'42"	10°54'49"	41.94'	S 65°17'27"W

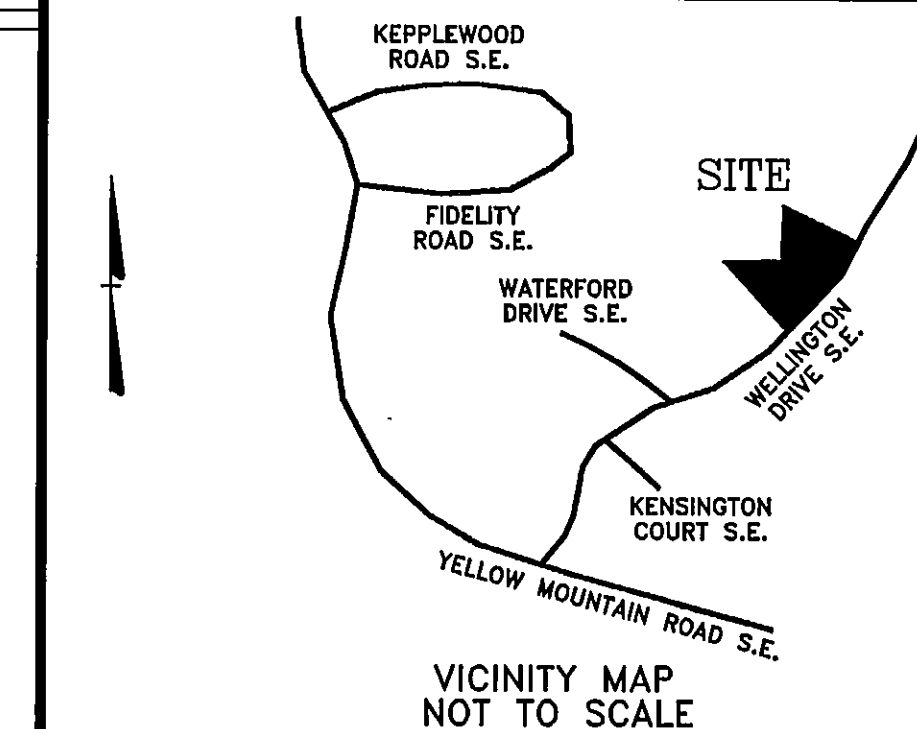

THIS SURVEY PLAT WAS PERFORMED WITHOUT THE BENEFIT OF A TITLE REPORT AND THEREFORE MAY NOT NECESSARILY INDICATE ALL ENCUMBRANCES UPON THE PROPERTY.

FLOODNOTE:

CAPTION PROPERTY IS NOT LOCATED IN A SPECIAL FLOOD HAZARD AREA SO DESIGNATED BY THE SECRETARY OF HOUSING AND URBAN DEVELOPMENT. AREA IS DESIGNATED AS FLOOD ZONE "X", AS SHOWN IN PANEL #51161C0256C DATED 09/28/07. THIS DETERMINATION IS BASED ON FEMA FLOOD INSURANCE RATE MAPS AND HAS NOT BEEN VERIFIED BY ACTUAL FIELD ELEVATIONS.

PLAT IS DRAWN FROM A CURRENT FIELD SURVEY.

THE RECORDATION OF THIS PLAT OF SUBDIVISION DOES NOT CONSTITUTE A CONVEYANCE OF LAND. ANY LOT, PARCEL OR TRACT OF LAND SHOWN HEREON THAT IS INTENDED FOR SALE AND/OR CONVEYANCE MUST BE CONVEYED BY DEED AND SAID DEED MUST BE RECORDED IN THE OFFICE OF THE CLERK OF CIRCUIT COURT OF THE CITY OF ROANOKE.

COORDINATE LIST		
CORNER	NORTHING	EASTING
1	5000.0000	5000.0000
2	5231.9532	4904.2997
3	5209.3304	5038.6483
4	5378.0418	5033.8375
5	5246.6220	5237.2583
6	5120.5127	5159.3985
1	5000.0000	5000.0000

Combination Plat For
Keith F. & Tracy L. Helmer
Combining Lots 1 and 2
Section 3, Wellington
Creating Hereon Lot 1A (1.3483 Acres)
Located Adjacent to
Wellington Drive S.E.
In The
City of Roanoke, Virginia
SCALE : 1" = 40' DATE: July 3, 2008

GRAPHIC SCALE



(IN FEET)
1 inch = 40 ft.

LEGEND:

- IP FOUND
- IP SET
- △ CALCULATED POINT

I, hereby certify that this survey to the best of my knowledge and belief, is correct and complies with the minimum standards and procedures established by the Virginia State Board of Architects, Professional Engineers, Land Surveyors and Certified Landscape Architects.

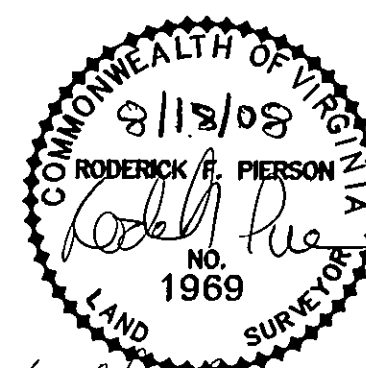

RODERICK F. PIERSON, LLS 1969