

KNOW ALL MEN BY THESE PRESENTS TO WIT:

THAT ONA M. LITWILLER, TRUSTEE OF THE ONA M. LITWILLER REVOCABLE LIVING TRUST IS THE FEE SIMPLE OWNER OF THE PARCEL OF LAND SHOWN HEREON BOUNDED BY CORNERS 1 THROUGH 4 TO 1, INCLUSIVE, AND BEING ALL OF THE LAND CONVEYED TO SAID OWNER BY INSTRUMENT RECORDED IN THE CLERK'S OFFICE OF THE CIRCUIT COURT OF THE CITY OF ROANOKE, VIRGINIA BY INSTRUMENT NUMBER 50012576.

THAT DONALD W. HUFFMAN AND COLLEEN J. HUFFMAN ARE THE FEE SIMPLE OWNERS OF THE LAND SHOWN HEREON BOUNDED BY CORNERS 4 TO 3 TO 5 THROUGH 7 TO 4, INCLUSIVE, AND IS ALL OF THE LAND CONVEYED TO SAID OWNERS BY DEED RECORDED IN THE CLERK'S OFFICE OF THE CIRCUIT COURT OF THE CITY OF ROANOKE, VIRGINIA IN DEED BOOK 1218, PAGE 211.

THE SAID OWNER HEREBY CERTIFIES THAT THE PLAT OF THE LAND AS SHOWN HEREON, AS REQUIRED BY SECTION 15.2-2240 THROUGH 15.2-2279 OF THE CODE OF VIRGINIA (1950) AS AMENDED, AND THE SUBDIVISION ORDINANCE OF THE CITY OF ROANOKE, VIRGINIA; IS ENTIRELY WITH ITS OWN FREE WILL AND CONSENT AND IN ACCORDANCE WITH THE DESIRES OF THE OWNERS OR PROPRIETORS OF THE LAND AND THE TRUSTEES IN ANY DEED OF TRUST, OR OTHER INSTRUMENT IMPOSING A LIEN UPON SUCH LAND, IF ANY THERE BE.

IN WITNESS WHEREON ARE HEREBY PLACED THE FOLLOWING SIGNATURES AND SEALS:

*Ona M. Litwiller*

ONA M. LITWILLER, TRUSTEE OF THE ONA M. LITWILLER REVOCABLE LIVING TRUST

*Donald W. Huffman*

DONALD W. HUFFMAN

*Colleen J. Huffman*

COLLEEN J. HUFFMAN

STATE OF VIRGINIA  
COMMONWEALTH AT LARGE

I, *Margaret Ann Lineberry*, A NOTARY PUBLIC IN AND FOR THE AFORESAID STATE DO HEREBY CERTIFY THAT *ONA M. LITWILLER*, WHOSE NAME IS SIGNED TO THE FOREGOING INSTRUMENT, HAS PERSONALLY APPEARED BEFORE ME AND ACKNOWLEDGED THE SAME ON THIS *27th* DAY OF *December*, 2008.

*Margaret Ann Lineberry* REG. # *7146435*  
NOTARY PUBLIC

MY COMMISSION EXPIRES *Apr 30, 2011*

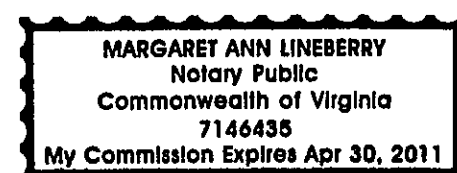

STATE OF VIRGINIA  
COMMONWEALTH AT LARGE

I, *Elesa L. Binner*, A NOTARY PUBLIC IN AND FOR THE AFORESAID STATE DO HEREBY CERTIFY THAT *DONALD W. HUFFMAN*, WHOSE NAME IS SIGNED TO THE FOREGOING INSTRUMENT, HAS PERSONALLY APPEARED BEFORE ME AND ACKNOWLEDGED THE SAME ON THIS *28th* DAY OF *December*, 2008.

*Elesa L. Binner* REG. # *155858*  
NOTARY PUBLIC

MY COMMISSION EXPIRES *6/30/2009*

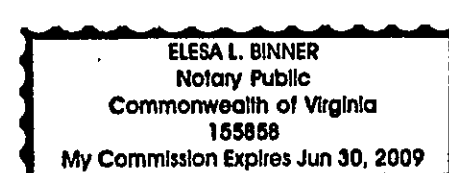

STATE OF VIRGINIA  
COMMONWEALTH AT LARGE

I, *Elesa L. Binner*, A NOTARY PUBLIC IN AND FOR THE AFORESAID STATE DO HEREBY CERTIFY THAT *COLLEEN J. HUFFMAN*, WHOSE NAME IS SIGNED TO THE FOREGOING INSTRUMENT, HAS PERSONALLY APPEARED BEFORE ME AND ACKNOWLEDGED THE SAME ON THIS *28th* DAY OF *December*, 2008.

*Elesa L. Binner* REG. # *155858*  
NOTARY PUBLIC

MY COMMISSION EXPIRES *6/30/2009*

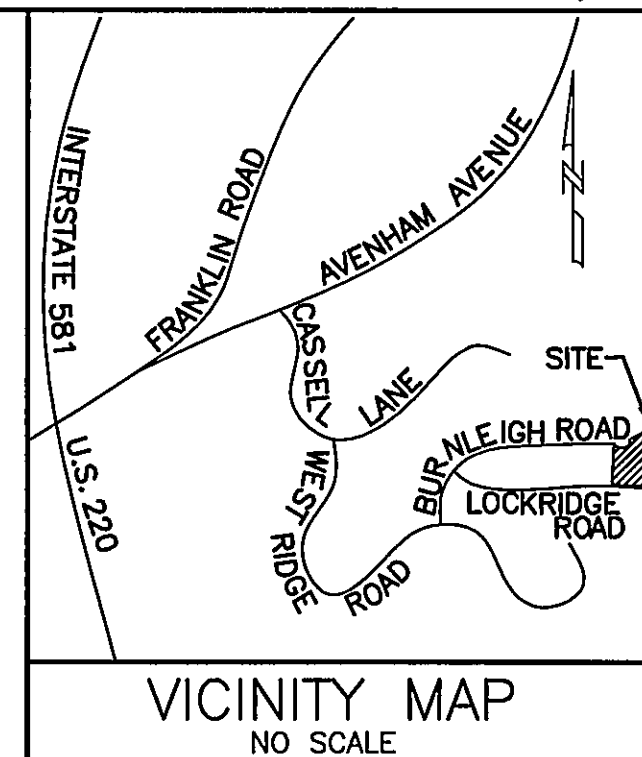
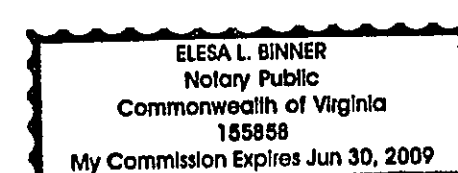

VICINITY MAP  
NO SCALE

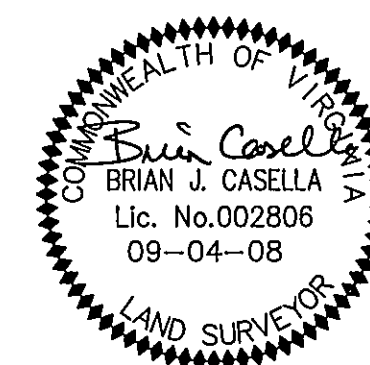

I HEREBY CERTIFY THAT THIS PLAT IS FROM A CURRENT FIELD SURVEY AND IS CORRECT TO THE BEST OF MY KNOWLEDGE AND BELIEF.

*Brian J. Casella*  
BRIAN J. CASELLA

002806

#### ACREAGE TABLE

LOT 18A
0.4685 ACRE LOT 18
- 0.0088 ACRE TO LOT 27
+ 0.0083 ACRE FROM LOT 27
= 0.4680 ACRE LOT 18A

#### ACREAGE TABLE

LOT 27A
0.3708 ACRE LOT 27
- 0.0083 ACRE TO LOT 18
+ 0.0088 ACRE FROM LOT 18
= 0.3713 ACRE LOT 27A

T.M. #1080758 COORDINATE LIST(ASSUMED)		
CORNER	NORTHING	EASTING
1	7032.2016	7901.4920
2	7092.0926	8066.3395
3	6850.9508	7992.6151
4	6991.9716	7889.2774
1	7032.2016	7901.4920

T.M. #1080758 COORDINATE LIST(ASSUMED)		
CORNER	NORTHING	EASTING
4	6991.9716	7889.2774
3	6850.9508	7992.6151
5	6867.1365	7839.9004
6	6890.0800	7793.9164
7	7004.4999	7837.3043
4	6991.9716	7889.2774

APPROVED:

*Tom Carr* *Jan. 14, 2009*  
AGENT, CITY OF ROANOKE PLANNING COMMISSION DATE

IN THE CLERK'S OFFICE OF THE CIRCUIT COURT OF CITY OF ROANOKE, VIRGINIA, THIS MAP WITH THE CERTIFICATE OF ACKNOWLEDGMENT THERETO ANNEXED IS ADMITTED TO RECORD AT *11:19* O'CLOCK *P.M.* ON THIS *14* DAY OF *JANUARY*, 2009, IN MAP BOOK *1*, PAGE *3444-3445*.

TESTE: *BRENDA S. HAMILTON*

CLERK

*Brenda S. Hamilton*  
DEPUTY CLERK

THIS PROPERTY DOES NOT LIE WITHIN THE LIMITS OF A 100 YEAR FLOOD BOUNDARY AS DESIGNATED BY CURRENT FEMA MAPS. PROPERTY IS IN ZONE X UNSHADED. SEE MAP #51161C0252G (REVISED DATE: SEPTEMBER 28, 2007)

THE RECORDATION OF THIS PLAT OF SUBDIVISION DOES NOT CONSTITUTE A CONVEYANCE OF LAND. ANY LOTS, PARCEL OR TRACT OF LAND SHOWN HEREON THAT IS INTENDED FOR SALE AND/OR CONVEYANCE MUST BE CONVEYED BY DEED AND SAID DEED MUST BE RECORDED IN THE OFFICE OF THE CLERK OF THE CIRCUIT COURT OF THE CITY OF ROANOKE.

LOT LINE ADJUSTMENT PLAT FOR  
ONA M. LITWILLER,  
DONALD W. HUFFMAN, &  
COLLEEN J. HUFFMAN  
BEING THE RESUBDIVISION OF  
LOT 18 & LOT 27  
AS SHOWN ON  
MAP OF  
SECTION NO. 5  
CHESTNUT HILLS  
MAP BOOK 1, PAGE 101  
CREATING HEREON  
LOT 18A (0.468 ACRE) &  
LOT 27A (0.371 ACRE)  
SITUATED ON  
BURNLEIGH ROAD, S.W.  
CITY OF ROANOKE, VIRGINIA  
SURVEYED SEPTEMBER 4, 2008  
JOB #R0810364.00  
SCALE: 1"=20'  
SHEET 1 OF 2



TEL: 540-772-9580 FAX: 540-772-8050  
PLANNERS ARCHITECTS ENGINEERS SURVEYORS  
Balzer & Associates, Inc. 1208 Corporate Circle Roanoke Va. 24018

• PLANNERS • ARCHITECTS  
• ENGINEERS • SURVEYORS