

KNOW ALL MEN BY THESE PRESENTS TO WIT:

THAT KEITH M. SAUNDERS IS THE FEE SIMPLE OWNER OF THE LAND SHOWN HEREON BOUNDED BY CORNERS 1 TO 4 TO 1 INCLUSIVE, AND IS ALL OF THE LAND CONVEYED TO SAID OWNER BY DEED RECORDED IN THE CLERK'S OFFICE OF THE CIRCUIT COURT OF THE CITY OF ROANOKE, VIRGINIA, IN INSTRUMENT NO. 070008227.

THE PLATTING OF THE LAND SHOWN HEREON AND THE DEDICATION OF EASEMENTS IS WITH THE FREE CONSENT AND IN ACCORDANCE WITH THE DESIRE OF THE UNDERSIGNED OWNER AS REQUIRED BY SECTION 15.2-2240 THROUGH 15.2-2279 OF THE CODE OF VIRGINIA (1950) AS AMENDED, AND THE SUBDIVISION ORDINANCE OF THE CITY OF ROANOKE, VIRGINIA.

Keith M. Saunders
KEITH M. SAUNDERS

SHIRLEEN RICHARDSON
NOTARY PUBLIC
COMMONWEALTH OF VIRGINIA
MY COMMISSION EXPIRES DEC. 31, 2012
COMMISSION # 165282

STATE OF VIRGINIA
COMMONWEALTH AT LARGE:

I, *Shirleen Richardson*, A NOTARY PUBLIC IN AND FOR THE AFORESAID STATE, DO HEREBY CERTIFY THAT *Keith M. Saunders*, WHOSE NAME IS SIGNED TO THE FOREGOING INSTRUMENT, HAS PERSONALLY APPEARED BEFORE ME AND ACKNOWLEDGED THE SAME ON THIS *20th* DAY OF *July*, 2009.

Shirleen Richardson
NOTARY PUBLIC
MY COMMISSION EXPIRES *12-31-2012*
REGISTRATION # *165282*

[Signature] 7/20/09
AGENT FOR THE CITY OF ROANOKE, VIRGINIA PLANNING COMMISSION DATE

CLERK'S STATEMENT:

IN THE CLERK'S OFFICE FOR THE CIRCUIT COURT OF ROANOKE, VIRGINIA THIS MAP WAS PRESENTED AND WITH THE CERTIFICATION OF ACKNOWLEDGMENT THERETO ANNEXED, TO RECORD AT *2:20* O'CLOCK *P.*M. ON THIS THE *20th* DAY OF *July*, 2009 AND RECORDED IN MAP BOOK *1*, PAGE *3501A*

BY: *Brenda S. Hamilton*
CLERK

[Signature]
DEPUTY CLERK

THIS PLAT HAS BEEN PREPARED WITHOUT THE BENEFIT OF A TITLE REPORT AND DOES NOT NECESSARILY INDICATE ALL ENCUMBRANCES ON THE PROPERTY.

I HEREBY CERTIFY THAT THIS PLAT IS FROM A CURRENT FIELD SURVEY AND IS CORRECT TO THE BEST OF MY KNOWLEDGE AND BELIEF.

Ronald R. Clark
RONALD R. CLARK, L.S.

THE RECORDATION OF THIS PLAT OF SUBDIVISION DOES NOT CONSTITUTE A CONVEYANCE OF LAND. ANY LOT, PARCEL OR TRACT OF LAND SHOWN HEREON THAT IS INTENDED FOR SALE AND/OR CONVEYANCE MUST BE CONVEYED BY DEED AND AND SAID DEED MUST BE RECORDED IN THE OFFICE OF THE CLERK OF THE CIRCUIT COURT OF THE CITY OF ROANOKE.

THIS PROPERTY DOES NOT LIE WITHIN THE LIMITS OF A 100-YEAR FLOOD BOUNDARY AS DESIGNATED BY CURRENT F.E.M.A. MAPS, MAP 51161C 0167 G DATED SEPT. 28, 2007.

KEITH SAUNDERS
TM. 3330602
INSTR. 070008227

KEITH SAUNDERS
TM. 3320101
INSTR. 070008228

LOT 2-A
0.5136 ACRES
22,372 sq. ft.
TM. 3320111

LOT 2-B
0.1377 ACRES
6000 sq. ft.
TM. 3320102

FRANCES D. MILLS
TM. 3320110
INSTR. 040004004

WEST PART OF LOT 2, BLOCK 14
ORG. TAX # 3320111
ORG. 14188 sq. ft.

MID PART OF LOT 2, BLOCK 14
ORG. TAX # 3320102
ORG. 14188 sq. ft.

BELLE AVENUE N.E.
40' R/W

S 62°23'00" W 303.10'

S 62°23'00" W 123.00'

S 62°23'00" W 50.00'

S 27°37'00" E 120.00'

S 27°37'00" E 164.00'

N 27°37'00" W 120.00'

N 27°37'00" W 164.00'

N 62°23'00" E 173.00' (86.50')

(86.50')

PLAT BOOK 1, PAGE 258

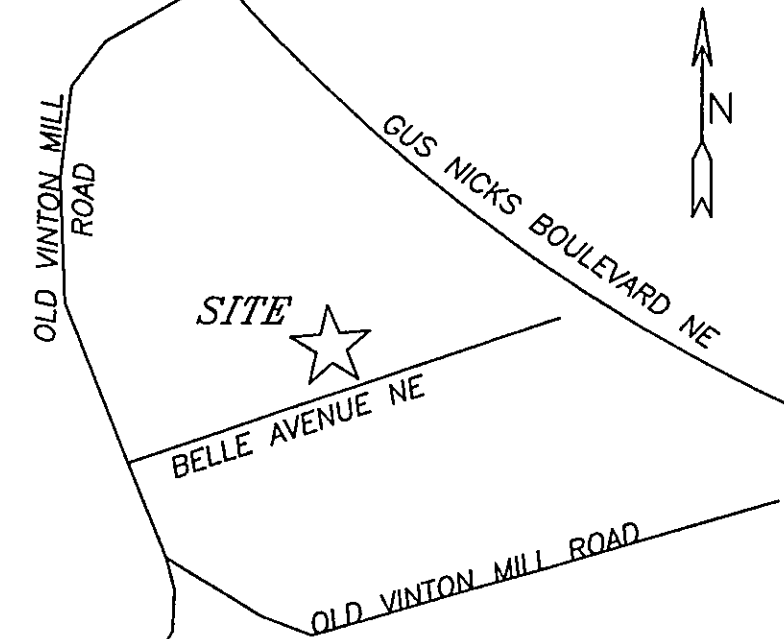

LOCATION MAP
NOT TO SCALE

COORDINATE LIST

1 =	400.0000	800.0000
2 =	319.8052	646.7101
3 =	465.1205	570.6873
4 =	545.3153	723.9772
1 =	400.0000	800.0000
5 =	376.8223	755.6966
6 =	483.1506	700.0701
7 =	506.3283	744.3735

LEGEND

- IRON PIN FOUND
- IRON PIN SET
- ⊙ PLATTED POINTS
- UTILITY LINE
- ⊕ POWER POLE
- () DEEDED CALLS

0 30
Scale 1"=30ft

PLAT OF SURVEY SHOWING BOUNDARY LINE ADJUSTMENT
SAUNDERS BOUNDARY LINE ADJUSTMENT

REARRANGING A PART OF LOT 2, TAX 3320102 & 3320111
CREATING LOT 2-B, 0.1377 ACRES
CREATING LOT 2-A- 0.5136 ACRES

BLOCK 14, MAP OF IDLEWILD PARK
PLAT BOOK 1, PAGE 258 (ROANOKE COUNTY)
LOCATED ON BELLE AVENUE N.E.
CITY OF ROANOKE, VIRGINIA
SCALE: 1" = 30'



PREPARED BY:
CLARK SURVEYING
P.O. BOX 5575
ROANOKE, VIRGINIA
PHONE: (540) 362-1002

NOTES:

EXISTING TAX # 3320102
3320111
SOURCE OF TITLE: INSTR. 070008227
NO TITLE REPORT FURNISHED

JOB #	09007
DATE	FEBRUARY 2, 2009
DISK	200

