

KNOW ALL MEN BY THESE PRESENTS, TO WIT:

THAT MARY LINDA, LLC IS THE FEE SIMPLE OWNER AND PROPRIETOR OF THE LAND SHOWN HEREON TO BE COMBINED BOUNDED BY OUTSIDE CORNERS 11 THRU 13 TO 19, 18, 17, 16 TO 11 INCLUSIVE WHICH COMPRISES ALL OF THE PROPERTY CONVEYED TO SAID OWNER BY DEED DATED SEPTEMBER 16, 2008 AND RECORDED IN THE CLERKS OFFICE OF THE CIRCUIT COURT OF THE CITY OF ROANOKE, VIRGINIA IN INSTRUMENT #080011940.

THAT WILDWOOD PARK, L.L.C. IS THE FEE SIMPLE OWNER AND PROPRIETOR OF THE LAND SHOWN HEREON TO BE SUBDIVIDED BOUNDED BY OUTSIDE CORNERS 1 THRU 10 TO 16 THRU 19 TO 13 THRU 15 TO 1 INCLUSIVE WHICH COMPRISES ALL OF THE PROPERTY CONVEYED TO SAID OWNER BY DEED DATED JANUARY 12, 1996 AND RECORDED IN THE CLERKS OFFICE OF THE CIRCUIT COURT OF THE CITY OF ROANOKE, VIRGINIA IN DEED BOOK 1755, PAGE 79 AND ALL OF THE PROPERTY CONVEYED TO SAID OWNER BY DEED DATED FEBRUARY 10, 1997 AND RECORDED IN THE CLERKS OFFICE OF THE CIRCUIT COURT OF THE CITY OF ROANOKE, VIRGINIA IN DEED BOOK 1794, PAGE 254.

THE SAID OWNERS HEREBY CERTIFY THAT THEY HAVE COMBINED AND RESUBDIVIDED THE LAND AS SHOWN HEREON ENTIRELY OF THEIR OWN FREE WILL AND CONSENT AND PURSUANT TO AND IN COMPLIANCE WITH SECTION 15.2-2240 THROUGH 2276 OF THE CODE OF VIRGINIA, 1950 (AS AMENDED) TO DATE AND FURTHER PURSUANT TO AND IN COMPLIANCE WITH THE CITY OF ROANOKE LAND SUBDIVISION ORDINANCE.

WITNESS THE FOLLOWING SIGNATURES AND SEALS ON THIS 13 DAY OF July, 2009.

Robert R. Cofey ITS Partner
MARY LINDA, LLC, OWNER

Paul W. Henegans ITS Phonetic
WILDWOOD PARK, L.L.C., OWNER

STATE OF VIRGINIA

County of Roanoke

I, Paul W. Henegans, A NOTARY PUBLIC IN AND FOR THE AFORESAID County AND STATE DO HEREBY CERTIFY THAT Robert Cofey, FOR MARY LINDA, LLC, OWNER HAS PERSONALLY APPEARED BEFORE ME IN MY AFORESAID County AND STATE AND ACKNOWLEDGED THE SAME ON July 13, 2009.

MY COMMISSION EXPIRES ON 7-31-2013

Paul W. Henegans REG # 303673
NOTARY PUBLIC

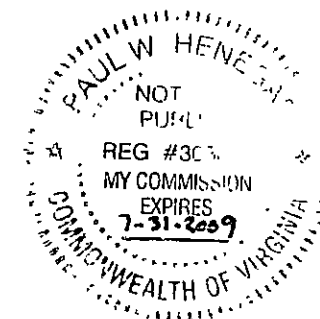

STATE OF VIRGINIA

County of Roanoke

I, Larry T. Ogle, Jr., A NOTARY PUBLIC IN AND FOR THE AFORESAID County AND STATE DO HEREBY CERTIFY THAT J.C. Harrison, FOR WILDWOOD PARK, L.L.C., OWNER HAS PERSONALLY APPEARED BEFORE ME IN MY AFORESAID County AND STATE AND ACKNOWLEDGED THE SAME ON July 14, 2009.

MY COMMISSION EXPIRES ON May 31, 2010

Larry T. Ogle Jr. REG # 7023385
NOTARY PUBLIC

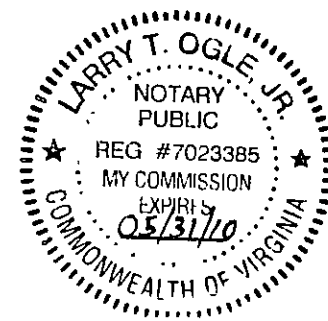

NOTES:

1. THIS PROPERTY IS NOT LOCATED WITHIN THE LIMITS OF A SPECIAL FLOOD HAZARD AREA AS DESIGNATED BY FEMA. THIS OPINION IS BASED ON AN INSPECTION OF THE FLOOD INSURANCE RATE MAP #51161C0167 G, DATED SEPTEMBER 28, 2007 AND HAS NOT BEEN VERIFIED BY ACTUAL FIELD ELEVATIONS. ZONE X (UNSHADED).
2. THIS PLAT WAS PREPARED WITHOUT THE BENEFIT OF A CURRENT TITLE REPORT AND THERE MAY EXIST ENCUMBRANCES WHICH AFFECT THE PROPERTY THAT ARE NOT SHOWN HEREON.
3. IRON PINS WERE FOUND OR SET AS SHOWN HEREON.
4. THIS PLAT IS BASED ON A CURRENT FIELD SURVEY.
5. APPROVAL HEREOF BY THE CITY OF ROANOKE PLANNING COMMISSION AGENT IS FOR PURPOSES OF ENSURING COMPLIANCE WITH THE CITY OF ROANOKE SUBDIVISION ORDINANCE. PRIVATE MATTERS, SUCH AS COMPLIANCE WITH RESTRICTIVE COVENANTS OR OTHER TITLE REQUIREMENTS, APPLICABLE TO THE PROPERTIES SHOWN HEREON, ARE NOT REVIEWED OR APPROVED WITH REGARD TO THIS SUBDIVISION OR RE-SUBDIVISION.
6. THE RECORDATION OF THIS PLAT OF SUBDIVISION DOES NOT CONSTITUTE A CONVEYANCE OF LAND. ANY LOT, PARCEL OR TRACT OF LAND SHOWN HEREON THAT IS INTENDED FOR SALE AND/OR CONVEYANCE MUST BE CONVEYED BY DEED AND SAID DEED MUST BE RECORDED IN THE OFFICE OF THE CLERK OF CIRCUIT COURT OF THE CITY OF ROANOKE.
7. ORIGINAL TAX PARCELS #7200101, #7200102X & #7200103X ARE TO BE COMBINED AND A (1,404 S.F.) PORTION OF ORIGINAL PARCEL "C-1", TAX #7150102 PROPERTY OF WILDWOOD PARK, L.L.C., BOUNDED BY CORNERS 10 TO 16 TO 17 TO A TO 10, INCLUSIVE IS TO BE CONVEYED TO MARY LINDA, LLC AND IS TO BE ADDED TO AND COMBINED WITH ORIGINAL TAX PARCELS #7200101, #7200102X & #7200103X, CREATING TRACT "A-1" (7.5943 AC.) AND PARCEL "C-1A" (12.1296 AC.).

BOUNDARY COORDINATES ORIGIN OF COORDINATES IS ASSUMED		
CORNER	NORTHING	EASTING
1	11018.55557	9373.34930
2	11016.15962	9344.13229
3	10533.23710	8780.35958
4	10478.47804	8725.64403
5	10029.56593	9135.82858
6	9885.10449	9379.36601
7	9572.32510	9025.87901
8	9465.86723	8965.57599
9	9514.75485	8822.94568
10	10383.59890	8261.07040
11	11140.64814	7769.60521
12	11294.62578	7824.90273
13	10521.68147	8684.94883
14	11070.17171	9325.50843
15	11029.81692	9360.07598
1	11018.55557	9373.34930
TOTAL AREA = 19.7240 AC. (859,176 S.F.)		
A	10397.96559	8285.12440

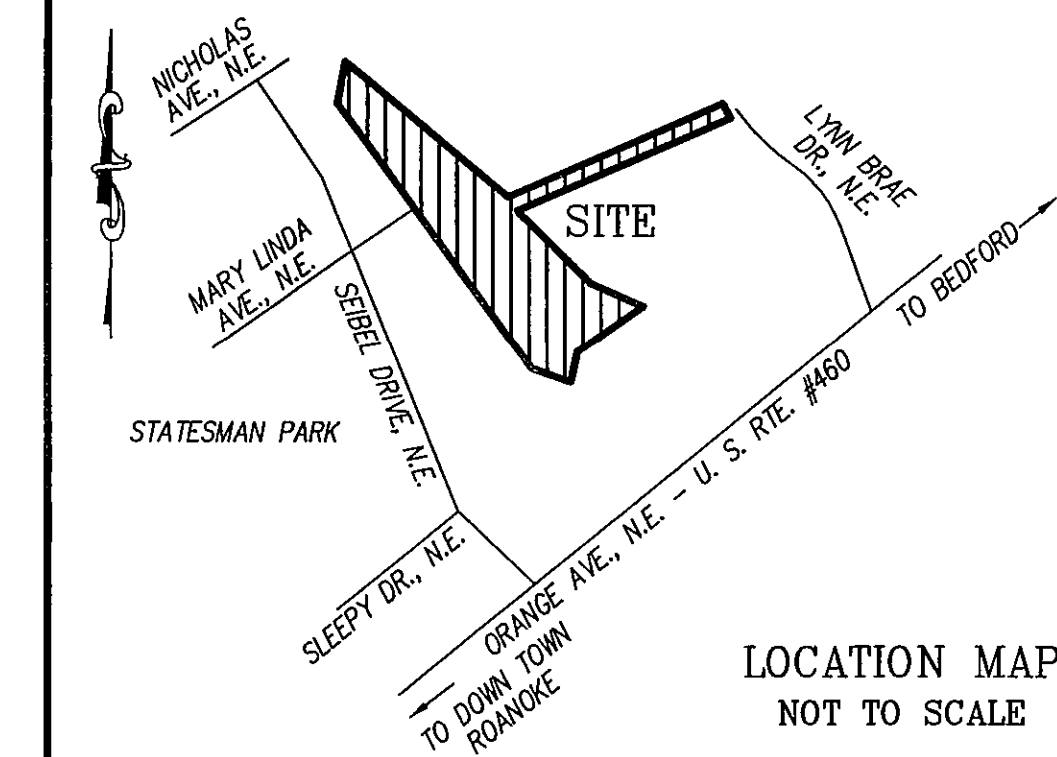

APPROVED:
Tom Carr
AGENT, CITY OF ROANOKE PLANNING COMMISSION

7/16/09
DATE

CLERK'S CERTIFICATE:
IN THE CLERK'S OFFICE OF THE CIRCUIT COURT OF THE CITY OF ROANOKE, VIRGINIA, THIS PLAT WITH THE CERTIFICATE OF ACKNOWLEDGMENT THERETO ANNEXED IS ADMITTED TO RECORD ON July 20, 2009, AT 10:42 O'CLOCK A.M.

TESTEE: BRENDA S. HAMILTON

[Signature]
DEPUTY CLERK

PLAT SHOWING THE COMBINATION & RESUBDIVISION OF
ORIGINAL TAX #7150102 (12.1618 ACRES)

PROPERTY OF
WILDWOOD PARK, L.L.C.

(D.B. 1794, PG. 254 & D.B. 1755, PG. 79)

CREATING

PARCEL "C-1A" (12.1296 AC.)

AND

ORIGINAL TAX #7200101, #7200102X & #7200103X

PROPERTY OF
MARY LINDA, LLC
(INSTRUMENT #080011940)

CREATING

TRACT "A-1" (7.5943 AC.)

SITUATED AT THE TERMINUS OF MARY LINDA AVE., N.E.
AND LYNN BRAE DRIVE, N.E.

CITY OF ROANOKE, VIRGINIA

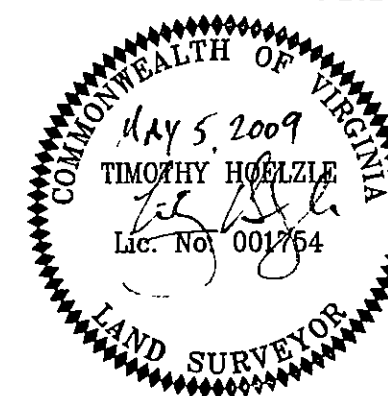

PHONE: (540) 774-4411
FAX: (540) 772-9445
E-MAIL: MAIL@LUMSDENPC.COM

4664 BRAMBLETON AVENUE, SW
P.O. BOX 20669
ROANOKE, VIRGINIA 24018

LUMSDEN ASSOCIATES, P.C.
ENGINEERS-SURVEYORS-PLANNERS
ROANOKE, VIRGINIA

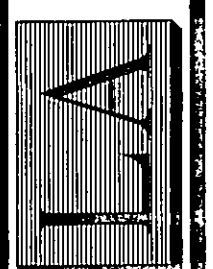

DATE: May 5, 2009
COMM. NO.: 09-063
SCALE: NONE
SHEET 1 OF 2