

DEVELOPMENT PLAN  
FOR  
RY SEWER LINE EXT  
FROM MEADOW VALLEY CIRCLE  
FOR FUTURE DEVELOPMENT  
"THE RESERVE"

*SITUATED IN  
WINDSOR HILLS MAGISTERIAL DISTRICT  
ROANOKE COUNTY, VIRGINIA*

DATE: 4 FEBRUARY 2005

PREPARED FOR  
BARON ENTERPRISES

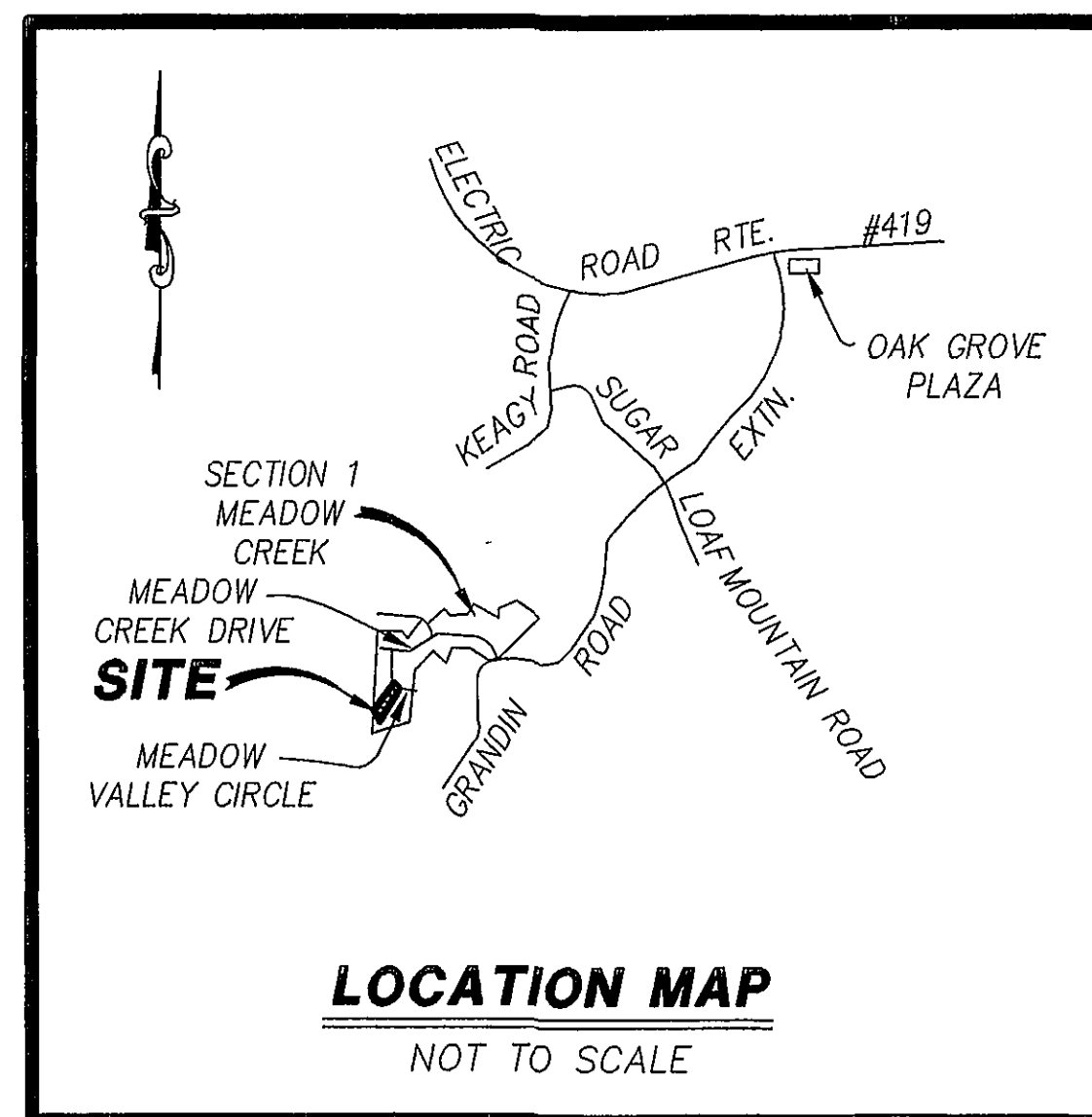

**--INDEX OF DRAWINGS--**

<b>SHEET No.</b>	<b>DESCRIPTION</b>
1 . . . . .	LUMSDEN ASSOCIATES COVER SHEET
2 . . . . .	ROANOKE COUNTY COVER SHEET
3 . . . . .	RECORD PLAT
4 . . . . .	NOTES AND DETAILS
5 . . . . .	PLAN AND PROFILE LAYOUT
6 . . . . .	SEWER DETAILS
7 . . . . .	EROSION AND SEDIMENT CONTROL DETAILS

AS - BUILT  
5/25/2005

I AM CERTIFIED BY THE STATE OF VIRGINIA AS A "RESPONSIBLE LAND DISTURBER". I SHALL BE RESPONSIBLE FOR THE IMPLEMENTATION OF THE EROSION AND SEDIMENT CONTROL PLAN AS SHOWN.

SIGNATURE: . . . . .  
PRINTED NAME: . . . . .  
CERTIFICATE No.: . . . . .  
EXPIRATION DATE: . . . . .  
TELEPHONE No.: . . . . .  
ADDRESS: . . . . .



LUMSDEN ASSOCIATES, P.C.  
ENGINEERS-SURVEYORS-PLANNERS

4664 BRAMBLETON AVENUE, SW  
P.O. BOX 20669  
ROANOKE, VIRGINIA 24018

PHONE: (540) 774-4411  
FAX: (540) 772-9445  
E-MAIL: MAIL@LUMSDENPC.COM

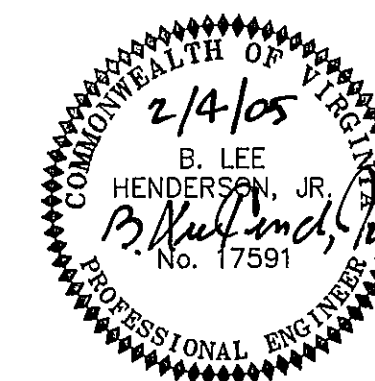

REVISIONS	
DATE	SHEETS

COMMISSION NO. 2004-026

SHEET 1 OF 7