

SEE PHASE ONE SHEETS FOR STORM DRAIN REQUIREMENTS
SEE SHEET C5.2 FOR ROOF COLLECTOR INFORMATION
SEE SHEETS C7.1 THROUGH C7.3 FOR STORM DRAIN PROFILES
SEE SHEET C15.4 FOR NEW PERMANENT STORMWATER MANAGEMENT FACILITY



POPE ARCHITECTS, INC.
1295 BANDANA BLVD N, SUITE 200
ST. PAUL, MN 55108-2735
(651) 642-9200 | FAX (651) 642-1101
www.popearch.com

**RICHFIELD LIVING
CAMPUS
REDEVELOPMENT
PART 2
SALEM, VA**



4005 MERRIMON AVENUE
F.O. BOX 6290
ROANOKE, VIRGINIA 24017-0290
(540) 368-3400
FAX: (540) 368-6705
Scale: 1" = 30'
W.O. 18-0045
Designed: C.L. White
Drawn: C.L. White

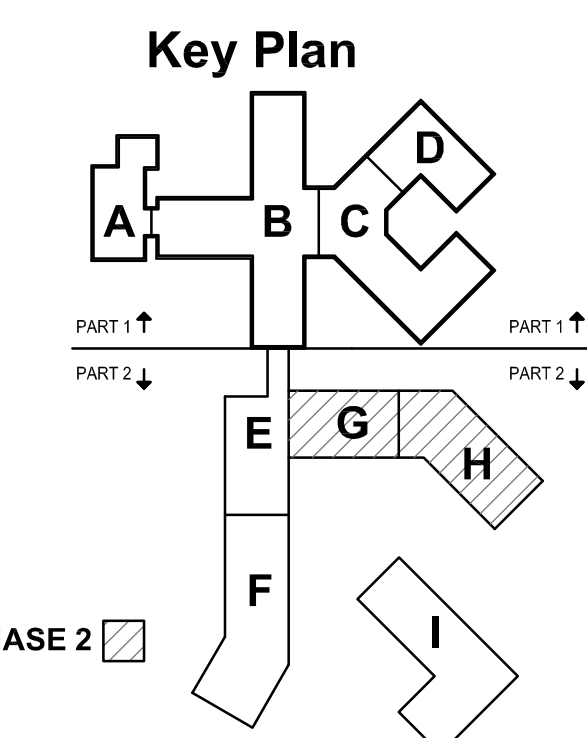

**PHASE 2-GRADING &
STORM DRAINAGE
PLAN**

Issues and Revisions:

10/15/2018	1ST SITE SUBMITTAL
11/09/2018	PERMIT SET
12/19/2018	CONSTRUCTION SET
04/02/2019	ADDENDUM 2



Commission No: 63132-17186
Drawn by:
Checked by:
SHEET

C12.1

30' 0' 30' 60'
1" = 30' GRAPHIC SCALE