

PROJECT LOCATION MAP

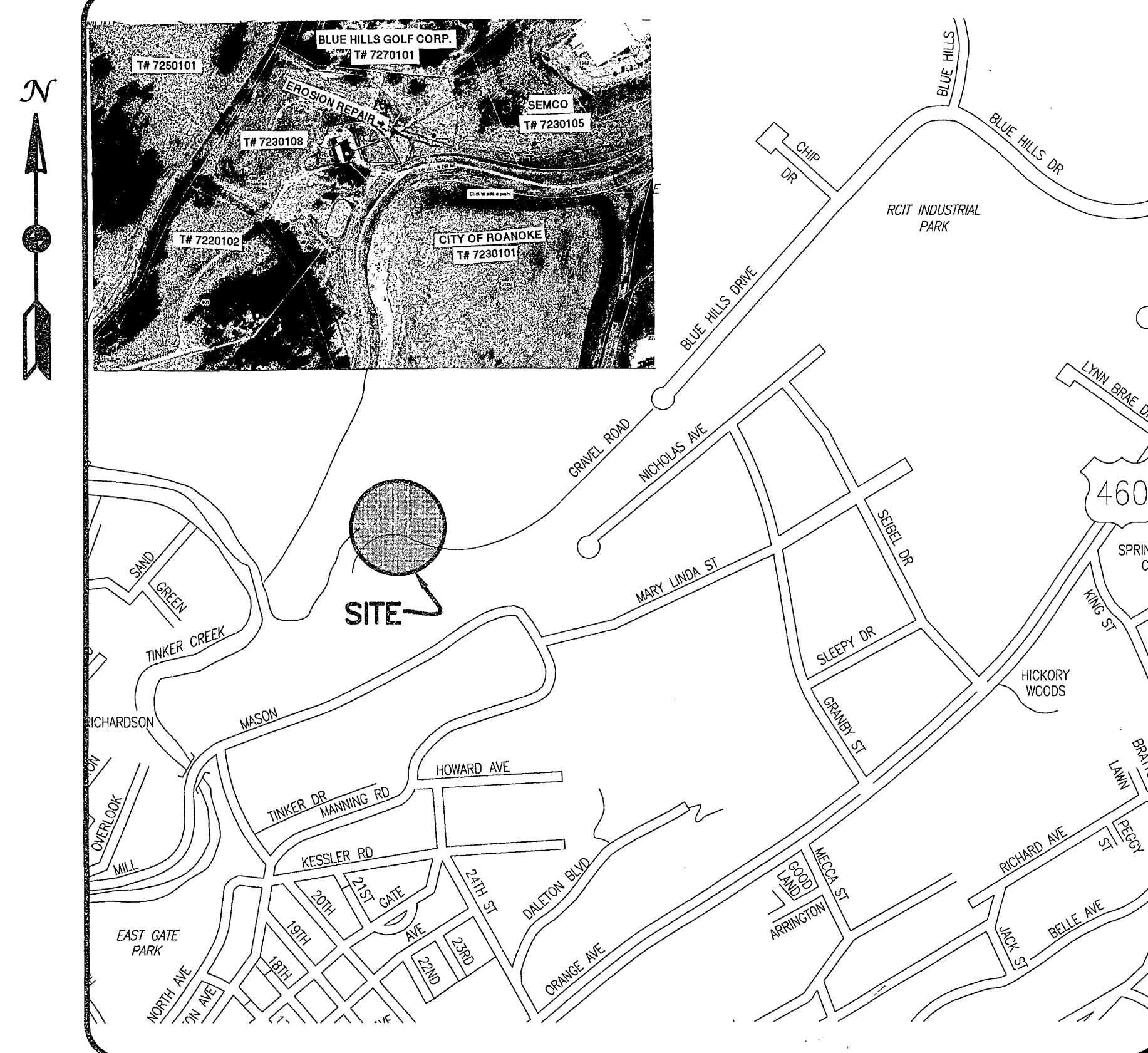

OFFICE OF THE CITY ENGINEER
215 CHURCH AVENUE, SW
ROOM 350
ROANOKE, VIRGINIA 24011-1587
PHONE: (540) 853-2731
FAX: (540) 853-1364
ENGINEER@ROANOKEVA.GOV

INDEX OF SHEETS

1. [CS] - COVER SHEET
2. [C1] - GENERAL NOTES
3. [C2] - EXISTING CONDITION/EASEMENT/DEMOLITION PLAN
4. [ES1] - EROSION AND SEDIMENT CONTROL NARRATIVE AND MS-19
5. [ES2] - EROSION AND SEDIMENT CONTROL PLAN AND DETAIL
6. [U1] - CONCRETE CHANNEL PLAN AND PROFILE
7. [U2] - CONCRETE CHANNEL CROSS SECTION 1
8. [U3] - CONCRETE CHANNEL CROSS SECTION 2
9. [U4] - BRIDGE REPLACEMENT AND GRADE BREAK WALL DETAILS

NOTICE: ALL LANDOWNERS, DEVELOPERS AND CONTRACTORS

FAILURE TO COMPLY WITH THE CONSTRUCTION PROCEDURE REQUIREMENTS LISTED BELOW MAY RESULT IN THE COSTLY REMOVAL OF STRUCTURES, TIME DELAYS OR THE ISSUANCE OF A STOP WORK ORDER.

CONSTRUCTION PROCEDURE REQUIREMENTS

1. RIGHT OF WAY EXCAVATION PERMIT - PRIOR TO THE COMMENCEMENT OF ANY DIGGING, ALTERATION OR CONSTRUCTION WITHIN THE PUBLIC RIGHT OF WAY (STREETS, ALLEYS, PUBLIC EASEMENTS), A RIGHT OF WAY EXCAVATION PERMIT SHALL BE APPLIED FOR AND OBTAINED BY THE CONTRACTOR FROM THE CITY OF ROANOKE.
2. LAND DISTURBANCE PERMIT - AN APPROVED EROSION AND SEDIMENT CONTROL PLAN FOR ANY BORROW/FILL SITES ASSOCIATED WITH THE PROJECT MUST BE SUBMITTED PRIOR TO THE ISSUANCE OF A LAND DISTURBING PERMIT.
3. PLANS AND PERMITS - A COPY OF THE PLANS APPROVED BY THE CITY (SIGNED BY PROPER CITY OFFICIALS) AND ALL PERMITS ISSUED BY THE CITY SHALL BE AVAILABLE AT THE CONSTRUCTION SITE AT ALL TIMES OF ONGOING CONSTRUCTION.
4. LOCATION OF UTILITIES - THE CONTRACTOR SHALL VERIFY THE LOCATION OF ALL EXISTING UTILITIES PRIOR TO THE COMMENCEMENT OF ANY CONSTRUCTION.
5. CONSTRUCTION ENTRANCE - THE CONTRACTOR SHALL INSTALL AN ADEQUATE CONSTRUCTION ENTRANCE FOR ALL CONSTRUCTION RELATED EGRESS FROM THE SITE. SIZE AND COMPOSITION OF THE CONSTRUCTION ENTRANCE SHALL BE AS SHOWN ON THE PLANS.
6. STREETS TO REMAIN CLEAN - IT SHALL BE THE RESPONSIBILITY OF THE CONTRACTOR TO INSURE THAT THE PUBLIC STREET ADJACENT TO THE CONSTRUCTION ENTRANCE REMAINS FREE OF MUD, DIRT, DUST AND/OR ANY TYPE OF CONSTRUCTION MATERIALS OR LITTER AT ALL TIMES.
7. BARRICADES/DITCHES - THE CONTRACTOR SHALL MAINTAIN THE INTEGRITY OF ALL EXCAVATED DITCHES AND SHALL FURNISH AND ENSURE THAT ALL BARRICADES PROPER AND NECESSARY FOR SAFETY OF THE PUBLIC ARE IN PLACE.
8. SEWER AND PAVEMENT REPLACEMENT - CONSTRUCTION OF SANITARY SEWERS AND THE REPLACEMENT OF PAVEMENT SHALL BE IN ACCORDANCE WITH APPROVED STANDARDS AND SPECIFICATIONS OF THE CITY OF ROANOKE AND WESTERN VIRGINIA WATER AUTHORITY.
9. APPROVED PLANS/CONSTRUCTION CHANGES - ANY CHANGE OR VARIATION FROM CONSTRUCTION DESIGN AS SHOWN ON THE OFFICIALLY APPROVED PLANS SHALL BE APPROVED BY THE EROSION AND SEDIMENT CONTROL AGENT PRIOR TO SAID CHANGE OR VARIATION IN CONSTRUCTION BEING MADE.
10. FINAL ACCEPTANCE/CITY - THE OWNER OR DEVELOPER SHALL FURNISH THE CITY OF ROANOKE'S PLANNING BUILDING AND DEVELOPMENT DEPARTMENT WITH A FIELD SURVEYED FINAL CORRECT SET OF AS-BUILT PLANS OF THE NEWLY CONSTRUCTED STORM DRAIN AND/OR STORMWATER MANAGEMENT FACILITIES PRIOR TO FINAL ACCEPTANCE AND ISSUANCE OF A CERTIFICATE OF OCCUPANCY BY THE CITY. AS-BUILT PLANS SHALL BE PROVIDED IN THE STATE PLANE VIRGINIA SOUTH COORDINATE SYSTEM, NAD 1983, FIPS 4502 FEET, US SURVEY FEET, DATUM NA 83, IN THE FORM OF 1 PAPER COPY AND 1 DIGITAL AUTOCAD FILE.

APPROVED FOR CONSTRUCTION

Philip C. Sevin
ROANOKE CITY ENGINEER

06/23/13
DATE

Robert K. Benton
DIRECTOR OF PUBLIC WORKS

09/03/13
DATE

Shannon M. Stewart
ASSISTANT CITY MANAGER FOR OPERATIONS

9/3/13
DATE

SHEET NUMBER: 1 OF 9

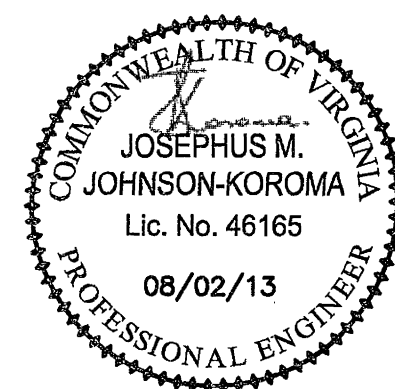

PROJECT NAME

RCIT/HERITAGE POINT EROSION REPAIR
RCIT INDUSTRIAL PARK
TAX MAP 7230108

CITY ENGINEERING PLAN NUMBER: 6743

CITY PLANNING NUMBER: CP130026

REVISION BY	DESCRIPTION:	DATE
REVISION BY	DESCRIPTION:	DATE
REVISION BY	DESCRIPTION:	DATE
REVISION BY	DESCRIPTION:	DATE

City of Roanoke
Planning Building and Development

APPROVED

George R. Winslow 9-4-14
Development Reviewer Date

RCIT/HERITAGE POINT EROSION REPAIR