

ROANOKE, VIRGINIA AND VICINITY

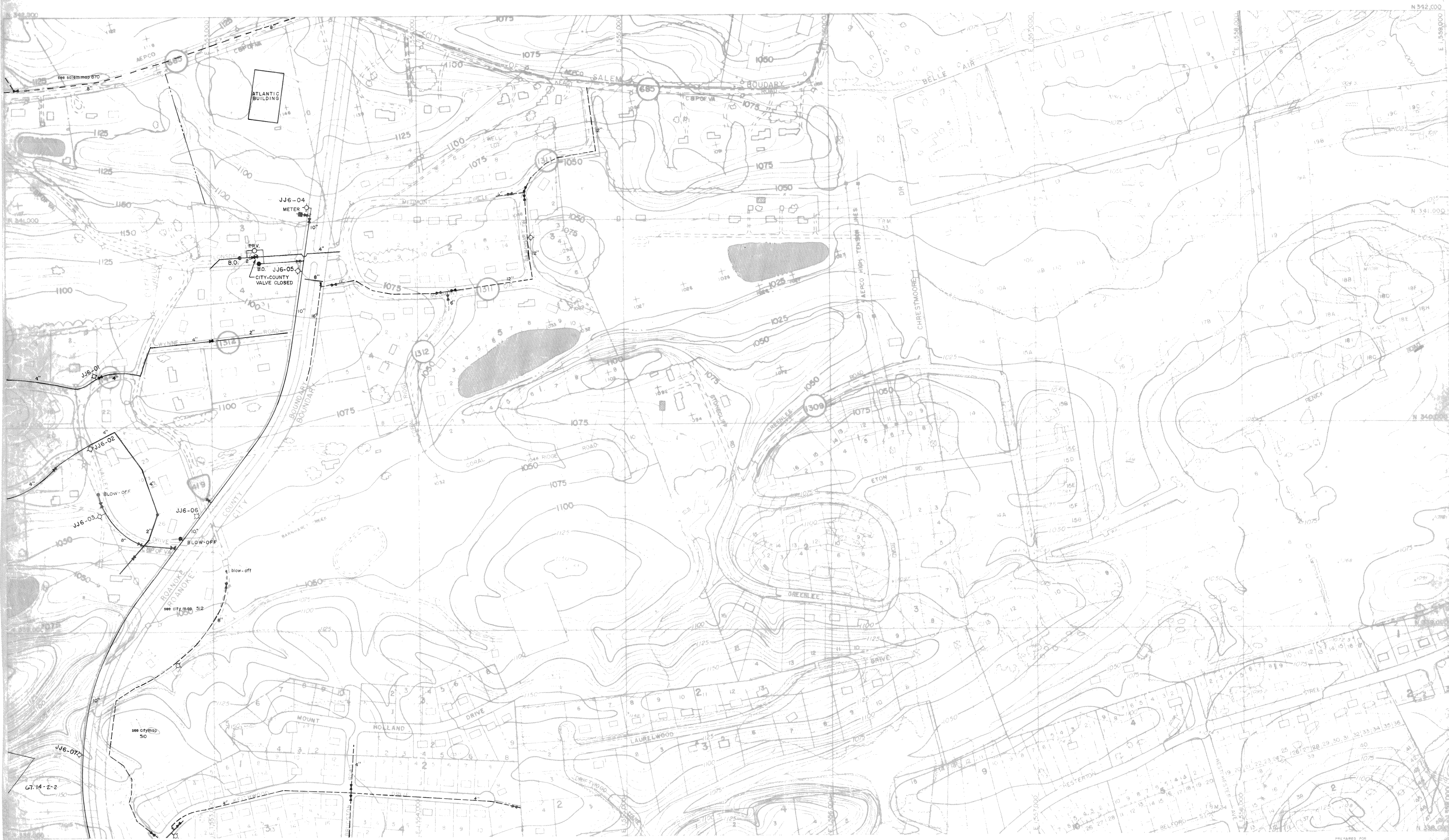

PREPARED BY
AMERICAN AIR SURVEYS, INC.
907 PENN. AVENUE
PITTSBURGH, PA.
A 394

THE PREPARATION OF THIS MAP WAS FINANCED IN PART
THROUGH AN URBAN PLANNING GRANT FROM THE HOUSING
AND URBAN DEVELOPMENT DEPARTMENT, U.S. DEPARTMENT OF
HOUSING AND URBAN DEVELOPMENT, UNDER THE PROVISIONS OF
SECTION 701 OF THE HOUSING ACT OF 1954 AS AMENDED

SCALE 1" = 200'
CONTOUR INTERVAL 5'

1000' GRID BASED ON VIRGINIA STATE PLANE COORDINATE SYSTEM

REVISIONS		
DATE	DATE	DATE
FEB 63	FEB 66	FEB 69
FEB 64	FEB 67	30 JUNE 70
FEB 65	FEB 68	JULY 71

DATE MARCH, 1961
SHEET NO. JJ6
LAST - JJ6-07

REVISIONS		
DATE	DATE	DATE
30 JUN 72	30 JUN 74	1 JUN 87
30 JUN 75	31 DEC 75	SEPT 89

PREPARED FOR
ROANOKE VALLEY
REGIONAL PLANNING & ECONOMIC DEVELOPMENT COMMISSION
ROANOKE, VIRGINIA

5-14-91
6/1/93

NOTE: TOPOGRAPHY IN THIS SHEET IS FROM A
STATE HIGHWAY DEPARTMENT SHEET



025