

GENERAL NOTES

1. THE BOUNDARY IS THE DIRECT RESULT OF A FIELD SURVEY BY LUMSDEN ASSOCIATES, P.C.
2. TOPOGRAPHY DATA BASED ON A FIELD SURVEY BY LUMSDEN ASSOCIATES, P.C.
3. A TITLE REPORT WAS NOT FURNISHED FOR THIS PROJECT.
4. NO CONSTRUCTION/FIELD REVISIONS ARE ALLOWED WITHOUT THE APPROVAL OF THE CONSULTING ENGINEER, THE CITY OF ROANOKE, AND/OR THE WESTERN VIRGINIA WATER AUTHORITY.
5. IT SHALL BE THE RESPONSIBILITY OF THE DEVELOPER TO CLEAN OUT THE EXISTING STORM SEWER SYSTEM WITHIN EXISTING DEVELOPMENTS SHOULD THESE SYSTEMS BECOME SILTED OR BLOCKED IN ANY WAY DUE TO THE CONSTRUCTION OF THIS PROPOSED DEVELOPMENT.
6. THIS PROPERTY IS NOT LOCATED WITHIN THE LIMITS OF A 100 YEAR FLOOD BOUNDARY AS DESIGNATED BY FEMA. THIS OPINION IS BASED ON AN INSPECTION OF THE FLOOD INSURANCE RATE MAP AND HAS NOT BEEN VERIFIED IN THE FIELD. SEE COMMUNITY PANEL NO. 510130 0161 G, MAP NUMBER 51161C0161 G, DATED 9-28-07.
7. SEE CONTRACT DOCUMENTS AND SPECIFICATIONS FOR ADDITIONAL REQUIREMENTS.

CONSTRUCTION NOTES

1. GRADES AND LOCATIONS OF EXISTING SANITARY SEWER LATERALS ARE UNKNOWN. GRADES AND LOCATIONS SHOWN ARE ASSUMED. THE CONTRACTOR SHALL VERIFY THE DEPTH AND LOCATIONS OF ALL EXISTING UTILITIES PRIOR TO CONSTRUCTION.
2. THE DEPTH OF WATER LINES, GAS LINES, AND TELEPHONE DUCTS ARE UNKNOWN. THEIR DEPTH HAS BEEN ASSUMED WHERE SHOWN IN PROFILE. THE CONTRACTOR SHALL VERIFY THE DEPTH AND LOCATION OF ALL EXISTING UTILITIES PRIOR TO CONSTRUCTION.
3. ALL EXISTING UTILITIES MAY NOT BE SHOWN OR MAY NOT BE SHOWN IN THEIR EXACT LOCATION. THE CONTRACTOR SHALL CONTACT PUBLIC UTILITIES COMPANIES THROUGH MISS UTILITY (1-800-552-7001) TO HAVE EXISTING UTILITIES LOCATED. THE CONTRACTOR SHALL VERIFY THE DEPTH AND LOCATION OF ALL EXISTING UTILITIES PRIOR TO CONSTRUCTION.
4. FOR THE RELOCATION OR REPLACEMENT OF ANY EXISTING WATER OR SANITARY SEWER FACILITIES, CONTACT CHRIS CUREY AT THE WESTERN VIRGINIA WATER AUTHORITY (853-5637) A MINIMUM OF 48 HOURS PRIOR TO CONSTRUCTION.
5. ALL STREETS TO BE MAINTAINED FOR ONE WAY TRAFFIC AND OPENED TO TWO WAY TRAFFIC DURING PEAK TRAFFIC HOURS. FOR ANY CLOSINGS REQUIRED, CONTACT ROANOKE CITY TRAFFIC ENGINEERING (853-2673) A MINIMUM OF TWO WEEKS PRIOR TO CLOSING.
6. ACCESS TO ADJOINING PROPERTIES SHALL BE MAINTAINED AT ALL TIMES DURING CONSTRUCTION. COORDINATE ACCESS WITH EACH PROPERTY OWNER.
7. THE CONTRACTOR SHALL VISIT AND VERIFY EXISTING CONDITIONS PRIOR TO STARTING CONSTRUCTION. CONTACT OWNER AND ENGINEER WITH ANY VARIATIONS.
8. ALL CONSTRUCTION SHALL CONFORM TO THE CURRENT CITY OF ROANOKE STANDARDS AND SPECIFICATIONS AND THE CURRENT EDITION OF VDOT'S ROAD AND BRIDGE STANDARDS.
9. THE CONTRACTOR SHALL BE RESPONSIBLE FOR NOTIFYING THE OWNER AND THE ENGINEER OF ANY CHANGES OR CONDITIONS ATTACHED TO PERMITS OBTAINED FROM ANY AUTHORITY ISSUING PERMITS.
10. ALL WATER CONNECTIONS TO EXISTING LINES SHALL BE COORDINATED WITH AND PERFORMED BY THE WESTERN VIRGINIA WATER AUTHORITY.
11. ALL SANITARY SEWER CONNECTIONS TO EXISTING LINES SHALL BE PERFORMED BY THE CONTRACTOR WITH A WESTERN VIRGINIA WATER AUTHORITY INSPECTOR ON-SITE.
12. SEE VDOT ROAD AND BRIDGE STANDARDS FOR CONCRETE CURB AND STORM DRAINAGE DETAILS.
13. THE CONTRACTOR AND OR OWNER SHALL PROVIDE A STORAGE CONTAINER FOR TEMPORARY STORAGE AND DISPOSAL OF LAND CLEARANCE DEBRIS AND BUILDING MATERIALS. ON-SITE BURIAL OF MATERIAL SHALL NOT BE PERMITTED.

GRADING NOTES

1. AREAS TO BE GRADED SHALL BE CLEARED OF ALL VEGETATION, STRUCTURES, AND OTHER PHYSICAL FEATURES IN PREPARATION OF GRADING.
2. TOPSOIL SHALL BE REMOVED FROM THE CLEARED AREA AND STOCKPILED FOR FUTURE USE. A SEPARATE E & S PLAN MAY BE REQUIRED FOR OFF-SITE STOCKPILES.
3. FILL MATERIAL SHALL BE FREE FROM ORGANIC MATTER AND ROCKS LARGER THAN 6 INCHES IN DIAMETER.
4. FILL MATERIAL SHALL BE PLACED AND COMPACTED IN EIGHT (8) INCH LOOSE LIFTS AND COMPACTED TO AT LEAST NINETY-FIVE (95) PERCENT OF THE MATERIAL'S MAXIMUM DRY DENSITY AS DETERMINED BY ASTM D698, STANDARD PROCTOR. MAINTAIN MOISTURE CONTENT OF FILL MATERIAL WITHIN THREE (3) PERCENT OF OPTIMUM TO ATTAIN REQUIRED COMPACTION DENSITY.
5. SUBSURFACE EXPLORATION SERVICES WERE PERFORMED BY ECS, LTD. A COPY OF THE REPORT IS INCLUDED IN THE SPECIFICATIONS.

BENCHMARK INFORMATION

1. BENCHMARK No. 1 - TOP OF ARROWHEAD ON FIRE HYDRANT LOCATED AT THE NORTHWEST CORNER OF THE INTERSECTION OF SHENANDOAH AVENUE AND 30TH STREET, AT STATION 11+31.02, 24.53' LEFT. ELEVATION = 1008.53

LEGEND

- 36" CL. III RCP
24" RCP
12" W
8" SS
UGT
2" G
E
T
UTILITY POLE
GUY WIRE
MANHOLE
FIRE HYDRANT
WATER VALVE
GAS VALVE
WATER METER
EXIST. FENCE
NEW FENCE
GUARDRAIL
PAVEMENT
GRAVEL
CONCRETE
CONTOUR
SOIL BORING

STORM DRAIN STRUCTURE COORDINATE CHART

STRUCTURE	NORTHING	EASTING
EX	7826.3808	8235.7125
A	7823.5237	8200.8797
A1	7827.2851	8193.8085
B	7985.6366	8100.1037
C	8091.1405	8126.1786
D	8250.2632	8175.7857
E	8353.5162	7806.4915
E1	8390.3839	7805.4052
E2	8368.3571	7736.2179
F	8586.4293	7853.6296
G	8678.5953	7888.4677
H	8888.6097	7929.1002
H1	8860.8353	8086.2101
H2	8877.8215	8089.2056
I	8908.6474	7827.4242
I1	8925.4984	7830.7394
J	8936.551	7885.8344
J1	8978.1091	7893.6877
K	8953.5414	7599.6208
L	8966.0959	7535.9161
L1	9013.8153	7545.3203
L2	9041.394	7582.2975
L3	9041.9755	7614.3157
M	8962.1586	7430.3542
N	9050.4387	7435.7919
O	9062.5458	7381.5385
O1	9046.8905	7358.4131
P	9091.912	7214.4405
P1	9076.204	7211.3047
Q	9122.0693	7063.3788
Q1	9114.2241	7061.6136

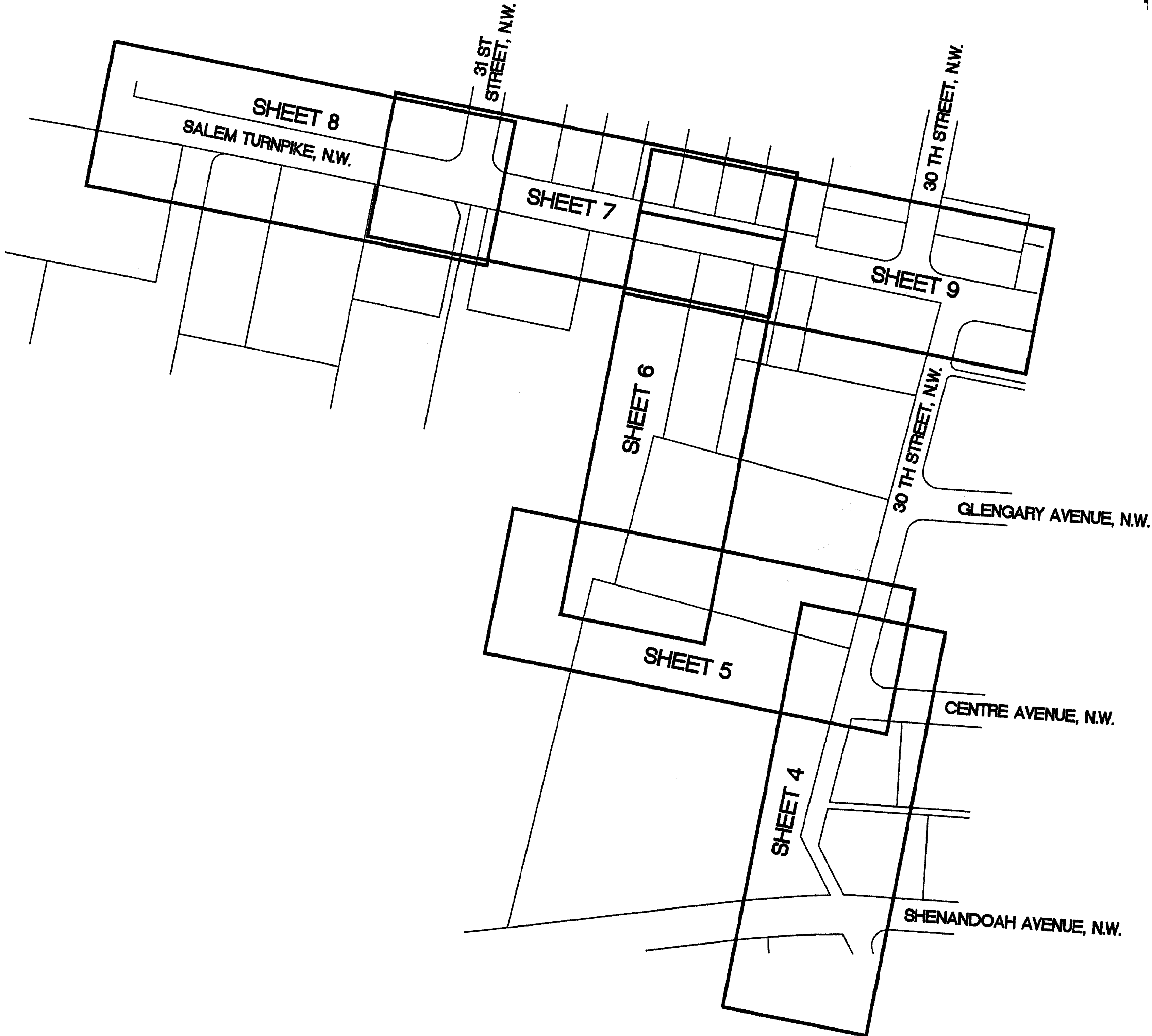

LUMSDEN ASSOCIATES, P.C.
ENGINEERS-SURVEYORS-PLANNERS
ROANOKE, VIRGINIA

4664 BRAMBLETON AVENUE
P.O. BOX 20669
ROANOKE, VIRGINIA 24018

PHONE: (540) 774-4411
FAX: (540) 772-9445
E-MAIL: MAIL@LUMSDENPC.COM

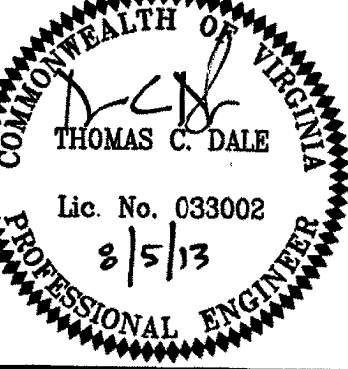

NOTES AND INDEX MAP

SALEM TURNPIKE STORM DRAINAGE PROJECT
29th STREET TO 31st STREET
PREPARED FOR
THE CITY OF ROANOKE, VIRGINIA

NO.	DATE	DESCRIPTION
1		
2		
3		
4		
5		

DATE: August 5, 2013

SCALE: 1" = 100'

COMMISSION NO: 99-436

SHEET 2 OF 11

APPROVED
NOV 07 2013