

DEVELOPMENT PLAN
FOR
"SOUTH MOUNTAIN VILLAGE"

SITUATED IN
CAVE SPRING MAGISTERIAL DISTRICT
ROANOKE COUNTY, VIRGINIA

DATE: 25 SEPTEMBER 2002
1 OCTOBER 2003 – "AS-BUILT"
PREPARED FOR

RADFORD & COMPANY

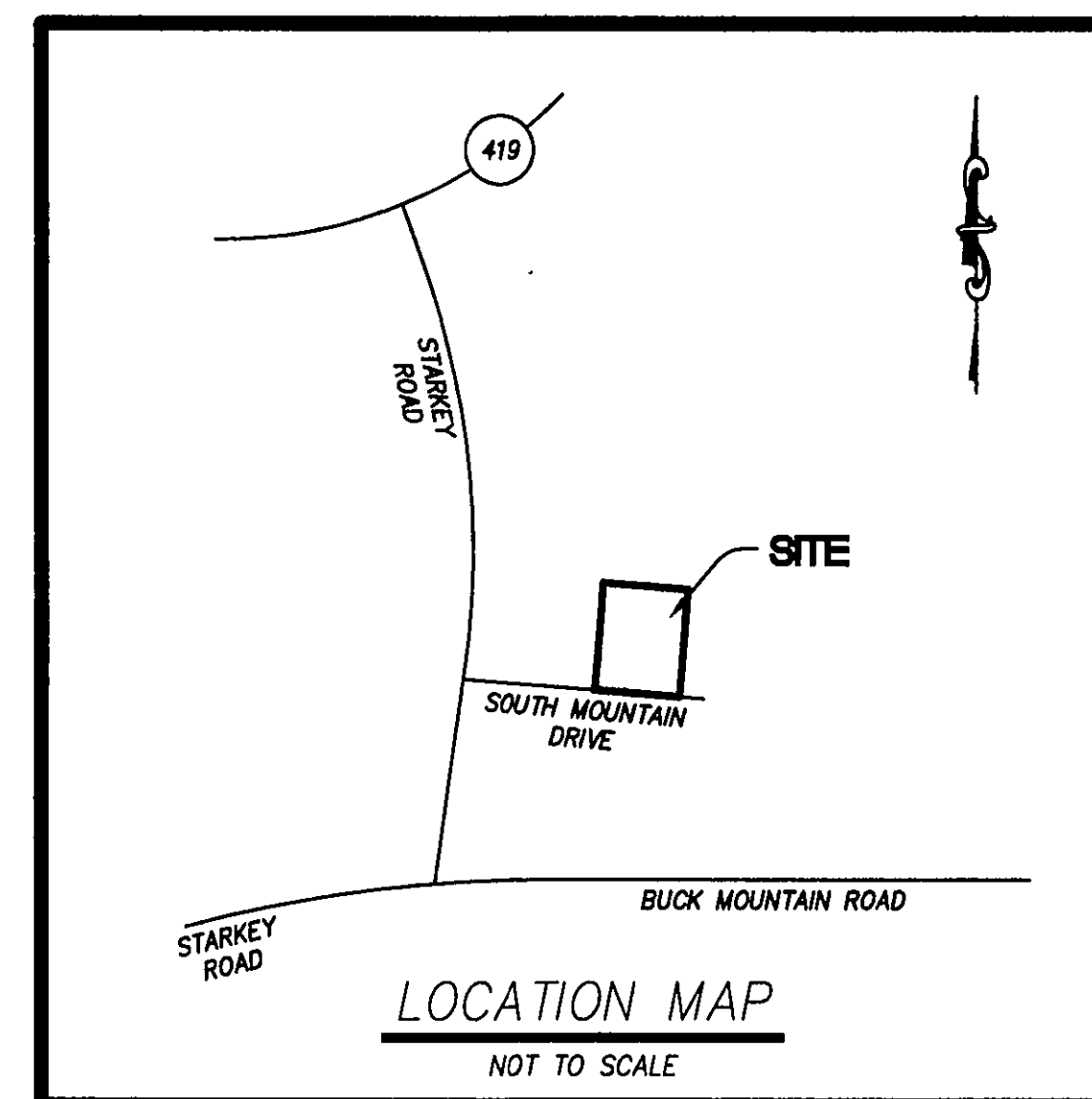

--INDEX OF DRAWINGS--
SHEET No. DESCRIPTION

1. LUMSDEN ASSOCIATES COVER SHEET
2. ROANOKE COUNTY STANDARD COVER SHEET
3. RECORD PLAT
4. NOTES AND DETAILS
5. DIMENSIONAL LAYOUT
6. GRADING PLAN
7. PROFILES
8. EROSION AND SEDIMENT CONTROL PLAN
9. ROANOKE COUNTY EROSION AND SEDIMENT CONTROL NOTES AND DETAILS

I AM CERTIFIED BY THE STATE OF VIRGINIA AS A "RESPONSIBLE LAND DISTURBER". I SHALL BE RESPONSIBLE FOR THE IMPLEMENTATION OF THE EROSION AND SEDIMENT CONTROL PLAN AS SHOWN.

SIGNATURE:
PRINTED NAME:
CERTIFICATE No.:
EXPIRATION DATE:
TELEPHONE No.:
ADDRESS:
.
.



LUMSDEN ASSOCIATES, P.C.
ENGINEERS-SURVEYORS-PLANNERS

4664 BRAMBLETON AVENUE, SW
P.O. BOX 20669
ROANOKE, VIRGINIA 24018

PHONE: (540) 774-4411
FAX: (540) 772-9445
E-MAIL: MAIL@LUMSDENPC.COM

"AS-BUILT"

- NOTE:
1. "AS BUILT" INFORMATION TAKEN FROM PLAN FURNISHED BY J. P. TURNER & BROTHERS, INC., GENERAL CONTRACTOR.
 2. "AS-BUILT" DIMENSIONS SHOWN IN BRACKETS.

REVISIONS	
DATE	SHEETS
1/9/03	1, 6
1/17/03	1, 6
10/01/03	"AS-BUILT"
COMMISSION NO. 2002-053	
SHEET 1 OF 9	