

LEGEND

EXISTING STORM

EXISTING WATER

EXISTING SANITARY SEWER

PROPOSED SANITARY SEWER

EXISTING SANITARY SEWER MANHOLE

PROPOSED SANITARY SEWER MANHOLE

PROPOSED SANITARY SEWER EASEMENT

PROPERTY LINE

EXISTING FENCELINE

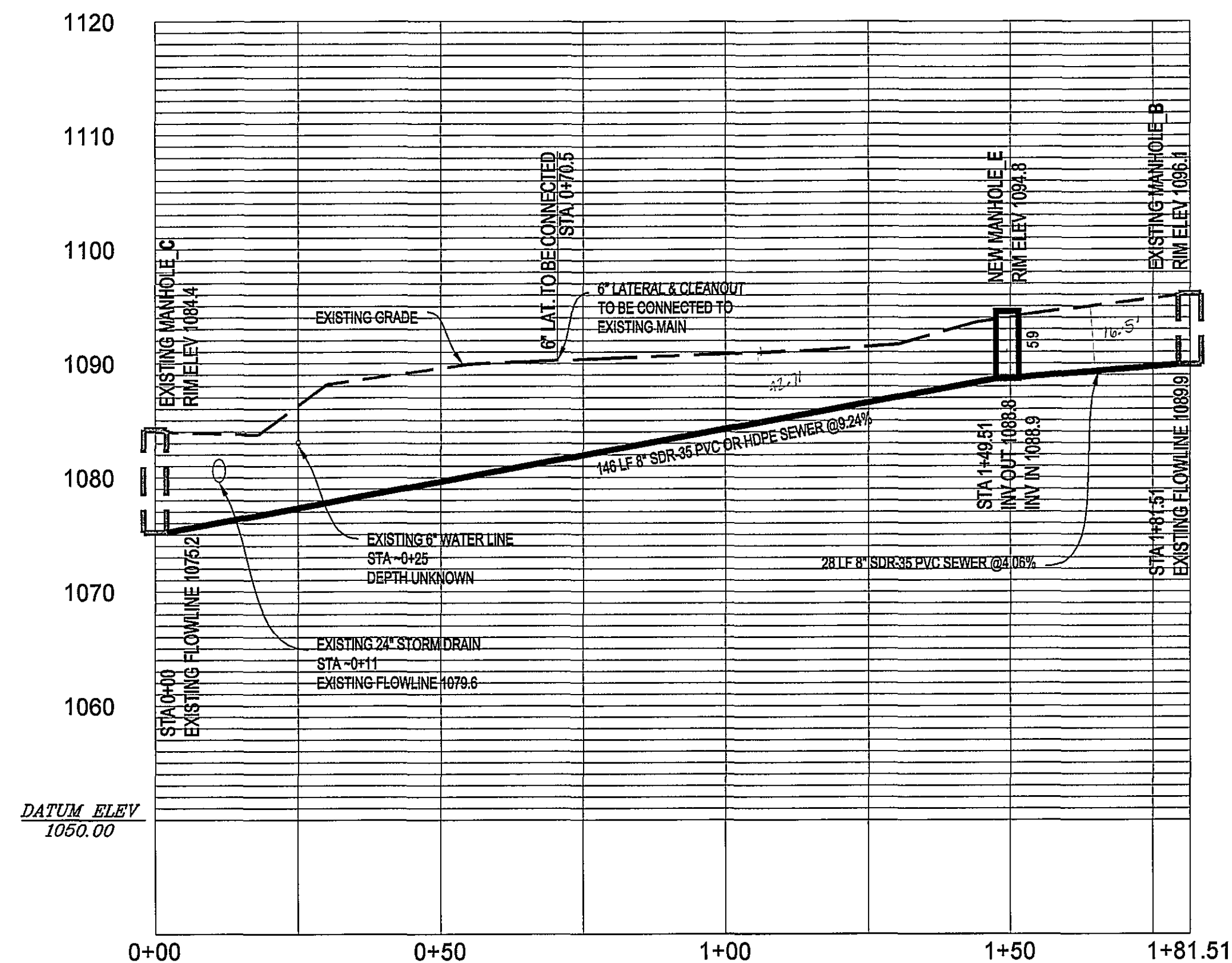
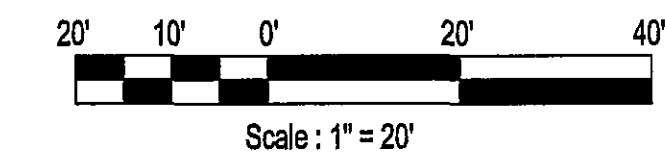

- NOTES:
- 1.) ALL WORK SHALL CONFORM TO THE LATEST EDITION OF WESTERN VIRGINIA WATER AUTHORITY DESIGN & CONSTRUCTION STANDARDS.
  - 2.) MH B TO MH E - REMOVE EXISTING 8" SEWER LINE & REPLACE ACCORDING TO PROFILE INVERTS.
  - 3.) MH C TO MH E SECTION TO BE PLACED BY HORIZONTAL DIRECTIONAL DRILLING OR OPEN CUT METHOD.  
- ALL WORK TO BE COORDINATED WITH THE AUTHORITY AND IF MORE THAN ONE CONTRACTOR IS AWARDED WORK, ALL WORK SHALL BE COORDINATED BETWEEN CONTRACTORS AND THE AUTHORITY.
  - 4.) HDD - HDD WILL BE BID BASED ON SOIL DRILLING, MEDIUM ROCK AND HARD ROCK BORING.  
**ALL CONTRACTORS BIDDING THE BORING PORTION MUST HAVE THE CAPACITY TO DRILL HARD ROCK.**  
SOIL BORING SHALL CONSIST OF USING A STANDARD BIT. MEDIUM ROCK BORING REQUIRES THE USE OF A BIT WITH ROCK TEETH WITH A ROCKING MOTION (OR EQUIVALENT) FOR ROCK SUCH AS SHALE. HARD ROCK BORING IS REQUIRED WHEN MEDIUM ROCK HEAD CANNOT BE GUIDED THROUGH THE BORE. THE LOW BIDDER WILL BE DETERMINED BY BASING THE BID ON 50% SOIL BORE AND 50% HARD ROCK BORE.
  - 5.) HDPE PIPE SHALL MEET ASTM F714 POLYETHYLENE PIPE (SDR-PR) BASED ON OUTSIDE DIAMETER ASTM 3350 CELL CLASSIFICATION 345464E. INTERIOR OF PIPE SHALL BE LIGHT IN COLOR TO AID TELEVISIONING THE PIPE.
  - 6.) OPEN CUT - BACKFILL SHALL BE PLACED AND COMPACTED TO THE EXISTING GRADE. CONTRACTOR WILL NOT BE RESPONSIBLE FOR THE FOLLOWING ITEMS AT 2906 STEPHENSON AVENUE: RESEEDING YARD, REMOVING OR REPAIRING LANDSCAPED AREAS, RESTORING DRIVEWAY AND REMOVAL OR RESTORATION OF FENCE.

SCALE: HOR. 1 IN. = 20 FT.  
VERT. 1 IN. = 10 FT.

WVWA ID# 6H-LJ3B

WESTERN VIRGINIA  
WATER AUTHORITY

ENGINEERING SERVICES

2012 SOUTH JEFFERSON STREET  
ROANOKE, VIRGINIA 24014  
PHONE: (540) 653-5641

CASSANDRA ALTICE  
035567  
REGISTERED PROFESSIONAL ENGINEER

2906 STEPHENSON AVE, SW  
PROPOSED SEWER REPLACEMENT

Designed By: JAD

Drawn By: JAD

Checked By: JGR

Date: 08/15/05

Scale: AS NOTED

Plan #:

Sheet: 2 OF 2