

DEVELOPMENT PLAN
FOR
SECTION NO. 2
STONE MANOR

SITUATED IN
WINDSOR HILLS MAGISTERIAL DISTRICT
ROANOKE COUNTY, VIRGINIA

DATE: August 23, 2005

PREPARED FOR
BOONE HOMES, INC.

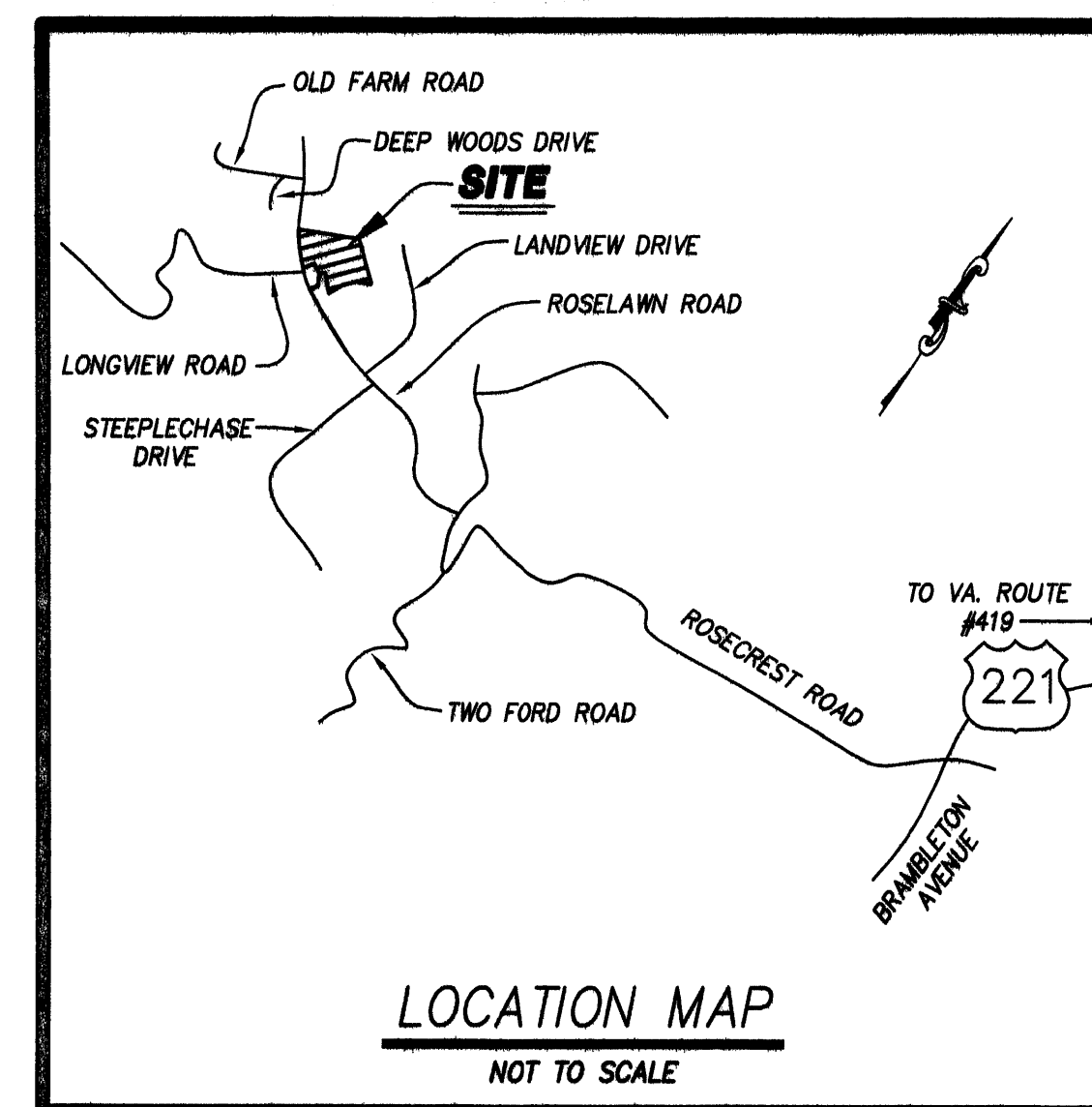

--INDEX OF DRAWINGS--
SHEET No. DESCRIPTION

1. LUMSDEN ASSOCIATES COVER SHEET
2. ROANOKE COUNTY COVER SHEET
3. RECORD PLAT
4. NOTES & DETAILS
5. DIMENSIONAL LAYOUT
6. GRADING PLAN
7. PROFILES
8. PROFILES
9. EROSION AND SEDIMENT CONTROL PLAN
10. EROSION AND SEDIMENT CONTROL DETAILS
11. SEDIMENT BASIN DETAILS
12. WATER AND SANITARY SEWER DETAILS

"As-Built"

1. Water and sewer "As-Built" information taken from plans furnished by J. P. Turner and Sons, Inc., contractor.
2. "As- Built dimensions are shown in brackets.

I AM CERTIFIED BY THE STATE OF VIRGINIA AS A "RESPONSIBLE LAND DISTURBER". I SHALL BE RESPONSIBLE FOR THE IMPLEMENTATION OF THE EROSION AND SEDIMENT CONTROL PLAN AS SHOWN.

SIGNATURE:
PRINTED NAME: RONALD J. BOOTH
CERTIFICATE No.: 12589
EXPIRATION DATE: 01/03/08
TELEPHONE No.: (540) 772-3887
ADDRESS: P. O. BOX 8156
ROANOKE, VA 24014



LUMSDEN ASSOCIATES, P.C.
ENGINEERS-SURVEYORS-PLANNERS

4664 BRAMBLETON AVENUE, SW
P.O. BOX 20669
ROANOKE, VIRGINIA 24018

PHONE: (540) 774-4411
FAX: (540) 772-9445
E-MAIL: MAIL@LUMSDENPC.COM

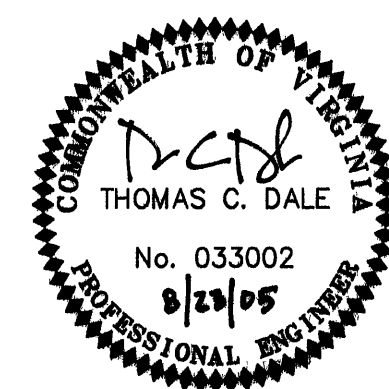

REVISIONS	
DATE	SHEETS
11/11/05	1, 7, 9, 11
8/14/06	"As-Built"
COMMISSION NO. 01-409	
SHEET 1 OF 12	