

Plotted By: Anderson, Laura Sheet Set: KHA Layout: CG-202 Overall Stormwater Management Plan February 23, 2022 01:09:35pm K:\RIG-CVA\113418 Take 5\005 Williamson Rd Roanoke\CAD\PlanSheets\CG-202 Overall Stormwater Management Plan.dwg
This document, together with the concepts and designs presented herein, as an instrument of service, is intended only for the specific purpose and client for which it was prepared. Reuse of and improper reliance on this document without written authorization and adaptation by Kimley-Horn and Associates, Inc. shall be without liability to Kimley-Horn and Associates, Inc.

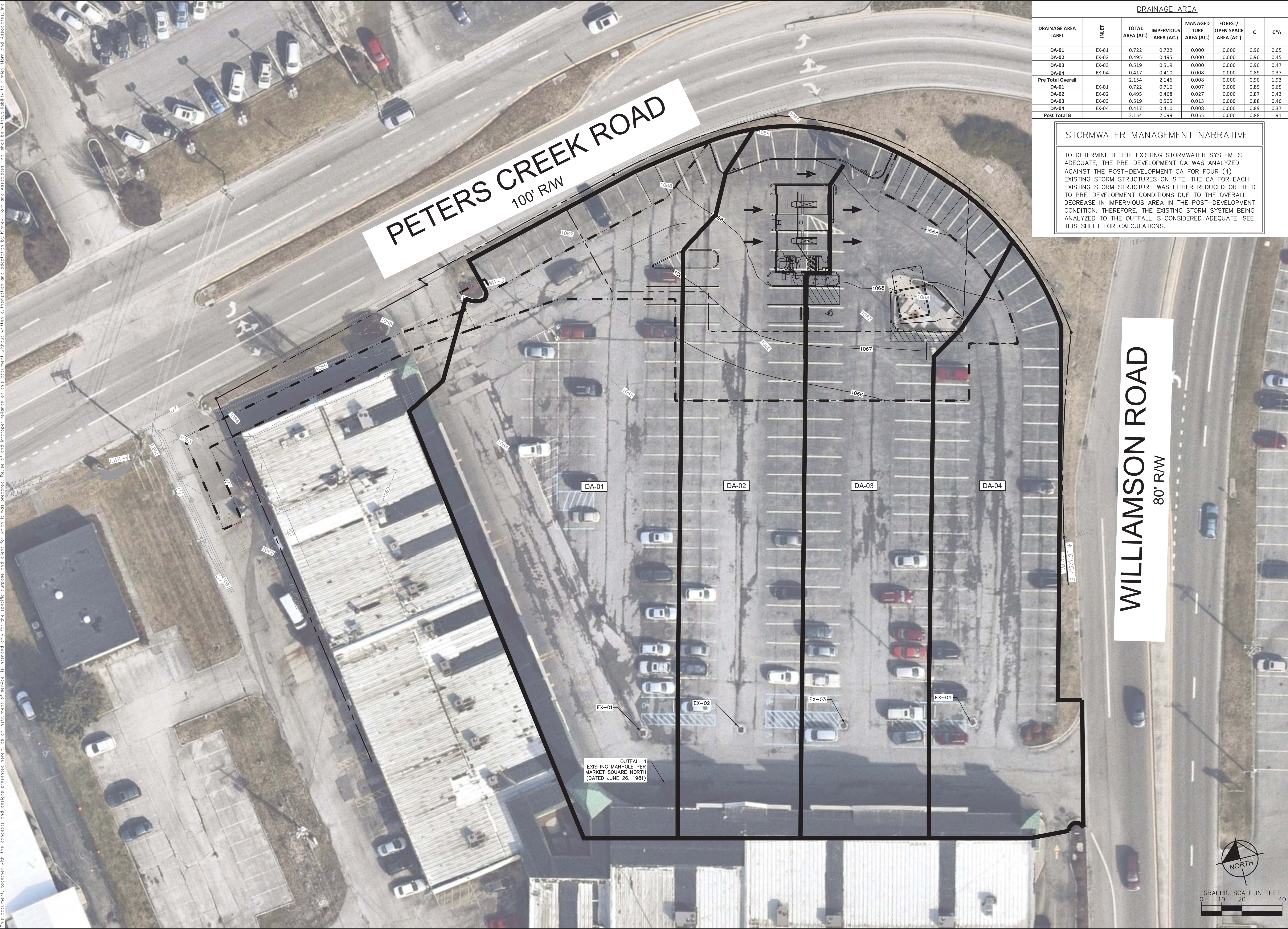

DRAINAGE AREA							
DRAINAGE AREA LABEL	INLET	TOTAL AREA (AC.)	IMPERVIOUS AREA (AC.)	MANAGED TURF AREA (AC.)	FOREST/ OPEN SPACE AREA (AC.)	C	C*A
DA-01	EX-01	0.722	0.722	0.000	0.000	0.90	0.65
DA-02	EX-02	0.495	0.495	0.000	0.000	0.90	0.45
DA-03	EX-03	0.519	0.519	0.000	0.000	0.90	0.47
DA-04	EX-04	0.417	0.410	0.008	0.000	0.89	0.37
Pre Total Overall		2.154	2.146	0.008	0.000	0.90	1.93
DA-01	EX-01	0.722	0.716	0.007	0.000	0.89	0.65
DA-02	EX-02	0.495	0.468	0.027	0.000	0.87	0.43
DA-03	EX-03	0.519	0.505	0.013	0.000	0.88	0.46
DA-04	EX-04	0.417	0.410	0.008	0.000	0.89	0.37
Post Total B		2.154	2.099	0.055	0.000	0.88	1.91

STORMWATER MANAGEMENT NARRATIVE

TO DETERMINE IF THE EXISTING STORMWATER SYSTEM IS ADEQUATE, THE PRE-DEVELOPMENT CA WAS ANALYZED AGAINST THE POST-DEVELOPMENT CA FOR FOUR (4) EXISTING STORM STRUCTURES ON SITE. THE CA FOR EACH EXISTING STORM STRUCTURE WAS EITHER REDUCED OR HELD TO PRE-DEVELOPMENT CONDITIONS DUE TO THE OVERALL DECREASE IN IMPERVIOUS AREA IN THE POST-DEVELOPMENT CONDITION. THEREFORE, THE EXISTING STORM SYSTEM BEING ANALYZED TO THE OUTFALL IS CONSIDERED ADEQUATE. SEE THIS SHEET FOR CALCULATIONS.

TAKE 5
WILLIAMSON ROAD
PREPARED FOR
EB PARTNERS LLC

OVERALL
STORMWATER
MANAGMENT PLAN

© 2022 KIMLEY-HORN AND ASSOCIATES, INC.
1700 WILLOW LANE DR, SUITE 200, RICHMOND, VA 23230
PHONE: 804-673-3882
WWW.KIMLEY-HORN.COM

Kimley»Horn

LAURA P. ANDERSON
Lic. No. 069865
01/23/2023
PROFESSIONAL ENGINEER

REVISIONS

DATE

BY

SHEET NUMBER
CG-202

ROANOKE COUNTY

VA