

MANHOLE NUMBER	REQUIRED REHABILITATION/REPLACEMENT
MH 05A-3747.0	REBUILD BENCH AND CHANNEL, CHIMNEY SEALANT, AND INFLOW PROTECTION INSERT
MH 05A-3748.0	CHIMNEY SEALANT AND INFLOW PROTECTION INSERT
MH 05A-3749.0	REPLACE MANHOLE WITH NEW PRECAST MANHOLE 4.7 FEET IN DEPTH

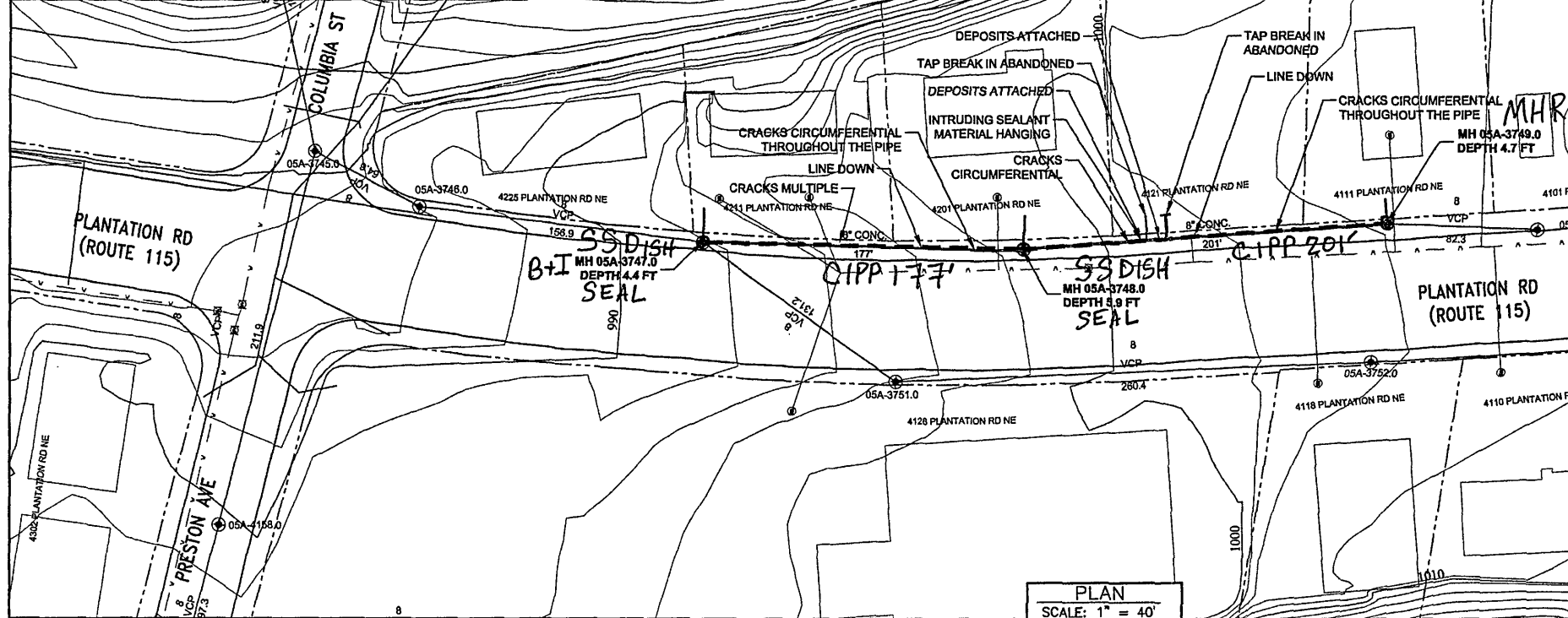

**NOTES:**

- 1. ALL SEWER LINES WILL BE REHABILITATED USING CURED-IN-PLACE PIPE (CIPP) OR FOLD AND FORM.**
- 2. ALL POINT REPAIRS SHALL BE LINED THROUGH.**
- 3. CONTINUOUS SEWAGE FLOW MUST BE MAINTAINED AT ALL TIMES. FLOW-THROUGH PLUGS WILL BE ACCEPTABLE. CONTRACTOR IS RESPONSIBLE FOR BY-PASS PUMPING.**
- 4. REFER TO SHEET G-5 FOR TRAFFIC CONTROL.**
- 5. ALL ACTIVE SEWER SERVICE CONNECTIONS SHALL BE REINSTATED.**
- 6. ALL ABANDONED/CAPPED SEWER SERVICE CONNECTIONS SHALL NOT BE REINSTATED.**
- 7. NO SURVEY HAS BEEN PERFORMED. LOCATION OF ALL UTILITY INFORMATION ON THE PLANS IS FROM WESTERN VIRGINIA WATER AUTHORITY GIS.**

MANHOLE NUMBER	REQUIRED REHABILITATION/REPLACEMENT
MH 05A-3764.0	CHIMNEY SEALANT AND INFLOW PROTECTION INSERT, REMOVE STEPS
MH 05A-3763.0	CHIMNEY SEALANT AND INFLOW PROTECTION INSERT, REMOVE STEPS

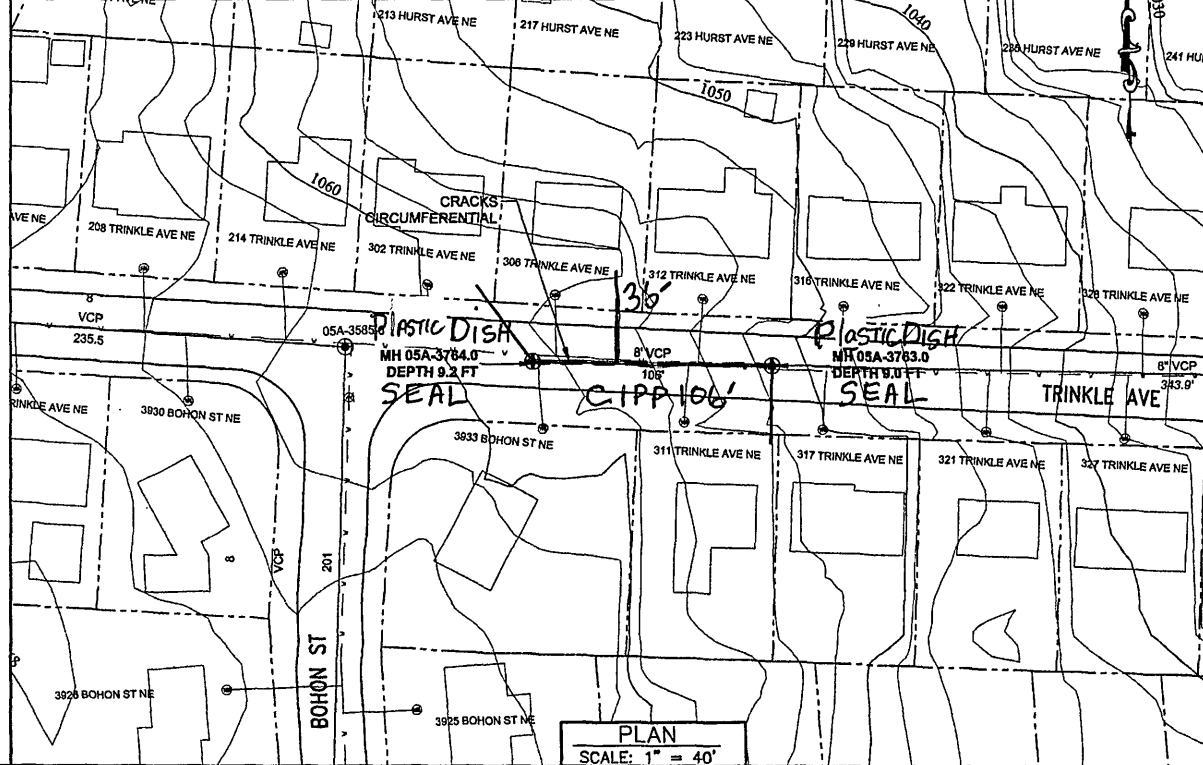

# STU

5540 FALMOUTH STREET, SUITE 201  
RICHMOND, VIRGINIA 23230  
(804)965-9000 [www.URScorp.com](http://www.URScorp.com)



**WESTERN VIRGINIA  
WATER AUTHORITY**

*As-Built*

**TINKER CREEK SEWER REHABILITATION**

PLANTATION ROAD AND TRINKLE AVENUE

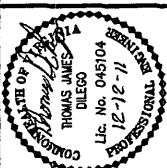

DATE: DECEMBER 2011  
JOB NO.: 11658086  
LEAD ENGINEER: tjd  
DRAWN BY: wlj  
CHECKED: tkf

REVISION:

C-4

SHEET 9 OF 9