

GENERAL NOTES

PRE-CONSTRUCTION MEETING AND CONSTRUCTION COMMENCEMENT:

- All construction methods and materials shall conform to the Construction Standards and Specifications of Roanoke County, the Western Virginia Water Authority, and the Virginia Department of Transportation.
 - Stormwater Management Agreements with an attached 8 1/2" x 11" or 8 1/2" x 14" plat must be approved and recorded prior to the pre-construction meeting.
 - Once all required items are submitted to the County of Roanoke, the developer must contact the Development Review Coordinator to indicate that a pre-construction meeting needs to be scheduled. The pre-construction meeting will be scheduled with the owner/developer two (2) working days later.
 - Please note the 2001 General Assembly revisions to VA Erosion and Sediment Control Law. Effective July 1, 2001, all land disturbing projects that require approval of an erosion and sediment control plan, grading or clearing permit shall require that the applicant provide the name of an individual who will be responsible for land disturbing activities and that this individual hold a Responsible Land Disturber (RLD) Certificate from the Department of Conservation and Recreation. The Responsible Land Disturber can be anyone from the Project team that is certified by the State of Virginia to be in charge of carrying out the land disturbing activity for the project.
 - It is the responsibility of the owner/developer to notify the certified Responsible Land Disturber and the Utility Contractor to attend the pre-construction meeting.
 - The Development Review Coordinator will schedule the pre-construction meeting with the County Review Engineer, the County Inspector, and the Western Virginia Water Authority and the Town of Vinton Public Works Department if applicable.
 - An approved set of plans and all permits must be available at the construction site at all times.
 - The developer and/or contractor shall supply all utility companies with copies of approved plans, advising them that all grading and installation shall conform to approved plans.
 - The project engineer will inform the owner/developer verbally and in writing of the County's obligation to perform inspections on site. Everyone in the meeting will be required to sign a pre-construction checklist indicating their knowledge of Roanoke County's obligation to perform inspections on site.
 - The Erosion Control Permit is given to the developer at this pre-construction meeting.
 - The developer MUST contact the project inspector 24 hours before beginning any grading or construction on the property.
 - The project inspector will visit the site within 48 hours of the developer's call to ensure that all necessary erosion and sediment control measures are properly installed according to the approved plan.
 - All work shall be subject to inspection by Roanoke County, the Western Virginia Water Authority and the Virginia Department of Transportation Inspectors.
 - Contractors shall notify utilities of proposed construction at least two (2), but not more than ten (10) working days in advance. Area public utilities may be notified thru "Miss Utility": 1-800-552-7001.
 - 100 year Floodway and Floodplain information shall be shown where applicable. FIRM Index Date shall be shown on the plans. The 100 year Floodway shall be staked prior to any construction.
 - Grade stakes shall be set for all curb and gutter, culvert, sanitary sewer and storm sewer at all times of construction.
 - The Department of Community Development shall be notified when a spring is encountered during construction.
 - Construction debris shall be containerized in accordance with the Virginia Litter Control Act. No less than one litter receptacle shall be provided on site.
 - The contractor shall provide adequate means of cleaning mud from trucks and/or other equipment prior to entering public streets or rights of ways. It is the contractors responsibility to insure that the streets are in a clean, mud and dust free condition at all times.
 - Plan approval in no way relieves the developer or contractors of the responsibilities contained within the erosion and sediment control policies.
 - Field construction shall honor proposed drainage divides as shown on plans.
 - Field corrections shall be approved by the Roanoke County Engineering Division and/or the Western Virginia Water Authority and the Professional of Record, prior to such construction.
 - The developer or contractor shall supply the County and the Western Virginia Water Authority with correct As-Built plans before final acceptance.
- VIRGINIA DEPARTMENT OF TRANSPORTATION:**
- Plan approval by Roanoke County does not guarantee issuance of any permits by the Virginia Department of Transportation.
 - A permit must be obtained from the Virginia Department of Transportation, Salem Residency Office prior to construction in the highway right-of-way.
 - The preliminary pavement designs should be based on a predicted sub-grade CBR value of 7.0 and with a Resiliency Factor (RF) of 2.0 as shown in Appendix I of the 2000 Virginia Department of Transportation Pavement Design Guide for Subdivision and Secondary Roads. The sub-grade soil is to be tested by an independent laboratory and the results submitted to the Virginia Department of Transportation prior to base construction. Should the sub-grade CBR value and/or the RF value be less than the predicted values, additional base material will be required in accordance with Departmental specifications. Refer to the same manual as the number and locations of the required soil samples to be tested. All pavement designs shall be submitted to the Department for review and approval. The sub-grade shall be approved by the Virginia Department of Transportation prior to placement of the base. Base shall be approved by the Virginia Department of Transportation for depth, template, and compaction before the surface is applied.
 - Standard guardrail with safety end sections may be required on fills or in areas where hazards exist as deemed necessary. After completion of rough grading operations, the County Engineer and Virginia Department of Transportation shall be contacted to schedule a field review. Where guard rail is warranted, the standard shoulder width shall be provided and the guard rail shall be installed in accordance with the 2001 VDOT Road and Bridge Standards as part of this development.
 - Standard street and traffic control signs shall be erected at each intersection by the developer prior to final street acceptance.
 - All traffic devices shall be in accordance with current edition of the manual: "Uniform Traffic Control Devices (MUTCD)"
 - All unsuitable material shall be removed from the construction limits of the roadway before placing embankment.

The Project Engineer shall provide electronic copies of the approved plans to the Development Review Coordinator within 5 working days of the pre-construction meeting. This sheet may not be modified.

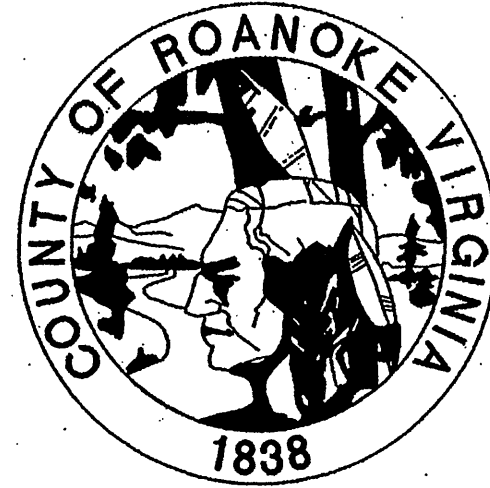

County of Roanoke, VA

NAME OF DEVELOPMENT	URGENT CARE FACILITY FOR MEDEXPRESS	OWNER/DEVELOPER: AM AWARE OF THE SITE DESIGN REQUIREMENTS IMPOSED BY THIS SITE DEVELOPMENT PLAN AND OTHER APPLICABLE ROANOKE COUNTY CODES. I HEREBY CERTIFY THAT I AGREE TO COMPLY WITH THESE REQUIREMENTS AND THE THIRTY (30) POINTS SHOWN ON THIS COVER SHEET UNLESS MODIFIED IN ACCORDANCE WITH LOCAL LAW.
MAGISTERIAL DISTRICT(S)	HOLLINS	
OWNER	VOKA PROPERTIES LLC PO BOX 163 VINTON, VA 24179	
DEVELOPER	MEDEXPRESS CONTACT: ERIC DIETZ 1751 EARL CORE ROAD MORGANTOWN, WV 26505 MOBILE: 304-282-6086	
ENGINEER AND SURVEYOR:	PARKER DESIGN GROUP 816 BOULEVARD SALEM, VA PHONE: 540-387-1153 FAX: 540-389-5767	
TAX MAP NO(S)	038.10-05-07.00 & 038.10-05-08.00	ZONE: C2 USE: MEDICAL OFFICE

WATER NOTES

All water facilities shall be installed according to the Western Virginia Water Authority Design and Construction Standards/ (Latest Edition).

A minimum cover of three (3) feet is required over proposed lines.

Contractor shall be responsible for locating and uncovering valve vaults after paving and adjustment to final grade if necessary.

All existing utilities may not be shown in their exact location. The contractor shall comply with the (State Water Works Regulations, Section 12.05.03, where lines cross.

All trenches in existing or future highway right-of-ways shall be compacted according to Virginia Department of Transportation standards.

Lines shall be staked prior to construction.

Water main shall be minimum Class 350 Ductile Iron in accordance to AWWA C151 or DR-14 PVC in accordance with AWWA C-900.

Ductile Iron Pipe in accordance with the Western Virginia Water Authority Design and Construction Standards shall be required for all pipe with a working pressure equal to or greater than 100 p.s.i.

EXISTING METER TO BE UTILIZED FOR THIS PROJECT

WESTERN VIRGINIA WATER AUTHORITY
AVAILABILITY LETTER NUMBER: 12-188

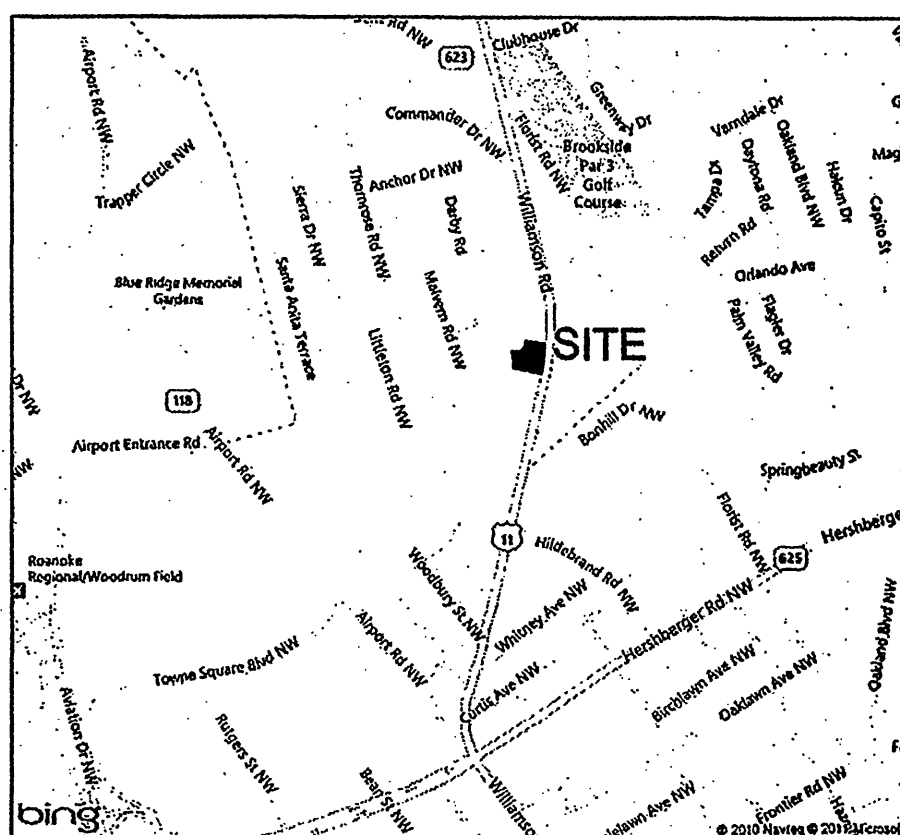

Vicinity Map

LEGEND

Property Line	---
Right-of-way	--- R/W ---
Centerline	--- CL ---
Minimum Building Line	--- MBL ---
Existing Storm Sewer	--- SAN ---
Existing Sanitary Sewer	--- SAN ---
Existing Water Main	--- W ---
Existing Contour	--- 1048 ---
Proposed Contour	--- 1048 ---
Proposed Drainage Divide	--- LIM ---
Proposed Limits of Clearing	--- LIM ---
Proposed Storm Sewer	--- 8" M.H. ---
Proposed Sanitary Sewer	--- 8" M.H. ---
Proposed Water Main	--- 8" M.H. ---

SEWER NOTES

All sanitary sewer facilities shall be installed according to the Western Virginia Water Authority Design and Construction Standards. (Latest Edition).

A minimum cover of three (3) feet is required over proposed lines.

Contractor shall be responsible for locating and uncovering all manholes after paving. Manhole tops shall be adjusted to grade if necessary.

All existing utilities may not be shown in their exact location. The contractor shall comply with (State Water Works Regulations, Section 12.05.03, where lines cross.)

All trenches in existing or future rights-of-way shall be compacted according to Virginia Department of Transportation standards.

Lines shall be staked prior to construction.

NEW SEWER LATERAL TO UTILIZE EXISTING CONNECTION

PRIVATE UTILITIES

Underground utilities installed on private property or in private utility easements and building related storm drains shall be designed and installed per the current edition of the Virginia Uniform Statewide Building Code. Design and installation requirements issued by the Western Virginia Water Authority that meet or exceed the USBC requirements are acceptable for private utilities. All private utilities are to be permitted through and inspected by the Roanoke County Inspections Office. Vaults, valves and other devices installed by or under the control of the Western Virginia Water Authority may not substituted for the code required devices.

- C01 ROANOKE COUNTY COVER SHEET
- C02 EXISTING CONDITIONS, DEMOLITION & INITIAL ESC PLAN
- C03 SITE LAYOUT & DIMENSIONAL PLAN
- C04 SITE UTILITY PLAN
- C05 GRADING & EROSION & SEDIMENT CONTROL PLAN
- C06 DETAILED GRADING PLAN
- C07 EROSION & SEDIMENT CONTROL NARRATIVE
- C08 EROSION & SEDIMENT CONTROL DETAILS
- C09 STORM PROFILES & DETAILS
- C10 STORM & WATER DETAILS & WATER PROFILE
- C11 SANITARY SEWER PROFILES & DETAILS
- C12 SITE DETAILS
- L01 LANDSCAPE PLAN

Index

SURVEY INFORMATION

Horizontal and vertical control surveys were performed in year:
January 2012 & Roanoke County aerial.

All vertical elevations must be referenced to the National Geodetic Vertical Datum of 1929 or 1988. All horizontal elevations must be referenced to the North American Datum of 1927 or 1983.

Source of topographic mapping is dated January 2012 by Parker Design Group

Boundary was performed by: Parker Design Group - Jan. 27, 2012

Benchmark Information: BM#1 is IPF at Southern Prop. Corner along Williamson RD. ELEV = 1105.94
BM#2 is IPF on Western Property Line. ELEV = 1109.11

The professional seal and signature certifies the boundary survey and topographic mapping to be accurate and correct.

QUANTITY & COST ESTIMATE

ITEM	QUANTITY	UNIT	UNIT PRICE	COST	BONDABLE
CLEARING AND GRUBBING		ACRES			
EXCAVATION		C.Y.			
EMBANKMENT		C.Y.			
CURB INLET DI-36, L=4'	2	EACH	\$2,500.00	\$5,000.00	
DI-1 GRATE INLET	1	EACH	\$2,500.00	\$2,500.00	
MANHOLE MH-		EACH			
MANHOLE MH-		*EACH			
15 -IN. CONCRETE PIPE, CLASS III	145	LIN. FT.	\$25.00	\$3,625.00	
6 -IN. HDPE	200	LIN. FT.	\$15.00	\$3,000.00	
BOX CULVERT		LUMP SUM			
CONCRETE FLUME		LIN. FT.			
PAVED DITCH		LIN. FT.			
RIPRAP - CLASS		S.F.			
SODDED SWALE		S.Y.			
-IN. CONCRETE ENDWALL EW-		EACH			
-IN. END SECTION ES-		EACH			
CURB & GUTTER CG-6	190	LIN. FT.	\$19.00	\$3,610.00	
CURB CG-2	250	LIN. FT.	\$15.00	\$3,750.00	
VALLEY GUTTER		EACH			
GRAVEL BASE		S.Y.			
SURFACE TREATMENT					
1.5 -IN. BIT. CONC.: TYPE SM 9.5A		TON			
2 -IN. BIT. CONC.: TYPE SM 9.5A	180	TON	\$80.00	\$14,400.00	
3 -IN. BIT. CONC.: TYPE BM 25	141	TON	\$80.00	\$11,280.00	
8 -IN. SUBBASE MATERIAL	800	TON	\$15.00	\$12,000.00	
SIDEWALK	160	SY	\$50.00	\$8,000.00	
TRAFFIC BARRICADE		EACH			
6" WATER LINE	17	LIN. FT.	\$25.00	\$425.00	
1.5" WATER LINE	160	LIN. FT.	\$12.00	\$1,920.00	
FIRE HYDRANT ASSEMBLIES	1	EACH	\$2,500.00	\$2,500.00	
BLOW OFFS W/VAULT, FRAME & COVER		EACH			
6-IN. GATE VALVES, W/VAULT, FRAME & COVER	1	EACH	\$500.00	\$500.00	
12" x 6" TAPPING SLEEVE	1	EACH	\$500.00	\$500.00	
6" PVC SDR35 - SANITARY SEWER	160	LIN. FT.	\$20.00	\$3,200.00	
SANITARY SEWER CLEANOUT	3	EACH	\$500.00	\$1,500.00	
STANDARD MANHOLE W/FRAME & COVER		EACH			
SAMPLING MANHOLE/PORT		EACH			
LANDSCAPING	1	LUMP SUM	\$15,000.00	\$15,000.00	
AMENITIES (INCLUDING BUT NOT LIMITED TO TRAILS, ETC...)		LUMP SUM			
STORMWATER MANAGEMENT		LUMP SUM			
AS-BUILT PLANS (STORM SEWER SYSTEMS)	1	LUMP SUM	\$1,500.00	\$1,500.00	
AS-BUILT PLANS (STORMWATER MANAGEMENT)		LUMP SUM			
SUBTOTAL				\$94,200.00	
10% CONTINGENCY				\$9,420.00	
ESTIMATED TOTAL				\$103,620.00	

I HEREBY CERTIFY THAT THE FOREGOING ESTIMATE REFLECTS THE CURRENT IMPROVEMENT COSTS OF THIS PROJECT.

SIGNED: Eric Dietz DATE: 06-20-2012

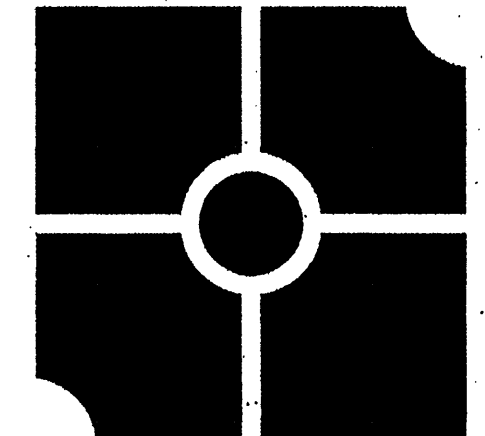

parker
DESIGN GROUP

816 Boulevard
Salem, Virginia 24153
Phone: 540-387-1153
Fax: 540-389-5767
www.parkerdg.com

These documents are the property of Parker Design Group (PDG) and may not be reproduced or used without the express permission of PDG. Any reuse of these documents without authorization of PDG will be at the sole risk of the individual or entity utilizing said documents.

**Urgent Care Facility
Prepared for MedExpress
5610 Williamson Road**
Tax No. 038.10-05-07.00 & 038.10-05-08.00
Hollins Magisterial District; Roanoke County, Virginia

As-Built
1/24/2013

REVISIONS:
Per County VDOT & WVWA Comments
16 May 2012
Per County VDOT & WVWA Comments
20 June 2012

DESIGNED BY: SLR
DRAWN BY: SLR
CHECKED BY: SRB
SCALE: AS SHOWN
DATE: 20 March 2012

SHEET TITLE:

COVER SHEET

C01
01 OF 13
PROJECT NUMBER:
12-0012-02

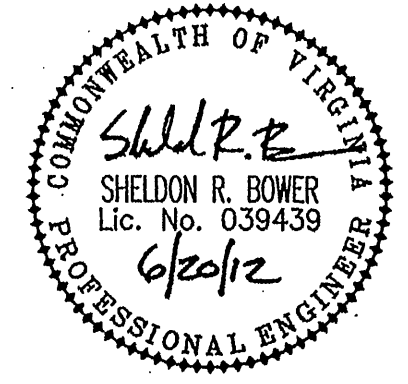

JUL 13 2012

APPROVED
Urgent Care Facility/Med
Express
SP-1200723

REVISED MAY 16, 2012
- PER COUNTY, VDOT & WVWA
COMMENTS

REVISED JUNE 20, 2012
- PER COUNTY, VDOT & WVWA
COMMENTS

DEVELOPMENT PLAN APPROVED FOR CONSTRUCTION BY ROANOKE COUNTY	Date 7/19/12	Department Engineering	Signature Eric Dietz	Signature Sheldon R. Bower
---	-----------------	---------------------------	-------------------------	-------------------------------

**Urgent Care Facility
for MedExpress
5610 Williamson Road
Roanoke County, Virginia**

SHEET
C01
OF
13

APPROVED 07/19/2012
Med Express
Sheldon R. Bower