

COVER SHEET FOR GREENFIELD CAMPUS VWCC WORKFORCE TRAINING CENTER DALEVILLE, VIRGINIA

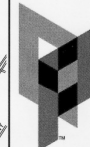
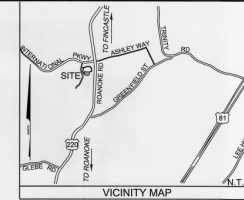

ARCHITECTURAL
PARTNERS

10 9th Street
Lynchburg, Virginia 24004
p.434-846-8455
f.434-846-8454
www.architecturalpartners.com

GREENFIELD CAMPUS
VWCC WORKFORCE TRAINING CENTER
BOTETOURT COUNTY
DALEVILLE, VIRGINIA
PROJECT NO.: 21152

CONSTRUCTION SET



DATE: 15 December 2021
DRAWN: NRO
CHECKED: PCP
LST: 37 43N08
LONG: -79 50533'

GENERAL
NOTES

C-001

AS-Built
11-04-2022
Mark, Fred

EXISTING LEGEND
● R.P. IRON PIN FOUND
▲ ELECTRIC POLE
□ TELEPHONE PEDESTAL
X FIRE HYDRANT
○ WATER METER
○ STORM MANHOLE
○ SANITARY MANHOLE
○ CLEAFOUT
○ LIGHT POLE
○ SIGN
○ GAS METER
○ BENCHMARK
--- EDGE OF PAVEMENT
--- GUARDRAIL
--- EDGE OF WOODS
--- OH E --- OVERHEAD ELECTRIC
--- SE --- US SAN. SEWER LINE
--- C --- CONCRETE

PROPOSED LEGEND
--- LIMITS OF CLEARING/GRADING
--- PROPOSED INDEX CONTOUR
--- PROPOSED CONTOUR
--- STORM SEWER
--- STORM INLET
--- STORM SEWER STRUCTURE LABEL
--- SANITARY SEWER LINE
--- SANITARY SEWER MANHOLE
--- SANITARY STRUCTURE MARKER
--- WATER LINE
--- FIRE HYDRANT
--- GATE VALVE & BOX
--- CONCRETE ANCHOR
--- ACCESSIBLE PARKING SIGN
--- CURB AND GUTTER
--- REVERSE CURB AND GUTTER
--- ASPHALT PAVEMENT
--- CONCRETE

VIRGINIA UNIFORM CODING SYSTEM FOR EROSION AND SEDIMENT CONTROL PRACTICES
* CHART TAKEN FROM THE VIRGINIA EROSION AND SEDIMENT CONTROL HANDBOOK (JULY 1992)

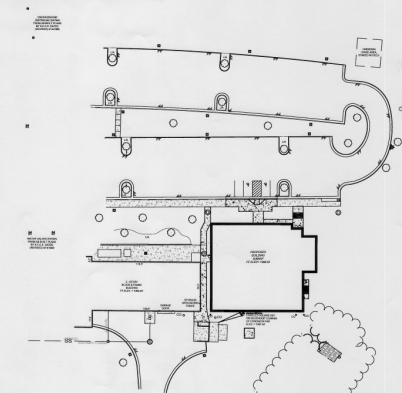

SPOT ELEVATION LEGEND
P PAVEMENT
W WALK
G GROUND
FF FINISH FLOOR
EP EDGE OF PAVEMENT
TC TOP OF CURB
TW TOP OF WALL
BW BOTTOM OF WALL
TS TOP OF STAIRS
BS BOTTOM OF STAIRS
LP LOW POINT
HP HIGH POINT
M2 MATCH GRADE
P-W WALK & PAVEMENT AT EQUAL ELEVATIONS
P-WP PAVEMENT ELEVATION AT HIGH POINT
P-LP PAVEMENT ELEVATION AT LOW POINT
W-WP WALK ELEVATION AT HIGH POINT
W-LP WALK ELEVATION AT LOW POINT
G-WG GROUND ELEVATION TO MATCH EXISTING ELEVATION

ABBREVIATIONS LEGEND
AD ALGEBRAIC DIFFERENCE
AR AIR RELEASE ASSEMBLY
BA BEGINNING OF LINE
CL CLASS
CONC CONCRETE
DUP DUCTILE IRON PIPE
ELEV ELEVATION
EOL END OF LINE
FA FIRE HYDRANT ASSEMBLY
HDPE HIGH DENSITY POLYETHYLENE PIPE
INV INVERT
NOT TO SCALE
OUP OUTLET PROTECTION FOR BYPASS CULVERTS
OUP OUTLET PROTECTION FOR STORM SEWER LINES
PC POINT OF CURVATURE
PI POINT OF INTERSECTION
PT POINT OF TANGENT
PVC POINT OF VERTICAL CURVATURE
PVT POINT OF VERTICAL TANGENT
PVI POINT OF VERTICAL INTERSECTION
POC POINT ON CURVE
PCC POINT OF COMPOUND CURVATURE
RAD RADIUS
RCP REINFORCED CONCRETE PIPE
SCH SCHEDULE
SDR STANDARD DIAMETER RATIO
SPEC SPECIFICATION
SSD STOPPING SIGHT DISTANCE
STA STATION
STD STANDARD
TELECOM TELECOMMUNICATIONS UTILITY
TO BE REMOVED
TYP TYPICAL
VDOT VIRGINIA DEPARTMENT OF TRANSPORTATION

SHEET INDEX
C-001 COVER SHEET
C-002 GENERAL NOTES
C-100 TOPOGRAPHIC SURVEY
C-101 DEMOLITION AND STAGE 1 E&S CONTROL PLAN
C-102 SITE AND UTILITY LAYOUT
C-103 GRADING AND STAGE 2 E&S CONTROL PLAN
C-501 SITE DETAILS
C-502 UTILITY DETAILS
C-503 EROSION CONTROL DETAILS

THE ENGINEER AND/OR SURVEYOR TAKES NO RESPONSIBILITY FOR THE LOCATION OR ACCURACY OF THE UTILITIES AS SHOWN HEREON OR ANY UTILITIES WITHIN THE PROJECT THAT MAY NOT BE SHOWN HEREON. THE CONTRACTOR SHALL BE RESPONSIBLE FOR CONTACTING THE UTILITY COMPANIES TO SEE IF ANY UTILITIES EXIST WITHIN THE AREA OF THE PROJECT BEFORE ANY CONSTRUCTION BEGINS. ANY COST INCURRED BY DAMAGING ANY UTILITY WITHIN THE PROJECT SHALL BE AT THE EXPENSE OF THE CONTRACTOR.



APPROVED
By David S. Olivera, Planning & Zoning at 1:48 pm, Feb 15, 2022

APPROVED
By David S. Olivera, PE at 11:45 am, Feb 16, 2022

VIRGINIA CERTIFIED RESPONSIBLE LAND DISTURBER
NAME: PRINTED SIGNATURE DATE
PHONE # COMPANY
ADDRESS

434.847.7788
2024 LANGHORNE ROAD
LYNCHBURG, VA 24004

20201452

HURT & PROFFITT
INSPIRED / RESPONSIVE / TRUSTED



434.847.7788
2024 LANGHORNE ROAD
LYNCHBURG, VA 24004

ENGINEERING • SURVEYING • LAND DEVELOPMENT • ENVIRONMENTAL
GEOCHEMISTRY • CONSTRUCTION TESTING & INSPECTION • CULTURAL RESOURCES