

REQUIRED LANDSCAPE CROWN COVERAGE: 35% OF 1.11 AC

REQUIRED LANDSCAPE CROWN COVERAGE: 35% OF 1.11 AC  
35% REQUIRED -- 16,923 SF

STRAW	BOTANICAL NAME	COMMON NAME	PLANTING SPECIES	QUANTITY	CANOPY (A)	CANOPY (TOTAL)

SIMIL	STANDARD NAME	CUSTOM NAME	PARTIAL SPEC.	QUANTITY	GROSS (LBS)	GROSS (TOTAL)
	K&N R-99-M VOTERBEE GLASS	VOTERBEE GLASS <sup>®</sup> RED WAFLE	NIS. PLATING SIZE 1.5" CUPPER RHS	54	1,250 SF	17,500 SF

1. ALL CONSTRUCTION METHODS AND MATERIALS SHALL CONFORM TO THE LATEST WYMA DESIGN AND CONSTRUCTION STANDARDS

- [illegible]

1. ALL SANITARY SEWER CONNECTIONS TO EXISTING LINES SHALL BE COORDINATED AND

1. ALL SANITARY SEWER CONNECTIONS TO EXISTING LINES SHALL BE COORDINATED AND PERFORMED BY THE WESTERN VIRGINIA WATER AUTHORITY.
2. ALL WATER AND SANITARY SEWER FACILITIES ARE TO BE INSTALLED ACCORDING THE WESTERN VIRGINIA WATER AUTHORITY DESIGN AND CONSTRUCTION STANDARDS.
- WATER NOTES:

1. ALL WATER CO

1. ALL WATER CONNECTIONS TO EXISTING LINES SHALL BE COORDINATED AND PERFORMED BY THE WESTERN NIMRODA WATER AUTHORITY.
2. ALL WATER AND SANITARY SEWER FACILITIES ARE TO BE INSTALLED ACCORDING TO THE WESTERN NIMRODA WATER AUTHORITY DESIGN AND CONSTRUCTION STANDARDS.
3. PLEASE PROVIDE 5 DAYS NOTICE TO THE WMA FOR ANY ANTICIPATED WATER OUTAGE TO ALLOW THE WMA TIME TO SCHEDULE AND NOTIFY AFFECTED CUSTOMERS (340) 357-3460.

LOT #	INV. ELEV. @ S.S. MAIN	MIN. BLOD. ELEV.	PROCP. F.F.E.
1	10.00	10.00	10.00
2	10.00	10.00	10.00
3	10.00	10.00	10.00
4	10.00	10.00	10.00
5	10.00	10.00	10.00
6	10.00	10.00	10.00
7	10.00	10.00	10.00
8	10.00	10.00	10.00
9	10.00	10.00	10.00
10	10.00	10.00	10.00
11	10.00	10.00	10.00
12	10.00	10.00	10.00
13	10.00	10.00	10.00
14	10.00	10.00	10.00
15	10.00	10.00	10.00
16	10.00	10.00	10.00
17	10.00	10.00	10.00
18	10.00	10.00	10.00
19	10.00	10.00	10.00
20	10.00	10.00	10.00
21	10.00	10.00	10.00
22	10.00	10.00	10.00
23	10.00	10.00	10.00
24	10.00	10.00	10.00
25	10.00	10.00	10.00
26	10.00	10.00	10.00
27	10.00	10.00	10.00
28	10.00	10.00	10.00
29	10.00	10.00	10.00
30	10.00	10.00	10.00
31	10.00	10.00	10.00
32	10.00	10.00	10.00
33	10.00	10.00	10.00
34	10.00	10.00	10.00
35	10.00	10.00	10.00
36	10.00	10.00	10.00
37	10.00	10.00	10.00
38	10.00	10.00	10.00
39	10.00	10.00	10.00
40	10.00	10.00	10.00
41	10.00	10.00	10.00
42	10.00	10.00	10.00
43	10.00	10.00	10.00
44	10.00	10.00	10.00
45	10.00	10.00	10.00
46	10.00	10.00	10.00
47	10.00	10.00	10.00
48	10.00	10.00	10.00
49	10.00	10.00	10.00
50	10.00	10.00	10.00
51	10.00	10.00	10.00
52	10.00	10.00	10.00
53	10.00	10.00	10.00
54	10.00	10.00	10.00
55	10.00	10.00	10.00
56	10.00	10.00	10.00
57	10.00	10.00	10.00
58	10.00	10.00	10.00
59	10.00	10.00	10.00
60	10.00	10.00	10.00
61	10.00	10.00	10.00
62	10.00	10.00	10.00
63	10.00	10.00	10.00
64	10.00	10.00	10.00
65	10.00	10.00	10.00
66	10.00	10.00	10.00
67	10.00	10.00	10.00
68	10.00	10.00	10.00
69	10.00	10.00	10.00
70	10.00	10.00	10.00
71	10.00	10.00	10.00
72	10.00	10.00	10.00
73	10.00	10.00	10.00
74	10.00	10.00	10.00
75	10.00	10.00	10.00
76	10.00	10.00	10.00
77	10.00	10.00	10.00
78	10.00	10.00	10.00
79	10.00	10.00	10.00
80	10.00	10.00	10.00
81	10.00	10.00	10.00
82	10.00	10.00	10.00
83	10.00	10.00	10.00
84	10.00	10.00	10.00

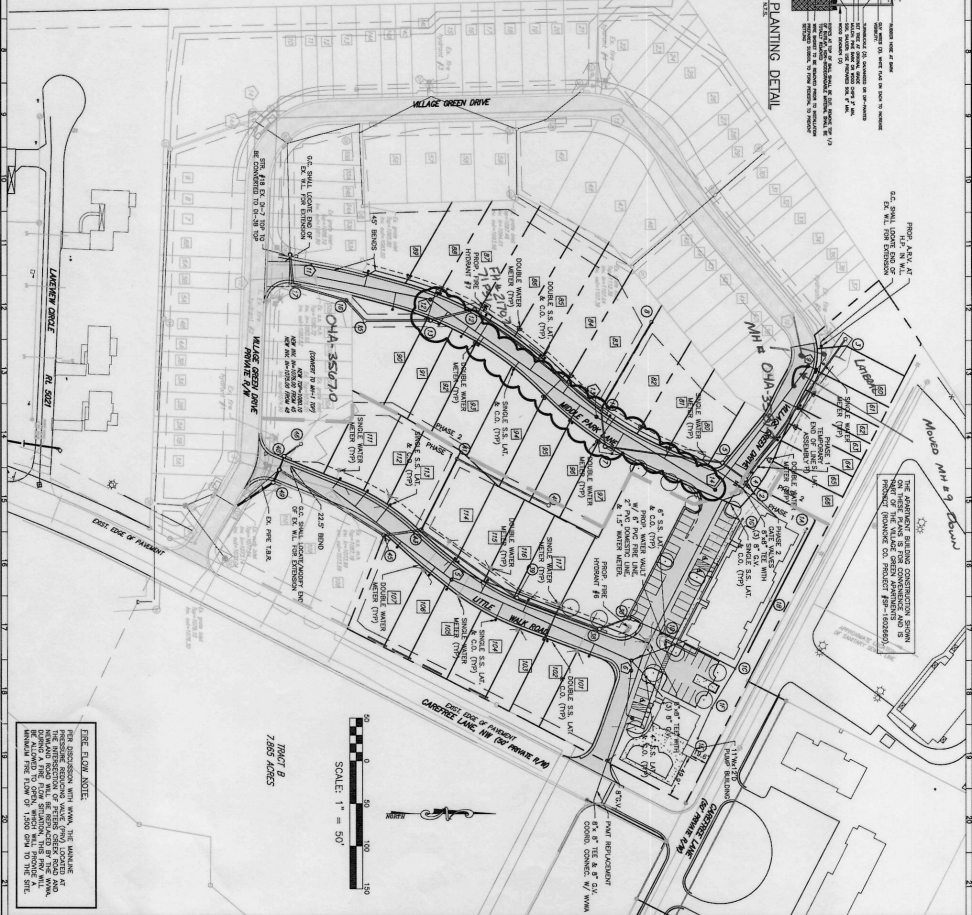
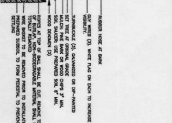
[illegible]

APPROVED, 5/18/202

C4  
JOB NO. 04170034.00

THE VILLAGE GREEN PHASE III  
CAREFREE LANE  
UTILITY & LANDSCAPE PLAN  
HOLLINS DISTRICT  
ROANOKE COUNTY VIRGINIA



1201 Corporate Center  
Riverside, VA 24011  
540-772-9280  
FAX 540-772-8060

Baker and Associates, Inc.  
1501 Colorado Circle