

1. AFTER APPROXIMATE FINAL GRADE IS REACHED, UTILITY CONSTRUCTION SHALL BEGIN. INLET PROTECTION SHALL BE INSTALLED ON ALL NEW INLETS IMMEDIATELY FOLLOWING INSTALLATION TO PROTECT AGAINST NEW STORM DRAIN SYSTEM.
2. G.C. SHALL COORDINATE WITH THE ENGINEER TO HAVE ALL STORM SEWER AS-BUILTS COMPLETED AND SUBMITTED TO ROADNOKE COUNTY.
3. AFTER STORM SEWER INLETS ARE INSTALLED AND PROPOSED DRAINAGE PATTERNS ARE ESTABLISHED, THE SEDIMENT TRAPS AND DIVERSIONS MAY BE REMOVED. G.C. SHALL DISCUSS WITH ROADNOKE COUNTY INSPECTOR PRIOR TO REMOVAL.
4. FOLLOWING UTILITY INSTALLATION, CURB AND GUTTER AND ROADWAY BASED STONE SHALL BE INSTALLED.
5. ALL AREAS NOT RECEIVING PAYMENT OR CURB AND GUTTER SHALL RECEIVE PERMANENT SEEDING AS SOON AS POSSIBLE AFTER REACHING FINAL GRADE.
6. AFTER FINAL STABILIZATION IS ACHIEVED, SILT FENCE AND INLET PROTECTION MAY BE REMOVED.
7. G.C. SHALL OBTAIN APPROVAL FROM THE ROADNOKE COUNTY INSPECTOR PRIOR TO REMOVAL OF ANY ESC MEASURES.
8. SEE SHEET C7 FOR PHASE 1 ESC PLAN.
9. LIMITS OF DISTURBANCE SHALL BE STRICTLY ADHERED TO.

3.02	TEMPORARY STONE CONSTRUCTION ENTRANCE	CE
3.05	SILT FENCE	SF
3.07	STORM DRAIN INLET PROTECTION	IP
3.31	TEMPORARY SEEDING	TS
3.32	PERMANENT SEEDING	PS
3.35	MULCHING	MU
3.36	SOIL STABILIZATION BLANKETS & MATTING	B/M

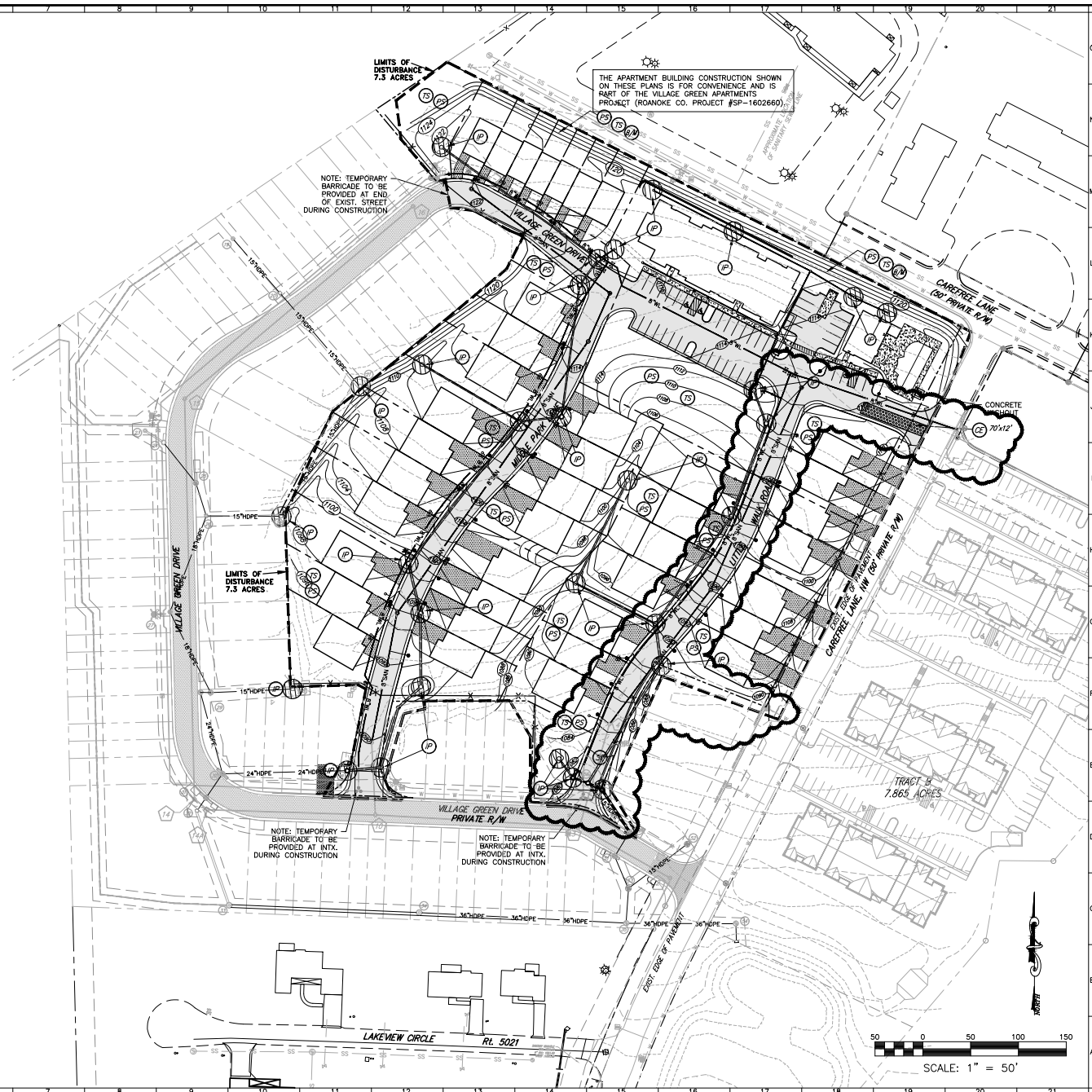

BALZER
AND ASSOCIATES, INC.
WINNER
REFLECTING TOMORROW
www.balzer.cc

Roanoke
New River Valley
Richmond
Staunton
Harrisonburg

RESIDENTIAL LAND DEVELOPMENT/ENGINEERING
SITE DEVELOPMENT/ENGINEERING
LAND USE PLANNING & ZONING
LANDSCAPE ARCHITECTURE
LAND SURVEYING
ARCHITECTURE
STRUCTURAL ENGINEERING
TRANSPORTATION/ENGINEERING
ENVIRONMENTAL & SOIL SCIENCE
WETLAND DELINEATIONS & STREAM EVALUATIONS

Balzer and Associates, Inc.
1208 Corporate Circle
Roanoke, VA 24018
540-772-9580
FAX 540-772-8050



THE VILLAGE GREEN PHASE III
CAREFREE LANE

PHASE II ESC PLAN

HOLLINS DISTRICT
ROANOKE COUNTY, VIRGINIA

DRAWN BY _____ CPB
DESIGNED BY _____ CPB
CHECKED BY _____ BTC
DATE 1/5/2018
SCALE 1"=50'
REVISIONS:
3/23/2018
4/13/2018
5/2/2018
8/9/2019 P.R. #1
1/10/2020 P.R. #2

SHEET NO.
C8
JOB NO. 04170034.00