

MATCHLINE - SHEET 11

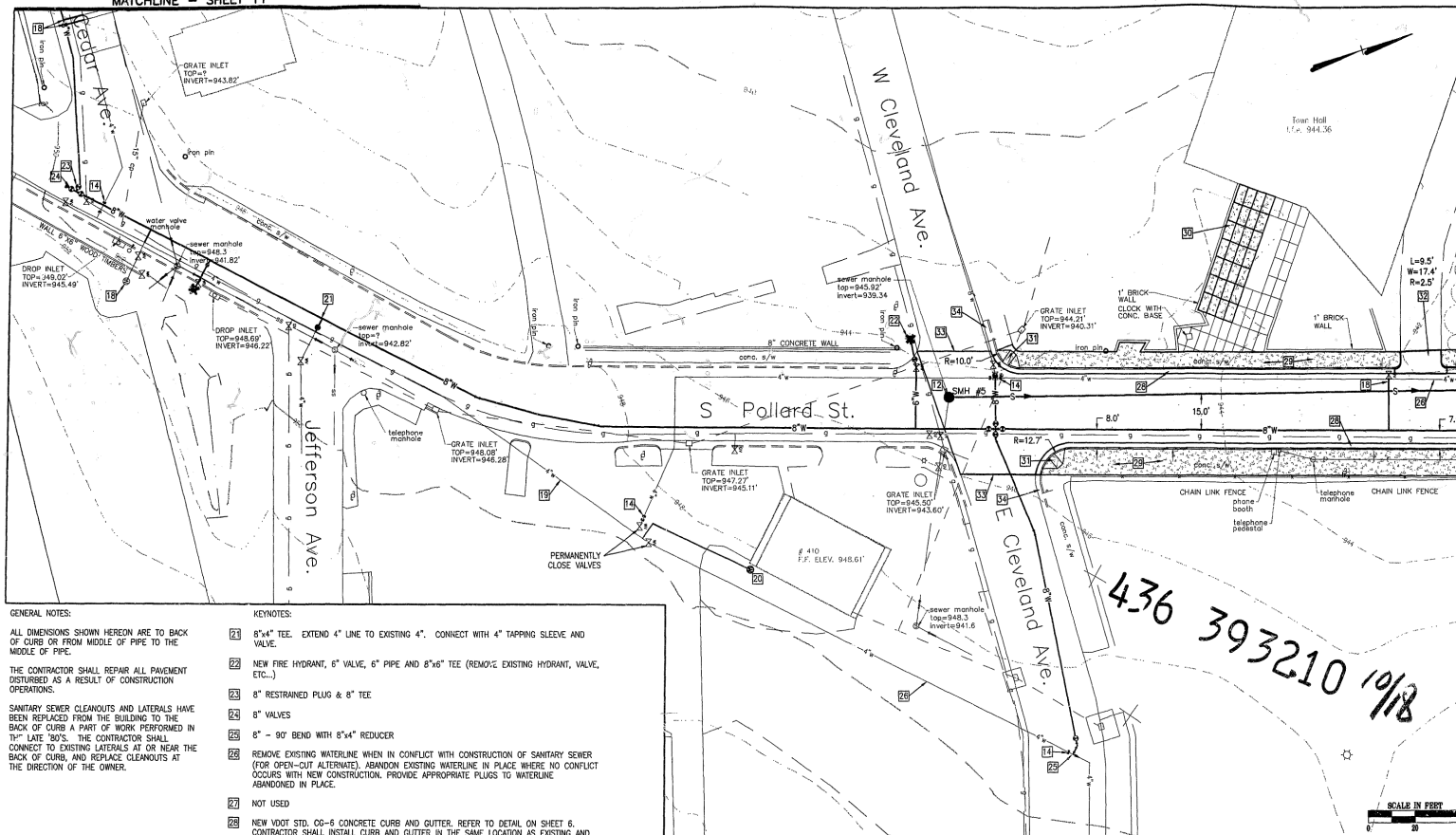

GENERAL NOTES:

ALL DIMENSIONS SHOWN HEREON ARE TO BACK OF CURB OR FROM MIDDLE OF PIPE TO THE MIDDLE OF PIPE.

THE CONTRACTOR SHALL REPAIR ALL PAVEMENT DISTURBED AS A RESULT OF CONSTRUCTION OPERATIONS.

SANITARY SEWER CLEANOUTS AND LATERALS HAVE BEEN REPLACED FROM THE BUILDING TO THE BACK OF CURB A PART OF WORK PERFORMED IN THE LATE '80'S. THE CONTRACTOR SHALL CONNECT TO EXISTING LATERALS AT OR NEAR THE BACK OF CURB, AND REPLACE CLEANOUTS AT THE DIRECTION OF THE OWNER.

KEYNOTES:

- 21 8"x4" TEE. EXTEND 4" LINE TO EXISTING 4". CONNECT WITH 4" TAPPING SLEEVE AND VALVE.
- 22 NEW FIRE HYDRANT, 6" VALVE, 6" PIPE AND 8"x6" TEE (REMOVE EXISTING HYDRANT, VALVE, ETC.)
- 23 8" RESTRAINED PLUG & 8" TEE
- 24 8" VALVES
- 25 8" - 90° BEND WITH 8"x4" REDUCER
- 26 REMOVE EXISTING WATERLINE WHEN IN CONFLICT WITH CONSTRUCTION OF SANITARY SEWER (FOR OPEN-OUT ALTERNATE). ABANDON EXISTING WATERLINE IN PLACE WHERE NO CONFLICT OCCURS WITH NEW CONSTRUCTION. PROVIDE APPROPRIATE PLUGS TO WATERLINE ABANDONED IN PLACE.
- 27 NOT USED
- 28 NEW VDOT STD. CO-6 CONCRETE CURB AND GUTTER. REFER TO DETAIL ON SHEET 6. CONTRACTOR SHALL INSTALL CURB AND GUTTER IN THE SAME LOCATION AS EXISTING AND ENSURE THAT RUNOFF DRAINS AWAY FROM ENTRANCES, AND BUILDINGS AND TOWARD EXISTING INLETS.
- 29 NEW CONCRETE SIDEWALK. SEE DETAIL ON SHEET 7 FOR TYPICAL SIDEWALK SECTION. CONTRACTOR SHALL CONSTRUCT SIDEWALK SUCH THAT RUNOFF IS DIRECTED TOWARD CURB AND GUTTER AND AWAY FROM BUILDINGS. CONTRACTOR SHALL INSTALL EXPANSION JOINT MATERIAL AROUND ALL EXISTING LIGHT POLES, WATER METERS & VALVE BOXES, GAS VALVES ETC... PRIOR TO POURING NEW SIDEWALKS.
- 30 NEW CONCRETE ENTRANCE. EACH SLAB SHALL BE 4'x8' WITH 1/2" CONSTRUCTION JOINTS B/W SLABS. SEE SIDEWALK DETAIL ON SHEET 7.
- 31 NEW VDOT STD. CO-12 HANDICAP RAMP. SEE DETAIL ON SHEET 8.
- 32 NEW DRIVE AND DIMENSIONS AS SHOWN ON PLANS. SEE DETAIL ON SHEET 9.
- 33 LIMITS OF PAVEMENT PLANNING AND OVERLAY. REFER TO TYPICAL SECTION-PAVEMENT OVERLAY ON SHEET 6.
- 34 EXISTING CURB AND GUTTER TO REMAIN.

KEYNOTES:

- 11 NOT USED
- 12 NOT USED
- 13 8"x4" TEE AND VALVES
- 14 NOT USED
- 15 NOT USED
- 16 NOT USED
- 17 NOT USED
- 18 CONNECT WATER SERVICE TO NEW PIPE
- 19 EXISTING 4" WATERLINE SHALL REMAIN IN SERVICE TO THE LOCATION SHOWN ABOVE. PERMANENTLY CLOSE VALVES IN PARKING LOT ONCE FINAL CONNECTIONS HAVE BEEN MADE.
- 20 THE CONTRACTOR SHALL INSTALL A NEW WATER METER AND SERVICE LATERAL TO BUILDING #410. SERVICE SHALL BE THE SAME SIZE AS EXISTING.

KEYNOTES:

- 1 NEW 8" SANITARY SEWER. REFER TO SHEET 12 FOR PROFILE AND ADDITIONAL INFORMATION. NOTE: DRAWINGS ARE DRAWN FOR OPEN OUT ALTERNATE.
- 2 NOT USED
- 3 NOT USED
- 4 NEW 8" WATERLINE. REFER TO SHEET 14 FOR PROFILE AND ADDITIONAL INFORMATION.
- 5 NOT USED
- 6 8"x8" CROSS AND 8" VALVES
- 7 NOT USED
- 8 NOT USED
- 9 NOT USED
- 10 NOT USED

MATCHLINE - SHEET 9

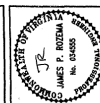

Date	
Revisions	

Issue Date:	MAY 19, 2001
Drawn By:	JPR
Designed By:	JPR
Checked By:	SW
Date App'd:	12/20/01

**Mattem & Craig**  
CONSULTANTS  
701 HUGH STREET, S.E.  
KNOXVILLE, TENNESSEE 37912  
PHONE: (615) 345-9416  
FAX: (615) 345-7991

**PLAN - POLLARD STREET IMPROVEMENTS**  
TOWN OF VINTON, VIRGINIA

Vertical Scale:	N/A
Horizontal Scale:	1"=30'
Commission Number:	19558
Sheet No.:	10

R:\dwg\19558\dwg\Pollard-1.dwg

