

CONSTRUCTION NOTES:

1. General sequence of work shall be excavated repairs, new manhole installation, cured-in-place manhole lining, cure-in-place lateral lining, manhole rehabilitation. All lateral replacements will be performed simultaneous to manhole replacement. All service lateral replacement or rehabilitation using CIPPL connected to cured-in-place mainlines shall not be performed until after the waiting period specified in the Specifications.
2. Unless detours are in place, maintain at least one-lane of traffic and access to all streets, commercial facilities, healthcare facilities and private residences by emergency vehicles, commercial deliveries, trash pick-up and school buses.
3. Restrict construction activities to the limits of the public-right-of-way or the easements shown on the drawings.
4. All initial and final pavement, curb and gutter repair shall be restored in accordance with City of Roanoke Excavation and Restoration Standards, Section 5.
5. Replacement of all service laterals shown to be connected to the rehabilitated sewer main (CIPPL) shall be connected to the rehabilitated sewer main using an Inserta Tee or Wye. All new lateral piping and cleanout assemblies shall be constructed of 4 or 6-inch SDR 35 PVC to match existing pipe diameter and constructed in accordance with the Details.
6. All service laterals shown to be connected to new piping, shall be connected to the new piping using Tees or Wye fittings to match existing service lateral configuration. All new lateral piping and cleanout assemblies shall be constructed of 4 or 6-inch SDR 35 PVC to match existing pipe diameter and constructed in accordance with the Details.
7. All service laterals that are shown to be rehabilitated with CIPPL with a new cleanout shall be televised to verify diameter, configuration and location of existing cleanout (if any). Uncover and expose existing cleanout to facilitate installation of the new lateral liner. Install new cleanout if an existing cleanout does not exist. Install new lateral liner after the required waiting period as described in the Specifications.
8. Dye Test laterals as shown to be abandoned to confirm inactive status. Do not reinstate inactive lateral connections.
9. All the survey information provided by Draper Aden is oriented to Horizontal Datum NAD 83 and Vertical Datum NAVD 88, calculated from static GPS sessions.
10. Elevations of all utilities are estimated. Contractor is responsible for location and protecting all buried utilities.
11. New gravity sewer shall be installed in same trench as existing gravity sewer. Existing gravity sewer and manholes shall be removed at no additional cost to owner.
12. Location of MH A is approximate. Locate MH A in the field as approved by the owner. Install manhole as close to a structurally sound pipe joint to the extent practical.
13. Maintain constant grade between manholes as shown.

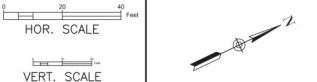

DESIGNED	DRAWN	CHECKED	APPROVED
A.T.	A.T.	J.A.S.	T.C.W.



Plan And Profile –
Crystal Spring Avenue

DATE	JOB NO.	DRAWING NO.	SHEET NO.
FEBRUARY 2018	062859	C8	8 OF 17

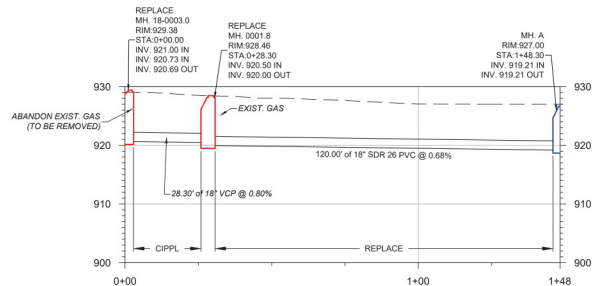
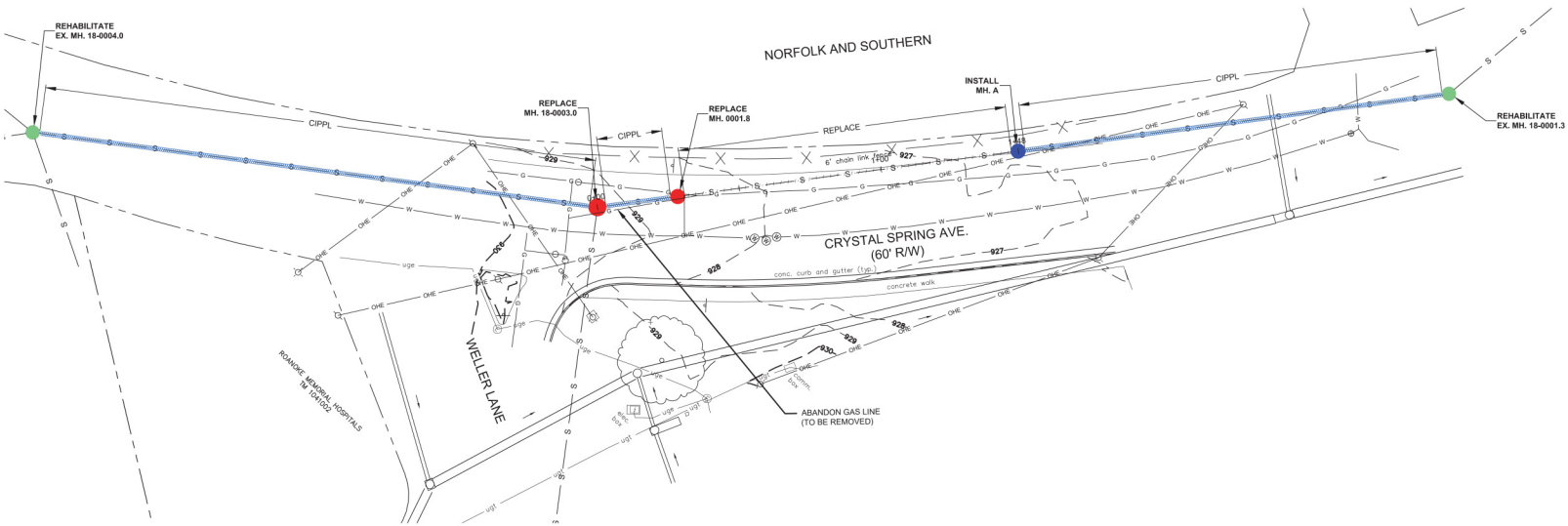

SAN.MH. 18-0003.0 - SAN.MH. A PROFILE