

| | |
|-------------|----------------------------------|
| AB | ANCHOR BOLT |
| ABAN | ABANDON OR ABANDONED |
| ABUT | ABUTMENT |
| ABV | ABOVE |
| ACT | ACOUSTICAL |
| ADD | ADDITIONAL |
| ADJ | ADJACENT |
| AFF | ABOVE FINISH FLOOR |
| AGGR | AGGREGATE |
| ALUM | ALUMINUM |
| ALT | ALTERNATE |
| ANC | ANCHOR |
| APPROX | APPROXIMATE |
| ARCH | ARCHITECTURAL |
| AWWA | AMERICAN WATER WORKS ASSOCIATION |
| AVG | AVERAGE |
| BIT | BITUMINOUS |
| BJ | BELL JOINT |
| BL | BASE LINE |
| BEG | BEGIN OR BEGINNING |
| BLDG | BUILDING |
| BLKG | BLOCKING |
| BM | BENCH MARK, BEAM |
| BOTT | BOTTOM |
| BP | BYPASS |
| BRG | BEARING |
| BSMT | BASEMENT |
| BV | BUTTERFLY VALVE |
| C | CHANNEL, COLD |
| C/C, C TO C | CENTER TO CENTER |
| CAB | CABINET |
| CAP | CAPACITY |
| CF | CUBIC FEET |
| CG | CHANGE OF GRADE |
| C & G | CURB AND GUTTER |
| CI | CAST IRON |
| CIRC | CIRCULAR |
| CKT | CIRCUIT |
| CL | CENTER LINE |
| CLR | CLEAR |
| CONST | CONSTRUCTION |
| COR | CORNER |
| CMP | CORRUGATED METAL PIPE |
| CMU | CONCRETE MASONRY UNITS |
| CND | CONDUIT |
| CO | CLEAN OUT |
| COMB | COMBINATION |
| CONC | CONCRETE |
| CONN | CONNECT, CONNECTION |
| CONT | CONTINUOUS, CONTROL |
| CONTR | CONTRACTOR |
| CONV | CONVEYOR |
| CP | COORDINATE POINT |
| CR STONE | CRUSHED STONE |
| CTR | CENTER |
| CULV | CULVERT |
| CY | CUBIC YARD |
| D | DEPTH OR DEGREE OF CURVE |
| DEPT | DEPARTMENT |
| DF | DRINKING FOUNTAIN |
| DI | DROP INLET, DUCTILE IRON |
| DIA | DIAMETER |
| DIM | DIMENSION |
| DISC | DISCONNECT |
| DMH | DROP MANHOLE |
| DN | DOWN |
| DR | DRIVE |
| DS | DOWN SPOUT |
| DTL | DETAIL |
| DW.D/W | DRIVEWAY |
| DWL | DWELLING |
| DWG | DRAWING |
| E | EAST |
| EA | EACH |
| E.B.L. | EASTBOUND LANE |
| EF | EACH FACE |
| EJ | EXPANSION JOINT |
| EL, ELEV | ELEVATION |
| ELEC | ELECTRICAL |
| ENGR | ENGINEER |
| ENTR | ENTRANCE |
| EOL | END OF LINE |
| EP | EDGE OF PAVEMENT |
| EQ | EQUAL |
| EQPT | EQUIPMENT |
| EW | EACH WAY, ENDWALL |
| EXIST | EXISTING |
| EXP | EXPANSION |
| EXT | EXTERIOR |
| FR | FRAME |
| FD | FLOOR DRAIN |
| FDN | FOUNDATION |
| FES | FLARED END SECTION |

| | |
|------------|--------------------------------|
| FF | FINISH FLOOR |
| FFE | FINISHED FLOOR ELEVATION |
| FIG | FIGURE |
| FIN | FINISH |
| FIXT | FIXTURE |
| FL | FLOOR |
| FLEX | FLEXIBLE |
| FLG | FLANGE |
| FT | FOOT |
| FTG | FOOTING |
| FUT | FUTURE |
| GAL | GALLON |
| GALV | GALVANIZED |
| GAR | GARAGE |
| GND | GROUND |
| GR | GRAVEL |
| GOVT | GOVERNMENT |
| GPM | GALLONS PER MINUTE |
| GRTG | GRATING |
| GV | GATE VALVE |
| GW | GRAY WATER |
| H | HOT |
| HB | HOSE BIBB |
| HK | HOOK |
| HM | HOLLOW METAL |
| HOR, HORIZ | HORIZONTAL |
| HP | HORSE POWER |
| HPT | HIGH POINT |
| HYD | HYDRANT |
| ID | INSIDE DIAMETER |
| IN | INCH |
| INSUL | INSULATION |
| INV | INVERT |
| IP | IRON PIN |
| JT | JOINT |
| JB | JUNCTION BOX |
| L | LENGTH, LONG |
| LF | LINEAL FOOT |
| LG | LONG |
| LP | LIGHT POLE |
| LR | LONG RADIUS |
| LT | LEFT |
| LTG | LIGHTING |
| MACH | MACHINERY |
| MAS | MASONRY |
| MATL | MATERIAL |
| MAX | MAXIMUM |
| MECH | MECHANICAL |
| MFR | MANUFACTURER |
| MH | MANHOLE, MOUNTING HEIGHT |
| MIN | MINIMUM |
| MISC | MISCELLANEOUS |
| MJ | MECHANICAL JOINT |
| MO | MASONRY OPENING |
| MON | MONUMENT |
| MTD | MOUNTED |
| MTG | MOUNTING |
| MTL | METAL |
| MV | MUD VALVE |
| N & C | NAIL AND CAP |
| NIC | NOT IN CONTRACT |
| NO | NUMBER |
| NTS | NOT TO SCALE |
| OC | ON CENTERS |
| OD | OUTSIDE DIAMETER |
| OPER | OPERATOR |
| OPNG | OPENING |
| OPP | OPPOSITE |
| PC | POINT OF CURVE |
| PCC | POINT OF COMPOUND |
| PER | PERIMETER |
| PERF | PERFORATED |
| PERP | PERPENDICULAR |
| PI | POINT OF INTERSECTION |
| PIV | POST INDICATOR VALVE |
| PL | PLATE, PROPERTY LINE |
| PLYWD | PLYWOOD |
| POL | POINT ON LINE |
| PP | POWER POLE |
| POT | POINT ON TANGENT |
| PRC | POINT OF REVERSE CURVE |
| PSI | POUNDS PER SQUARE INCH |
| PT | POINT OF TANGENT |
| PVC | POLYVINYL CHLORIDE |
| PVI | POINT OF VERTICAL INTERSECTION |
| PVMT | PAVEMENT |
| PVT | PRIVATE |
| R | RADIUS, RISER |
| RAS | RETURN ACTIVATED SLUDGE |
| RR | RAIL ROAD |
| RCP | REINFORCED CONCRETE PIPE |
| RD | ROOF DRAIN, ROAD |
| RDCR | REDUCER |

| | |
|-------------|--------------------------------------------|
| RECPT | RECEPTACLE |
| RECT | RECTANGULAR |
| REINF | REINFORCE, REINFORCEMENT |
| REF | REFERENCE |
| REL | RELOCATED |
| REQD | REQUIRED |
| REV | REVISION |
| RTE | ROUTE |
| RT | RIGHT |
| R/W | RIGHT OF WAY |
| S | SANITARY SEWER, SOUTH, SWITCH |
| SAN | SANITARY |
| SCH | SCHEDULE |
| SD | STORM DRAIN |
| SECT | SECTION |
| SER | SERVICE |
| SH | SHEET |
| SHTG | SHEETING |
| SIM | SIMILAR |
| SPEC | SPECIFICATION |
| SQ | SQUARE |
| SS | STAINLESS STEEL |
| ST | STREET |
| STA | STATION |
| STD | STANDARD |
| STL | STEEL |
| STRUCT | STRUCTURAL |
| STY | STORY |
| SUR | SURVEY |
| SURF | SURFACE |
| S/W | SIDEWALK |
| SYMM | SYMMETRICAL |
| T | TREAD, TOP |
| T & B | TOP AND BOTTOM |
| TDC | TURNED DOWN CURB |
| TELE | TELEPHONE |
| TEMP | TEMPORARY |
| THK | THICK |
| TP | TELEPHONE POLE |
| TRTD | TREATED |
| TS | TOP OF SLAB |
| TV | TELEVISION |
| TW | TOP OF WALL |
| TYP | TYPICAL |
| UG | UNDERGROUND |
| UON | UNLESS OTHERWISE NOTED |
| U.S.C.&G.S. | UNITED STATES COAST AND GEODETIC SURVEY |
| V, VAL | VALVE |
| VAP BAR | VAPOR BARRIER |
| VC | VERTICAL CURVE |
| VERT | VERTICAL |
| VOL | VOLUME |
| VDOT | VIRGINIA DEPARTMENT OF TRANSPORTATION |
| V.S.D. | VERTICAL SIGHT DISTANCE |
| W.B.L. | WEST BOUND LANE |
| W | WIDE FLANGE, WIDE |
| W/ | WITH |
| WD | WOOD |
| WL | WATER LINE |
| W/O | WITHOUT |
| WS | WATER SURFACE |
| WT | WATERTIGHT, WEIGHT |
| WVDH | WEST VIRGINIA DEPARTMENT OF HIGHWAYS |
| WWF | WELDED WIRE FABRIC |

EROSION AND SEDIMENT CONTROL SYMBOLS

| | | |
|-----|--|-------------------------------------------|
| EC1 | | EROSION CONTROL STONE |
| STB | | STRAW BALE BARRIER |
| IP | | STORM DRAIN INLET PROTECTION |
| DV | | DIVERSION |
| ST | | TEMPORARY SEDIMENT TRAP |
| CE | | TEMPORARY GRAVEL CONSTRUCTION ENTRANCE |
| RR | | RIPRAP |
| SF | | SILT FENCE |

EXISTING

| |
|--|
| |
| |
| |
| |
| |
| |
| |
| |
| |
| |
| |
| |
| |
| |
| |
| |
| |
| |
| |
| |
| |
| |
| |
| |
| |
| |
| |
| |
| |
| |
| |
| |
| |
| |
| |
| |
| |
| |
| |
| |
| |
| |
| |
| |
| |
| |

NEW

| |
|--|
| |
| |
| |
| |
| |
| |
| |
| |
| |
| |
| |
| |
| |
| |
| |
| |
| |
| |
| |
| |
| |
| |
| |
| |
| |
| |
| |
| |
| |
| |
| |
| |
| |
| |
| |
| |
| |
| |
| |
| |
| |
| |
| |
| |
| |
| |

DESCRIPTION

| |
|--------------------------------------|
| BUILDING WITH PORCH OR STOOP |
| FOUNDATION ONLY |
| CONTOUR, CONTOUR WITH ELEVATION |
| SPOT ELEVATION |
| CONCRETE CURB |
| CONCRETE CURB & GUTTER |
| CONCRETE WALK OR SLAB |
| PAVEMENT |
| UNPAVED OR GRAVEL ROAD |
| TREE LINE |
| TREE OR SHRUB |
| FENCE |
| CENTERLINE CREEK, SWALE OR DITCH |
| PROPERTY LINE |
| CENTERLINE OR BASELINE |
| LIMIT OF WORK LINE |
| FIELD SURVEY TRAVERSE POINT |
| P.C. OR P.T. |
| GEOLOGIC BORE HOLE |
| STORM DRAIN AND ENDWALL |
| SANITARY SEWER |
| FORCE MAIN |
| GAS MAIN OR SERVICE LINE |
| WATER MAIN OR SERVICE LINE |
| ELECTRICAL LINE |
| UNDERGROUND ELECTRICAL LINE |
| PIPE FITTINGS |
| FIRE HYDRANT |
| GATE VALVE |
| CLEANOUT |
| MANHOLE |
| DROP INLET (CURB AND GRATING TYPES) |
| G.M. - GAS METER, W.M. - WATER METER |
| TELEPHONE LINE |
| TELEPHONE POLE, GUY AND ANCHOR |
| POWER POLE, GUY AND ANCHOR |
| LIGHT POLE |
| TELEPHONE PEDESTAL |
| BURIED TELEPHONE VAULT |
| ABANDON OR REMOVE |
| PAVED DITCH |
| DRIVEWAY CULVERT |
| CULVERT WITH FLARED END SECTION |
| WATER VALVE |
| HUB AND TACK |
| COORDINATE POINT |

MATERIALS SYMBOLS

| | |
|--|-------------------------------|
| | METAL |
| | BRICK |
| | CONCRETE MASONRY |
| | CONCRETE |
| | GROUT OR FINISHED CONCRETE |
| | INSULATION (RIGID) |
| | WOOD BLOCKING |
| | FINISHED WOOD OR PLYWOOD |
| | GRAVEL OR STONE |
| | EARTH |

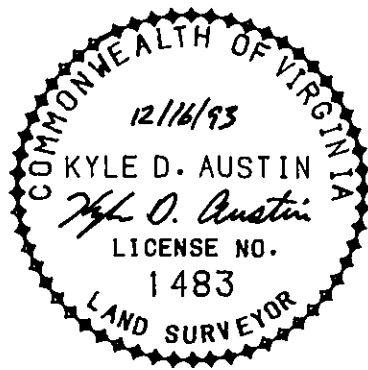

WATER DEPARTMENT #93-07

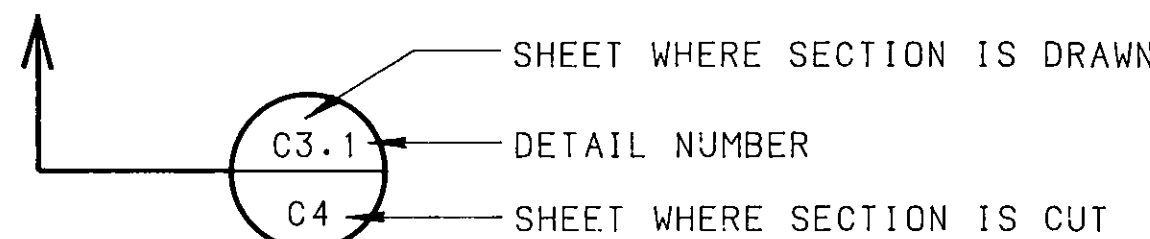

| REVISION | DATE | DESCRIPTION | BY | APP |
|-------------------------|------|---------------------------|----------------|-----|
| DSGN | JLW | WOODCLIFF SUBDIVISION | | |
| DRAWN | ASB | ABBREVIATIONS AND LEGEND | | |
| CHKD | KDA | CITY OF ROANOKE, VIRGINIA | | |
| | | SCALE: NONE | CONS. NO. 1178 | |
| | | DATE: JAN., 1993 | SHEET 2 OF 2 | |
| DRAWING # D112-D-117812 | | | | |

Mattern & Craig
CONSULTING ENGINEERS
SURVEYORS