

## TYPICAL SECTIONS

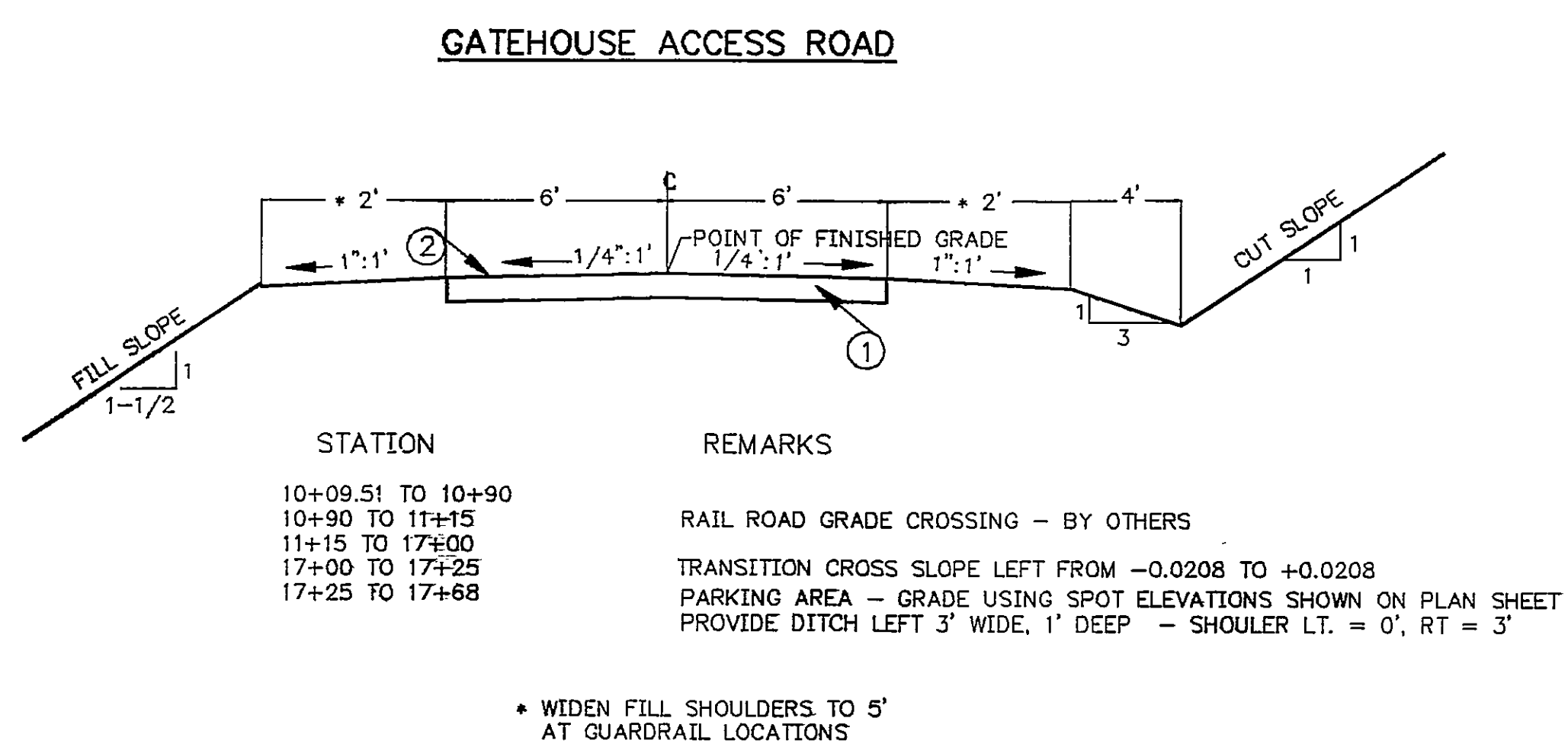
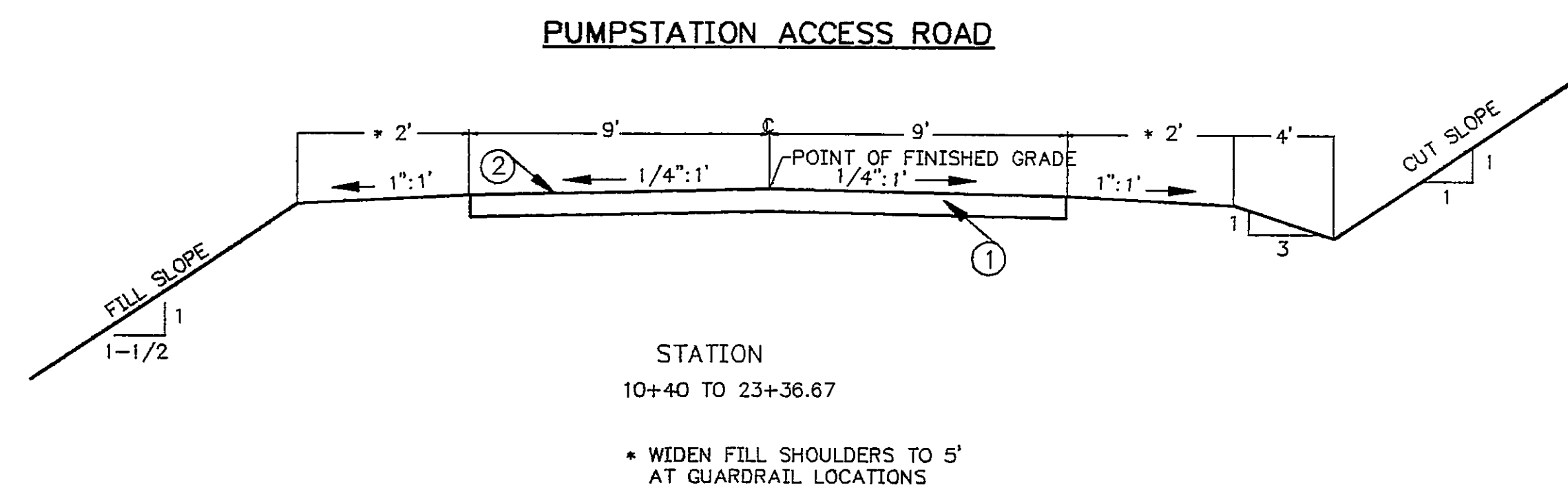

## MATERIALS

- ① 8" AGGREGATE BASE MATERIAL TY. 1 NO. 21B
- ② ASPHALT

NOTE: THE ACCESS ROADS ARE TO BE CONSTRUCTED IN ACCORDANCE WITH THE VIRGINIA DEPARTMENT OF TRANSPORTATION ROAD AND BRIDGE SPECIFICATIONS DATED JANUARY 1, 1987. REFERENCES TO STANDARDS OR TO VDOT STANDARDS ON THE DRAWINGS ARE TO VIRGINIA DEPARTMENT OF TRANSPORTATION ROAD AND BRIDGE STANDARDS DATED JANUARY 1, 1989.

## DETAILS

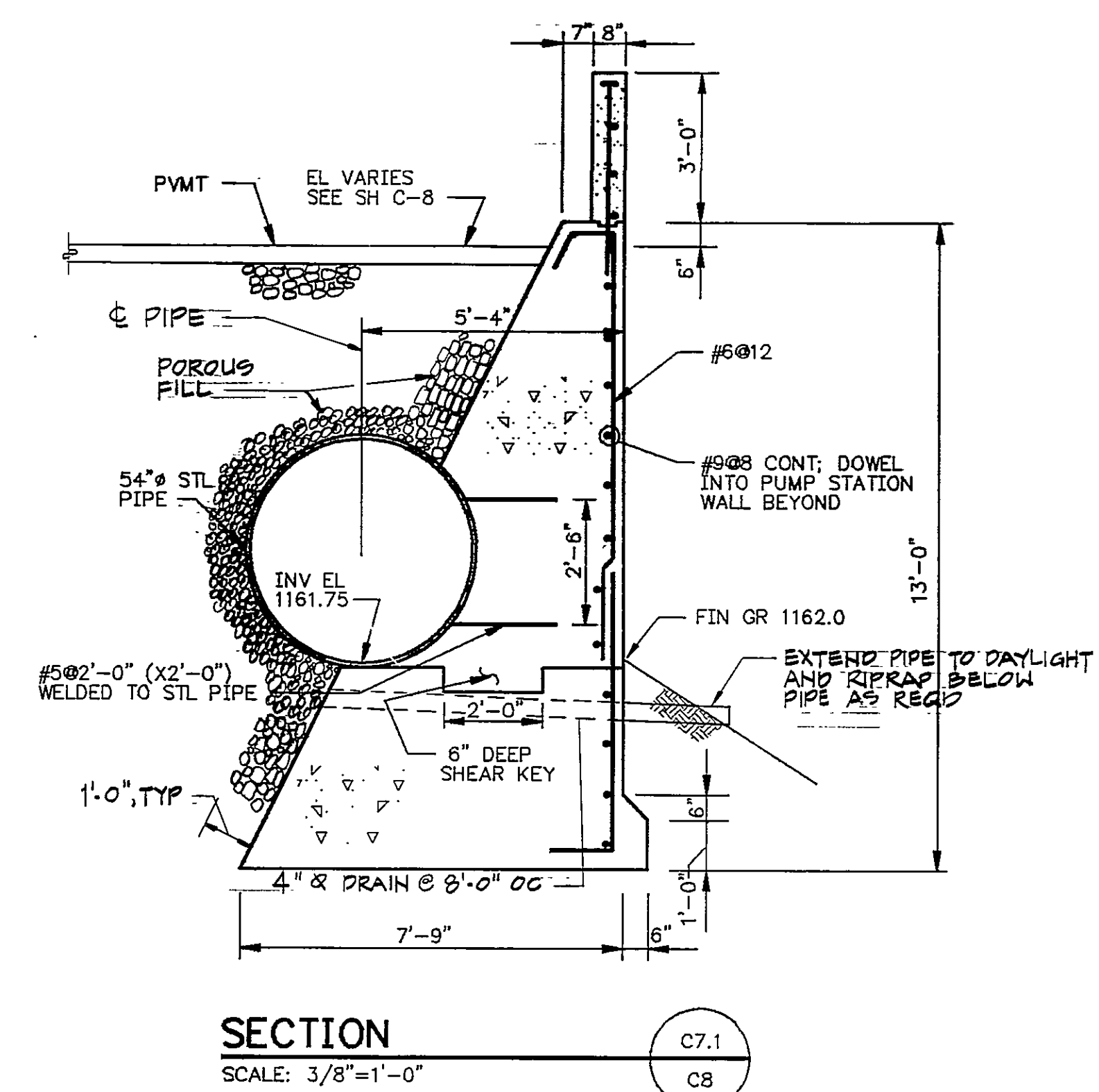
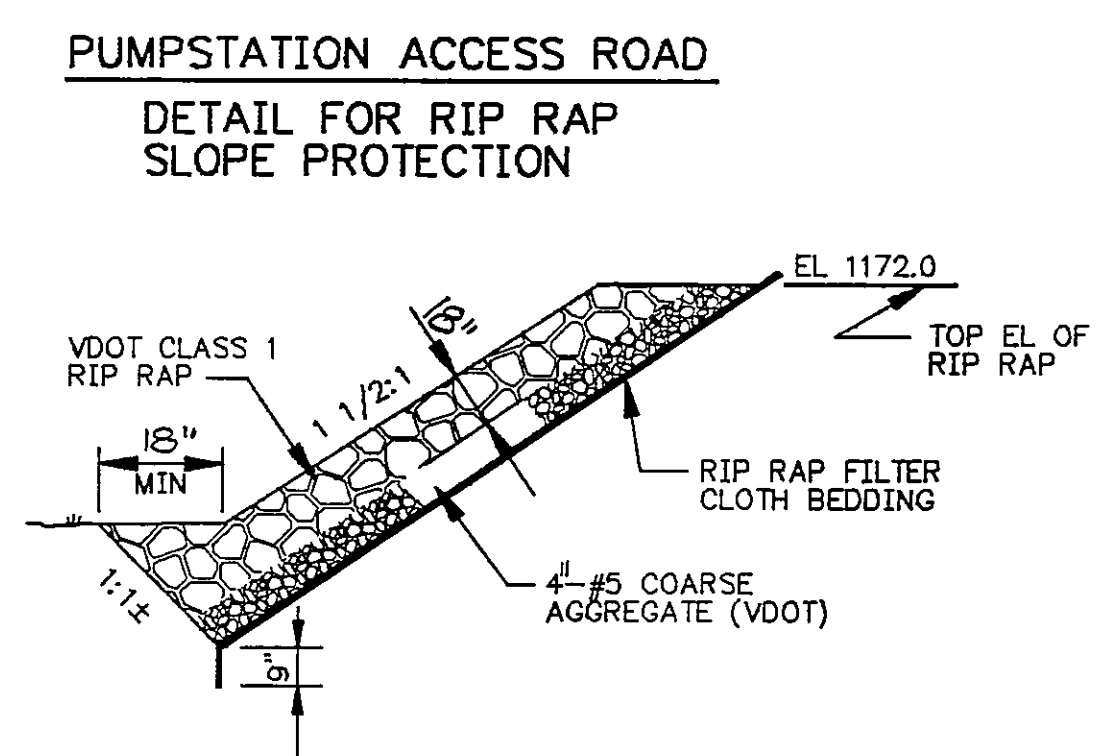
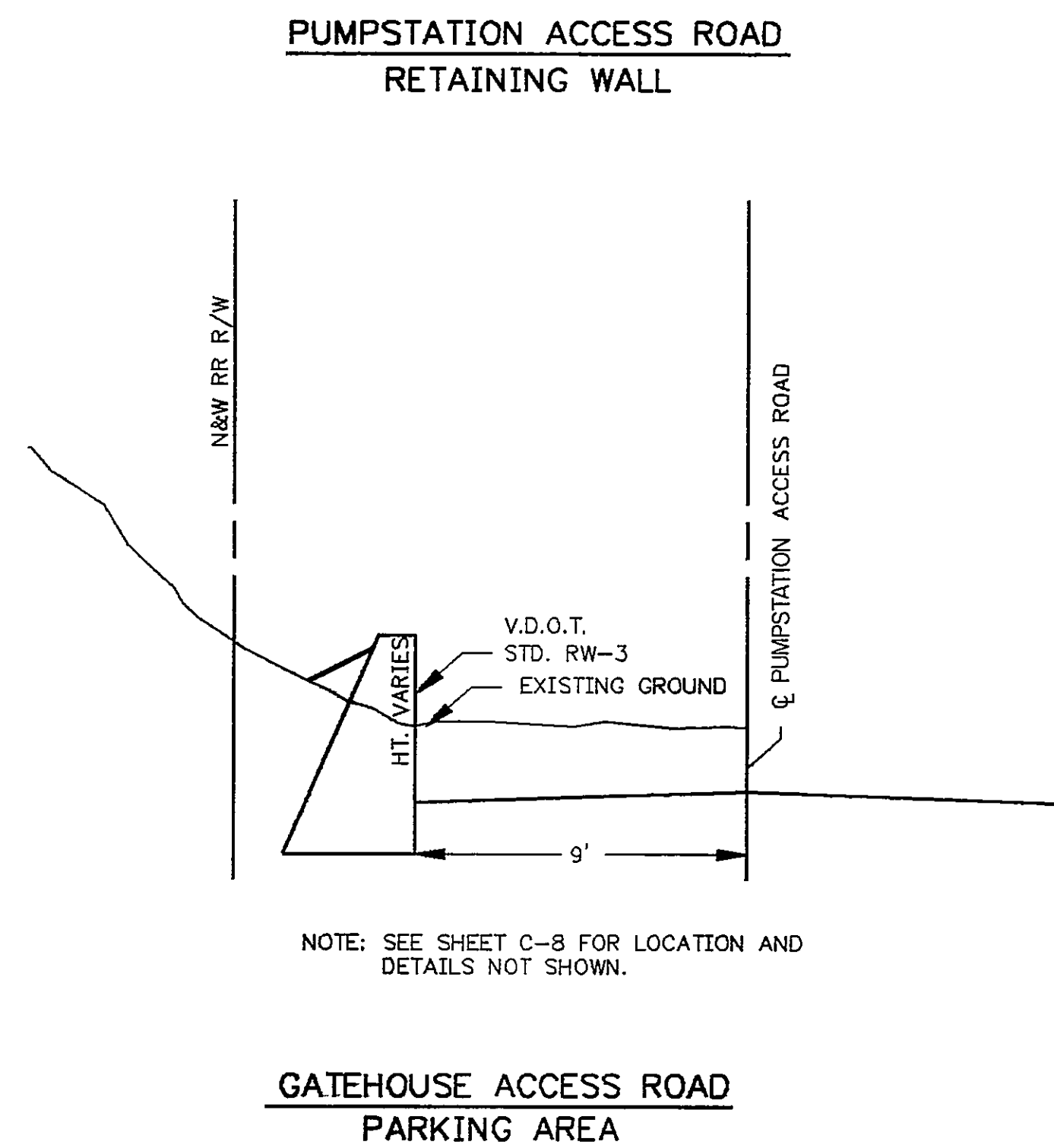

## RECORD DRAWINGS

THESE DRAWINGS RECORDED ON THE BASIS OF  
INFORMATION FURNISHED BY THE CONTRACTOR  
OR SPECIFICALLY KNOWN TO HSMM. NO OTHER  
REPRESENTATIONS ARE MADE OR IMPLIED

Date: 6-5-95

Date: 6-5-95

GRAPHIC SCALE

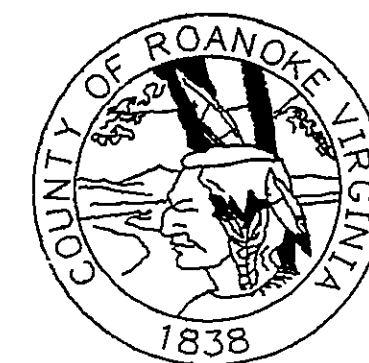
[illegible]

SPRING HOLLOW RESERVOIR  
ROANOKE COUNTY, VIRGINIA

HAYES, SEAY, MATTERN & MATTERN, INC.  
ARCHITECTS - ENGINEERS - PLANNERS  
ROANOKE, VIRGINIA

## CIVIL ACCESS ROADS TYPICAL SECTIONS AND DETAILS

SCALE AS NOTED	DATE 8/4/91	COMM 4194E	SHEET C-7	DWG 9
-------------------	----------------	---------------	--------------	----------