

NOTE: SEE SHEET 7 FOR SUMP RESTEEL SCHEDULE

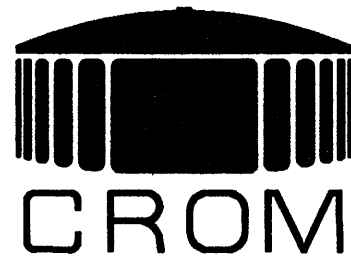

DATE: 03-21-95

DRAWN: PSM

CHECKED: [Signature]

APPROVED: [Signature]

DESIGNED: JSW

TANK DESCRIPTION:

2.0-MG CLEAR WELL

TANK DIMENSIONS:

112'0" ID x 28'0" SWD

TANK BUILDER:

THE CROM CORPORATION
GAINESVILLE, FLORIDA

OWNER:

COUNTY OF
ROANOKE
VIRGINIA

CONSULTING ENGINEER:

ROANOKE COUNTY
UTILITY DEPARTMENT

REV.	DESCRIPTION	DATE CHK BY
------	-------------	----------------

WHERE STANDARD SPECIFICATIONS ARE IN CONFLICT WITH CROM CORPORATION SPECIFICATIONS OR WITH GOOD PRE-STRESSING OR SHOTCRETE PRACTICES THE STANDARD SPECIFICATIONS SHALL BE SUBORDINATED. THIS DESIGN AND DRAWING ORIGINATED BY AND THE EXCLUSIVE PROPERTY OF THE CROM CORPORATION.

BAR IS ONE INCH ON ORIGINAL
DRAWINGS 0 1"

SCALE:

AS NOTED

FILE NO. 9449.2

SHEET 6 OF 19

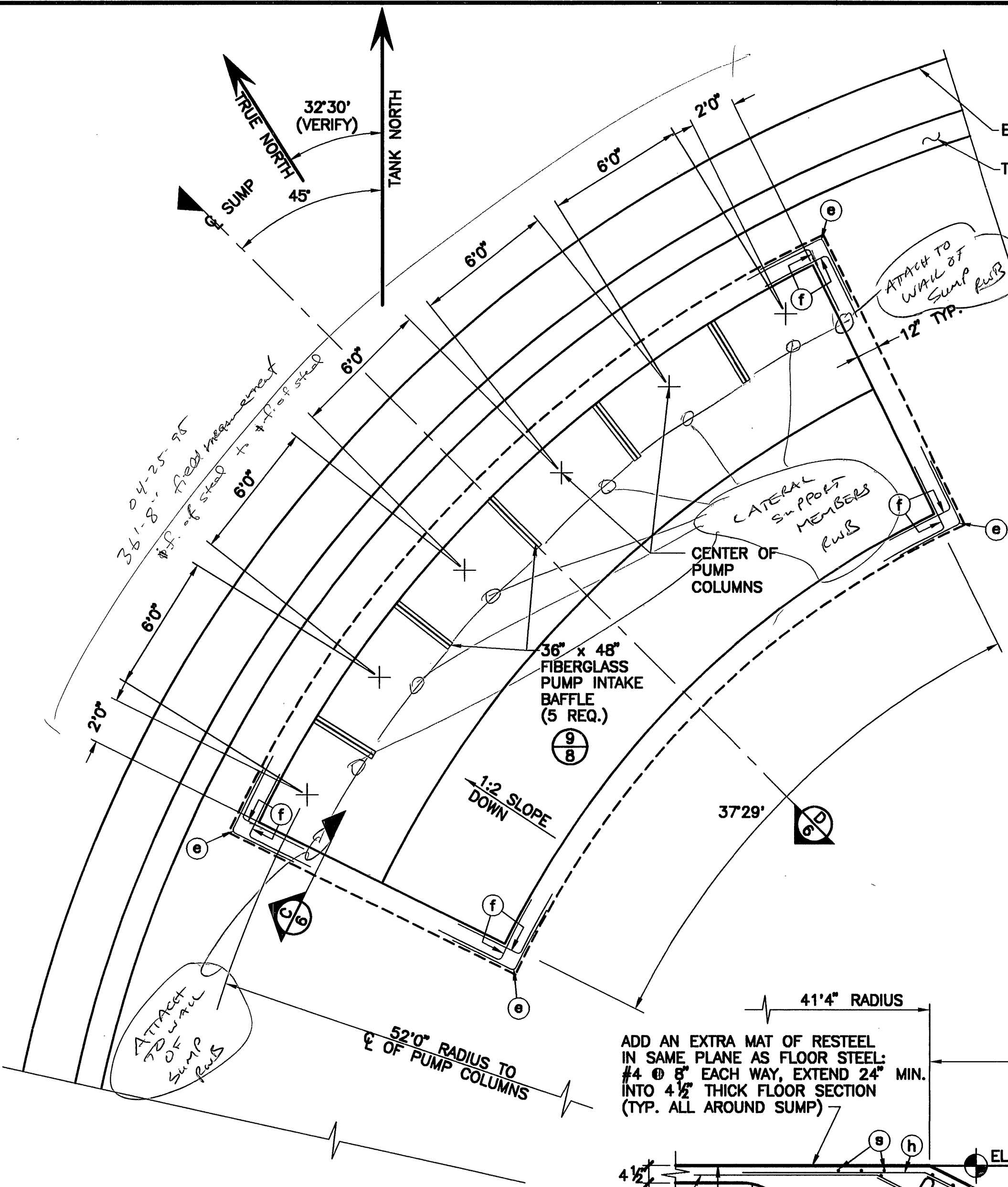

6 PUMP SUMP PLAN
SCALE 1/4"=1'0"

ADD AN EXTRA MAT OF RESTEEL IN SAME PLANE AS FLOOR STEEL: #4 @ 8" EACH WAY, EXTEND 24" MIN. INTO 4 1/2" THICK FLOOR SECTION (TYP. ALL AROUND SUMP)

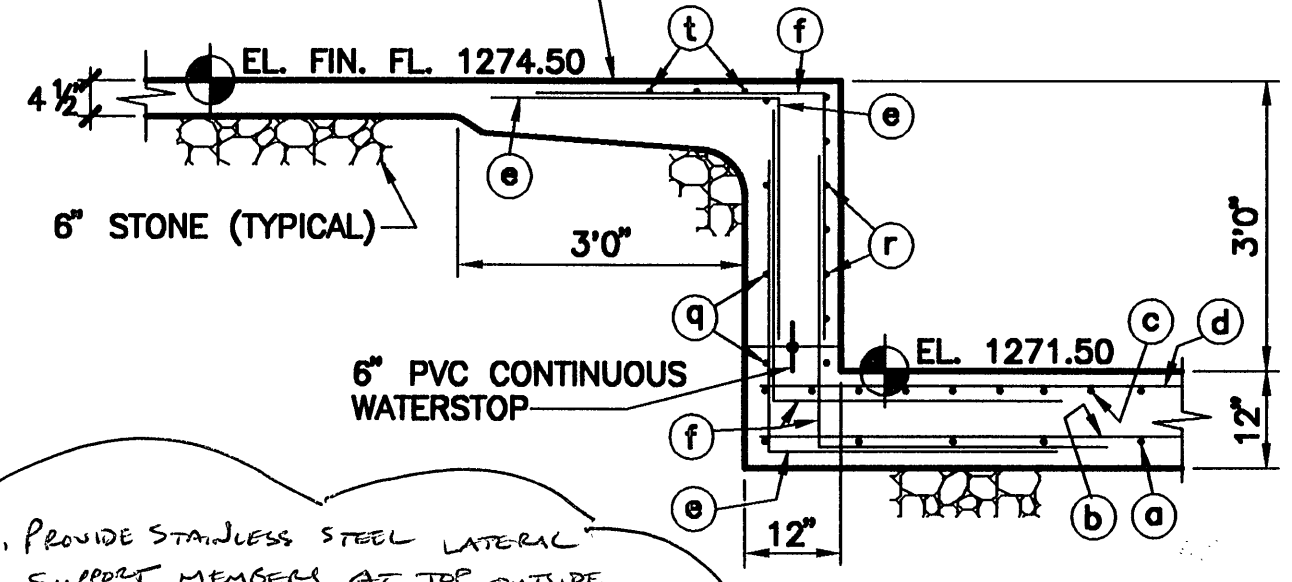

1. PROVIDE STAINLESS STEEL LATERAL SUPPORT MEMBERS AT TOP OUTSIDE EDGE OF BAFFLES (SEE SHEET 8 OF 9)
2. ALTERNATE BAFFLE OPTION WOULD BE 4" CAST CONCRETE PANELS OR 4" WIDE CONCRETE BLOCK (CMU) WALLS

NOTE:
COVER OVER SUMP RESTEEL
1) 1 1/2" MIN. ALL INSIDE FACES
2) 3" MIN. ALL FACES CAST AGAINST GROUND.

NOTE:
TYPICAL FLOOR STEEL NOT SHOWN

ADD AN EXTRA MAT OF RESTEEL IN SAME PLANE AS FLOOR STEEL: #4 @ 8" EACH WAY, EXTEND 24" MIN. INTO 4 1/2" THICK FLOOR SECTION (TYP. ALL AROUND SUMP)

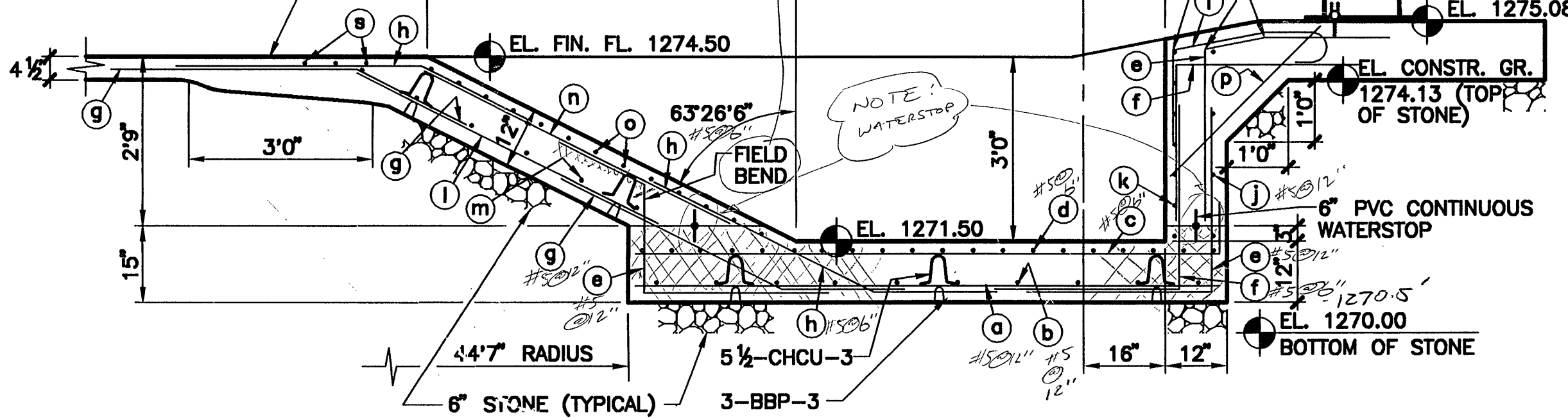

D SUMP SECTION
SCALE 1/2"=1'0"

NOTE: FOR SAFETY DURING CONSTRUCTION COVER TIPS OF STEEL DOWELS WITH PLASTIC BAR GUARDS OR PLASTIC BUCKETS