

GENERAL SITE NOTES:

- G.C. TO CONFIRM THE LOCATION OF ALL EXISTING UTILITIES PRIOR TO ANY CONSTRUCTION OF PROPOSED IMPROVEMENTS.
- NO CONSTRUCTION/FIELD CHANGES WITHOUT THE APPROVAL OF THE CONSULTING ENGINEER, WESTERN VIRGINIA WATER AUTHORITY, VDOT, AND BOTETOURT COUNTY PLANNING, BUILDING, AND DEVELOPMENT DEPARTMENT.
- GENERAL CONTRACTOR TO FIELD VERIFY PAVEMENT TIE IN LOCATIONS AND ENSURE THAT POSITIVE DRAINAGE AWAY FROM THE PROPOSED BUILDING IS MAINTAINED THROUGHOUT THE SITE.
- ANY PAVEMENT OR UTILITIES TO REMAIN THAT ARE DISTURBED OR DESTROYED DURING THE CONSTRUCTION PROCESS SHALL BE REPAIRED/REPLACED AS NECESSARY TO PRE-CONSTRUCTION CONDITIONS AT NO COST TO THE OWNER.
- ALL BUILDING DIMENSIONS SHALL BE COORDINATED WITH THE ARCHITECTURAL PLANS.
- G.C. TO PROVIDE ALL REQUIRED CONDUIT FOR EXTERIOR LIGHTING, ELECTRICAL, TELEPHONE, AND COMMUNICATIONS.
- G.C. SHALL COORDINATE CONCRETE FINISHING AROUND THE PROPOSED DOOR LOCATIONS WITH THE ARCHITECTURAL PLANS.
- THE SITE CONTRACTOR MUST COORDINATE THE TIMING AND INSTALLATION OF ALL UTILITIES AND MAKE ALL NECESSARY SCHEDULE ARRANGEMENTS FOR TEMPORARY OR PERMANENT UTILITIES PER THE PROJECT SCHEDULE.
- ALL ROOFTOP OR GROUND MOUNTED MECHANICAL EQUIPMENT SHALL BE SCREENED FROM VIEW PER BOTETOURT COUNTY ORDINANCE. THE PERIMETER OF ALL GROUND-MOUNTED EQUIPMENT SHALL BE SCREENED FROM ANY STREET FRONTAGE OR ADJACENT PROPERTY THROUGH THE USE OF EVERGREEN PLANT MATERIALS AND/OR SOLID FENCES OR SCREEN WALLS A MINIMUM OF SIX FEET IN HEIGHT. THE PERIMETER OF ALL ROOFTOP EQUIPMENT THAT WOULD OTHERWISE BE VISIBLE FROM ANY STREET FRONTAGE SHALL BE SCREENED THROUGH THE USE OF PARAPETS OR OTHER OPAQUE WALLS CONSTRUCTED OF MATERIALS COMPLEMENTARY TO THE EXTERIOR WALLS, TO BE VERIFIED BY SUBMISSION OF A FIELD REVISION TO THE DEVELOPMENT PLAN OR SEPARATE BUILDING PERMIT.
- G.C. SHALL OBTAIN A SEPARATE SIGN PERMIT FOR ALL ON-SITE AND BUILDING SIGNAGE. IF A FLAGPOLE DISPLAY IS PROPOSED, NOTE THAT A SEPARATE PERMIT MAY BE REQUIRED BASED ON SECTION 25-461 OF THE BOTETOURT COUNTY CODE.
- THE DUMPSTER OR REFUSE CONTAINER STORAGE AREA MUST MEET ALL REQUIREMENTS SET FORTH IN DIVISION 4, SECTION 25-486 OF THE ZONING ORDINANCE. THE HEIGHT OF THE DUMPSTER SCREENING MUST BE AT LEAST 6' IN HEIGHT AND CONSIST OF A SOLID SCREEN WALL OR EVERGREEN PLANT MATERIAL. SEE SHEET C11 FOR DUMPSTER ENCLOSURE AND GATE DETAILS.
- ALL EXTERIOR LIGHTING SHALL BE INSTALLED IN ACCORDANCE WITH THE APPROVED LIGHTING PLAN AND CUT SHEETS. THE LIGHTING SHALL ALSO BE INSTALLED AND AIMED TO MEET ALL REQUIREMENTS SET FORTH IN DIVISION 5, SECTION 25-504 LIGHTING STANDARDS.
- NO OUTDOOR STORAGE IS PROPOSED AS PART OF THIS PROJECT AT THIS TIME.

UTILITY NOTES:

- G.C. SHALL COORDINATE THE EXACT SANITARY SEWER, WATER, AND STORM SEWER BUILDING TIE-IN LOCATIONS WITH THE ARCHITECTURAL PLANS.
- ALL UTILITY SERVICE LATERALS OR LINES, INCLUDING ELECTRIC, SHALL BE INSTALLED UNDERGROUND. WATER & SEWER CONNECTIONS SHALL CONFORM TO WVAW UTILITY STANDARDS AND INTERNATIONAL BUILDING CODE.
- THE G.C. SHALL COORDINATE TEMPORARY POWER FOR THE PROPOSED BUILDINGS.
- THE G.C. IS RESPONSIBLE FOR PROVIDING AND INSTALLING ALL CONDUIT ASSOCIATED WITH REQUIRED UTILITIES FOR THE PROPOSED BUILDING AND ANY NECESSARY UTILITIES ON-SITE SUCH AS LIGHTING, ELECTRICAL, ETC.

WATER NOTES:

- ALL WATER CONNECTIONS TO EXISTING LINES SHALL BE COORDINATED WITH AND PERFORMED BY THE WESTERN VIRGINIA WATER AUTHORITY.
- ALL WATER AND SANITARY SEWER FACILITIES ARE TO BE INSTALLED ACCORDING TO THE WESTERN VIRGINIA WATER AUTHORITY DESIGN AND CONSTRUCTION STANDARDS.
- PROVIDE 5 DAYS NOTICE TO THE WVAW FOR ANY ANTICIPATED WATER OUTAGE TO ALLOW THE WVAW TIME TO SCHEDULE AND NOTIFY AFFECTED CUSTOMERS. (540) 537-3460

SANITARY SEWER NOTES:

- ALL SANITARY SEWER CONNECTIONS TO EXISTING LINES SHALL BE COORDINATED WITH AND PERFORMED BY THE WESTERN VIRGINIA WATER AUTHORITY.
- ALL WATER AND SANITARY SEWER FACILITIES ARE TO BE INSTALLED ACCORDING TO THE WESTERN VIRGINIA WATER AUTHORITY DESIGN AND CONSTRUCTION STANDARDS.

GENERAL W.V.W.A. NOTES:

- ALL CONSTRUCTION METHODS AND MATERIALS SHALL CONFORM TO THE LATEST WVAW DESIGN AND CONSTRUCTION STANDARDS.
- THE CONTRACTOR OR DEVELOPER IS REQUIRED TO NOTIFY THE WESTERN VIRGINIA WATER AUTHORITY IN WRITING AT LEAST THREE (3) DAYS PRIOR TO ANY CONSTRUCTION. PLEASE CONTACT MARK SINK AT (540) 537-3460/
- ALL WORK SHALL BE SUBJECT TO INSPECTION BY THE WESTERN VIRGINIA WATER AUTHORITY.
- FIELD CORRECTIONS SHALL BE APPROVED BY THE WESTERN VIRGINIA WATER AUTHORITY.
- THE CONTRACTOR SHALL MAINTAIN A MINIMUM OF 18" CLEARANCE VERTICALLY AND 2' MINIMUM HORIZONTALLY FROM OUTSIDE OF PIPE TO OUTSIDE OF PIPE AT ALL WATER, SANITARY SEWER CROSSINGS OF ANY OTHER UTILITIES. WHERE THIS CANNOT BE ACHIEVED ADDITIONAL MEASURES IN ACCORDANCE WITH WVAW STANDARDS SHALL BE ENFORCED.
- IT IS THE CONTRACTOR'S RESPONSIBILITY TO HAVE ALL EXISTING UTILITIES LOCATED AND POTHOLED TO VERIFY LOCATIONS. THIS PLAN REVIEW DOES NOT REMOVE THE CONTRACTOR'S RESPONSIBILITY TO RELOCATE ANY EXISTING CONFLICTS FOUND DURING CONSTRUCTION.
- REFER TO PLAN SET AND WVAW DETAILS FOR SPECIFIC CONSTRUCTION STANDARDS.

PAVEMENT LEGEND

- | | |
|--|---|
| | HEAVY-DUTY PAVEMENT (SEE DETAILS SHEET C13) |
| | LIGHT-DUTY PAVEMENT (SEE DETAILS SHEET C13) |
| | CONCRETE |

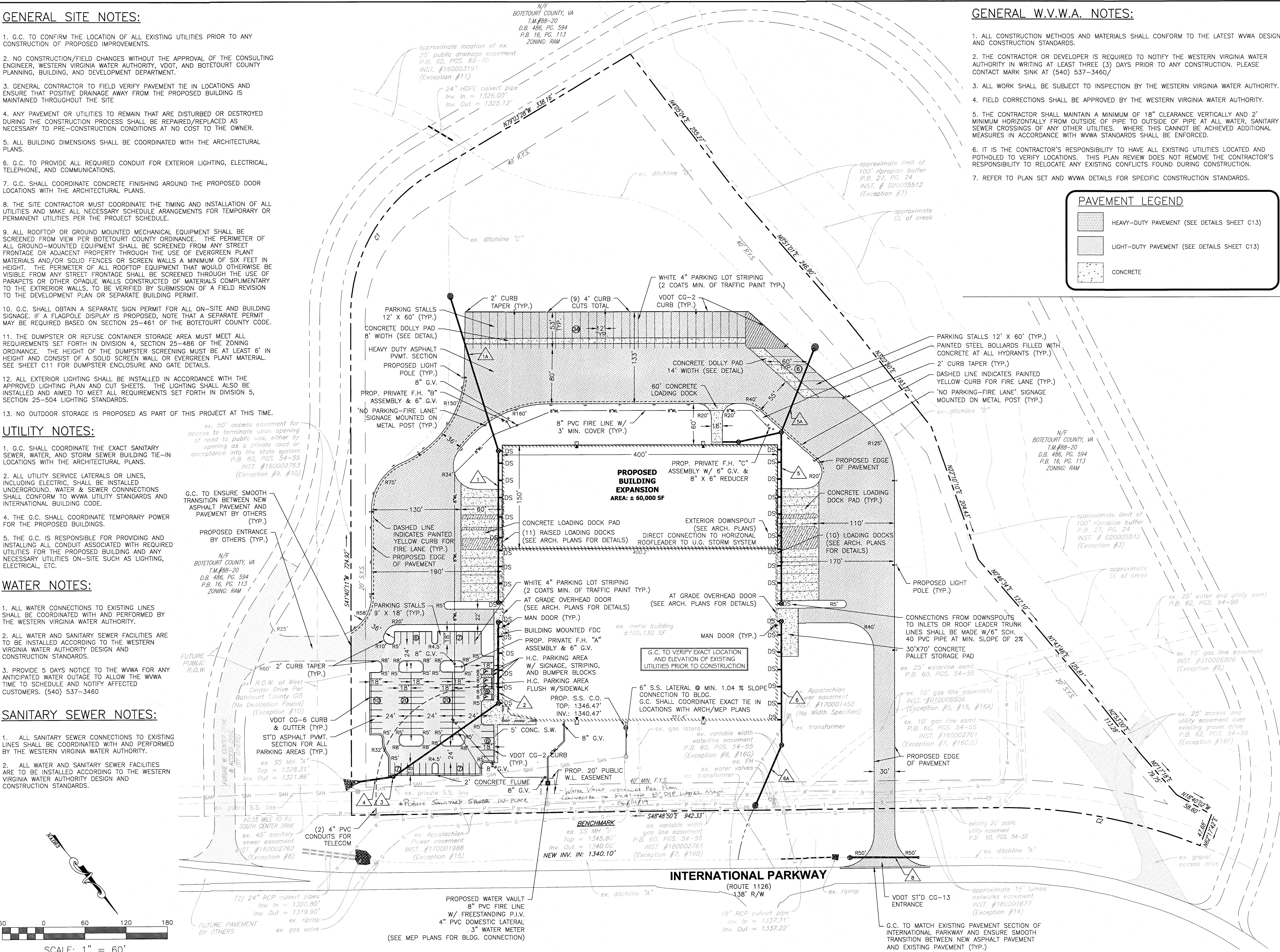

PROJECT ADAMS

LAYOUT & UTILITY PLAN

DRAWN BY EJP
DESIGNED BY SMH
CHECKED BY CPB
DATE 3/14/2019
SCALE 1"=60'
REVISIONS

4/18/19

C3
PROJECT NO 04180118.00