

1. THE SWPPP SHALL BE PROVIDED ON-SITE AND ALL REGULATIONS, INSPECTIONS, AND PROCEDURES FOLLOWED FOR THE ENTIRE DURATION OF THE PROJECT. SEE GENERAL PERMIT DETAILS FOR ADDITIONAL INFORMATION AND SWPPP FOR SITE SPECIFIC REQUIREMENTS AND INSPECTIONS.
2. CONSTRUCTION ENTRANCES SHALL BE INSTALLED AS A FIRST STEP AT THE PROPOSED ENTRANCE LOCATIONS AS SHOWN. THE CONSTRUCTION ENTRANCES SHALL BE MAINTAINED THROUGHOUT THE DURATION OF THE PROJECT. G.C. SHALL PAY SPECIAL ATTENTION TO ENSURE SEDIMENT LOADED RUNOFF IS NOT DIRECTED TOWARDS THE ADJACENT PUBLIC RIGHT OF WAY AND THERE SHALL BE NO MUD "TRACKING" FROM THE SITE INTO THE PUBLIC RIGHT OF WAY.
3. SILT FENCE SHALL BE INSTALLED AS SHOWN. THE SILT FENCE SHALL BE MAINTAINED THROUGHOUT THE DURATION OF THE PROJECT. THE R.I.D. ASSIGNED TO THE PROJECT SHALL ENSURE ALL REGULATIONS ARE FOLLOWED AND DOCUMENTED THROUGHOUT THE ENTIRE PROJECT TO PREVENT THE EXCESSIVE BUILD-UP OF SEDIMENT.
4. CULVERT INLET AND OUTLET PROTECTION SHALL BE PROVIDED FOR THE APPLICABLE EXISTING ON-SITE CULVERT PIPES.
5. SEDIMENT TRAPS AND DIVERSION DIKES SHALL BE CONSTRUCTED AS SHOWN. SEE DETAILS ON SHEET C08. THE DIVERSION DIKES SHALL BE INSTALLED AS SHOWN TO DIRECT ON-SITE RUNOFF TO THE SEDIMENT TRAPS.
6. DEMOLITION OPERATIONS SHALL OCCUR AT THIS TIME FOR EXISTING IMPROVEMENTS TO BE REMOVED.
7. TEMPORARY SEEDING MUST BE PROVIDED FOR ALL AREAS THAT WILL REMAIN DORMANT FOR MORE THAN 14 DAYS. PERMANENT SEEDING AND MULCHING TO BE PROVIDED FOR ALL APPLICABLE AREAS AS SOON AS POSSIBLE AFTER FINAL GRADE IS ACHIEVED.
8. G.C. SHALL ENSURE THAT THE LIMITS OF DISTURBANCE ARE STRICTLY ADHERED TO DURING THE PROJECT.
9. NO DEVIATIONS TO THE PLANS SHALL TAKE PLACE UNLESS PRIOR APPROVAL FROM THE OWNER, PROJECT ENGINEER, AND THE APPROPRIATE REVIEW AGENCIES.
10. SEE SHEET C7 FOR PHASE II OF THE EROSION AND SEDIMENT CONTROL PLAN.

3.02	TEMPORARY STONE CONSTRUCTION ENTRANCE	CE
3.05	SILT FENCE	SF
3.08	CULVERT INLET PROTECTION	CIP
3.09	TEMPORARY DIVERSION DIKE	DD
3.13	TEMPORARY SEDIMENT TRAP	ST
3.31	TEMPORARY SEEDING	TS

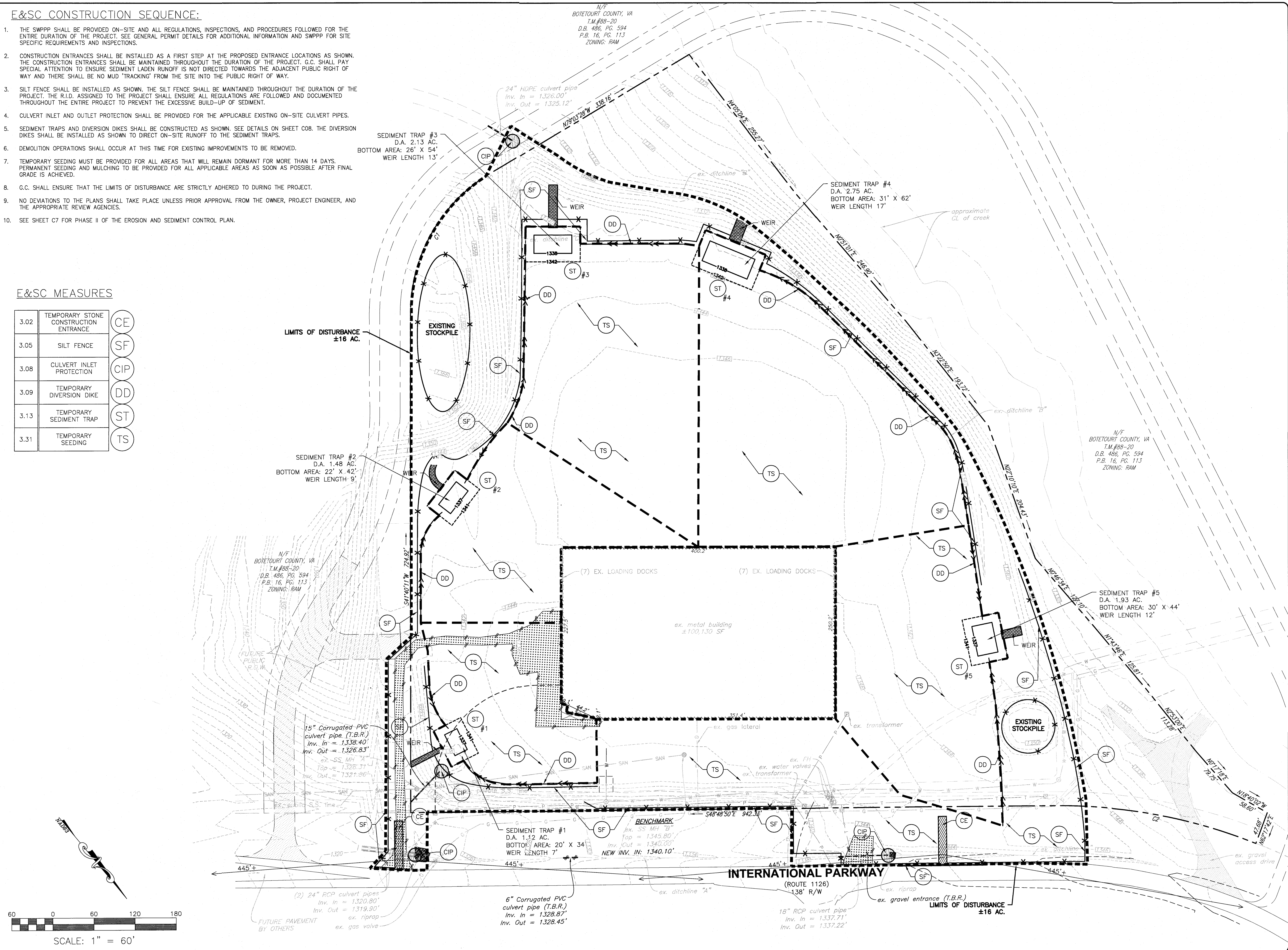

BALZER
& ASSOCIATES
PLANNERS / ARCHITECTS
ENGINEERS / SURVEYORS

Roanoke / Richmond
New River Valley / Staunton
Harrisonburg / Lynchburg
www.balzer.cc

208 Corporate Circle
Roanoke, VA 24018
540.772.9580

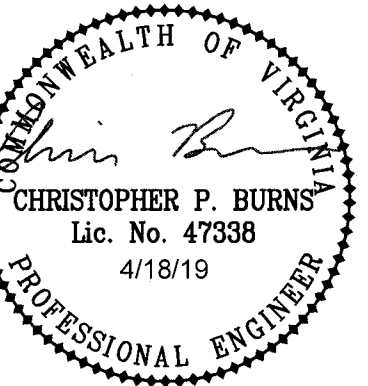

PROJECT ADAMS

E.S.C. PLAN (PHASE I)

BOTETOURT COUNTY, VIRGINIA

DRAWN BY	EJP
DESIGNED BY	SMH
CHECKED BY	CPB
DATE	3/14/2019
SCALE	1"=60'
REVISIONS	
4/18/19	

C5