

GENERAL LANDSCAPE NOTES:

1. CONTRACTOR SHALL AMEND ALL PROPOSED PLANT BEDS PER THE LANDSCAPE SPECIFICATIONS.
2. ALL PLANTINGS WITHIN PROPERTY LINE, INCLUDING SODDED LAWN, SHALL BE IRRIGATED WITH AN AUTOMATIC IRRIGATION SYSTEM PER IRRIGATION PERFORMANCE SPECIFICATIONS.
3. NO PLANT SUBSTITUTIONS ARE PERMITTED WITHOUT WRITTEN APPROVAL OF THE OWNER'S REPRESENTATIVE.
4. ALL PLANT AND BED LINE LOCATIONS SHALL BE STAKED IN THE FIELD AND APPROVED BY THE OWNER'S REPRESENTATIVE PRIOR TO INSTALLATION.
5. ALL PLANTINGS SHALL BE INSTALLED WITH THE SPECIFIED LAYER OF MULCH. REFERENCE PLANTING DETAILS AND SPECIFICATIONS FOR DEPTH AND TYPE OF MULCH.

PLAN LEGEND

- ⊕ CANOPY TREE
- ⊙ ORNAMENTAL TREE
- EVERGREEN SHRUB
- ▨ SODDED LAWN
- ▩ GROUND COVER

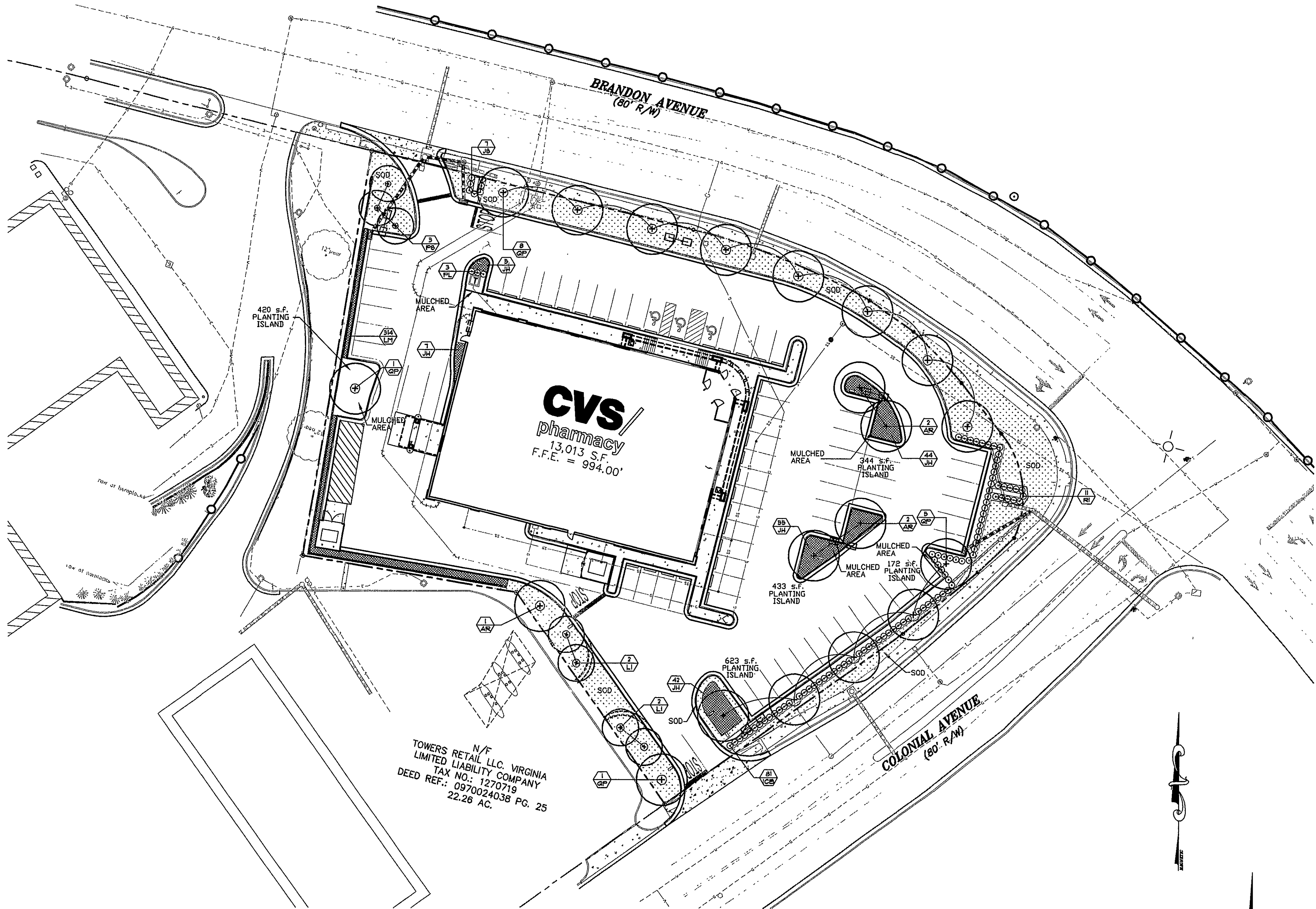

MASTER PLANT LIST							
TYPE	SYM/KEY	BOTANICAL NAME	COMMON NAME	SPECIFICATION			
				CALIPER	HEIGHT	SPREAD	OTHER
TREES	AR	Acer rubrum 'Red Sunset'	Red Sunset Red Maple	2"	12-14'	B&B	AS SHOWN
	QP	Quercus phellos 'Hightower'	Hightower Willow Oak	2"	12-14'	B&B	AS SHOWN
	LI	Lagerstroemia indica 'Cherokee'	Cherokee Grape Myrtle	6"-8"		B&B	AS SHOWN Multi-trunk (3 stem min.)
	PS	Prunus serrulata 'Kwansan'	Kwansan Japanese Cherry	2"	10-12'	B&B	AS SHOWN
SHRUBS AND GROUNDCOVERS	ICB	Ilex cornuta 'Burfordii nano'	Dwarf Burford Holly	24"		Cont.	36" o.c.
	PL	Prunus laurocerasus 'Schipka'	Schipka Laurel	24"		Cont.	36" o.c.
	JH	Juniperus horizontalis 'Plumosa'	Andorra Juniper	6-12"		Cont.	36" o.c.
	RI	Raphiolepis indica 'Fascination'	India Hawthorn	24"		Cont.	36" o.c.
	VM	Vinca minor 'Atropurpurea'	Periwinkle			2.5" Flat	18" o.c.

LANDSCAPE REQUIREMENTS & CALCULATIONS				
LANDSCAPE DESIGNATED AREA	CODE REQUIREMENT	LINEAL FEET OF FRONTAGE	TOTAL QUANTITY REQUIRED	TOTAL QUANTITY PROVIDED
REQUIREMENTS FOR ADJACENT RIGHT OF WAY / STREETYARD PLANTINGS	DECIDUOUS TREES, HAVING A MINIMUM CALIPER OF TWO (2) TO TWO AND ONE-HALF (2 1/2) INCHES AT PLANTING SHALL BE PROVIDED IN ANY REQUIRED YARD OF A LOT THAT ADJUTS A PUBLIC STREET, AND TREES SHALL BE PROVIDED AT A RATE OF ONE (1) TREE FOR EACH FIFTY (50) FEET OF STREET FRONTAGE.	BRANDON AVENUE - 311.35 L.F. COLONIAL AVENUE - 243.80 L.F.	BRANDON AVENUE - 8 TREES REQ'D. COLONIAL AVENUE - 5 TREES REQ'D.	BRANDON AVENUE - 8 TREES PROVIDED COLONIAL AVENUE - 6 TREES PROVIDED
PARKING AREA LANDSCAPING	PROVIDE A LANDSCAPED AREA WITHIN THE PARKING AREA EQUAL TO 8% OF THE TOTAL AREA USED FOR PARKING OR VEHICULAR DISPLAY OR STORAGE		GROSS SQUARE FOOTAGE OF PARKING LOT = 39,380 S.F. (APPROX.) 1569 S.F. (3%) OF LANDSCAPING REQUIRED	1932 S.F. OF LANDSCAPING PROVIDED IN PARKING LOT ISLANDS
BUFFERYARD SCREENING	NO BUFFERYARD IS REQUIRED BETWEEN SUBJECT PROPERTY (ZONED C-2) AND ADJACENT PROPERTY (ZONED C-2)	NOT APPLICABLE	NOT APPLICABLE	NOT APPLICABLE

ROANOKE, VA
CVS STORE 3949

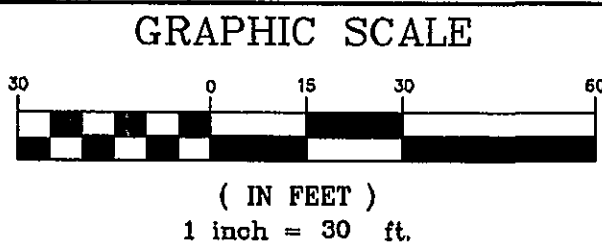

© 2005
**Kimley-Horn
and Associates, Inc.**
1500 FOREST AVENUE, SUITE 115
RICHMOND, VIRGINIA 23229

CONSULTANT:

KIMLEY-HORN AND ASSOC.
1500 FOREST AVENUE
TEL (804) 673-3882
FAX (804) 673-3980

SEAL:

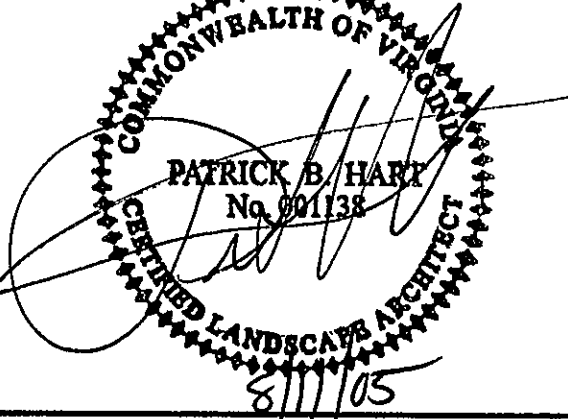

CVS/
pharmacy
13,013 S.F. PROTOTYPE
STORE NUMBER: #3949

INTERSECTION OF
BARNDON AVE. & COLONIAL AVE.
ROANOKE, VIRGINIA

OWNER/DEVELOPER:

THE REBKEE COMPANY
1020 OLD BON AIR ROAD
RICHMOND, VA 23235
PHONE: (804) 560-0500
FAX: (804) 560-0778

REVISIONS:

LAYOUT COORD: BDM
PLANNING MGR. KDC
DRAWING BY:
DATE: 04/06/05
JOB NUMBER: 113001048
TITLE:

PLANTING
PLAN

SHEET NUMBER:

LA-1

COMMENTS:
NOT FOR CONSTRUCTION