

**BENCHMARKS:**

1. P.K. NAIL SET IN APCO POLE 302-1040  
ELEV.= 949.08
2. TOP OF ARROWHEAD ON FIRE HYDRANT  
ELEV.= 952.58  
(SEE SHEET C-4 FOR LOCATIONS)

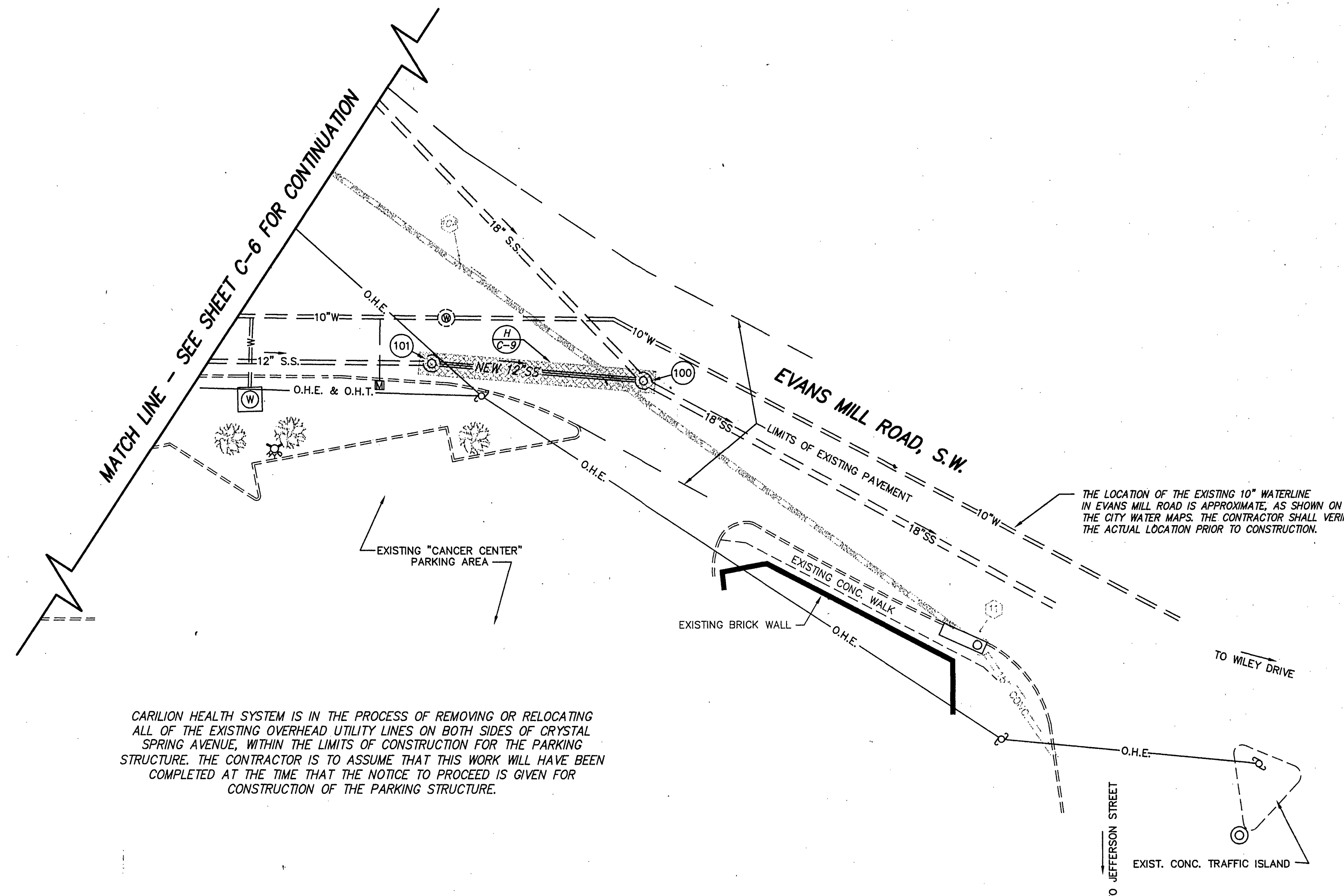
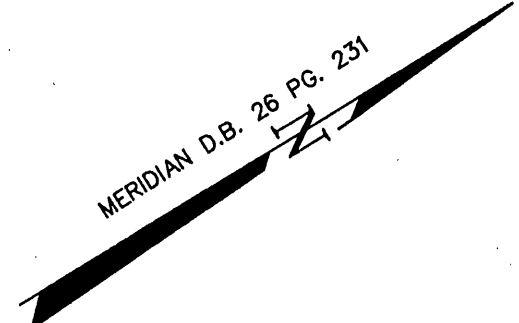

CARILION HEALTH SYSTEM IS IN THE PROCESS OF REMOVING OR RELOCATING ALL OF THE EXISTING OVERHEAD UTILITY LINES ON BOTH SIDES OF CRYSTAL SPRING AVENUE, WITHIN THE LIMITS OF CONSTRUCTION FOR THE PARKING STRUCTURE. THE CONTRACTOR IS TO ASSUME THAT THIS WORK WILL HAVE BEEN COMPLETED AT THE TIME THAT THE NOTICE TO PROCEED IS GIVEN FOR CONSTRUCTION OF THE PARKING STRUCTURE.

THE LOCATION OF THE EXISTING 10" WATERLINE IN EVANS MILL ROAD IS APPROXIMATE, AS SHOWN ON THE CITY WATER MAPS. THE CONTRACTOR SHALL VERIFY THE ACTUAL LOCATION PRIOR TO CONSTRUCTION.

- ◻ SEE SHEET C-4 FOR NEW STORM DRAIN ◻
- SEE SHEET C-8 FOR NEW SANITARY SEWER PROFILE —
- SEE SHEET C-6 FOR NEW SANITARY SEWER MAIN SCHEDULE ○

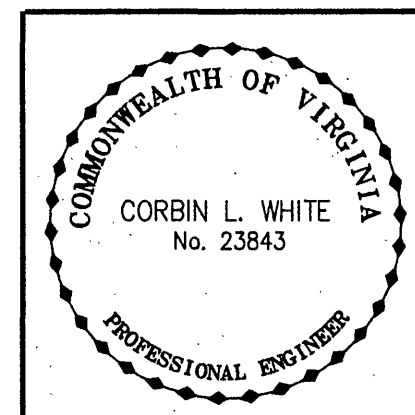
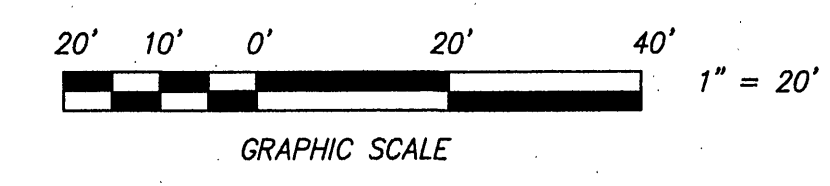

SITE UTILITIES PLAN  
FOR  
**NEW MEDICAL OFFICE BUILDING  
AND NEW PARKING STRUCTURE**  
FOR  
**CARILION HEALTH SYSTEM**  
SITUATE THE NORTHWEST CORNER OF THE INTERSECTION OF  
McCLANAHAN STREET, S.W. AND CRYSTAL SPRING AVENUE, S.W.  
CITY OF ROANOKE, VIRGINIA

Designed: C.L. White  
Drawn: C.L. White  
Checked: April 09, 1999  
Date: 1" = 20'  
Scale: 1040902, 04, 05, 06  
Tax Parcel: 1041003, 04  
W.O. No.: 88-0087  
Field Book: JW-04

**CWA**  
**CALDWELL WHITE ASSOCIATES**  
ENGINEERS / SURVEYORS / PLANNERS  
1054 OLD COUNTRY CLUB ROAD  
P.O. BOX 6340  
ROANOKE, VIRGINIA 24017  
(840) 948-7094  
FAX: (840) 981-0699