

GENERAL NOTES:

1. THIS PARTIAL AS-BUILT SURVEY WAS PREPARED WITHOUT BENEFIT OF A TITLE REPORT AND IS SUBJECT THERETO. THIS AS-BUILT SURVEY INCLUDES RECORDED EASEMENT WIDTHS AND LOCATIONS, AS SHOWN IN M.B. 1, PG 2804. THE RECORDED EASEMENTS ARE BEING VACATED AND NEW EASEMENTS ARE BEING CREATED.
2. ITEMS SHOWN ON THE PLAN INCLUDE: i) EXISTING UTILITIES LOCATED IN 2004, ii) UTILITIES LOCATED IN THE FIELD IN 2007, AND iii) INFORMATION RELAYED BY THE PIPE CONTRACTOR. PLAN CURB AND PAVEMENT LINES ARE SHOWN SHADED AND DASHED TO INCLUDE REFERENCE TO THE PLANS, AND HAVE NOT BEEN LOCATED.
3. A PORTION OF THE SUBJECT PROPERTY IS WITHIN THE LIMITS OF ZONE "AE" AND ZONE "X" AS SHOWN ON THE FEMA FLOOD INSURANCE RATE MAP NUMBER 51161C0048 D, EFFECTIVE DATE: OCTOBER 15, 1993. THIS DETERMINATION IS BASED ON SAID MAP AND HAS NOT BEEN VERIFIED BY ACTUAL FIELD ELEVATIONS. SEE SAID MAP FOR FLOOD ELEVATIONS.
4. ELEVATIONS ARE BASED ON A PUBLISHED BENCHMARK FOR THE CITY OF ROANOKE. THE DATUM IS NGVD 1929.

UTILITY STRUCTURES SHOWN AND NOTED WERE LOCATED IN THE FIELD AND VERIFIED IN MARCH 2007. PARKER DESIGN GROUP LOCATED VISIBLE STRUCTURES. SOME UTILITY LINES WERE LOCATED IN THE FIELD AS EXPOSED DURING CONSTRUCTION. OTHER LINES ARE ASSUMED STRAIGHT LINE BETWEEN STRUCTURES. UTILITY LINES AND STRUCTURES WITHOUT ELEVATIONS NOTED HAVE NOT BEEN VERIFIED OR NOT INSTALLED TO DATE. PARKER DESIGN GROUP DOES NOT WARRANT THE LOCATION OF UNDERGROUND UTILITIES SHOWN HEREON OR ANY IMPROVEMENTS EXCEPT WHERE VISIBLE ON THE SURFACE.

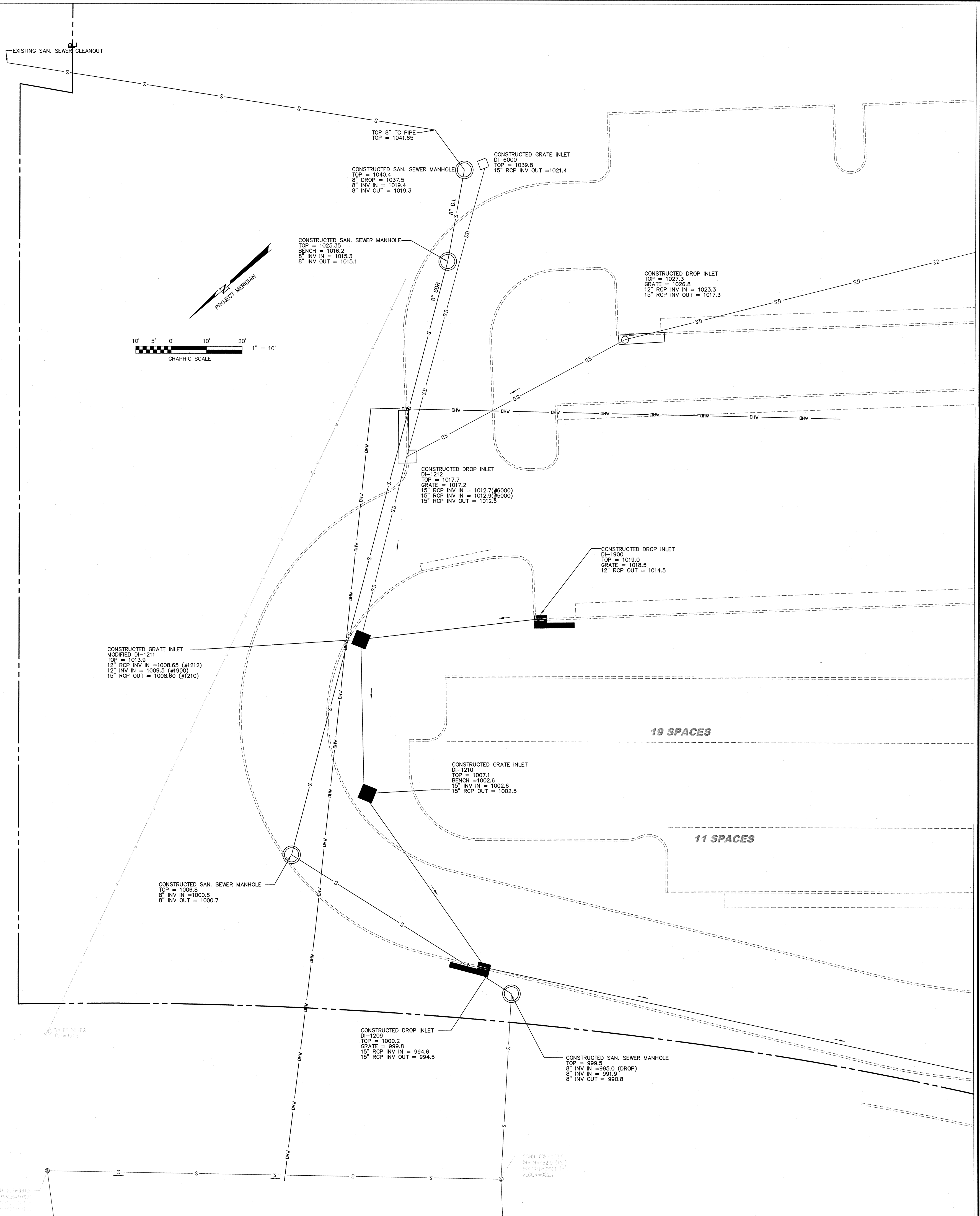

These documents are the property of Parker Design Group (PDG) and may not be reproduced or used without the express permission of PDG. Any reuse of these documents without written permission of PDG will be at the sole risk of the individual or entity using said documents.

AS-BUILT PLAN DATED
SEPTEMBER 4, 2007.



CARLION ROANOKE MEMORIAL
AS BUILT INFORMATION

TAX NO. 4060301
ROANOKE, VIRGINIA

REVISIONS:

DESIGNED BY:

DRAWN BY: PJB

CHECKED BY: PJB

SCALE: 1" = 10'

DATE: APRIL 11, 2007

SHEET TITLE:

CRMH ASBUILT
INFORMATION

AB6

06 OF 06
PROJECT NUMBER:
06-0087-01