

This document, together with the concepts and designs presented herein, as an instrument of service, is intended only for the specific purpose and client for which it was prepared. Reuse of and improper reliance on this document without written authorization and adoption by Engineering Concepts, Inc. shall be without liability to Engineering Concepts, Inc.

DALEVILLE TOWN CENTER

PHASE 5 SUBDIVISION: AMENDED PHASING PLAN

DALEVILLE

BOTETOURT COUNTY, VIRGINIA

DECEMBER 7, 2023

PROPERTY OWNER IDENTIFICATION

1. PROPERTY OWNER:
FRALIN & WALDRON, INC.
90 TOWN CENTER STREET
DALEVILLE, VIRGINIA 24083
2. SUBMITTING ENGINEER:
ENGINEERING CONCEPTS, INC.
94 GREENFIELD STREET
DALEVILLE, VIRGINIA 24083
PHONE: (540) 473-1253
J. SCOTT CALDWELL – PROJECT ENGINEER
3. CONTACT:
FRALIN & WALDRON, INC.
90 TOWN CENTER STREET
DALEVILLE, VIRGINIA 24083
PHONE: (540) 774-4415

ABBREVIATIONS

WSE	WATER SURFACE ELEVATION	SWM	STORM WATER MANAGEMENT
O.D.	OUTSIDE DIAMETER	ELEC	ELECTRIC (UNDERGROUND)
MH	MANHOLE	SS	SANITARY SEWER
XING	CROSSING	ARV	AIR RELEASE VALVE
GPM	GALLONS PER MINUTE	C.I.	CAST IRON
PSI	POUNDS PER SQUARE INCH	WL	WATERLINE
P.I.V.	POST INDICATOR VALVE	E	ELECTRIC (OVERHEAD)
SDR	STANDARD DIMENSION RATIO	C&P	CHESAPEAKE & POTOMAC
MIN	MINIMUM	STM	STEAM
LAT.	LATERAL	WV	WATER VALVE
ST	STORM DRAIN	CPU	UNDERGROUND COMPUTER CABLE
VERT.	VERTICAL	CONC	CONCRETE
HORIZ.	HORIZONTAL	T.C.	TERRA COTTA
BLDG.	BUILDING	SC	UNDERGROUND SATELLITE
SEP.	SEPARATION	INV	INVERT
D.I.	DROP INLET	V.D.O.T.	VIRGINIA DEPARTMENT OF TRANSPORTATION
C.O.	CLEANOUT	TYP.	TYPICAL
MAX.	MAXIMUM	ELEV.	ELEVATION
F.F.	FINISHED FLOOR	@	AT
FIN.	FINISHED	C	CENTERLINE
FOUND.	FOUNDATION	HD	HIGH DENSITY
O	DIAMETER	PVC	POLYVINYL CHLORIDE
CLR.	CLEARANCE	F.H.	FIRE HYDRANT
T.O.F.	TOP OF FOOTING	TELE.	TELEPHONE
O.C.	ON CENTER	CMP	CORRUGATED METAL PIPE
REINF.	REINFORCEMENT	H.P.	HIGH POINT
SSMH	SANITARY SEWER MANHOLE	EXIST/EX.	EXISTING
L.P.	LOW POINT	HDPE	HIGH DENSITY POLYETHYLENE
FD	FOUNDATION DRAIN	V.M.I.	VIRGINIA MILITARY INSTITUTE
F	FIRE SERVICE LINE	A.E.	AIR ENTRAINED
D	DOMESTIC SERVICE LINE	TCxxx	TOP OF CURB ELEVATION
		Pxxx	PAVEMENT ELEVATION

VIRGINIA COUNTY LOCATION MAP

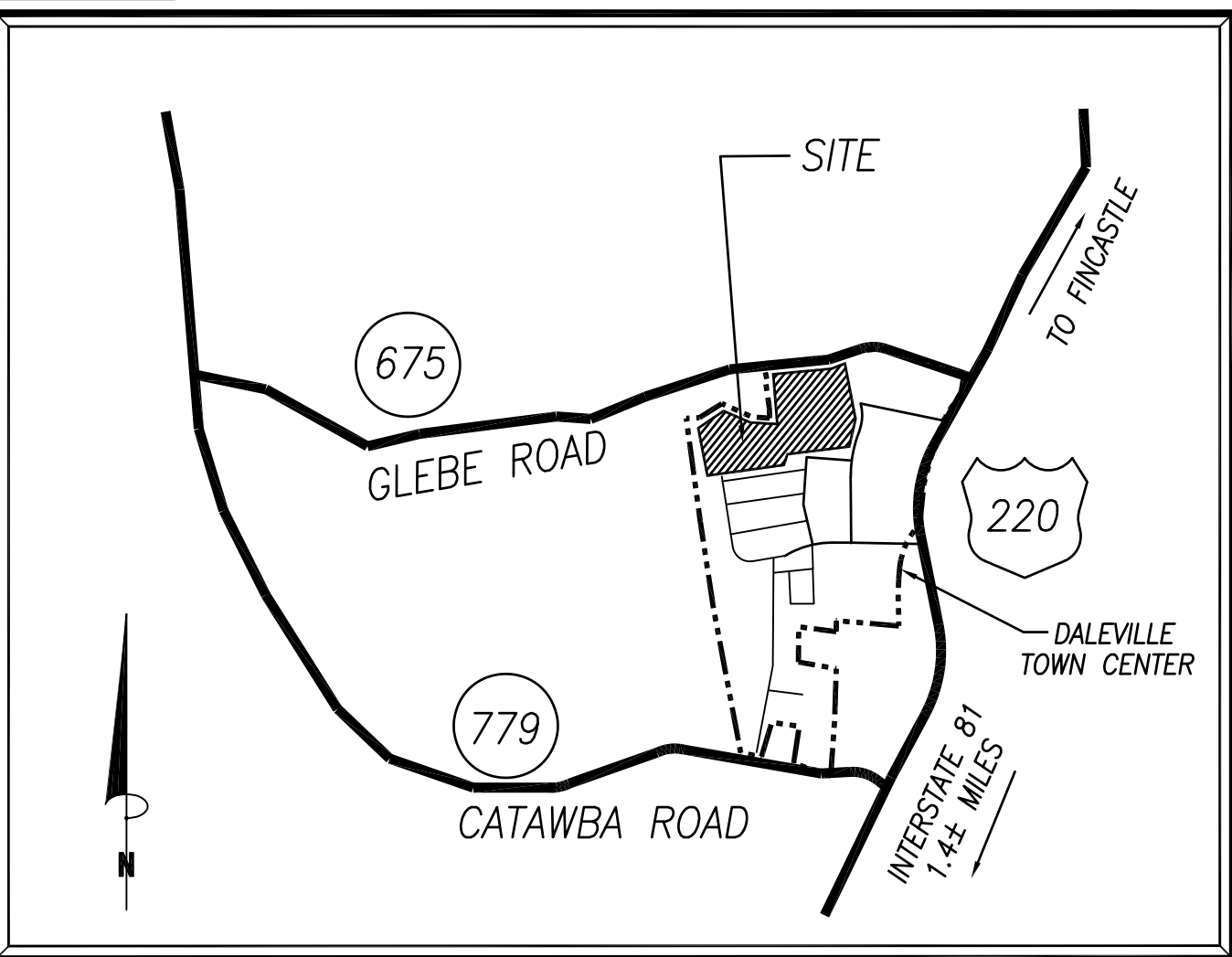
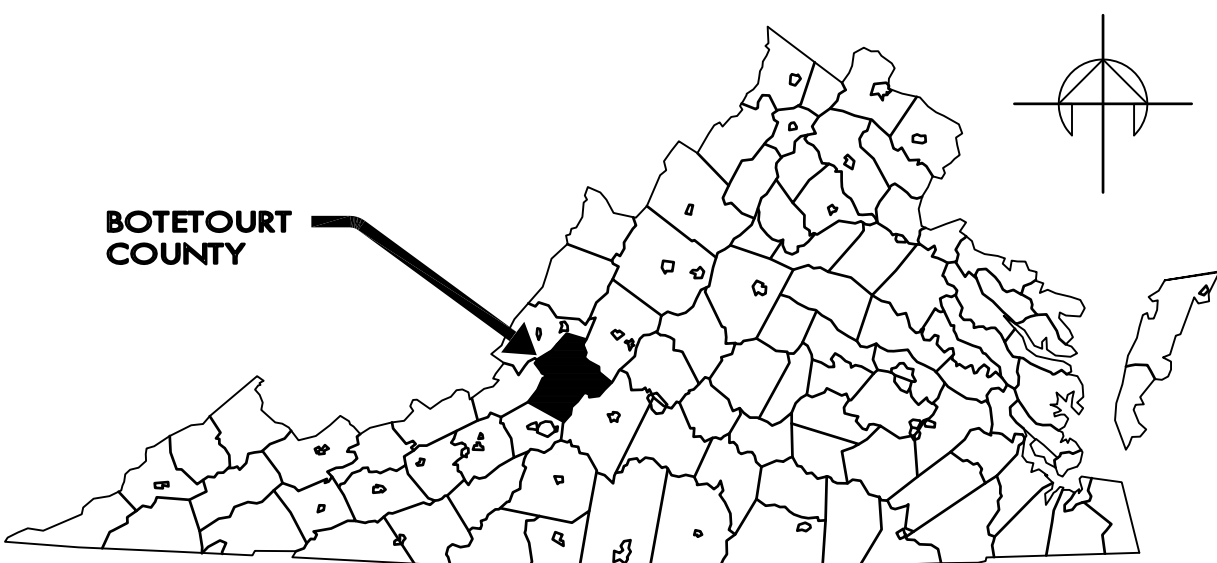

VICINITY MAP

NOT TO SCALE

SHEET INDEX

C-000	COVER SHEET	C-503	STORM DRAINAGE AREAS
C-001	GENERAL NOTES	C-504	STORM DRAINAGE AREAS
C-002	ZONING NOTES	C-505	STORM BASIN PLAN
C-003	E&S NOTES	C-601	STORM SEWER PROFILES
C-004	UTILITY NOTES & SUMMARY	C-602	STORM SEWER PROFILES
C-005	OVERALL PLAN	C-603	STORM SEWER PROFILES
C-101	EXISTING CONDITIONS PLAN	C-604	STORM SEWER PROFILES
C-102	EROSION & SEDIMENT CONTROL PLAN	C-605	STORM STRUCTURE TABLES
C-201	SITE DIMENSIONAL & UTILITIES PLAN	C-606	STORM PIPE TABLES
C-202	SITE DIMENSIONAL & UTILITIES PLAN	C-607	SANITARY SEWER PROFILES
C-203	SITE DIMENSIONAL & UTILITIES PLAN	C-608	SANITARY SEWER PROFILES
C-301	GRADING & EROSION CONTROL PLAN	C-609	SANITARY SEWER PROFILES
C-302	GRADING & EROSION CONTROL PLAN	C-610	SANITARY STRUCTURE & PIPE TABLES
C-303	GRADING & EROSION CONTROL PLAN	C-611	SANITARY CLEANOUT TABLES
C-304	INTERSECTION GRADING PLAN	C-701	TYPICAL ROAD SECTIONS
C-305	BROAD STREET CROSSING GRADING PLAN	C-702	TYPICAL ROAD SECTIONS
C-401	SEDGEWOOD AVENUE PLAN & PROFILE	C-703	WVWA DETAILS
C-402	MERIWETHER STREET PLAN & PROFILE	C-704	WVWA DETAILS
C-403	COLONY AVENUE PLAN & PROFILE	C-705	WVWA DETAILS
C-404	COLONY AVENUE PLAN & PROFILE	C-706	EROSION CONTROL DETAILS
C-405	CLARK STREET PLAN	C-707	SOILS DATA PLAN
C-406	CLARK STREET PROFILE	C-708	ZONING TABULATION PLAN
C-407	CHARTER AVENUE AND ALLEY 2 PLAN & PROFILE	C-709	TRANSPORTATION MANAGEMENT PLAN
C-408	BROAD STREET PLAN & PROFILE	C-710	VEHICLE TRACKING
C-409	ALLEY 1 PLAN & PROFILE	C-711	SIGHT DISTANCE PROFILE
C-501	EXISTING DRAINAGE AREAS	C-801	PHASING OVERALL PLAN
C-502	Basin Drainage Area	C-802	PHASING PLAN MERIWETHER & COLONY
		C-803	PHASING PLAN COLONY & CLARK

TOTAL LIMITS OF DISTURBANCE = 21.65 ACRES

RLD NAME: _____
RLD No: _____



ENGINEERING
CONCEPTS, INC.

94 GREENFIELD STREET
DALEVILLE, VIRGINIA 24083
540.473.1253



daleville
town center



FRALIN & WALDRON, INC.

APPROVED

By Sean Nester at 1:33 pm, Feb 06, 2024

Approved
Botetourt County
Planning and Zoning

C. Nicole Pendleton

02/07/2024

DALEVILLE TOWN CENTER
BOTETOURT COUNTY, VA

COVER SHEET – PHASING
PLAN

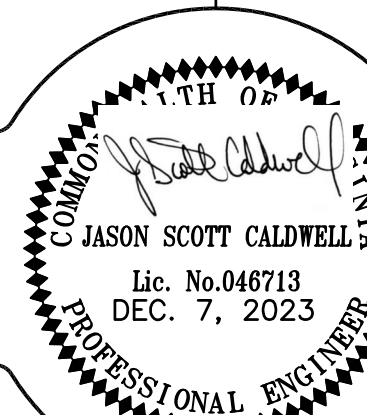

0 N/A N/A
GRAPHIC SCALE

PROJECT: 21061

C-000