

SITE IMPROVEMENTS

CONTRACT SI-1

DEANWOOD COMMUNITY DEVELOPMENT PROGRAM, (CD-2)

ROANOKE, VIRGINIA

CITY OF ROANOKE REDEVELOPMENT AND HOUSING AUTHORITY

DATE: 23 MAR. 1984

INDEX OF DRAWINGS

SHEET NUMBER	DESCRIPTION
1	COVER SHEET
2	ABBREVIATIONS, LEGEND, AND SUMMARY OF QUANTITIES
3	LANDSCAPING, GRADING, AND STORM DRAINAGE (SOUTH)
4	LANDSCAPING, GRADING, AND STORM DRAINAGE (NORTH)
5	DIMENSIONAL LAYOUT AND UTILITIES (SOUTH)
6	DIMENSIONAL LAYOUT AND UTILITIES (NORTH)
7	EXISTING UTILITIES (SOUTH)
8	EXISTING UTILITIES (NORTH)
* 9	OFF-SITE PLAN & PROFILE, KIMBALL AVENUE
10	PROFILES, STREET & SANITARY SEWER
11	SANITARY SEWER AND STORM DRAIN PROFILES
* 12	EROSION CONTROL PLAN (SOUTH)
* 13	EROSION CONTROL PLAN (NORTH)
14	DETAILS

* NOT INCLUDED IN "AS-BUILT" DRAWINGS

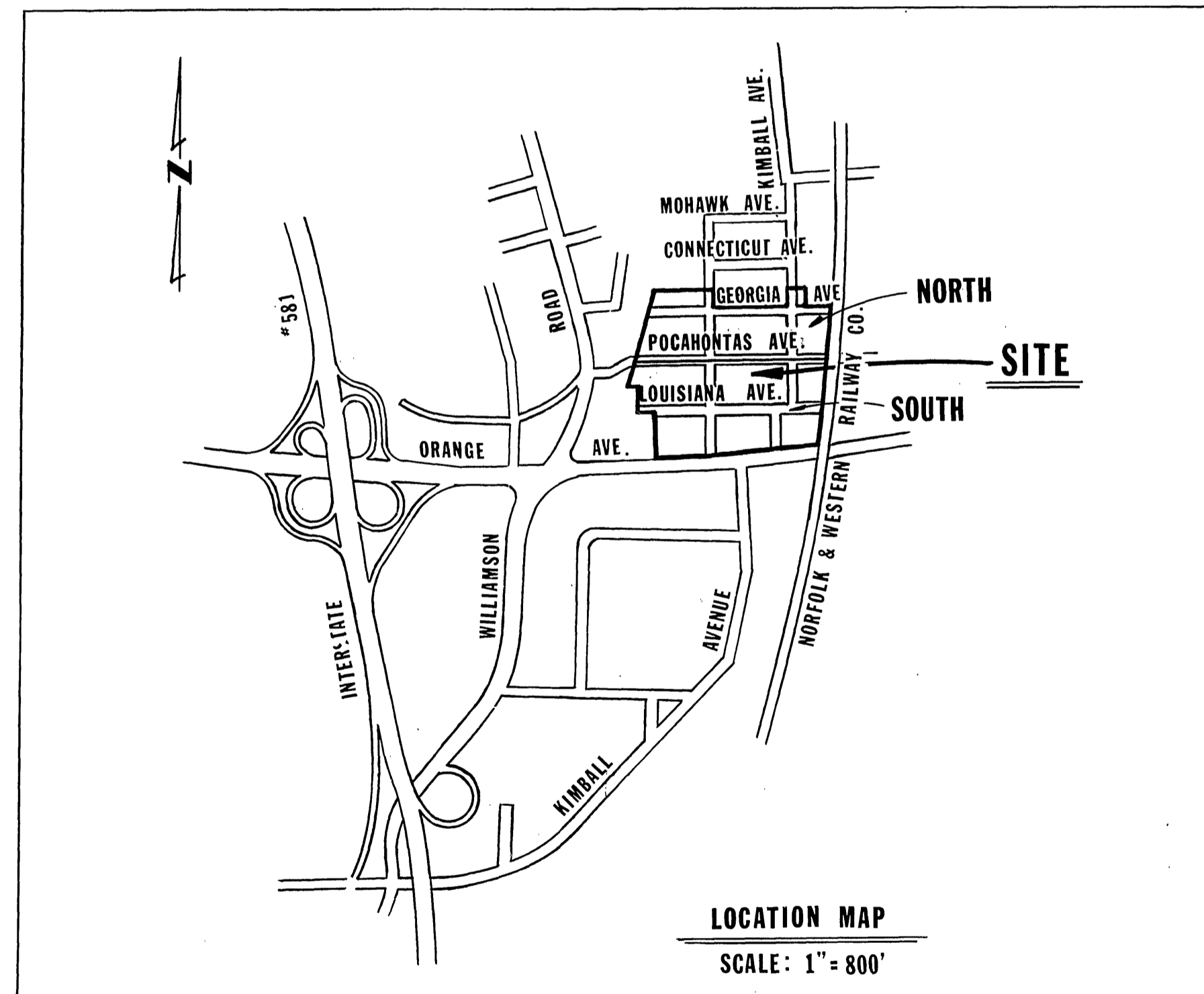

GENERAL NOTES:

- EXISTING TOPOGRAPHIC INFORMATION BASED ON AERIAL MAPPING BY AERIAL DATA REDUCTION ASSOCIATES, SUPPLEMENTED BY FIELD SURVEYS BY BUFORD T. LUMSDEN & ASSOCIATES.
- ELEVATIONS ARE USGS DATUM, UNLESS OTHERWISE INDICATED.
- GRID CO-ORDINATES AND BEARINGS ARE BASED ON VIRGINIA STATE PLANE CO-ORDINATE SYSTEM, SOUTH ZONE.
- THE LOCATIONS OF ALL UNDERGROUND UTILITIES SHOWN ON THE DRAWINGS ARE PLOTTED FROM AVAILABLE RECORDS AND SURFACE SURVEYS AND SHOULD BE CONSIDERED APPROXIMATE. THE CONTRACTOR SHALL BE RESPONSIBLE FOR THE DEFINITE LOCATION OF EACH UTILITY INVOLVED WITHIN THE AREA OF HIS EXCAVATION FOR WORK UNDER THIS CONTRACT. CARE SHALL BE EXERCISED DURING SUCH LOCATION WORK TO AVOID DAMAGING AND/OR DISRUPTING THE AFFECTED UTILITY. THE CONTRACTOR SHALL BE RESPONSIBLE FOR REPAIRING, AT HIS EXPENSE, DAMAGE TO ANY UTILITY CAUSED BY HIS WORK. ALL WORK IN THE VICINITY OF EXISTING UNDERGROUND UTILITIES SHALL BE COORDINATED WITH AND APPROVED BY THE RESPECTIVE UTILITY COMPANY AND SHALL BE ACCOMPLISHED IN ACCORDANCE WITH THE RULES AND REGULATIONS OF THE RESPECTIVE UTILITY COMPANY.
- WHERE EXISTING UNDERGROUND UTILITIES OR OTHER CONSTRUCTION APPEARS TO BE IN CLOSE PROXIMITY TO PROPOSED CONSTRUCTION, OR WHEN APPROACHING EXISTING UTILITIES OR STRUCTURES FOR CONNECTIONS, THE TRENCH SHALL BE OPENED A SUFFICIENT DISTANCE AHEAD OF THE WORK OR TEST PITS MADE TO VERIFY THE EXACT LOCATION AND INVERTS OF THE UTILITY TO ALLOW FOR POSSIBLE CHANGES IN LINE OR GRADE. ANY NECESSARY CHANGES IN LINE OR GRADE OF THE WORK, CAUSED BY FAILURE TO TAKE SUCH PRECAUTIONS, WILL BE AT THE EXPENSE OF THE CONTRACTOR.
- SUPPLEMENTAL DRAWINGS FOR VARIOUS CONSTRUCTION DETAILS ARE INCLUDED IN THE SPECIFICATIONS.
- PROJECT BOUNDARY IS DEFINED BY CORNERS ① - ② - ① INCLUSIVE.
- "OFF SITE" WORK ON KIMBALL AVENUE (NORTH OF STATION 21+00) TO BE PERFORMED EITHER BY CITY FORCES OR UNDER A SEPARATE CONTRACT. THE CONTRACTOR WILL COORDINATE HIS WORK WITH THE "OFF SITE" WORK IN ORDER TO MAINTAIN TRAFFIC AND CONTINUITY OF UTILITY SERVICES.

APPROVED:

Richard B. Boman 5 April 1984
 ENGINEER, CITY OF ROANOKE, VIRGINIA DATE
Carl B. Reynolds 5 April 1984
 AGENT, ROANOKE CITY PLANNING COMMISSION DATE

BUFORD T. LUMSDEN & ASSOCIATES, P.C.

ENGINEERS-SURVEYORS

ROANOKE, VIRGINIA

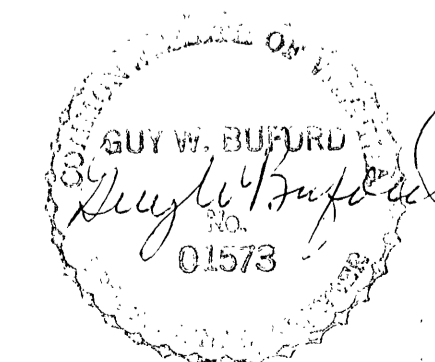
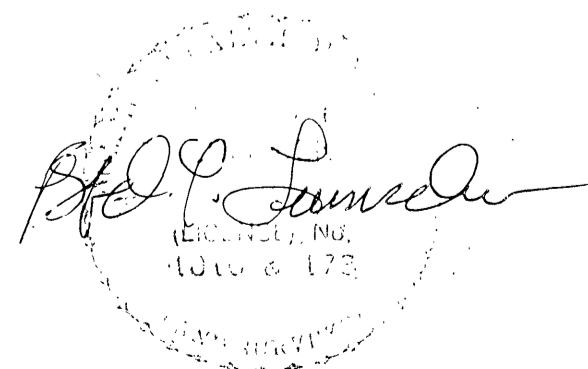

WATER DEPARTMENT PLAN NO. 85-11A

"AS - BUILT" DRAWINGS

NOTE: AS BUILT DRAWINGS COMPILED FROM CHANGE ORDERS AND INFORMATION OBTAINED FROM CONTRACTORS' "AS-BUILT" DRAWINGS
4 APRIL, 1985

PLAN No. 5907

#81-338

SHEET #1 OF 14