

ML AS-Built Dent St  
ML

### Site Map

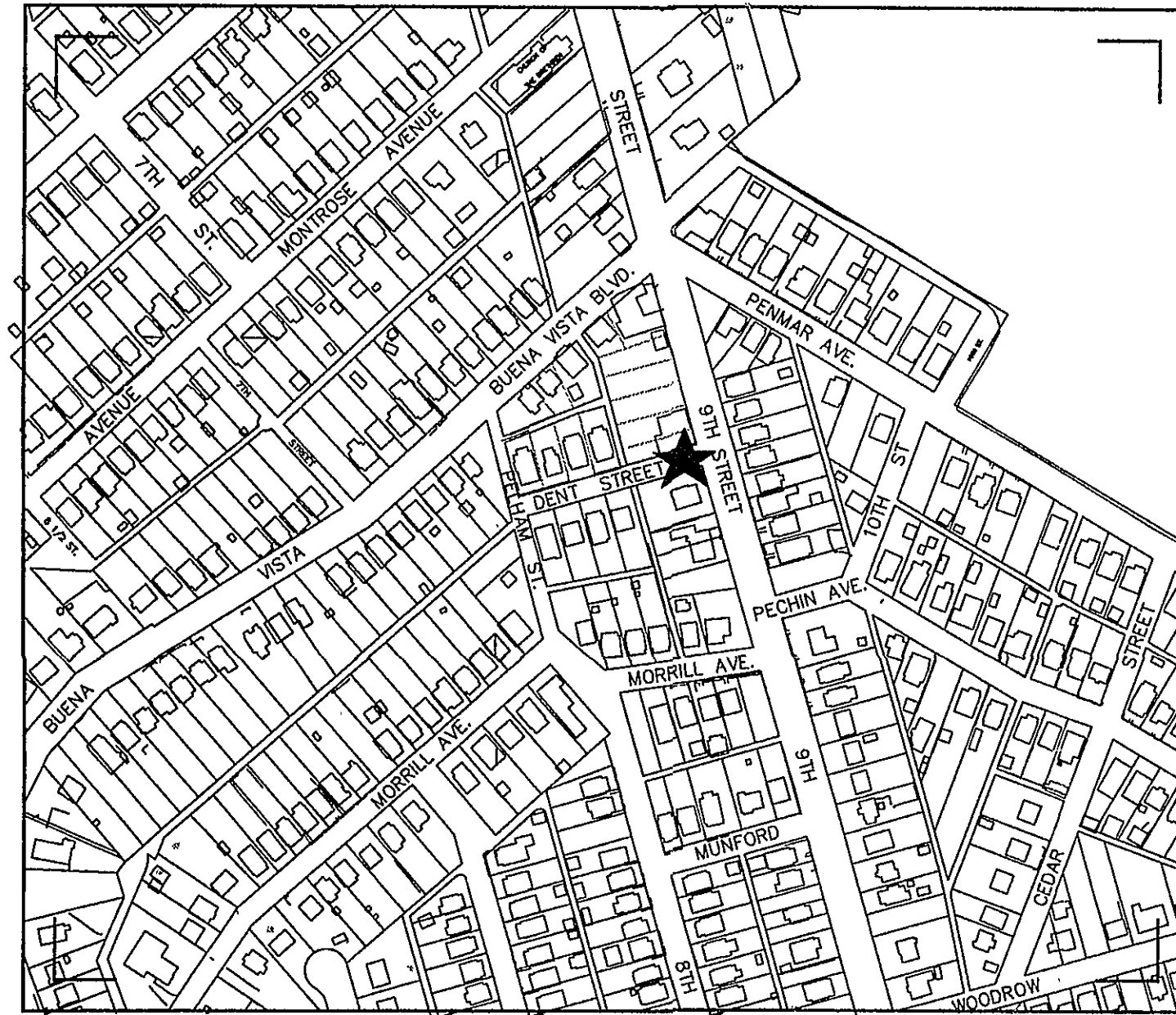

# Water Project

## Dent Street Water Line Replacement

### SHEET INDEX

- 1 Cover Sheet
- 2 Plan

Design Engineer:  
WVWA

#### GENERAL NOTES:

1. All construction methods and materials shall conform to the latest edition of the Design and Construction Standards and Specifications of the Western Virginia Water Authority (Authority). Project shall also comply with the controlling jurisdiction's and other agency's standards (VDOT, DEQ, DCR, VDH, etc.)
2. All connections to existing sanitary sewer lines and manholes shall be performed by the Authority. The contractor shall excavate to the base of the existing manhole, shore per OSHA requirements and provide a center mark on the side of the manhole for the tap. Contractor shall notify ULS as 853-2792 at least seventy-two (72) hours prior to connection.
3. All connections to existing water lines shall be performed by the Authority. Contractor shall provide full stainless steel tapping sleeve and valve. Contractor shall notify ULS at 853-2792 at least seventy-two (72) hours prior to connection.
4. Prior to construction in the right-of-way, all applicable permit(s) from the controlling jurisdiction or agency must be obtained and a copy kept on the project site.
5. Traffic control shall be provided in accordance with the most recent MUTCD Manual and the VDOT Work Area Protection Manual. For projects requiring traffic control in City of Roanoke, notify Traffic Engineer, Mark Jamison at 853-2585 two weeks in advance of construction. For a Lane Closure Permit in City of Roanoke, contact Gary Bowman at 853-5293. All pavement repairs shall be in accordance with the controlling jurisdiction's or agency's standards.
6. The Contractor shall notify Engineering Coordinator, Chuck Clark, at 537-3243 at least (3) days prior to construction.
7. A pre-construction conference shall be scheduled at least one (1) day prior to any construction.
8. The Contractor shall have a valid Miss Utility ticket prior to excavation. Contact Miss Utility at 1-800-552-7001.
9. All existing utilities may not be shown or may not be shown in their exact location. Contractor shall locate all utilities and determine all inverts in advance of the construction to allow for adjustments due to conflicts with other utilities. The Contractor shall comply with State Water Works Regulations, Section 12.05.03, and Sewage Collection and Treatment Regulations where lines cross.
10. An approved set of plans and permits must be available at the construction site at all times.
11. Construction debris shall be containerized in accordance with the Virginia Litter Control Act.
12. Prior to commencing work, the Contractor's Certified Responsible Land Disturber shall obtain an Erosion and Sediment Control Permit for the project from the local controlling jurisdiction and DCR (if required). All erosion control measures must be in accordance with the latest edition of the Virginia Erosion and Sediment Control Handbook and shall be placed prior to construction.
13. The Contractor shall provide adequate means of cleaning mud from all vehicles and equipment prior to entering public streets. It is the Contractor's responsibility to ensure that the streets are kept in a clean, mud and dust free condition at all times.
14. Field changes shall be approved by the Authority Engineering Division prior to such construction.
15. Contractor shall make provisions to provide access to all properties during construction and shall maintain safe accessibility to fire hydrants at all times.
16. Contractor shall be responsible for locating and uncovering all manholes after paving. Manhole tops shall be constructed to grade and flush with pavement.
17. Unrepaired roadways opened to traffic shall have, at a minimum, compacted aggregate material 21A or 21B flush with the adjacent roadway surface and shall be inspected and repaired on a daily basis. Some areas will require a temporary patch until final paving can be completed.
18. Contractor shall not excavate more trench length than can be restored within the same work day. All trenches shall be backfilled or plated at the end of each work day or when contractor is not on site.
19. The Contractor shall supply the Authority with correct as-built plans before substantial completion will be granted.

#### Approved for Construction:

	1-9-06
Executive Director of Water	Date
N/A	
Executive Director of Wastewater	Date
	1-9-06
Manager of Engineering Services	Date

AS - BUILT  
2/22/2006

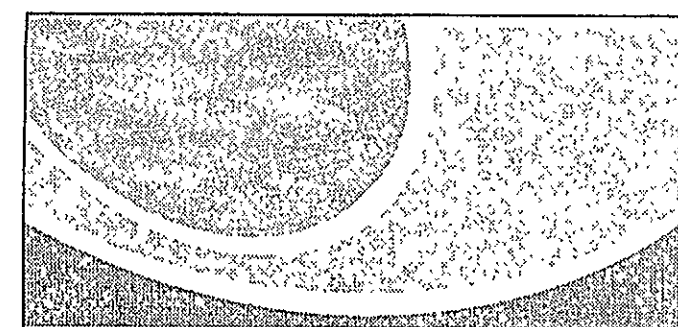

WESTERN VIRGINIA  
WATER AUTHORITY

601 S. Jefferson Street  
Suite 300  
Roanoke, VA 24011

Revisions:	
Date	Sheets

Sheet 1 OF 2

DENT ST WATER