

**SEWER NOTES:**

- 1.) ALL CONSTRUCTION OF THESE SEWERAGE SYSTEMS TO BE IN ACCORDANCE WITH THE STATE BOARD OF HEALTH SEWERAGE HANDLING AND DISPOSAL REGULATIONS.
- 2.) PIPING AND VALVES: ALL GRAVITY LINES AND FORCE MAINS OUTSIDE PUMP STATION TO BE SCHEDULE 40 PVC AND BEDDED TO PROVIDE UNIFORM SUPPORT ALONG THE LENGTH OF THE SEWER. ALL TRENCHES SHALL BE BACKFILLED WITH SUITABLE MATERIAL FREE OF LARGE STONES AND DEBRIS AND TAMPED TO PREVENT MOVEMENT AS SOON AS POSSIBLE. ALL FORCE MAIN PIPES SHALL BE TESTED TO 50 PSI FOR ONE HOUR WITH NO LEAKAGE PERMITTED. FORCE MAINS SHALL HAVE PRESSURE FITTINGS.
- 3.) DRAINFIELD SHALL HAVE A MINIMUM COVER OF 30" IF DRIVEWAY IS TO BE CONSTRUCTED IN ABSORPTION AREA. DRIVEWAY MAY NOT BE CONSTRUCTED OVER DRAINFIELD IN THIS SYSTEM. DRIVEWAY NOT TO CROSS TANKS OR DISTRIBUTION BOXES.
- 4.) TANKS, DISTRIBUTION BOXES AND DRAINFIELDS MUST BE LOCATED A MINIMUM OF 5' FROM PROPERTY LINES, 10' FROM BUILDING FOUNDATIONS, 10' FROM UTILITY LINES, AND 50' FROM TOP OF RIP RAP.
- 5.) ALL HYDROPHILIC TREES AND PLANTS SHALL BE REMOVED WITHIN 10 FEET OF DRAINFIELD AREA.
- 6.) ALL SOIL WORK AND DESIGN CRITERIA PERFORMED BY FRANK DAVIS AOSE (#163). ALL CHANGES IN DESIGN MUST BE APPROVED BY THE AOSE.
- 7.) SOIL ABSORPTION SYSTEM CONSTRUCTION PERMITS TO BE ISSUED BY VIRGINIA DEPARTMENT OF HEALTH FOR ALL SYSTEMS INCLUDED IN PLANS.

**WATER NOTES:**

1. ALL CONSTRUCTION STANDARDS AND SPECIFICATIONS SHALL BE IN ACCORDANCE WITH ALL LOCAL, STATE, AND FEDERAL REGULATIONS, SPECIFICALLY FRANKLIN COUNTY CHAPTER 22 WATER AND SEWER REGULATIONS, VIRGINIA DEPARTMENT OF HEALTH WATERWORKS REGULATIONS, AND VIRGINIA DEPARTMENT OF TRANSPORTATION ROAD AND BRIDGE STANDARDS.
2. PRIOR TO CONSTRUCTION CONTRACTOR SHALL CONTACT MISS UTILITY TO LOCATE ALL EXISTING UTILITIES. THE ENGINEER SHALL BE CONTACTED IMMEDIATELY IF THE EXISTING CONDITIONS DIFFER FROM PLANS.
3. WATER MAINS SHALL HAVE AT LEAST 36 INCHES OF COVER. *or DIP*
4. ALL PIPE CROSSINGS SHALL MAINTAIN A MINIMUM VERTICAL SEPARATION OF 18".
5. ALL WATER MAINS SHALL BE CLASS 150 PVC. A COPPER WIRE (SIZE #14 OR LARGER) SHALL BE INSTALLED PARALLEL AND AT THE SAME DEPTH AS THE PIPE AS WELL AS LOOP AROUND ALL VALVES. MARKING TAPE OF THE APPROPRIATE COLOR SHALL ALSO BE INSTALLED 12" TO 18" BELOW FINISHED GRADE FOR ALL PVC PIPE.
6. ALL TEES, BENDS, PLUGS, AND CAPS SHALL BE SUBSTANTIALLY BRACED, BLOCKED, AND/OR ANCHORED W/2500psi CONCRETE.
7. ALL WATER LINES SHALL BE A MINIMUM OF 10' HORIZONTALLY FROM SEWER LINES AND 30 FEET FROM DRAINFIELDS.

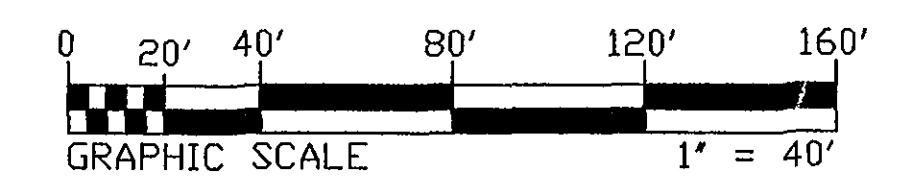
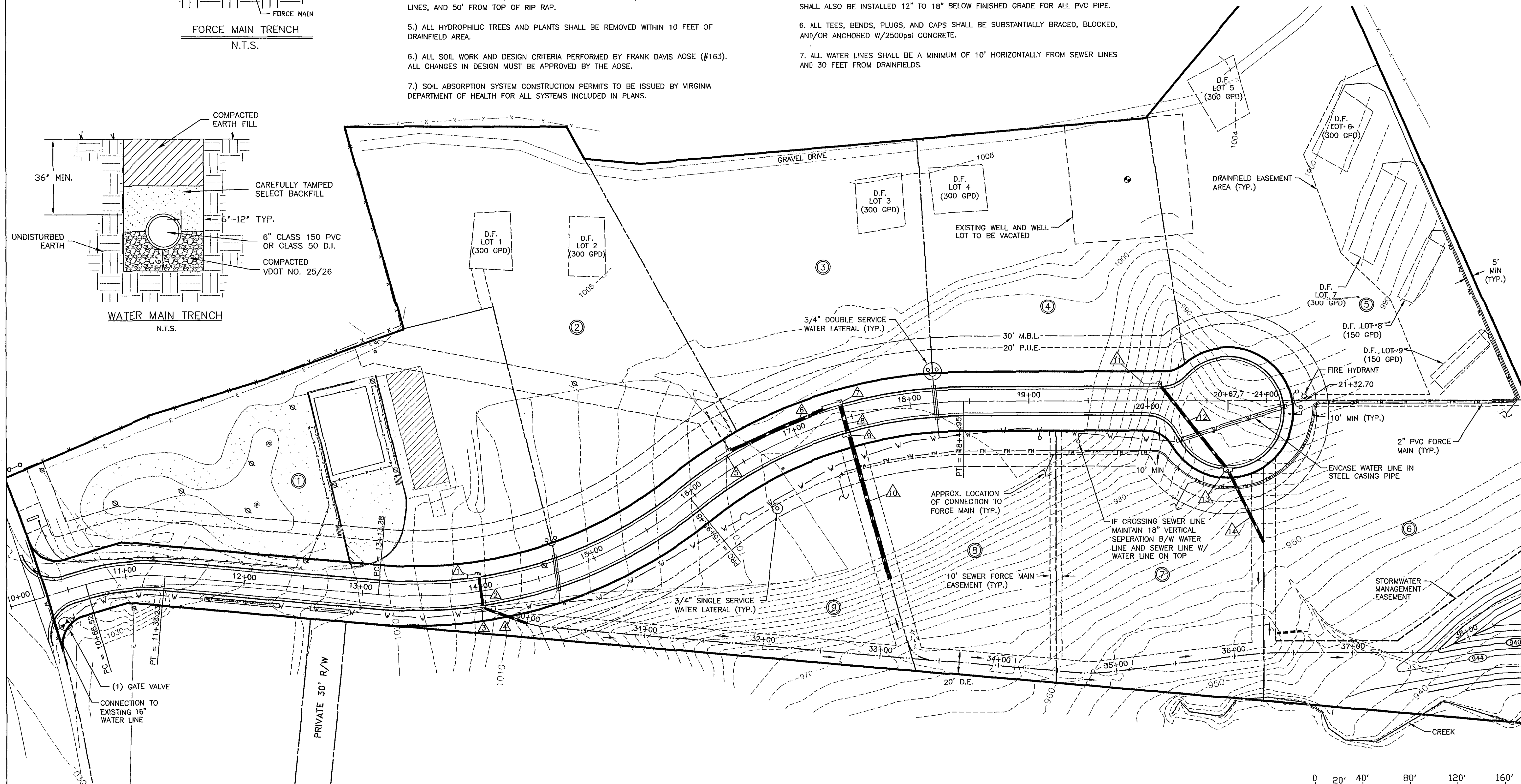
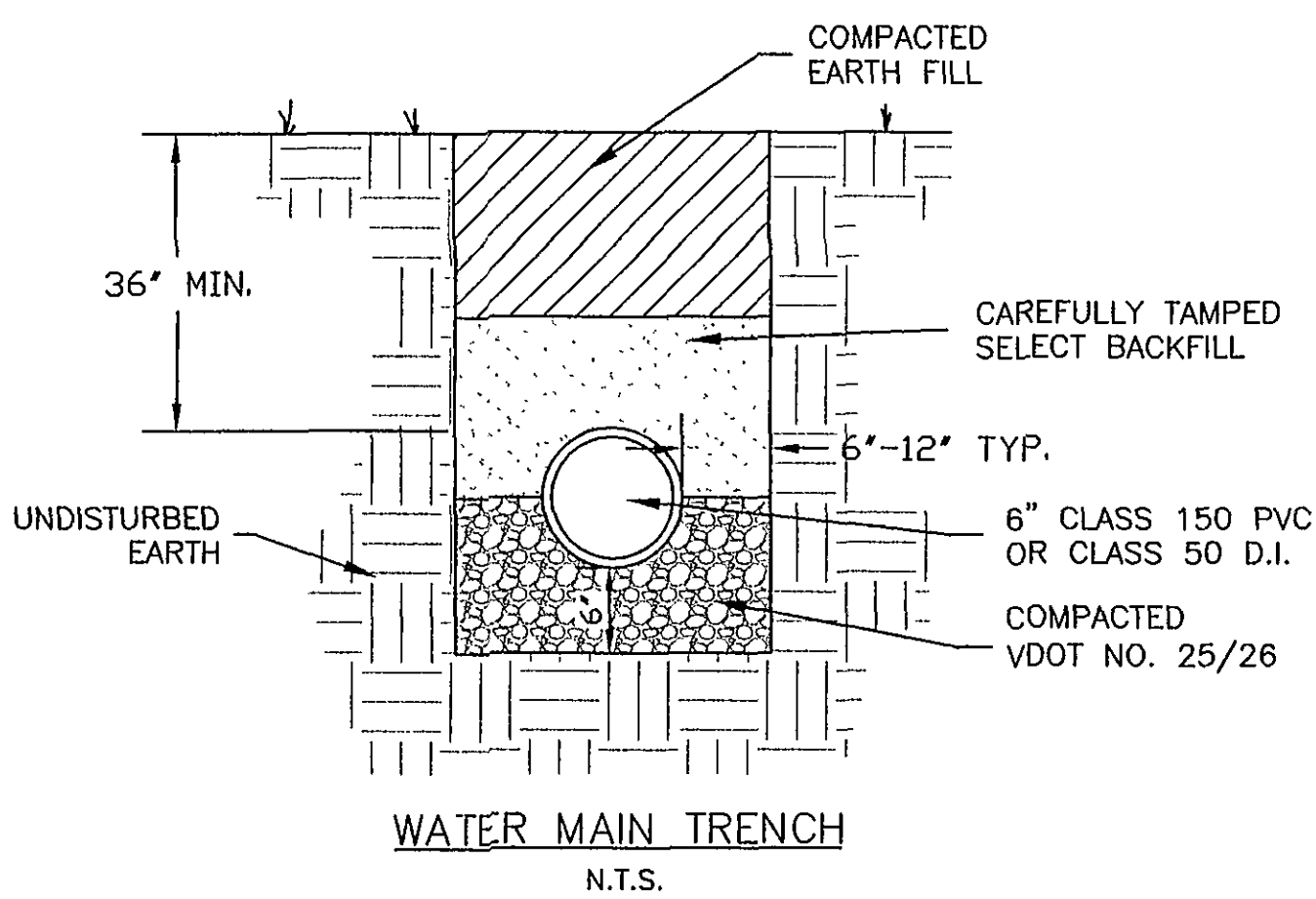

REVISIONS	DATE	APPROVAL

**Stone Engineering**  
 250 S. Main Street  
 Rocky Mount, Virginia 24151  
 (540) 483-0078

DESIGN: KSH  
 DRAFT: KSH  
 CHECK: RDS

**WATER AND SEWER PLAN SHEET FOR  
 MOUNTAIN VIEW VILLAGE**  
 LOCATED ON VIRGINIA ROUTE 122  
 GILLS CREEK MAGISTERIAL DISTRICT  
 FRANKLIN COUNTY, VIRGINIA

DATE: 2-15-06  
 SCALE: AS SHOWN  
 SHEET 5 OF 6  
 PROJECT NO. 05016